

STAGE 3

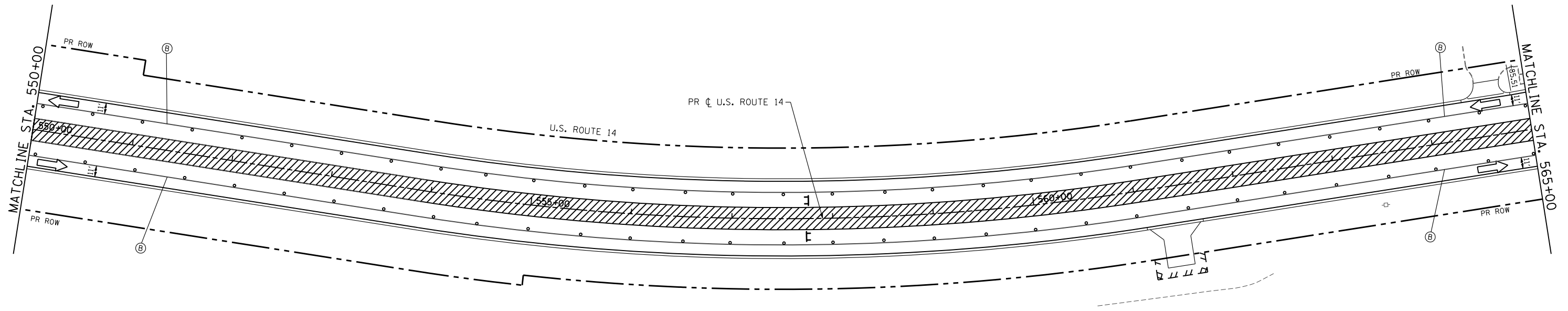

STAGE 3

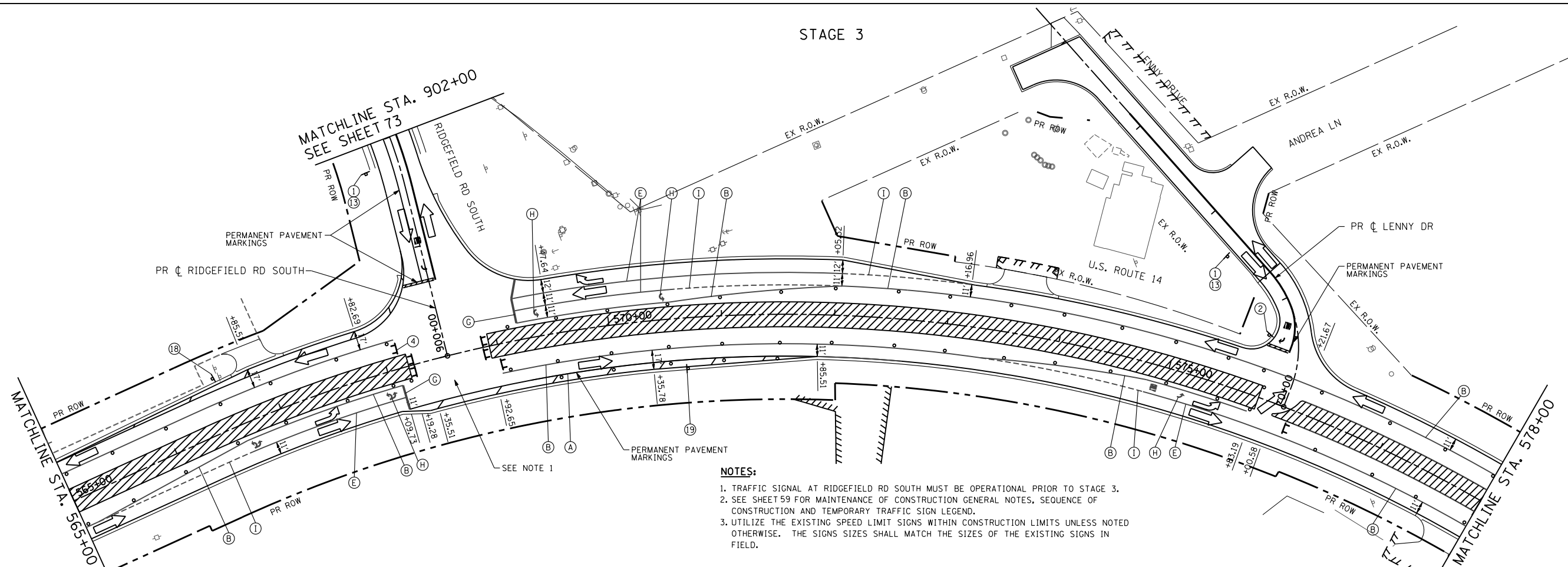

- NOTES:**
1. TRAFFIC SIGNAL AT RIDGEFIELD RD SOUTH MUST BE OPERATIONAL PRIOR TO STAGE 3.
 2. SEE SHEET 59 FOR MAINTENANCE OF CONSTRUCTION GENERAL NOTES, SEQUENCE OF CONSTRUCTION AND TEMPORARY TRAFFIC SIGN LEGEND.
 3. UTILIZE THE EXISTING SPEED LIMIT SIGNS WITHIN CONSTRUCTION LIMITS UNLESS NOTED OTHERWISE. THE SIGNS SIZES SHALL MATCH THE SIZES OF THE EXISTING SIGNS IN FIELD.

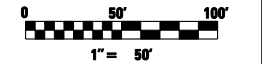

FILE NAME = s:\1606\cadd sheets\0162517-sht-staging3.dgn	USER NAME = _USERNAME_	DESIGNED - JPW	REVISED -	STATE OF ILLINOIS DEPARTMENT OF TRANSPORTATION	MAINTENANCE OF TRAFFIC PLAN US ROUTE 14 - STAGE 3		F.A. RTE. 305	SECTION 27R-3	COUNTY MCHENRY	TOTAL SHEETS 431	SHEET NO. 91	
PLOT SCALE = 100.0000' / IN.	CHECKED - MGZ	REVISIED -	REVISIED -		SCALE: 1"=50'	SHEET NO. 91 OF 431 SHEETS	STA. 550+00 TO STA. 578+00	CONTRACT NO. 62517		ILLINOIS FED. AID PROJECT		
PLOT DATE = 10/9/2013	DATE - 10/15/2013	REVISIED -	REVISIED -									