

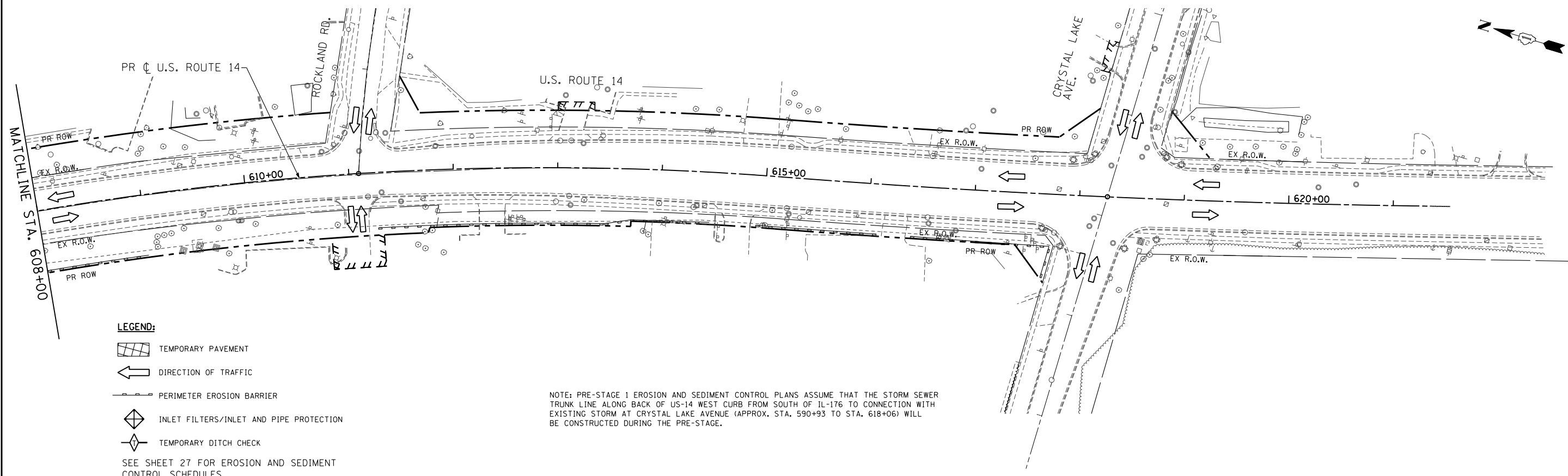



PRE-STAGE 1

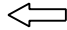
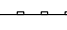

LEGEND:

-  TEMPORARY PAVEMENT
-  DIRECTION OF TRAFFIC
-  PERIMETER EROSION BARRIER
-  INLET FILTERS/INLET AND PIPE PROTECTION
-  TEMPORARY DITCH CHECK

SEE SHEET 27 FOR EROSION AND SEDIMENT CONTROL SCHEDULES

NOTE: PRE-STAGE 1 EROSION AND SEDIMENT CONTROL PLANS ASSUME THAT THE STORM SEWER TRUNK LINE ALONG BACK OF US-14 WEST CURB FROM SOUTH OF IL-176 TO CONNECTION WITH EXISTING STORM AT CRYSTAL LAKE AVENUE (APPROX. STA. 590+93 TO STA. 618+06) WILL BE CONSTRUCTED DURING THE PRE-STAGE.

FILE NAME = S:\1606\CADD Sheets\0162517-sht-ErosionPre.dgn	USER NAME = _USERNAME_	DESIGNED - AWM	REVISED -
		DRAWN - DA	REVISED -
		CHECKED - JWM	REVISED -
		DATE - 10/15/2013	REVISED -

**STATE OF ILLINOIS
DEPARTMENT OF TRANSPORTATION**

**EROSION AND SEDIMENT CONTROL PLAN
US ROUTE 14 PRE-STAGE 1**

SCALE: 1"=50' SHEET NO. 97 OF 431 SHEETS STA. 608+00 TO STA. 619+25.58

F.A. RTE.	SECTION	COUNTY	TOTAL SHEETS	SHEET NO.
305	27R-3	MCHENRY	431	97
ILLINOIS FED. AID PROJECT			CONTRACT NO. 62517	