

COLLEGE ENTR #3 STA. 11+90

McHENRY COUNTY
COLLEGE ENTRANCE #3

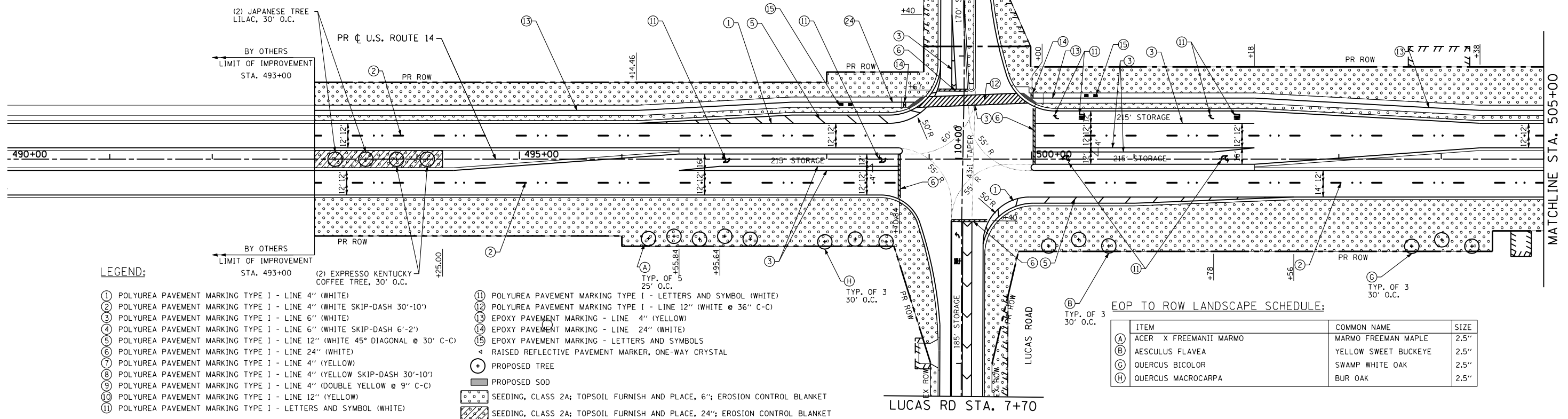

LEGEND:

- ① POLYUREA PAVEMENT MARKING TYPE I - LINE 4" (WHITE)
- ② POLYUREA PAVEMENT MARKING TYPE I - LINE 4" (WHITE SKIP-DASH 30'-10')
- ③ POLYUREA PAVEMENT MARKING TYPE I - LINE 6" (WHITE)
- ④ POLYUREA PAVEMENT MARKING TYPE I - LINE 6" (WHITE SKIP-DASH 6'-2')
- ⑤ POLYUREA PAVEMENT MARKING TYPE I - LINE 12" (WHITE 45° DIAGONAL @ 30" C-C)
- ⑥ POLYUREA PAVEMENT MARKING TYPE I - LINE 24" (WHITE)
- ⑦ POLYUREA PAVEMENT MARKING TYPE I - LINE 4" (YELLOW)
- ⑧ POLYUREA PAVEMENT MARKING TYPE I - LINE 4" (YELLOW SKIP-DASH 30'-10')
- ⑨ POLYUREA PAVEMENT MARKING TYPE I - LINE 4" (DOUBLE YELLOW @ 9" C-C)
- ⑩ POLYUREA PAVEMENT MARKING TYPE I - LINE 12" (YELLOW)
- ⑪ POLYUREA PAVEMENT MARKING TYPE I - LETTERS AND SYMBOL (WHITE)
- Ⓜ POLYUREA PAVEMENT MARKING TYPE I - LINE 12" (WHITE @ 36" C-C)
- ⑬ EPOXY PAVEMENT MARKING - LINE 4" (YELLOW)
- ⑭ EPOXY PAVEMENT MARKING - LINE 24" (WHITE)
- ⑮ EPOXY PAVEMENT MARKING - LETTERS AND SYMBOLS
- ▲ RAISED REFLECTIVE PAVEMENT MARKER, ONE-WAY CRYSTAL
- ⊕ PROPOSED TREE
- PROPOSED SOD
- ▨ SEEDING, CLASS 2A; TOPSOIL FURNISH AND PLACE, 6"; EROSION CONTROL BLANKET
- ▩ SEEDING, CLASS 2A; TOPSOIL FURNISH AND PLACE, 24"; EROSION CONTROL BLANKET

EOP TO ROW LANDSCAPE SCHEDULE:

ITEM	COMMON NAME	SIZE
(A)	ACER X FREEMANII MARMO	MARMO FREEMAN MAPLE 2.5"
(B)	AESCULUS FLAVEA	YELLOW SWEET BUCKEYE 2.5"
(C)	QUERCUS BICOLOR	SWAMP WHITE OAK 2.5"
(H)	QUERCUS MACROCARPA	BUR OAK 2.5"

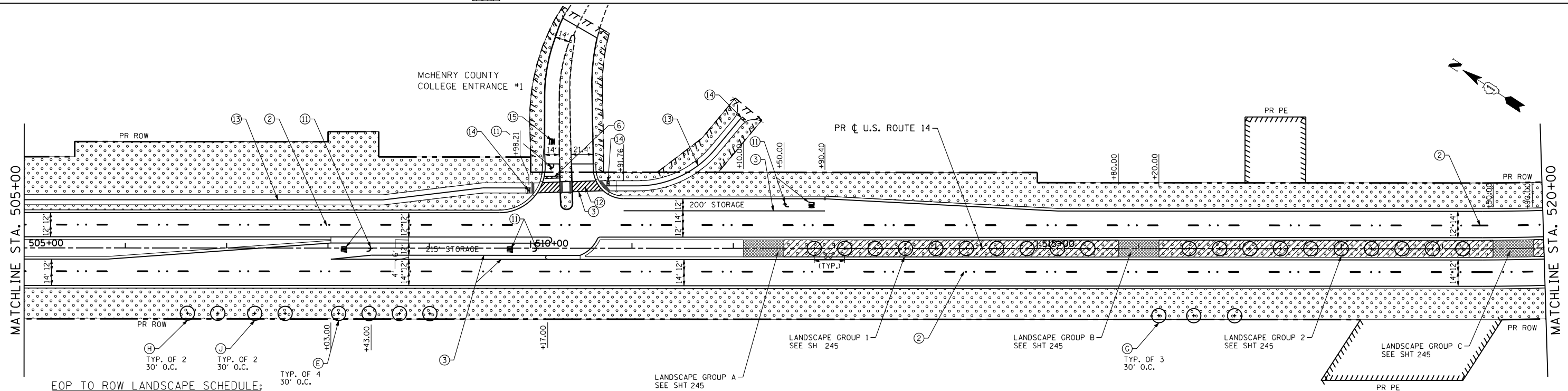

EOP TO ROW LANDSCAPE SCHEDULE:

ITEM	COMMON NAME	SIZE
(E)	GLEDITSIA TRIACANTHOS INERMIS SHADEMASTER	SHADEMASTER HONEYLOCUST 2"
(C)	QUERCUS BICOLOR	SWAMP WHITE OAK 2.5"
(H)	QUERCUS MACROCARPA	BUR OAK 2.5"
(J)	QUERCUS X MACDANIELLI CLEMONS	HERITAGE OAK 2"

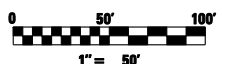

FILE NAME =	USER NAME = .USERNAME.	DESIGNED - JPW	REVISED -
S:\1606\CADD Sheets\0162517-sht-pmk.dgn		DRAWN - MM	REVISED -
		CHECKED - MGZ	REVISED -
		DATE - 10/15/2013	REVISED -

STATE OF ILLINOIS
DEPARTMENT OF TRANSPORTATION

PAVEMENT MARKING AND LANDSCAPING PLAN
US ROUTE 14

SCALE: 1"=50' SHEET NO. 238 OF 431 SHEETS STA. 490+00.00 TO STA. 520+00.00

F.A.P. RTE.	SECTION	COUNTY	TOTAL SHEETS	SHEET NO.
305	27R-3	MCHENRY	431	238
CONTRACT NO. 62517			ILLINOIS FED. AID PROJECT	