

ORIGINAL SURVEY	SURVEYED	BY	DATE
NOTE BOOK	PLOTTED		
	TEMPLATE		
	AREAS		
	CHECKED		

FINAL SURVEY	SURVEYED	BY	DATE
NOTE BOOK	PLOTTED		
	TEMPLATE		
	AREAS		
	CHECKED		

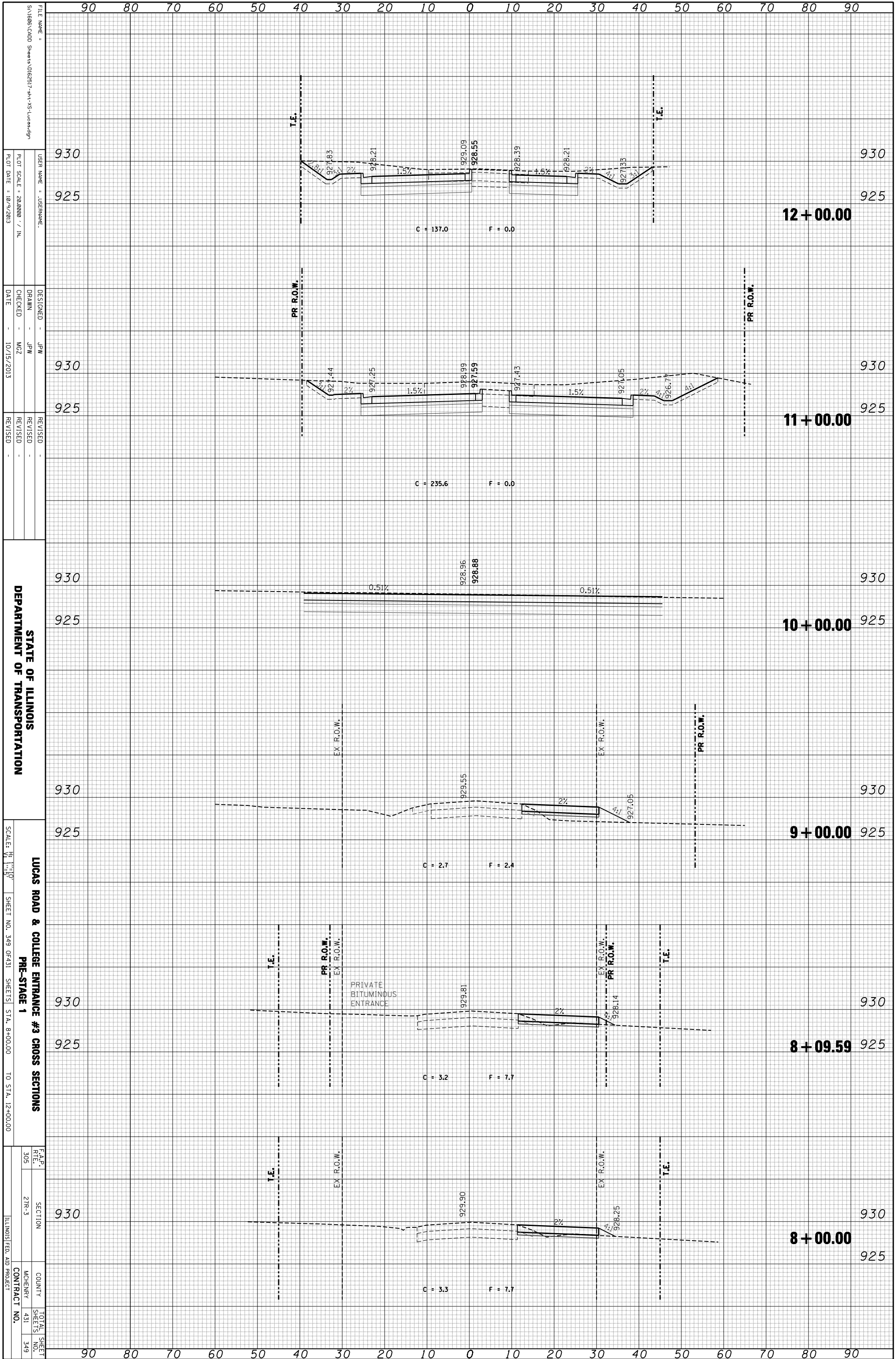

FILE NAME = S:\1606\CADD Sheets\0162517-1\1-VS-Lucas.dgn
 USER NAME = JPM
 DESIGNER = JPM
 DRAWN = JPM
 CHECKED = MZ
 DATE = 10/15/2013
 REVISIONS:

STATE OF ILLINOIS
 DEPARTMENT OF TRANSPORTATION

LUCAS ROAD & COLLEGE ENTRANCE #3 CROSS SECTIONS
 PRE-STAGE 1
 SCALE: 1" = 10'
 SHEET NO. 349 OF 431 SHEETS STA. 8+00.00 TO STA. 12+00.00

F.A.P. R.T.E.	SECTION	COUNTY	TOTAL SHEETS
305	21R-3	MCHEMERY	349
CONTRACT NO.		ILLINOIS FED. AID PROJECT	