

ORIGINAL SURVEY	SURVEYED	BY	DATE
NOTE BOOK	PLOTTED		
	TEMPLATE		
	AREAS		
	CHECKED		

FINAL SURVEY	SURVEYED	BY	DATE
NOTE BOOK	PLOTTED		
	TEMPLATE		
	AREAS		
	CHECKED		

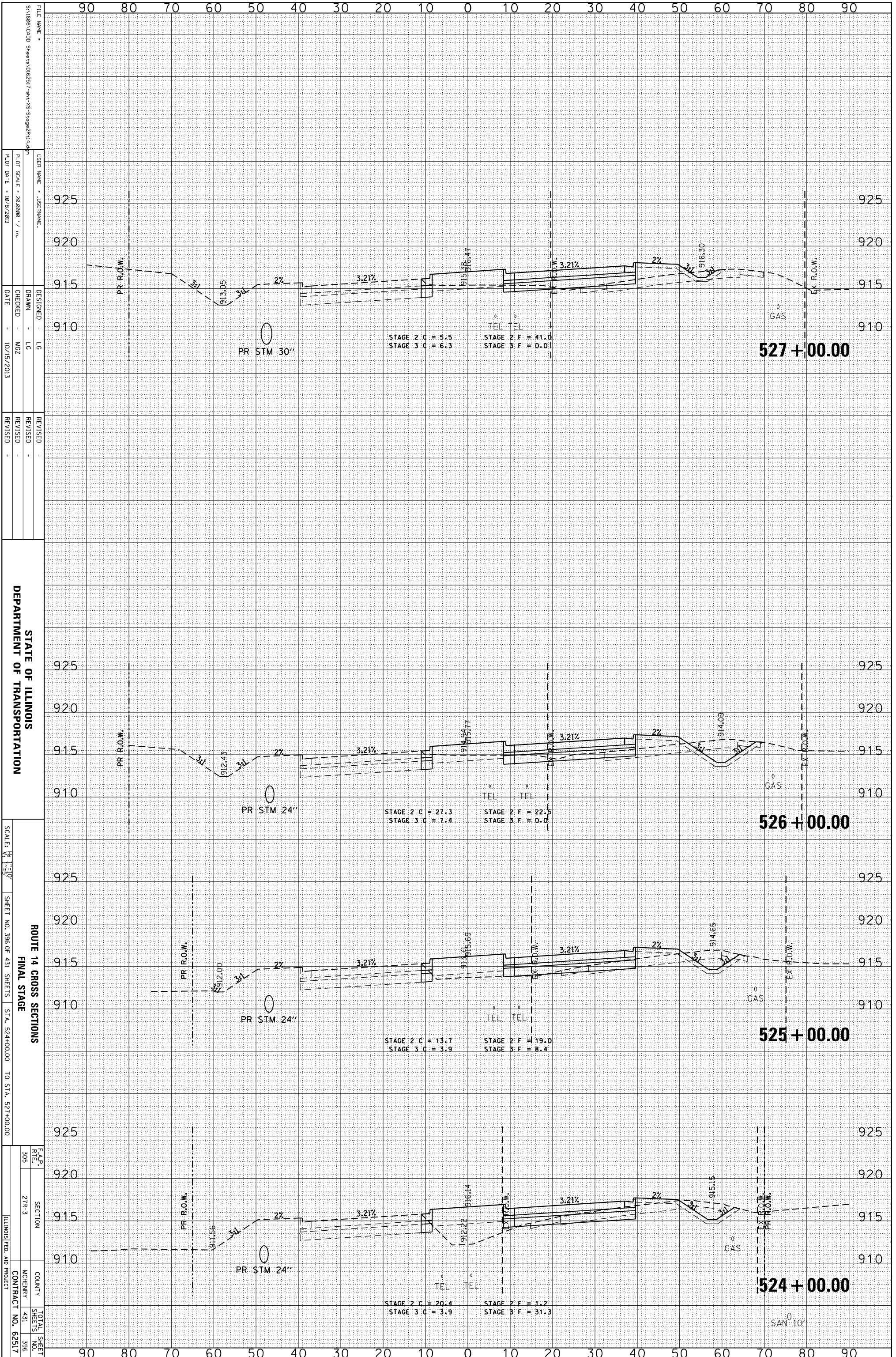

STATE OF ILLINOIS
DEPARTMENT OF TRANSPORTATION

ROUTE 14 CROSS SECTIONS
FINAL STAGE
SHEET NO. 396 OF 431 SHEETS STA. 524+00.00 TO STA. 527+00.00

F.A.P. R.T.E.	SECTION	COUNTY	TOTAL SHEETS NO.
305	27R-3	MCHEMERY	396
ILLINOIS FED. AID PROJECT		CONTRACT NO.	62517

FILE NAME =	USER NAME =	DESIGNED -	REVISION
S:\1606\CADD Sheets\062517-rt-14-SS-Stage2R14.dwg	JUSEPHNAME	LG	
		DRAWN -	REVISION
		LG	
		CHECKED -	REVISION
		MZ	
		DATE -	
		10/15/2013	

PLLOT SCALE = 28,0000 / in.
PLLOT DATE = 10/9/2013