

ORIGINAL SURVEY	SURVEYED	BY	DATE
NOTE BOOK	PLOTTED		
	TEMPLATE		
	AREAS		
	CHECKED		

FINAL SURVEY	SURVEYED	BY	DATE
NOTE BOOK	PLOTTED		
	TEMPLATE		
	AREAS		
	CHECKED		

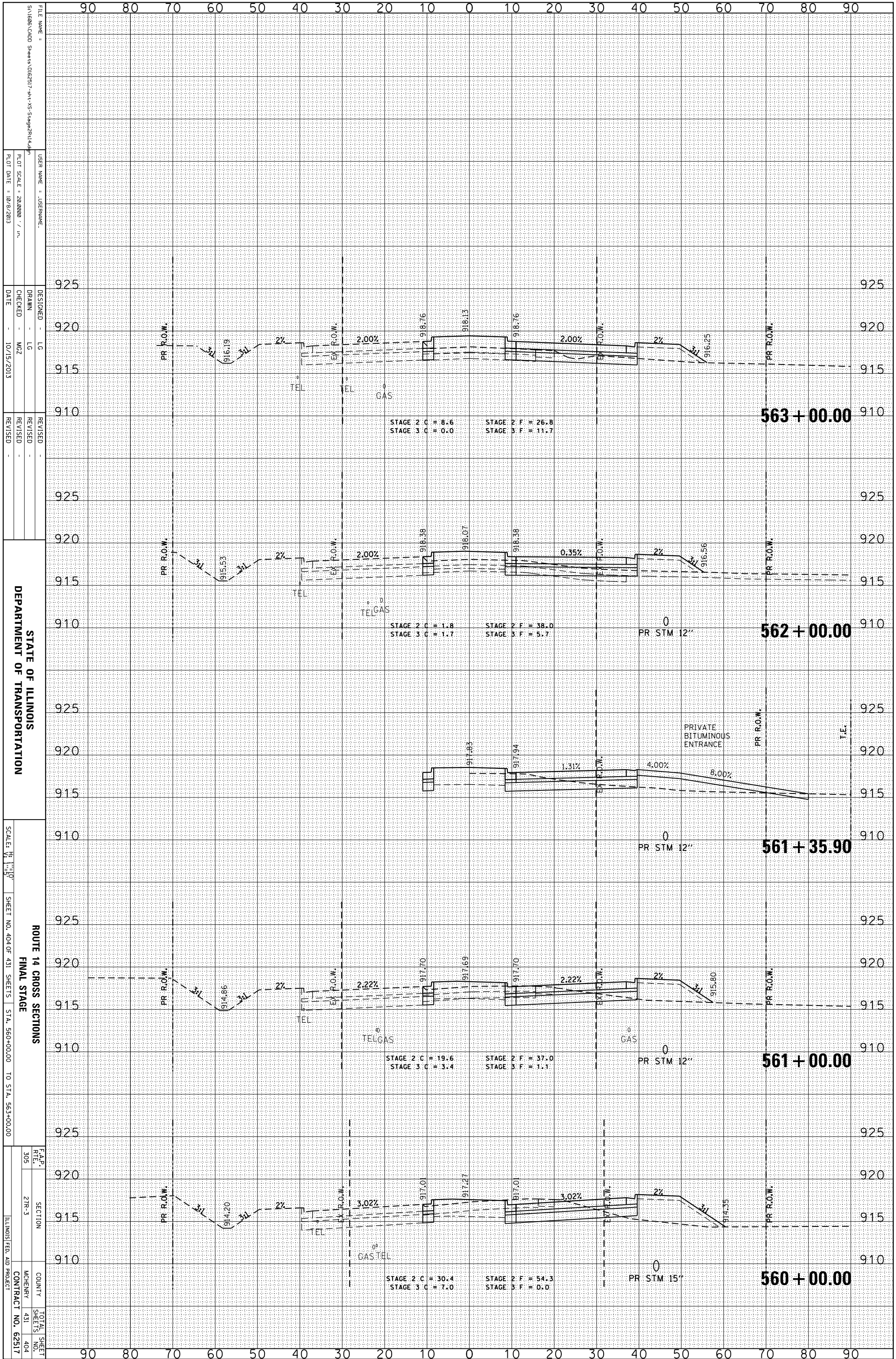

STATE OF ILLINOIS  
DEPARTMENT OF TRANSPORTATION

ROUTE 14 CROSS SECTIONS  
FINAL STAGE

F.A.P. SECTION COUNTY TOTAL SHEET NO. 62517  
RTE. 305 SECTION 27R-3 MCHENRY 431 404  
SCALE: 1" = 50'  
SHEET NO. 404 OF 431 SHEETS STA. 560+00.00 TO STA. 563+00.00  
ILLINOIS FED. AID PROJECT

FILE NAME: S:\1606\CADD Sheets\062517-rt-14-15-Stage2R14.dgn  
USER NAME: JUSEPHNAME  
DESIGNED: LG  
DRAWN: LG  
CHECKED: MZ  
DATE: 10/15/2013  
REVISIONS:

PLLOT SCALE: 28,0000 / in.  
PLOT DATE: 10/16/2013