

**STATE OF ILLINOIS**  
**DEPARTMENT OF TRANSPORTATION**  
**DIVISION OF HIGHWAYS**  
**PROPOSED**  
**HIGHWAY PLANS**

F.A.P. RTE.	SECTION	COUNTY	TOTAL SHEETS	SHEET NO.
330	(15)RS-5	KANKAKEE	31	1
		ILLINOIS	CONTRACT NO. 66427	

INDEX OF SHEETS

- 1 COVER SHEET
- 2 GENERAL NOTES
- 3-6 SUMMARY OF QUANTITIES
- 7-8 TYPICAL SECTIONS
- 9-11 SCHEDULE OF QUANTITIES
- 12-20 PAVEMENT MARKING
- 21-28 LOOP DETECTOR DETAILS
- 29-31 DETAILS

LIST OF ILLINOIS DOT HIGHWAY STANDARDS

- 000001-06 STANDARD SYMBOLS, ABBREVIATIONS AND PATTERNS
- 001006 DECIMAL OF AN INCH AND OF A FOOT
- 424001-07 PERPENDICULAR CURB RAMPS FOR SIDEWALKS
- 424006-01 DIAGONAL CURB RAMPS FOR SIDEWALKS
- 424011-01 CORNER PARALLEL CURB RAMPS FOR SIDEWALKS
- 424016-01 MID-BLOCK CURB RAMPS FOR SIDEWALKS
- 424021-02 DEPRESSED CORNER FOR SIDEWALKS
- 424028-01 ENTRANCE / ALLEY PEDESTRIAN CROSSINGS
- 424031-01 MEDIAN PEDESTRIAN CROSSINGS
- 606001-05 CONCRETE CURB TYPE B AND COMBINATION CONCRETE CURB AND GUTTER
- 667101-02 PERMANENT SURVEY MARKERS
- 701306-03 LANE CLOSURE, 2L, 2W, SLOW MOVING OPERATIONS DAY ONLY, FOR SPEEDS ≥ 45 MPH
- 701311-03 LANE CLOSURE, 2L, 2W, MOVING OPERATIONS - DAY ONLY
- 701421-06 LANE CLOSURE, MULTILANE, DAY OPERATIONS ONLY, FOR SPEEDS ≥ 45 MPH TO 55 MPH
- 701501-06 URBAN LANE CLOSURE, 2L, 2W, UNDIVIDED
- 701602-07 URBAN LANE CLOSURE, MULTILANE, 2W WITH BIDIRECTIONAL LEFT TURN LANE
- 701701-09 URBAN LANE CLOSURE, MULTILANE INTERSECTION
- 701901-03 TRAFFIC CONTROL DEVICES
- 780001-04 TYPICAL PAVEMENT MARKINGS
- 781001-03 TYPICAL APPLICATIONS RAISED REFLECTIVE PAVEMENT MARKERS
- 886001-01 DETECTOR LOOP INSTALLATIONS
- 886008-01 TYPICAL LAYOUT FOR DETECTION LOOPS

**FAP ROUTE 330 (US 45/52)**  
**SECTION (15)RS-5**

**3P MILLING AND RESURFACING**  
**KANKAKEE COUNTY**

C-93-029-04

**NORTH OF ARMOUR ROAD**  
**TO SOUTH OF INDIAN OAKS /ST. GEORGE ROAD**

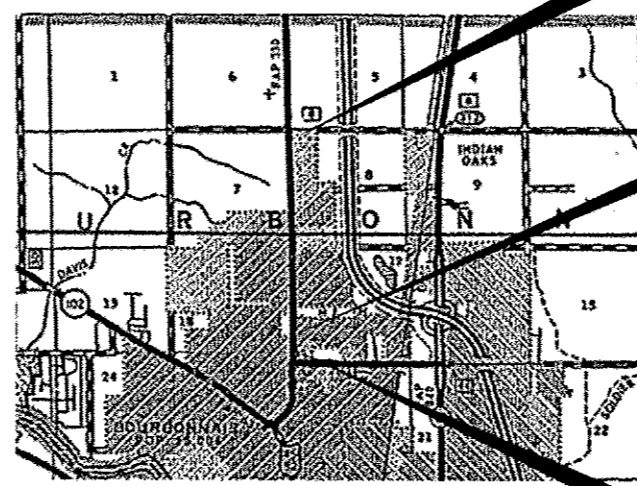
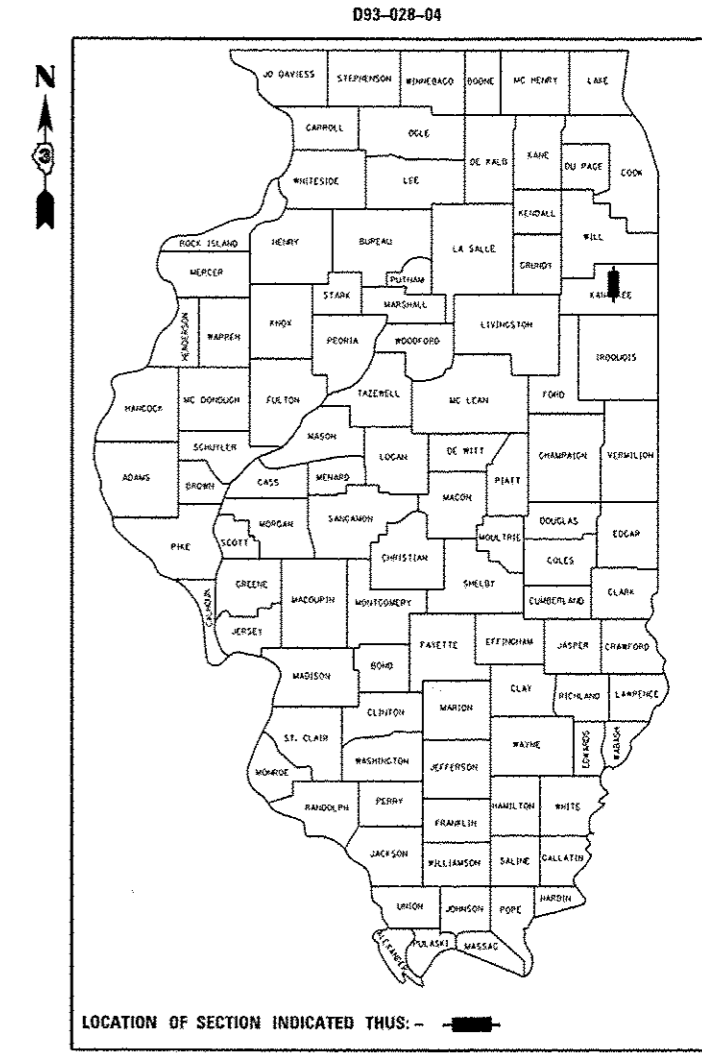

**PROJECT ENDS**  
**STA. 224 + 50**

**OMISSION**  
**JOHN CASEY RD**  
**STA 127+25 TO 134+00**

**PROJECT BEGINS**  
**STA. 123 + 82.78**

**LOCATION MAP**

GROSS LENGTH = 10,067.22 FEET = 1.907 MILES  
 NET LENGTH = 9392.22 FEET = 1.779 MILES

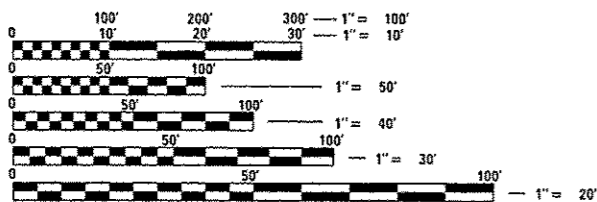

FULL SIZE PLANS HAVE BEEN PREPARED USING STANDARD ENGINEERING SCALES. REDUCED SIZED PLANS WILL NOT CONFORM TO STANDARD SCALES. IN MAKING MEASUREMENTS ON REDUCED PLANS, THE ABOVE SCALES MAY BE USED.

J.U.L.I.E.  
 JOINT UTILITY LOCATION INFORMATION FOR EXCAVATION  
 1-800-892-0123  
 OR 811

**PROJECT ENGINEER: JOE KANNEL, PE**  
**UNIT CHIEF: MICHELE LINDEMANN, PE**

**CONTRACT NO. 66427**

**PRINCIPAL ARTERIAL URBAN**  
 2013 ADT = 24,600  
 P.V. = 93.4% S.U. = 4.9% M.U. = 1.7%

STATE OF ILLINOIS  
 DEPARTMENT OF TRANSPORTATION  
 DIVISION OF HIGHWAYS

SUBMITTED June 6 20 14  
Paul Coete, P.E.  
 DEPUTY DIRECTOR OF HIGHWAYS, REGION ENGINEER

June 27 20 14  
John D. Baranzelli, P.E.  
 ENGINEER OF DESIGN AND ENVIRONMENT

June 27 20 14  
Omer Osman, P.E.  
 DIRECTOR OF HIGHWAYS, CHIEF ENGINEER

**PRINTED BY THE AUTHORITY**  
**OF THE STATE OF ILLINOIS**

**GENERAL NOTES**

THE THICKNESS OF HMA SHOWN ON THE PLANS IS THE NOMINAL THICKNESS. DEVIATIONS FROM THE NOMINAL THICKNESS WILL BE PERMITTED WHEN SUCH DEVIATIONS OCCUR DUE TO IRREGULARITIES IN THE EXISTING SURFACE OR BASE ON WHICH THE HMA IS PLACED.

THE HMA SURFACE OF ALL MAILBOX TURNOUTS, PRIVATE ENTRANCES, COMMERCIAL ENTRANCES, AND SIDE ROADS SHALL BE MADE NEATLY, IN A WORKMANLIKE MANNER, AND SHALL ACCURATELY CONFORM TO THE SHAPES AND DIMENSIONS SHOWN ON THE PLAN DETAILS. IF REQUIRED BY THE ENGINEER, THE CONTRACTOR SHALL SAW CUT THE HMA SURFACE TO CONFORM TO THE SHAPES AND DIMENSIONS SHOWN ON THE PLAN DETAILS. THIS WORK WILL BE INCLUDED IN THE COST OF THE HMA SURFACE.

THE ENGINEER WILL BE THE SOLE JUDGE CONCERNING CURING TIME FOR THE VARIOUS HMA LIFTS.

ALL EXCAVATED MATERIAL, WHICH INCLUDES DIGGING OR GRADING OF ANY SOIL OR FILL MATERIAL, WITH THE EXCEPTION OF AGGREGATE FILLS, MUST BE INCORPORATED WITHIN THE IDOT RIGHT OF WAY DUE TO ENVIRONMENTAL DOCUMENTATION REQUIREMENTS.

DETECTABLE WARNING SURFACES SHALL EXTEND 2.0 FT MINIMUM IN THE DIRECTION OF PEDESTRIAN TRAVEL. AT CURB RAMPS AND BLENDED TRANSITIONS, DETECTABLE WARNING SURFACES SHALL EXTEND THE FULL WIDTH OF THE RAMP RUN (EXCLUDING ANY FLARES) OR BLENDED TRANSITIONS. SOME DETECTABLE WARNING PRODUCTS REQUIRE A CONCRETE BORDER FOR PROPER INSTALLATION. THE CONCRETE BORDER SHALL NOT EXCEED 2 INCHES.

ON EXISTING PAVEMENT WHICH MAY BE SUPERELEVATED, THE NEW HMA PAVEMENT SHALL BE BUILT WITH THE SAME SUPERELEVATION UNLESS NEW SUPERELEVATION RATES ARE GIVEN ON THE PLANS.

ANY REFERENCE TO A STANDARD IN THESE PLANS SHALL BE INTERPRETED TO MEAN THE EDITION AS INDICATED BY THE SUBNUMBER SHOWN IN THE LIST OF STANDARDS OR THE COPY INCLUDED IN THESE PLANS.

THE FOLLOWING RATES OF APPLICATION HAVE BEEN USED IN CALCULATING PLAN QUANTITIES:

GRANULAR MATERIALS	2.05	TONS / CU YD
HMA RESURFACING	112	LBS / SQ YD / IN
SHORT TERM PAVEMENT MARKING	10	FT / 100 FT OF APPLICATION
MIX FOR CRACKS, JTS & FLGWYS	0.0003	TONS / SQ YD
LEVEL BINDER (HAND METHOD)	0.0005	TONS / SQ YD
SUPPLEMENTAL WATERING	3	GAL / SQ YD / APPLICATION
CALCIUM CHLORIDE	2	LB / SQ YD / APPLICATION
AGGREGATE DITCH CHECKS	5	TONS AGGREGATE

THE CONTRACTOR SHALL CONTACT JULIE AT LEAST 48 HOURS PRIOR TO EXCAVATION TO DETERMINE WHICH UTILITIES ARE IN THE AREA.

STATE OF ILLINOIS  
DEPARTMENT OF TRANSPORTATION  
DISTRICT THREE

PREPARED BY: *Don Bronil*  
DISTRICT STUDIES & PLANS ENGINEER

DATE: 6-6-14

EXAMINED BY: *Wayne L. Phillips*  
DISTRICT CONSTRUCTION ENGINEER

*Wayne L. Phillips*  
DISTRICT MATERIALS ENGINEER

*Bruce A. Hecker*  
DISTRICT OPERATIONS ENGINEER

FILE NAME =	USER NAME = carpentardj	DESIGNED -	REVISED -	<b>STATE OF ILLINOIS DEPARTMENT OF TRANSPORTATION</b>	<b>GENERAL NOTES</b>	F.A.P. RTE.	SECTION	COUNTY	TOTAL SHEETS	SHEET NO.	
c:\pwork\p\dot\carpentardj\dms82592\	OVERSHT.DGN	DRAWN -	REVISED -			330	(15)RS-5	KANKAKEE	31	2	
Default	PLOT SCALE = 100.0000' / in.	CHECKED -	REVISED -			SCALE: SHEET OF SHEETS STA. TO STA.					
	PLOT DATE = 6/6/2014	DATE -	REVISED -			[ILLINOIS] FED. AID PROJECT CONTRACT NO. 66427					

CODE NO.	ITEM	UNIT	TOTAL QUANTITY	CONSTR. CODE
				100% STATE
				ROADWAY
				0005
				URBAN
40600400	MIXTURE FOR CRACKS, JOINTS, AND FLANGEWAYS	TON	16	16
40600735	POLYMERIZED LEVELING BINDER (HAND METHOD), N70	TON	273	273
40600839	POLYMERIZED LEVELING BINDER (MACHINE METHOD), IL-9.5FG, N70	TON	2146	2146
40600990	TEMPORARY RAMP	SQ YD	962	962
40603545	POLYMERIZED HOT-MIX ASPHALT SURFACE COURSE, MIX "D", N90	TON	4286	4286
40800050	INCIDENTAL HOT-MIX ASPHALT SURFACING	TON	512	512
42400100	PORTLAND CEMENT CONCRETE SIDEWALK 4 INCH	SQ FT	1822	1822
42400800	DETECTABLE WARNINGS	SQ FT	370	370
44000158	HOT-MIX ASPHALT SURFACE REMOVAL, 2 1/4"	SQ YD	58643	58643
44000500	COMBINATION CURB AND GUTTER REMOVAL	FOOT	21	21
44000600	SIDEWALK REMOVAL	SQ FT	1763	1763
48101200	AGGREGATE SHOULDERS, TYPE B	TON	491	491
48203100	HOT-MIX ASPHALT SHOULDERS	TON	450	450
60255500	MANHOLES TO BE ADJUSTED	EACH	2	2

• SPECIALTY ITEMS

FILE NAME *	USER NAME * carpanterdj	DESIGNED -	REVISED -	<b>STATE OF ILLINOIS DEPARTMENT OF TRANSPORTATION</b>	<b>SUMMARY OF QUANTITIES</b>				F.A.P. RTE.	SECTION	COUNTY	TOTAL SHEETS	SHEET NO.
c:\pwork\pwork\carpanterdj\dms02592	summary.dgn	DRAWN -	REVISED -		330	150RS-5	KANKAKEE	31	3				
	PLOT SCALE * 1/8" = 1' / in.	CHECKED -	REVISED -		SCALE: SHEET OF SHEETS STA. TO STA.				CONTRACT NO. 66427				
#MODELNAME*	PLOT DATE * 6/6/2014	DATE -	REVISED -		ILLINOIS FED. AID PROJECT								

CODE NO.	ITEM	UNIT	TOTAL QUANTITY	CONSTR. CODE
				100% STATE
				ROADWAY
				0005
				URBAN
60605000	COMBINATION CONCRETE CURB AND CUTTER, TYPE B-6.24	FOOT	21	21
66700205	PERMANENT SURVEY MARKERS, TYPE I	EACH	5	5
67100100	MOBILIZATION	L SUM	1	1
70100310	TRAFFIC CONTROL AND PROTECTION, STANDARD 701421	L SUM	1	1
70100460	TRAFFIC CONTROL AND PROTECTION, STANDARD 701306	L SUM	1	1
70102620	TRAFFIC CONTROL AND PROTECTION, STANDARD 701501	L SUM	1	1
70102632	TRAFFIC CONTROL AND PROTECTION, STANDARD 701602	L SUM	1	1
70102635	TRAFFIC CONTROL AND PROTECTION, STANDARD 701701	L SUM	1	1
70300100	SHORT TERM PAVEMENT MARKING	FOOT	8620	8620
70300210	TEMPORARY PAVEMENT MARKING LETTERS AND SYMBOLS	SQ FT	1132	1132
70300220	TEMPORARY PAVEMENT MARKING - LINE 4"	FOOT	26789	26789
70300240	TEMPORARY PAVEMENT MARKING - LINE 6"	FOOT	5663	5663
70300250	TEMPORARY PAVEMENT MARKING - LINE 8"	FOOT	3836	3836
70300260	TEMPORARY PAVEMENT MARKING - LINE 12"	FOOT	3818	3818

\* SPECIALTY ITEMS

FILE NAME =	USER NAME = carpenterdj	DESIGNED -	REVISED -	<b>STATE OF ILLINOIS DEPARTMENT OF TRANSPORTATION</b>	<b>SUMMARY OF QUANTITIES</b>				F.A.P. RTE.	SECTION	COUNTY	TOTAL SHEETS	SHEET NO.
et:\p4\work\pavdot\carpenterdj\dms82592\summary.dgn	DRAWN -	REVISED -	330						(15)RS-5	KANKAKEE	31	4	
PLOT SCALE = 100.0000 1/1 in.	CHECKED -	REVISED -	SCALE: SHEET OF SHEETS STA. TO STA.					CONTRACT NO. 66427					
PLOT DATE = 6/6/2014	DATE -	REVISED -	ILLINOIS FED. AID PROJECT										

CODE NO.	ITEM	UNIT	TOTAL QUANTITY	CONSTR. CODE
				100% STATE
				ROADWAY 0005 URBAN
70300280	TEMPORARY PAVEMENT MARKING - LINE 24"	FOOT	643	643
70301000	WORK ZONE PAVEMENT MARKING REMOVAL	SO FT	1436	1436
78000100	THERMOPLASTIC PAVEMENT MARKING - LETTERS AND SYMBOLS	SO FT	1132	1132
78000200	THERMOPLASTIC PAVEMENT MARKING - LINE 4"	FOOT	24612	24612
78000400	THERMOPLASTIC PAVEMENT MARKING - LINE 6"	FOOT	3518	3518
78000500	THERMOPLASTIC PAVEMENT MARKING - LINE 8"	FOOT	3836	3836
78000600	THERMOPLASTIC PAVEMENT MARKING - LINE 12"	FOOT	3818	3818
78000650	THERMOPLASTIC PAVEMENT MARKING - LINE 24"	FOOT	643	643
78003130	PREFORMED PLASTIC PAVEMENT MARKING, TYPE B - LINE 6"	FOOT	2145	2145
78100100	RAISED REFLECTIVE PAVEMENT MARKER	EACH	633	633
78300200	RAISED REFLECTIVE PAVEMENT MARKER REMOVAL	EACH	593	593
88600100	DETECTOR LOOP, TYPE I	FOOT	6471	6471
X4060110	BITUMINOUS MATERIALS (PRIME COAT)	POUND	39586	39586
X7830074	GROOVING FOR RECESSED PAVEMENT MARKING 7"	FOOT	2145	2145

\* SPECIALTY ITEMS

FILE NAME =	USER NAME = oerpentardj	DESIGNED -	REVISED -	<b>STATE OF ILLINOIS DEPARTMENT OF TRANSPORTATION</b>	<b>SUMMARY OF QUANTITIES</b>				F.A.P. RTE.	SECTION	COUNTY	TOTAL SHEETS	SHEET NO.
o:\pav_work\pav\dot\carpentardj\dms82592\summary.dgn	DRAWN -	REVISED -	330						15/RS-5	KANKAKEE	31	5	
PLOT SCALE = 100,0000 1/1 in.	CHECKED -	REVISED -	SCALE: SHEET OF SHEETS STA. TO STA.					CONTRACT NO. 66427					
MODELNAME#	DATE -	REVISED -	ILLINOIS FED. AID PROJECT										

CODE NO.	ITEM	UNIT	TOTAL QUANTITY	CONSTR. CODE	
				ROADWAY 0005	URBAN
X7830076	GROOVING FOR RECESSED PAVEMENT MARKING 9"	FOOT	3524	3524	
X7830090	GROOVING FOR RECESSED PAVEMENT MARKING 25"	FOOT	643	643	
X8860100	LOOP DETECTOR TESTING	EACH	5	5	
Z0030850	TEMPORARY INFORMATION SIGNING	SQ FT	42	42	
Z0034105	MATERIAL TRANSFER DEVICE	TON	6385	6385	

• SPECIALTY ITEMS

FILE NAME =	USER NAME = aarpentardj	DESIGNED -	REVISED -	<b>STATE OF ILLINOIS DEPARTMENT OF TRANSPORTATION</b>	<b>SUMMARY OF QUANTITIES</b>	F.A.P. RTE.	SECTION	COUNTY	TOTAL SHEETS	SHEET NO.	
c:\p\work\p\104\carpentardj\dms02592	summary.dgn	DRAWN -	REVISED -			330	(ISRS-5)	KANKAKEE	31	6	
Default	PLOT SCALE = 1/8" = 1' / 1/4"	CHECKED -	REVISED -			CONTRACT NO. 66427					
	PLOT DATE = 8/9/2014	DATE -	REVISED -			SCALE:	SHEET	OF	SHEETS	STA.	TO STA.

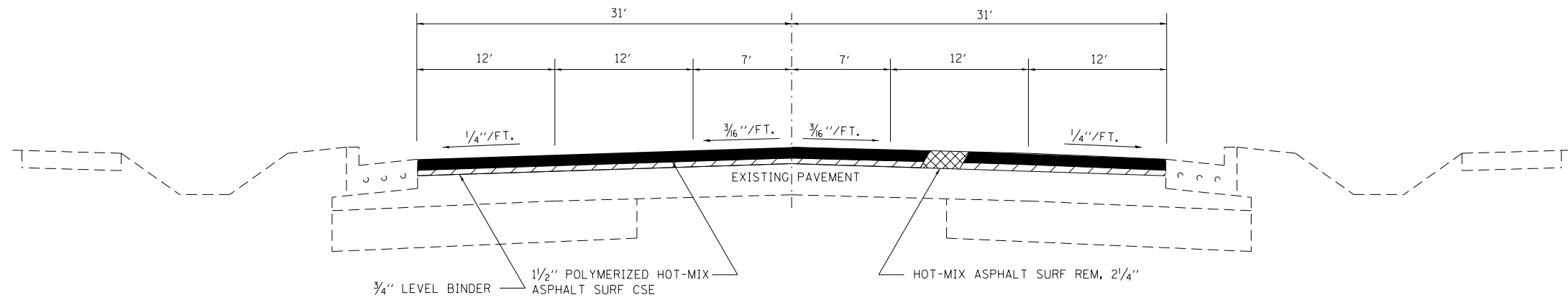

**PROPOSED TYPICAL 1**

STA. 123+82.78 TO 127+25  
STA. 134+00 TO 177+90

**OMISSION  
JOHN CASEY RD  
127+25 TO 134+00**

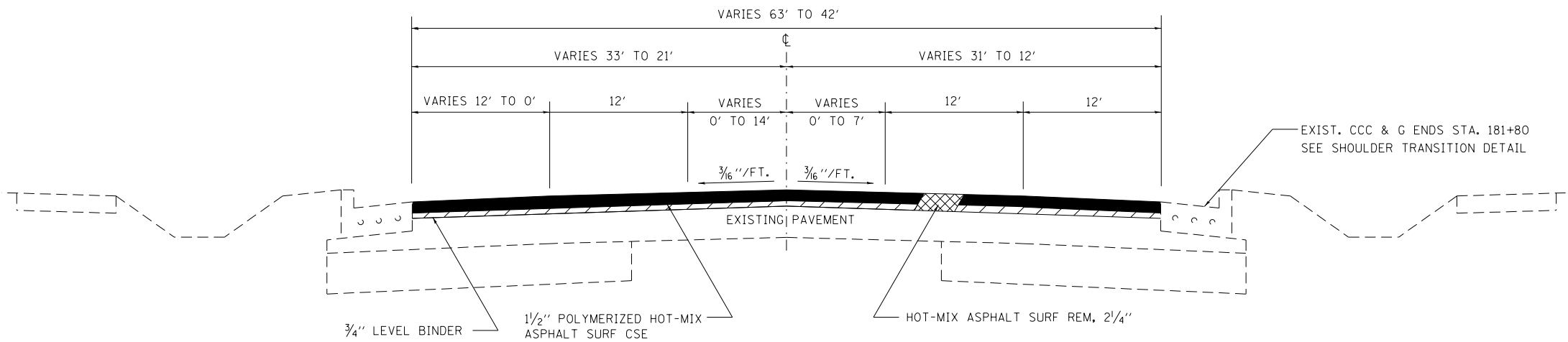

**PROPOSED TYPICAL 2**

STA. 177+90 TO 187+81

EXIST. CCC & G ENDS STA. 181+80  
SEE SHOULDER TRANSITION DETAIL

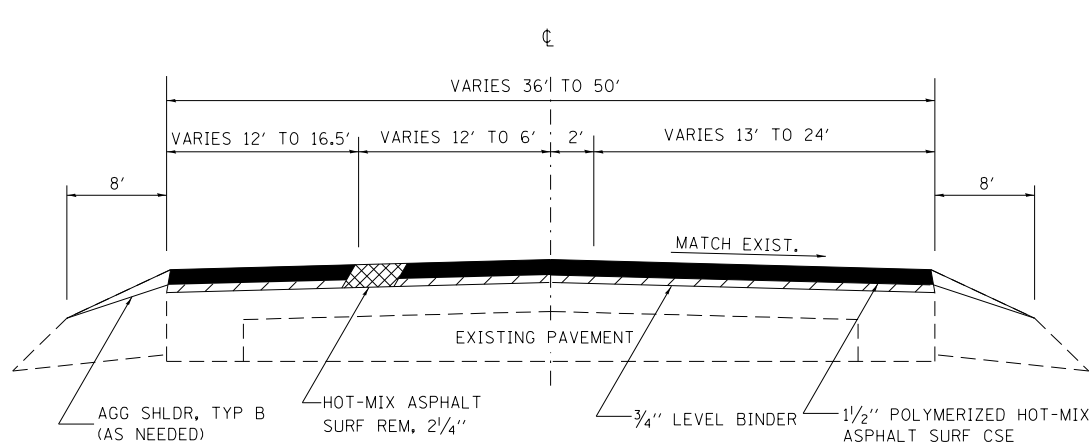

**PROPOSED TYPICAL 3**

STA. 187+81 TO 189+90

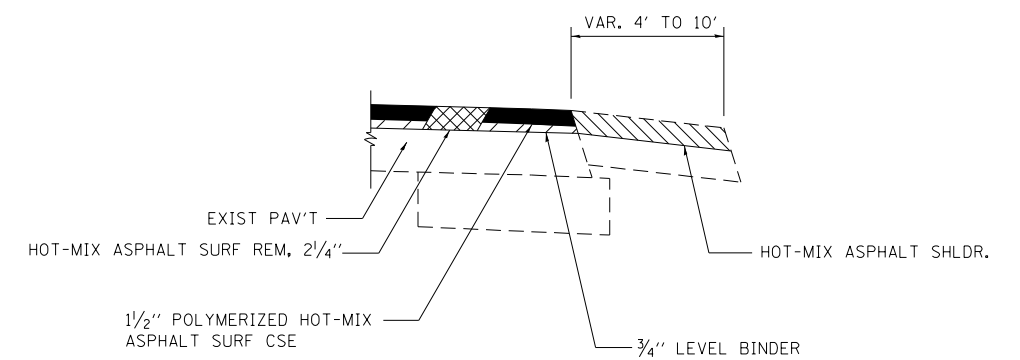

**SHOULDER TRANSITION DETAIL**

STA. 181+80 TO 185+50

FILE NAME =	USER NAME = carpenterdj	DESIGNED -	REVISED -
ci:\pwork\pwork\carpenterdj\dms82592\	sheets.dgn	DRAWN -	REVISED -
Default	PLOT SCALE = 40.0000' / in.	CHECKED -	REVISED -
	PLOT DATE = 6/6/2014	DATE -	REVISED -

**STATE OF ILLINOIS  
DEPARTMENT OF TRANSPORTATION**

**TYPICAL SECTIONS**

SCALE: SHEET OF SHEETS STA. TO STA.

F.A.P. RTE.	SECTION	COUNTY	TOTAL SHEETS	SHEET NO.
330	(15)RS-5	KANKAKEE	31	7
CONTRACT NO. 66427			ILLINOIS FED. AID PROJECT	

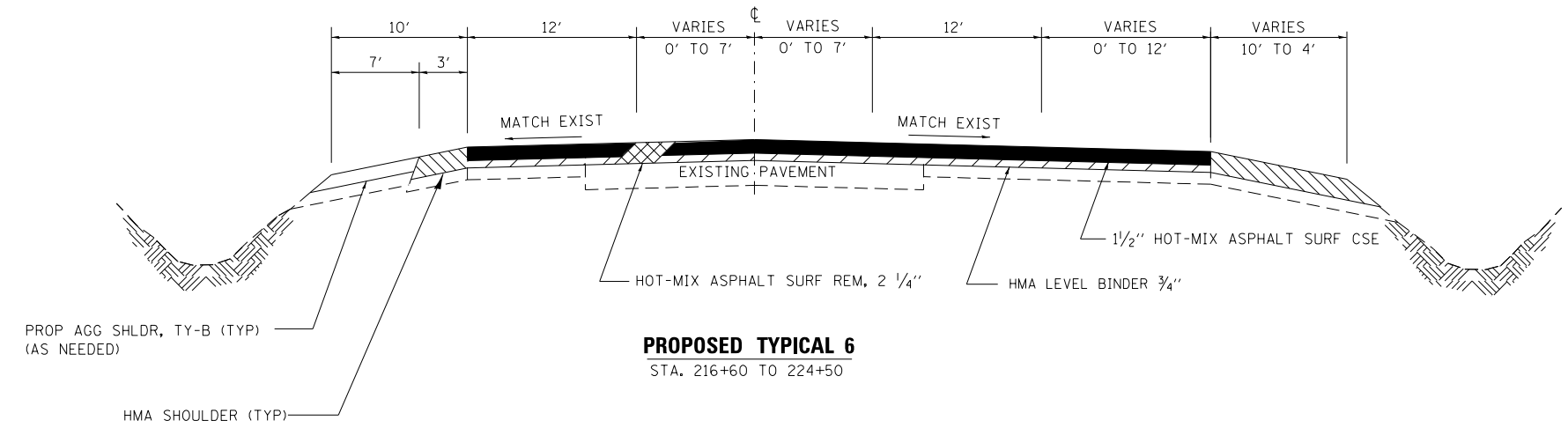
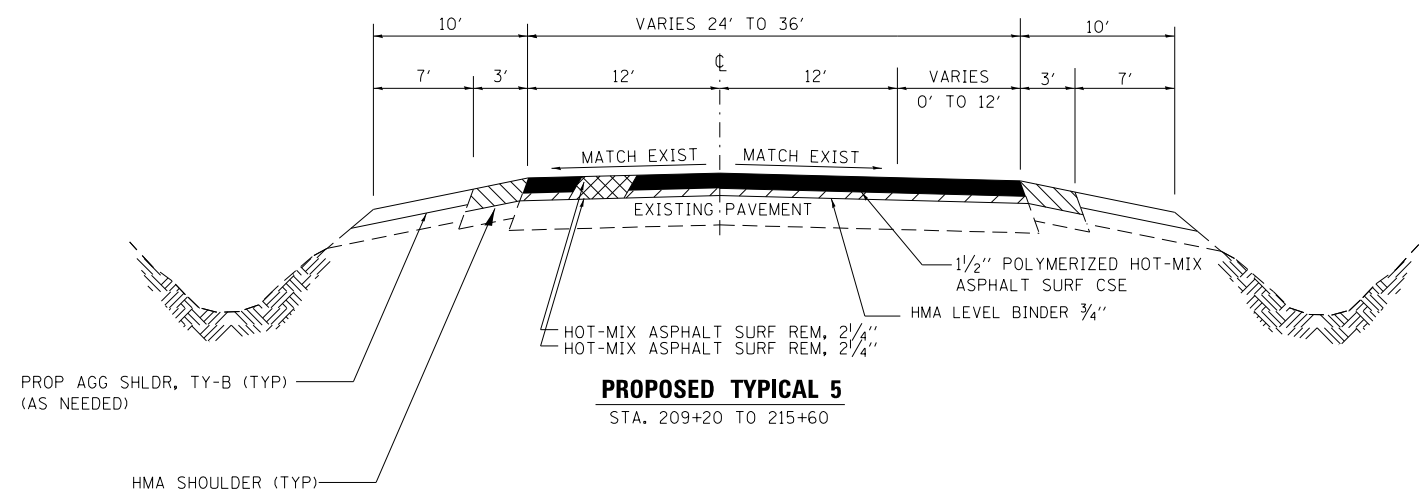
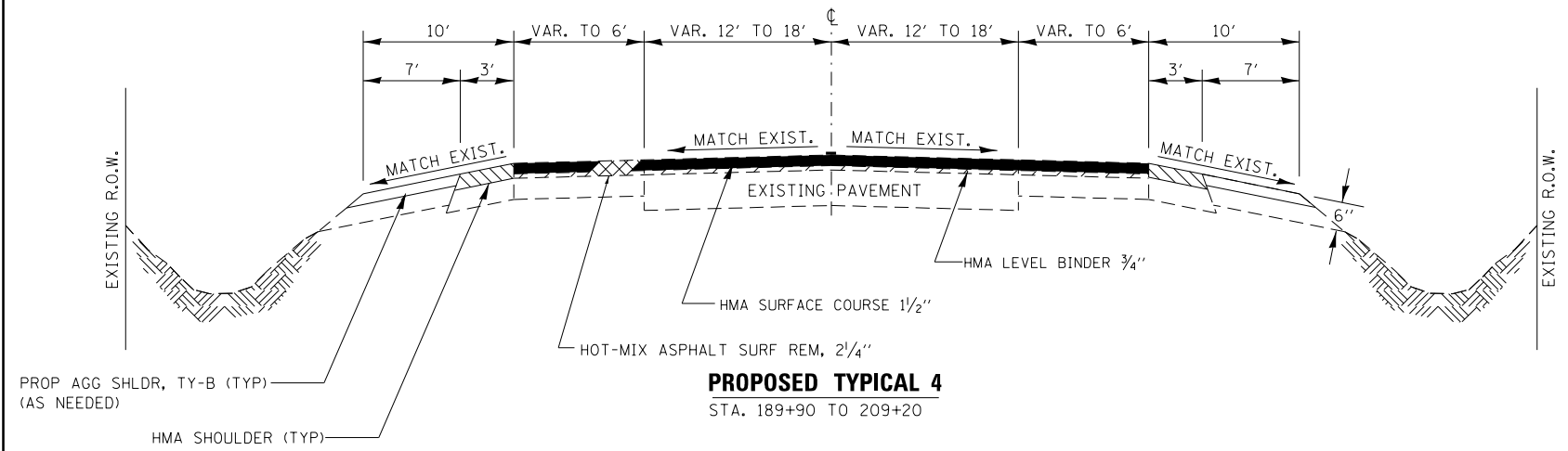

MIX DESIGN					
MIX	PG GRADE	DESIGN AIR Voids	MIX COMPOSITION	FRICTION AGG	DENSITY CONTROL
POLYMERIZED SURFACE	SBS PG 70-22	4.0% @N90	IL 9.5	MIXTURE D	CORRELATION
POLYMERIZED LEVEL BINDER	SBS PG 70-22	4.0% @N70	IL 9.5 FG		CORRELATION
HMA SHOULDER	PG 64-22	4.0% @N50	IL 9.5	MIXTURE C	CORES

•• WHEN RAP/RAS ABR EXCEEDS 20%, THE HIGH AND LOW VIRGIN ASPHALT BINDER GRADES SHALL EACH BE REDUCED BY ONE GRADE (EXAMPLE: 25% ABR WOULD REQUIRE A VIRGIN ASPHALT BINDER GRADE OF PG 64-22 TO BE REDUCED TO PG 58-28).



MAINLINE SCHEDULE										
LOCATION		POLY HMA SURF CSE	LEVEL BINDER	HMA SURF REM 2 1/4"	HMA SHLD	AGG SHLD TY B	TEMP RAMP	BIT MAT (PR CT)	LEVEL BINDER (HM)	MIX FOR CRACKS, JTS & FLGWYS
STA TO STA	LENGTH		TON	SQ YD	TON	TON	SQ YD	POUND	TON	TON
123+82.78 TO 127+25	342.22	198	99	2358			103	1592	11.8	0.7
127+25 TO 134+00	OMISSION									
134+00 TO 177+90	4390	2571	1286	30606			177	20659	153	9.2
177+90 TO 181+80	390	189	95	2253				1521	11.3	0.7
181+80 TO 185+50	370	149	75	2056	36			1388	10.3	0.6
185+50 TO 187+81	231	95	48	1296	21			875	6.5	0.4
187+81 TO 189+90	209	66	33	964	23	31.7		651	4.8	0.3
189+90 TO 209+25	1935	505	253	7740	217	257.1		5225	38.7	2.3
209+25 TO 215+60	635	164	82	2657	89	84.4		1793	13.3	0.8
215+60 TO 222+00	640	221	111	3073	56	85		2074	15.4	0.9
STA. 222+00 TO 224+50	250	128	64	1583	8	33.2	36	1069	7.9	0.5
<b>TOTAL</b>		<b>4286</b>	<b>2146</b>	<b>54586</b>	<b>450</b>	<b>491.4</b>	<b>316</b>	<b>36847</b>	<b>273</b>	<b>16.4</b>

NOTES: THE EXISTING AGGREGATE SHOULDERS ARE LOW. ADDITIONAL QUANTITY OF AGGREGATE SHOULDER, TYPE B HAS BEEN ADDED.  
THE LARRY POWER ROAD INTERSECTION SHALL BE PAVED WITH THE MAINLINE PAVEMENT

SIDEROAD AND ENTRANCE SCHEDULE									
SIDEROAD OR DESCRIPTION	STA	SIDE	EXIST MAT	WIDTH	HMA SURF REM 2 1/4"	INC HMA SURF	BIT MAT'L (PR CT)	TEMP RAMP	
				FOOT	SQ YD	TON	POUND	SQ YD	
HERITAGE DR	125+74.54	LT	HMA	34	156	19.7	105.3	28.3	
JOHN CASEY DR. (OMISSION)	130+44.12	LT & RT							
MOHAWK DR	135+50.88	RT	HMA	67	249	31.4	168.1	55.8	
BETHEL DR	146+04.50	LT	HMA	34	156	19.7	105.3	28.3	
JORDAN DR	148+40.90	LT	HMA	32	150	18.9	101.3	26.7	
HANSON DR	151+04.58	LT	HMA	32	150	18.9	101.3	26.7	
DENNING DR	154+40.67	LT	HMA	32	150	18.9	101.3	26.7	
MEADOWS RD	154+40.67	RT	HMA	34	156	19.7	105.3	28.3	
DUNCAN DR	157+65.56	LT	HMA	32	150	18.9	101.3	26.7	
BONDS DR	161+10.06	LT	HMA	32	150	18.9	101.3	26.7	
HILLTOP DR	164+25.87	LT	HMA	32	150	18.9	101.3	26.7	
EMERY DR	167+49.71	LT	HMA	32	150	18.9	101.3	26.7	
KIM DR	170+76.66	LT	HMA	32	150	18.9	101.3	26.7	
LARRY POWER / TUCKER RD.	172+45.08	RT	HMA						SEE MAINLINE SCHEDULE
KATHY DR	177+34	LT	HMA	30	143	18.0	96.5	25.0	
HIGHPOINT CIRCLE	187+26	LT	HMA	54	402	50.7	271.4	45.0	
PRAIRIE DR	187+29	RT	HMA	34	156	19.7	105.3	28.3	
BURNS	192+97	RT	HMA	64	461	58.1	311.2	53.3	
BURNS	192+97	LT	HMA	64	461	58.1	311.2	53.3	
300 RIVERSIDE DR	196+90	RT	HMA	24	123	15.5	83.0	20.0	
200 RIVERSIDE DR	209+49	RT	HMA	24	123	15.5	83.0	20.0	
FITNESS DR	215+86	RT	HMA	26	130	16.4	87.8	21.7	
CIGNA ENTRANCE	222+52	RT	HMA	30	141	17.8	95.2	25.0	
<b>TOTAL</b>					<b>4057</b>	<b>511.5</b>	<b>2739</b>	<b>645.9</b>	

SIDEWALK SCHEDULE FOR NEW RAMP INSTALLATION					
LOCATION	PCC SIDEWALK 4"	DETECTABLE WARNINGS	COMB CC&G TYPE B-6.24	SIDEWALK REMOVAL	COMB C&G REMOVAL
	SQ FT	SQ FT	FT	SQ FT	FT
<b>WEST HERITAGE</b>					
SW QUAD	51	10		51	
NW QUAD	44	10		44	
<b>MOHAWK DR</b>					
NE QUAD	46	10		46	
SE QUAD	45	10		45	
<b>ISLAND</b>					
<b>JORDAN AVE</b>					
NW QUAD	45	10		45	
SW QUAD	24	10		24	
<b>HANSON DR</b>					
NW QUAD	44	10		44	
SW QUAD	44	10		44	
<b>DENNISON DR</b>					
NW QUAD	45	20	11	33	11
SW QUAD	47	10		47	
<b>MEADOWS RD</b>					
NE QUAD	89	10		89	
SE QUAD	41	10		41	
<b>DUNCAN DR</b>					
NW QUAD	54	10		54	
SW QUAD	44	10		44	
<b>BONDS DR</b>					
NW QUAD	40	10		40	
SW QUAD	68	10		68	
<b>HILLTOP DR</b>					
NW QUAD	47	10		47	
SW QUAD	44	10		44	
<b>EMERY DR</b>					
NW QUAD	51	10		51	
SW QUAD	42	10		35	
<b>KIM DR</b>					
NW QUAD	48	10		48	
SW QUAD	90	20		90	
EAST SIDE	175	10		175	
<b>LARRY POWER RD</b>					
NE QUAD #1	92	10		92	
NE QUAD #2	81	10		81	
SE QUAD	46	10		46	
WEST SIDE	53	10		53	
<b>KATHY DR</b>					
SW QUAD	50	10		50	
<b>HIGHPOINT CIRCLE DR</b>					
NW QUAD	46	10	10	37	10
<b>PRAIRIE DR</b>					
NE QUAD	30	10		25	
<b>300 RIVERSIDE DR</b>					
NE QUAD	30	10		25	
SE QUAD	30	10		25	
<b>200 RIVERSIDE DR</b>					
NE QUAD	30	10		25	
SE QUAD	30	10		25	
<b>FITNESS DR</b>					
SE QUAD	36	10		30	
<b>TOTALS</b>	<b>1822</b>	<b>370</b>	<b>21</b>	<b>1763</b>	<b>21</b>

**PAVEMENT MARKING SCHEDULE**

LOCATION		THERMOPLASTIC PVMT MARKING		THERMOPLASTIC PVMT MARK		THERMO PVMT MARK	THERMOPLASTIC PVMT MARK		THERMO PVMT MARK	THERMOPLASTIC PVMT MARK LETTERS & SYMBOLS		PREFORMED PLASTIC PVMT MARK	GROOVING FOR RECESSED PVMT MARK	GROOVING FOR RECESSED PVMT MARK	GROOVING FOR RECESSED PVMT MARK	RAISED REF PVMT MARKER	RAISED REFLECT PVMT MARKER	
		WHITE 4"	YELLOW 4"	WHITE 6"	YELLOW 6"	WHITE 8"	WHITE 12"	YELLOW 12"	WHITE 24"	WHITE	YELLOW	TY B, 6"	7"	9"	25"	REMOVAL	WHITE	YELLOW
		FOOT	FOOT	FOOT	FOOT	FOOT	FOOT	FOOT	FOOT	SQ FT	SQ FT	FOOT	FOOT	EACH	EACH	EACH	EACH	EACH
123+82.78 TO 127+25	342.22		484	81	150				18	62.4		140	140		18	24	12	12
127+25 TO 134+00	OMISSION																	
134+00 TO 148+40.90	1440.9		2315	638.4	565	189.5	1596		96	46.8	156.0	625	625	189.5	96	144	72	72
148+40.90 TO 161+10.06	1269.16		2406	644	30	624	450	68	164	140.4		540	540	624	164	78	21	57
161+10.06 TO 170+76.66	966.6		2138	386	12	400	240	81	88	78.0		440	440	400	88	80	27	53
170+76.66 TO 189+90	1913.34	764	5341	364		635	240	232	127	93.6		400	400	635	127	129	32	97
189+90 TO 209+25	1935	3870	1820	648		1188	740	56	150	299.7				876	150	120	80	40
209+25 TO 224+50	1525	3010	2464			799		115		171.6	83.0			799		58	18	40
<b>SUB TOTAL</b>		<b>7644</b>	<b>16968</b>	<b>2761.4</b>	<b>757</b>	<b>3835.5</b>	<b>3266</b>	<b>552</b>	<b>643</b>	<b>892.5</b>	<b>239.0</b>	<b>2145</b>	<b>2145</b>	<b>3523.5</b>	<b>643</b>	<b>633</b>	<b>262</b>	<b>371</b>
<b>TOTAL</b>		<b>24612</b>		<b>3518.4</b>		<b>3835.5</b>	<b>3818</b>		<b>643</b>	<b>1131.5</b>		<b>2145</b>	<b>2145</b>	<b>3523.5</b>	<b>643</b>	<b>633</b>	<b>262</b>	<b>371</b>

**TEMPORARY PAVEMENT MARKING SCHEDULE**

LOCATION		TEMPORARY PVMT MARKING		TEMPORARY PVMT MARK		TEMPORARY PVMT MARK	TEMPORARY PVMT MARK		TEMPORARY PVMT MARK	TEMPORARY PVMT MARK LETTERS & SYMBOLS	
		WHITE 4"	YELLOW 4"	WHITE 6"	YELLOW 6"	WHITE 8"	WHITE 12"	YELLOW 12"	WHITE 24"	WHITE	YELLOW
		FOOT	FOOT	FOOT	FOOT	FOOT	FOOT	FOOT	FOOT	SQ FT	SQ FT
123+82.78 TO 127+25	342.22		484	221	150				18	62.4	
127+25 TO 134+00	OMISSION										
134+00 TO 148+40.90	1440.9		4492	1263.4	565	189.5	1596		96	46.8	156.0
148+40.90 TO 161+10.06	1269.16		2406	1184	30	624	450	68	164	140.4	
161+10.06 TO 170+76.66	966.6		2138	826	12	400	240	81	88	78.0	
170+76.66 TO 189+90	1913.34	764	5341	764		635	240	232	127	93.6	
189+90 TO 209+25	1935	3870	1820	648		1188	740	56	150	299.7	
209+25 TO 224+50	1525	3010	2464			799		115		171.6	83.0
<b>SUB TOTAL</b>		<b>7644</b>	<b>19145</b>	<b>4906.4</b>	<b>757</b>	<b>3835.5</b>	<b>3266</b>	<b>552</b>	<b>643</b>	<b>892.5</b>	<b>239.0</b>
<b>TOTAL</b>		<b>26789</b>		<b>5663.4</b>		<b>3835.5</b>	<b>3818</b>		<b>643</b>	<b>1131.5</b>	

**SHORT-TERM PAVEMENT MARKING SCHEDULE**

LOCATION		SHORT-TERM PAVEMENT MARKING		WORK ZONE PAV'T MARKING
		WHITE	YELLOW	REMOVAL
		FOOT	FOOT	SQ FT
123+82.78 TO 127+25	342.22	48	432	80
127+25 TO 134+00	OMISSION			
134+00 TO 148+40.90	1440.9	553	1392	324
148+40.90 TO 161+10.06	1269.16	1356	468	304
161+10.06 TO 170+76.66	966.6	867	424	215
170+76.66 TO 189+90	1913.34	1268	1080	391
209+25 TO 224+50	1525	121	611	122
<b>SUB TOTAL</b>		<b>4213</b>	<b>4407</b>	<b>1436</b>
<b>TOTAL</b>		<b>8620</b>		<b>1436</b>

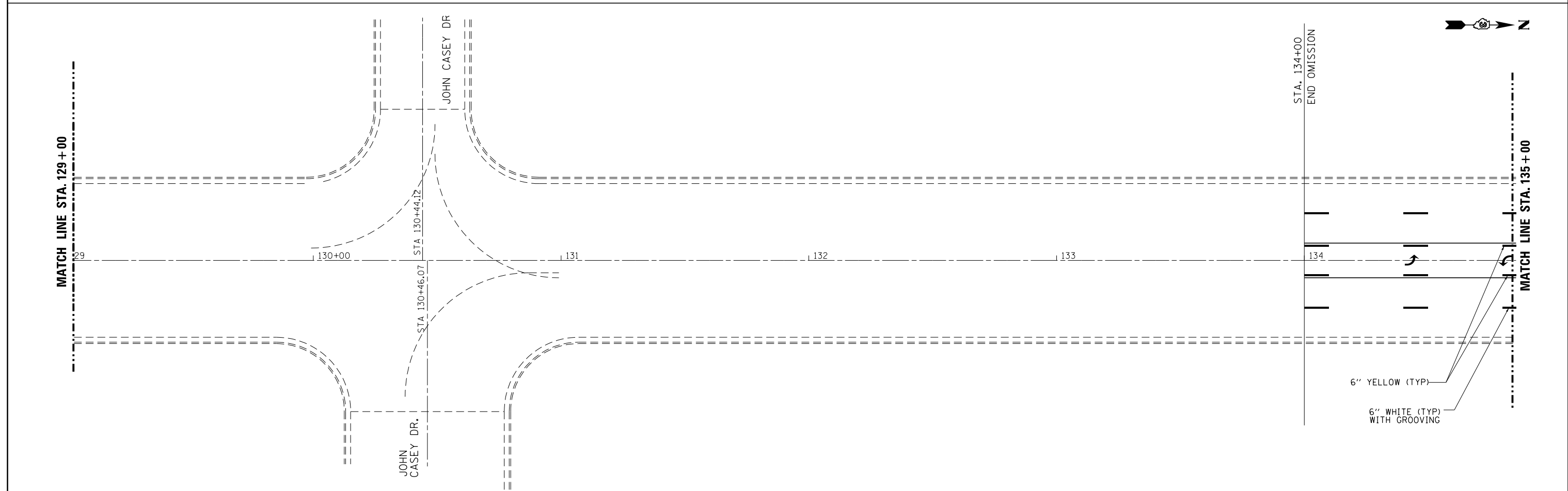
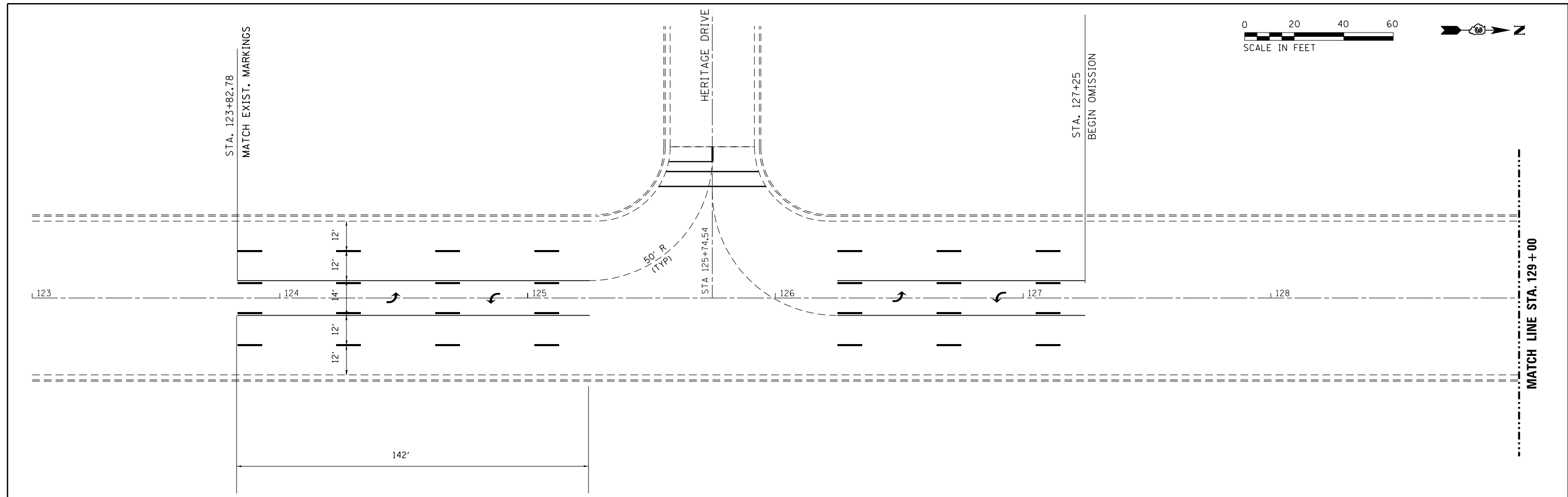

FILE NAME = c:\pw\work\p1dot\carpenterd\ms82592\	USER NAME = carpenterd_j	DESIGNED -	REVISED -	<b>STATE OF ILLINOIS DEPARTMENT OF TRANSPORTATION</b>	<b>PAVEMENT MARKING</b>			F.A.P. RTE.	SECTION	COUNTY	TOTAL SHEETS	SHEET NO.
	Drawn	DRAWN -	REVISED -					330	(15)RS-5	KANKAKEE	31	12
PLOT SCALE = 40.0000' / in.	CHECKED -	REVISED -	REVISED -		CONTRACT NO. 66427			ILLINOIS FED. AID PROJECT				
Default	PLOT DATE = 6/6/2014	DATE -	REVISED -		SCALE:	SHEET	OF					

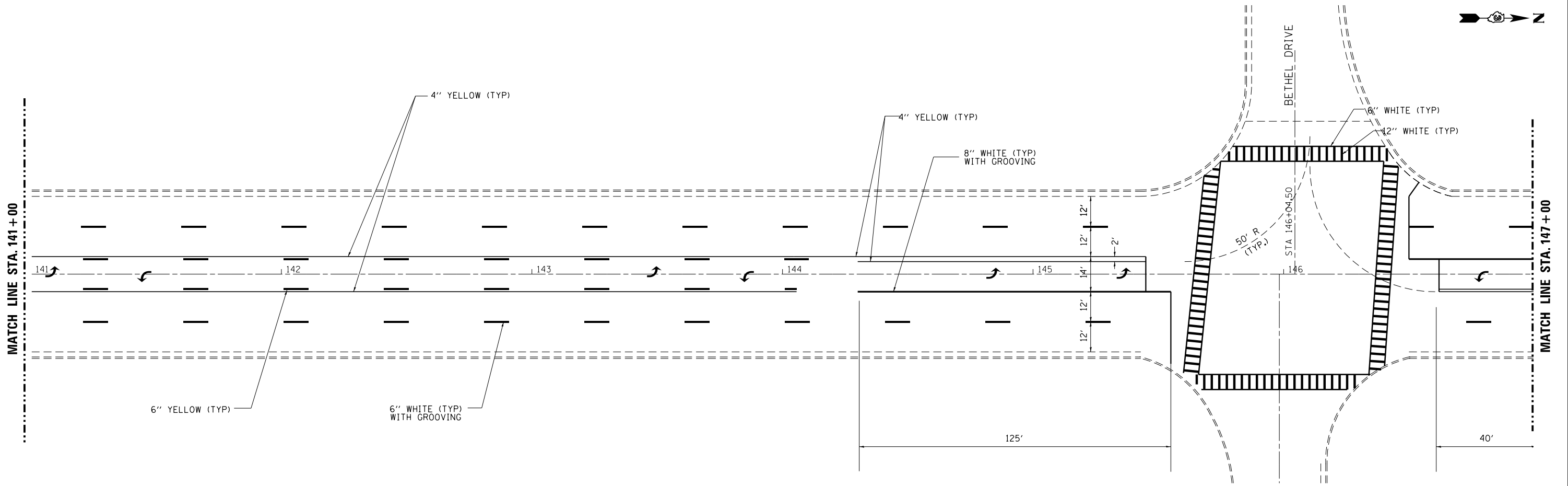
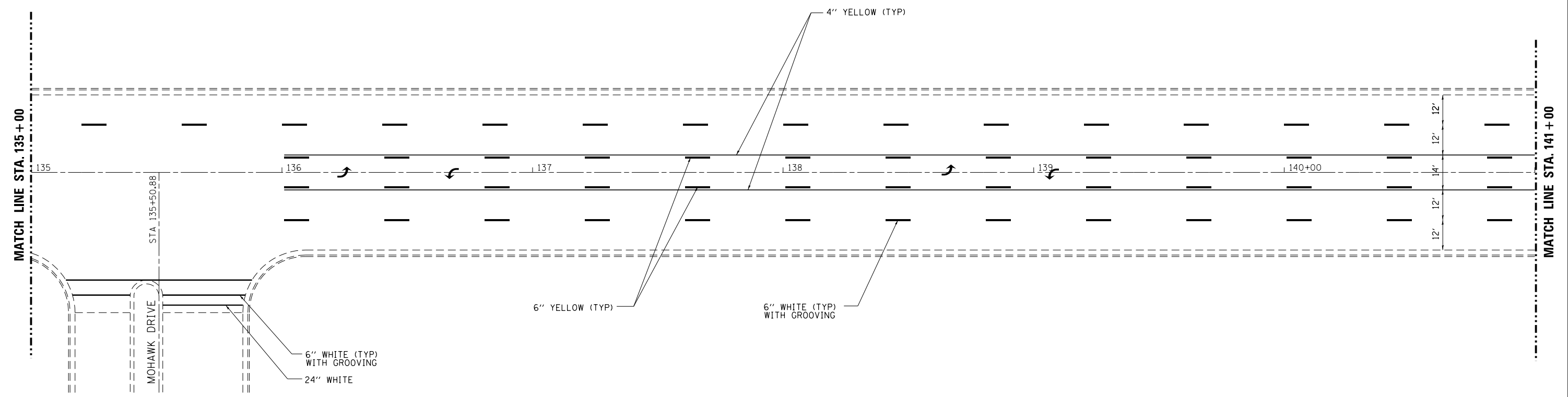
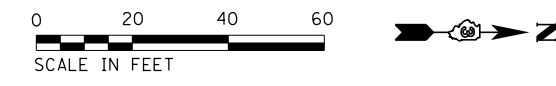

FILE NAME = c:\pw_work\p1dot\carpenterd\ms82592\	USER NAME = carpenterdj	DESIGNED -	REVISED -	<b>STATE OF ILLINOIS DEPARTMENT OF TRANSPORTATION</b>	<b>PAVEMENT MARKING</b>			F.A.P. RTE.	SECTION	COUNTY	TOTAL SHEETS	SHEET NO.
	sheets.dgn	DRAWN -	REVISED -					330	(15)RS-5	KANKAKEE	31	13
Default	PLOT SCALE = 40.0000' / in.	CHECKED -	REVISED -	SCALE: SHEET OF SHEETS STA. 135+00 TO STA. 147+00			CONTRACT NO. 66427					
	PLOT DATE = 6/6/2014	DATE -	REVISED -	ILLINOIS FED. AID PROJECT								

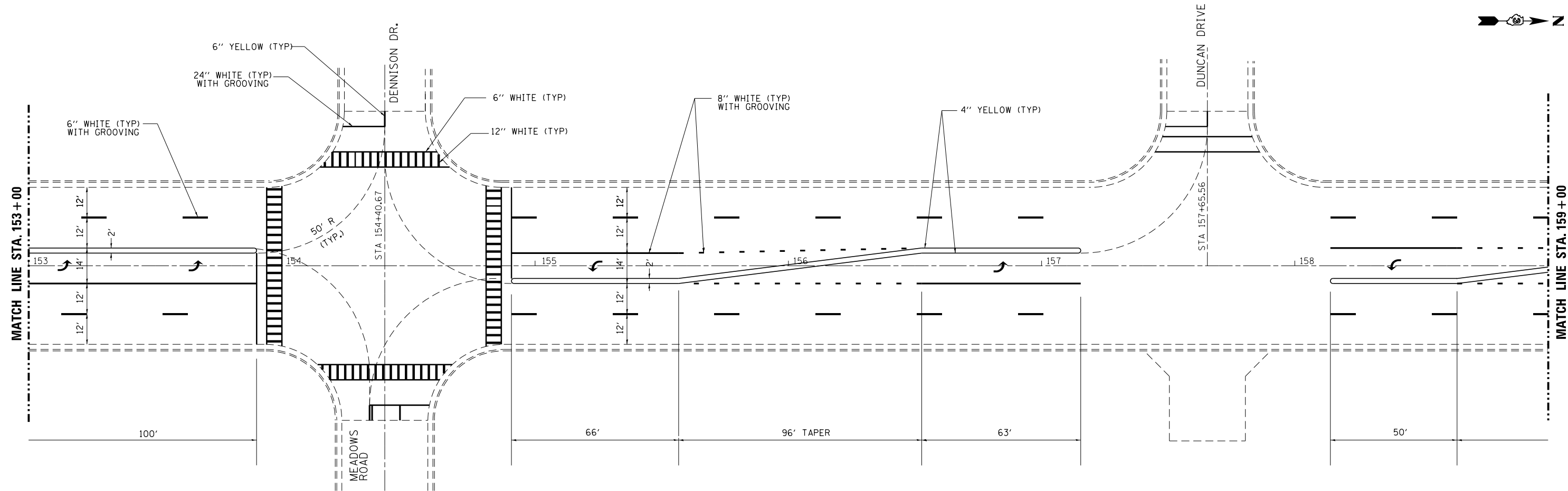
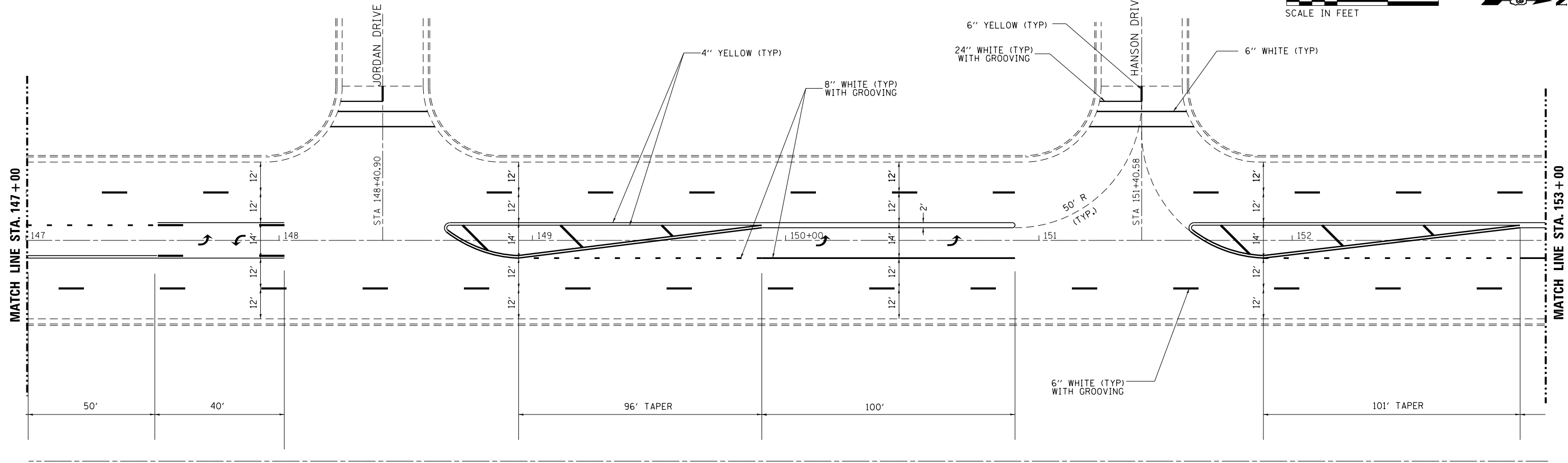

FILE NAME =	USER NAME = carpenterdj	DESIGNED -	REVISED -	<b>STATE OF ILLINOIS DEPARTMENT OF TRANSPORTATION</b>	<b>PAVEMENT MARKING</b>			F.A.P. RTE.	SECTION	COUNTY	TOTAL SHEETS	SHEET NO.
ci:\pw_work\p\midot\carpenterdj\dms82592\ sheets.dgn	DRAWN -	REVISED -	330					(15)RS-5	KANKAKEE	31	14	
Default	PLOT SCALE = 48.0000' / in.	CHECKED -	REVISED -		SCALE: SHEET OF SHEETS STA. 174+00 TO STA. 159+00			CONTRACT NO. 66427		ILLINOIS FED. AID PROJECT		
	PLOT DATE = 6/6/2014	DATE -	REVISED -									

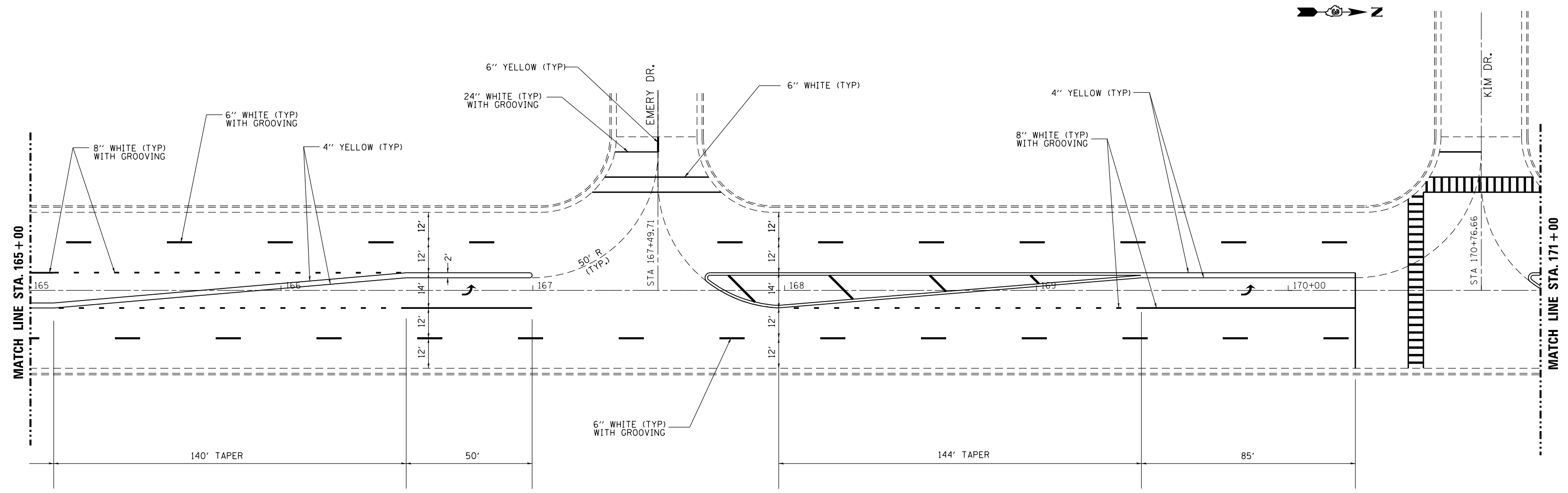
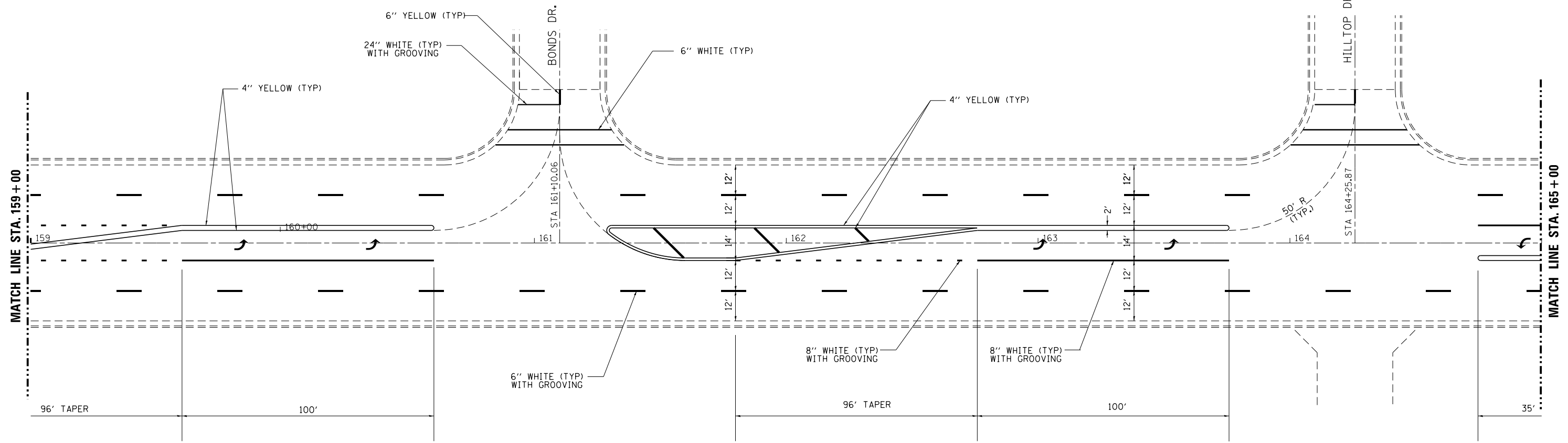

FILE NAME =	USER NAME = carpenterdj	DESIGNED -	REVISED -
c:\pwork\pwork\pwork\carpenterdj\dms82592\	sheets.dgn	DRAWN -	REVISED -
Default	PLOT SCALE = 48.0000' / in.	CHECKED -	REVISED -
	PLOT DATE = 6/6/2014	DATE -	REVISED -

**STATE OF ILLINOIS  
DEPARTMENT OF TRANSPORTATION**

**PAVEMENT MARKING**

SCALE: SHEET OF SHEETS STA. 159+00 TO STA. 171+00

F.A.P. RTE.	SECTION	COUNTY	TOTAL SHEETS	SHEET NO.
330	(15)RS-5	KANKAKEE	31	15
CONTRACT NO. 66427				
ILLINOIS FED. AID PROJECT				

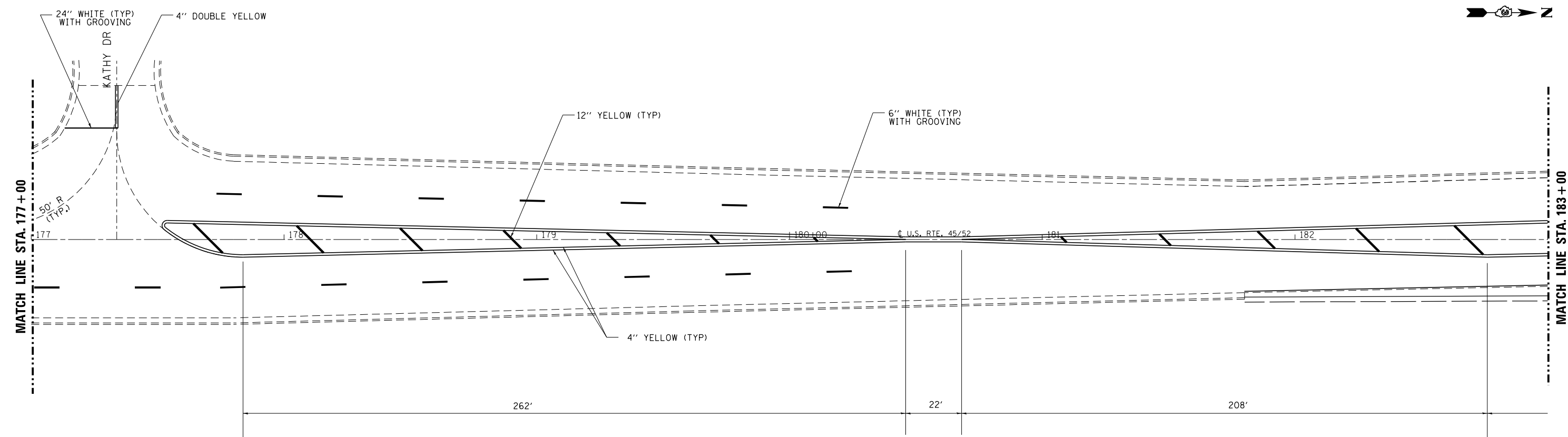
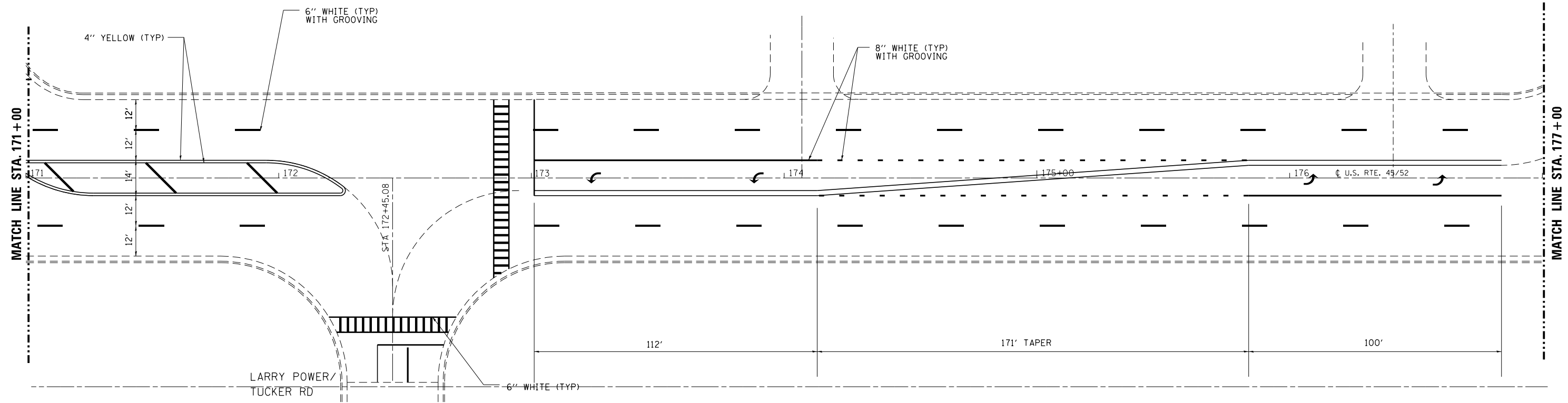

FILE NAME =	USER NAME = carpenterdj	DESIGNED -	REVISED -
ei:\pw\work\p\midot\carpenterdj\dms82592\	sheets.dgn	DRAWN -	REVISED -
Default	PLOT SCALE = 40.0000' / in.	CHECKED -	REVISED -
	PLOT DATE = 6/6/2014	DATE -	REVISED -

**STATE OF ILLINOIS  
DEPARTMENT OF TRANSPORTATION**

**PAVEMENT MARKING**

SCALE: SHEET OF SHEETS STA. 171+00 TO STA. 183+00

F.A.P. RTE.	SECTION	COUNTY	TOTAL SHEETS	SHEET NO.
330	(15)RS-5	KANKAKEE	31	16
CONTRACT NO. 66427				
ILLINOIS FED. AID PROJECT				



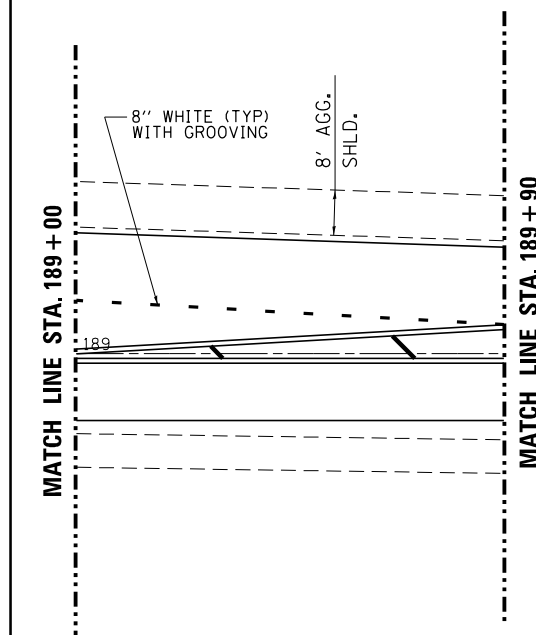
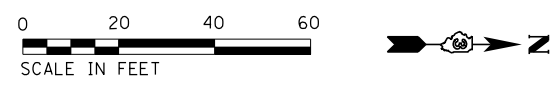
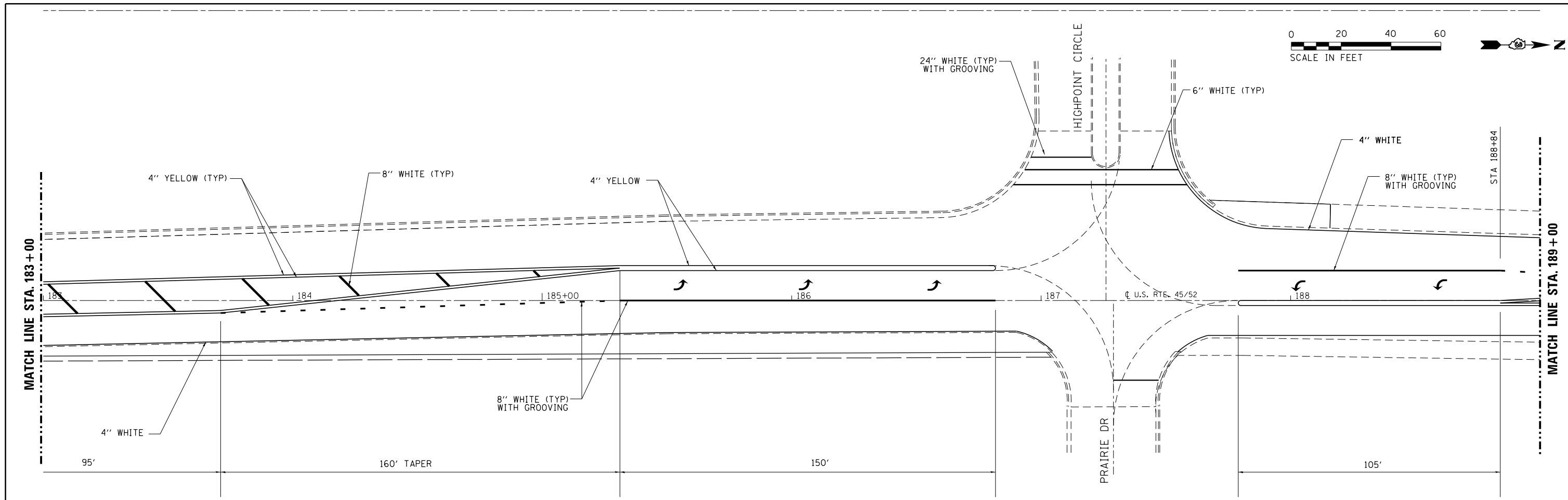

MATCH EXISTING  
PAVEMENT MARKING DETAILS  
NOT AVAILABLE STA 189+90 TO 201+00

FILE NAME =	USER NAME = carpenterdj	DESIGNED -	REVISED -
ci:\pw_work\p\dot\carpenterdj\dms82592\	heets.dgn	DRAWN -	REVISED -
Default	PLOT SCALE = 40.0000' / in.	CHECKED -	REVISED -
	PLOT DATE = 6/6/2014	DATE -	REVISED -

**STATE OF ILLINOIS  
DEPARTMENT OF TRANSPORTATION**

<b>PAVEMENT MARKING</b>	
SCALE:	SHEET OF SHEETS STA. 183+00 TO STA. 195+00

F.A.P. RTE.	SECTION	COUNTY	TOTAL SHEETS	SHEET NO.
330	(15)RS-5	KANKAKEE	31	17
CONTRACT NO. 66427				
ILLINOIS FED. AID PROJECT				

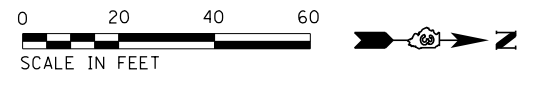

**MATCH EXISTING  
PAVEMENT MARKING DETAILS  
NOT AVAILABLE STA 189+90 TO 201+00**

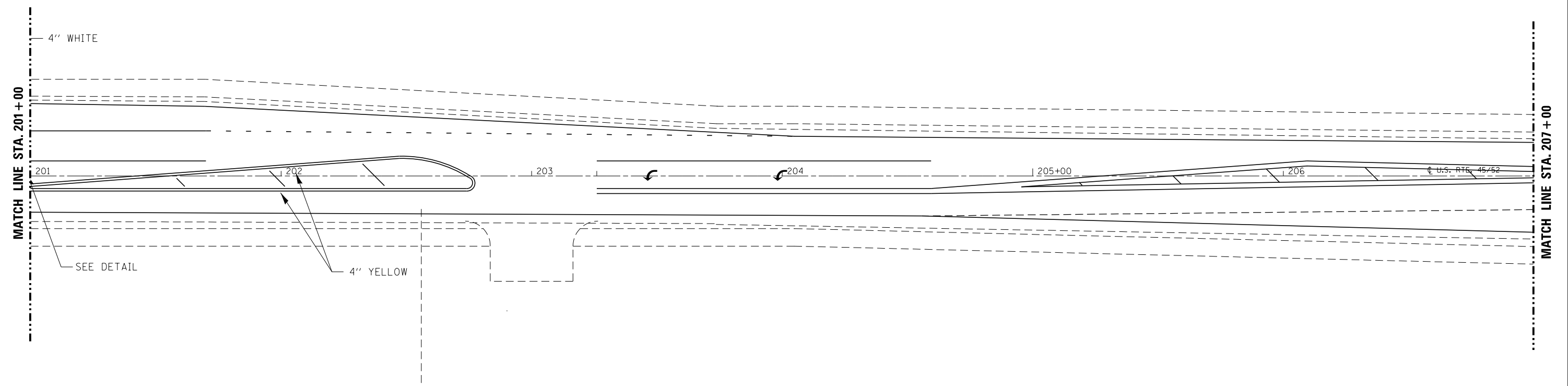

FILE NAME =	USER NAME = carpenterdj	DESIGNED -	REVISED -
c:\pwork\work\pwork\carpenterdj\dms82592\	sheets.dgn	DRAWN -	REVISED -
Default	PLOT SCALE = 40.0000' / in.	CHECKED -	REVISED -
	PLOT DATE = 6/6/2014	DATE -	REVISED -

**STATE OF ILLINOIS  
DEPARTMENT OF TRANSPORTATION**

<b>PAVEMENT MARKING</b>			
SCALE:	SHEET	OF	SHEETS
			STA. 195+00 TO STA. 207+00

F.A.P. RTE.	SECTION	COUNTY	TOTAL SHEETS	SHEET NO.
330	(15)RS-5	KANKAKEE	31	18
CONTRACT NO. 66427			ILLINOIS FED. AID PROJECT	

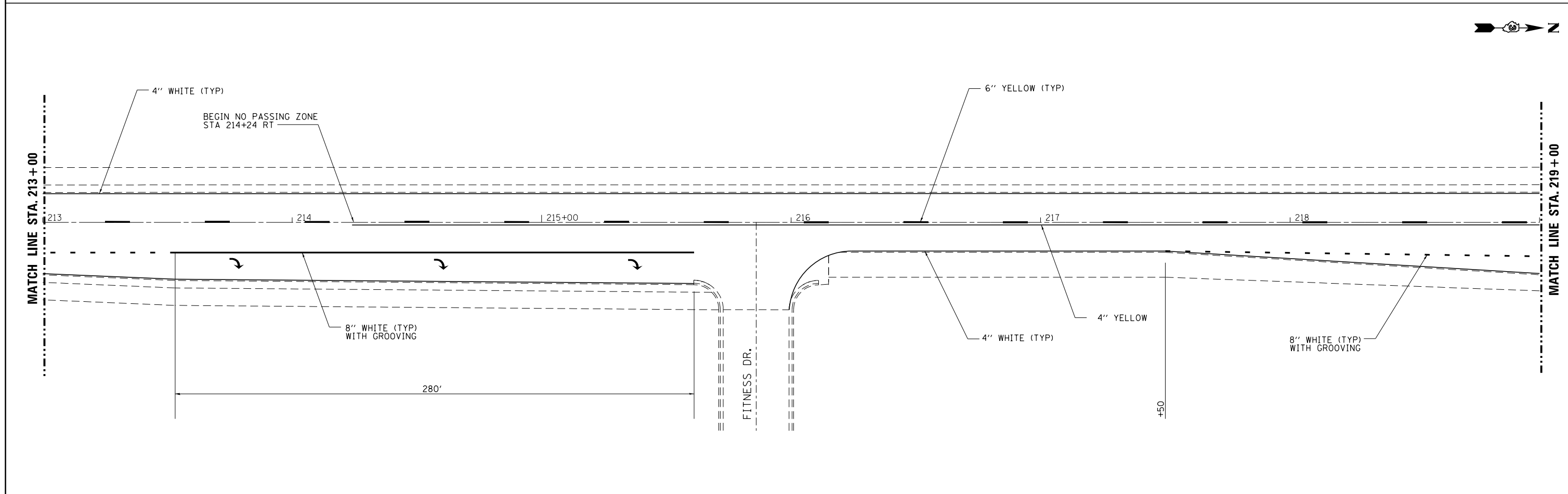
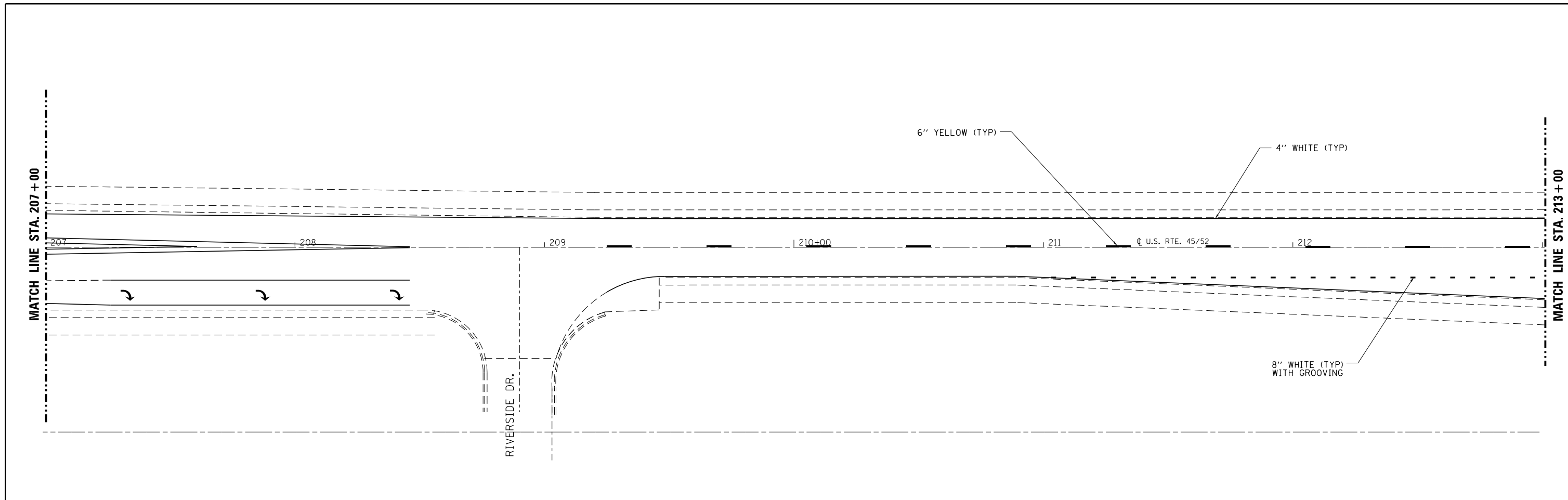

FILE NAME =	USER NAME = carpenterdj	DESIGNED -	REVISED -
c:\pwork\work\pwork\carpenterdj\dms82592\	sheets.dgn	DRAWN -	REVISED -
	PLOT SCALE = 40.0000' / in.	CHECKED -	REVISED -
#MODELNAME#	PLOT DATE = 6/6/2014	DATE -	REVISED -

**STATE OF ILLINOIS  
DEPARTMENT OF TRANSPORTATION**

<b>PAVEMENT MARKING</b>			
SCALE:	SHEET	OF	SHEETS
			STA. 207+00 TO STA. 219+00

F.A.P. RTE.	SECTION	COUNTY	TOTAL SHEETS	SHEET NO.
330	(15)RS-5	KANKAKEE	31	19
			CONTRACT NO. 66427	
ILLINOIS FED. AID PROJECT				

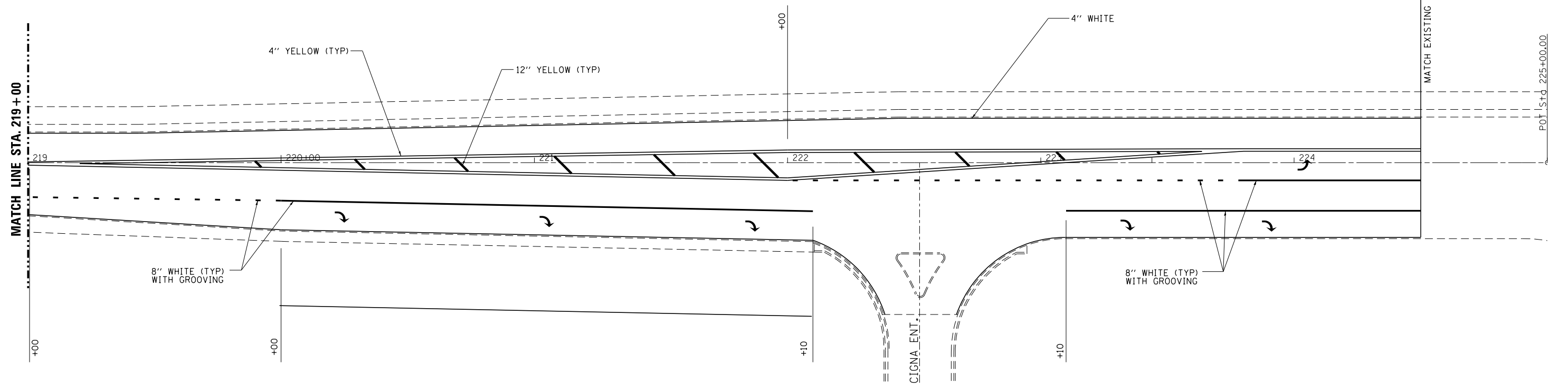
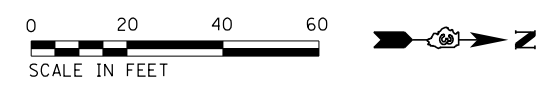

FILE NAME =	USER NAME = carpenterdj	DESIGNED -	REVISED -
c:\pw\work\p\dot\carpenterdj\dms82592\	heets.dgn	DRAWN -	REVISED -
Default	PLOT SCALE = 40.0000' / in.	CHECKED -	REVISED -
	PLOT DATE = 6/6/2014	DATE -	REVISED -

**STATE OF ILLINOIS  
DEPARTMENT OF TRANSPORTATION**

<b>PAVEMENT MARKING</b>			
SCALE:	SHEET	OF	SHEETS
	STA. 219+00	TO	STA. 224+50

F.A.P. RTE.	SECTION	COUNTY	TOTAL SHEETS	SHEET NO.
330	(15)RS-5	KANKAKEE	31	20
CONTRACT NO. 66427				
ILLINOIS FED. AID PROJECT				

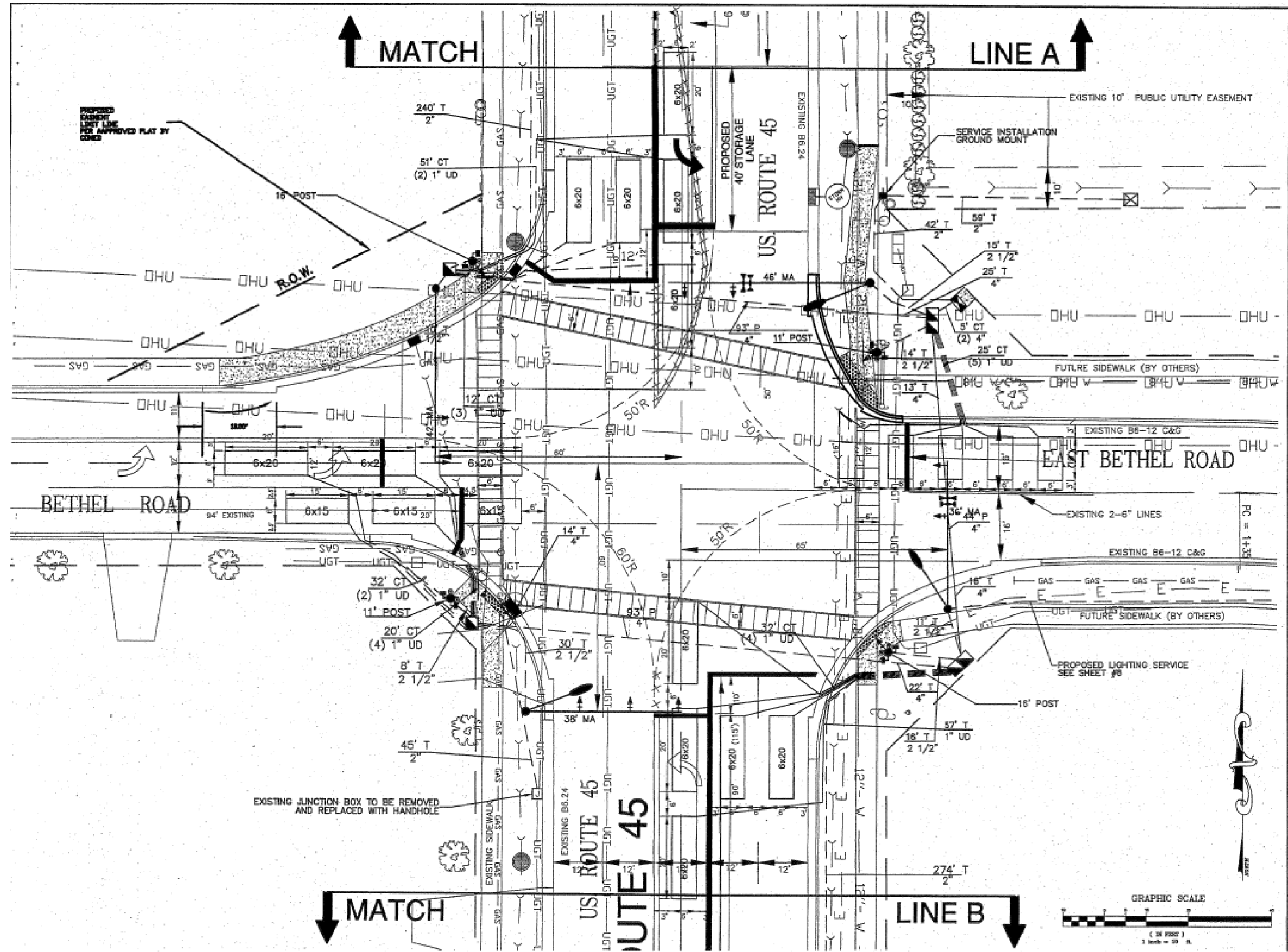

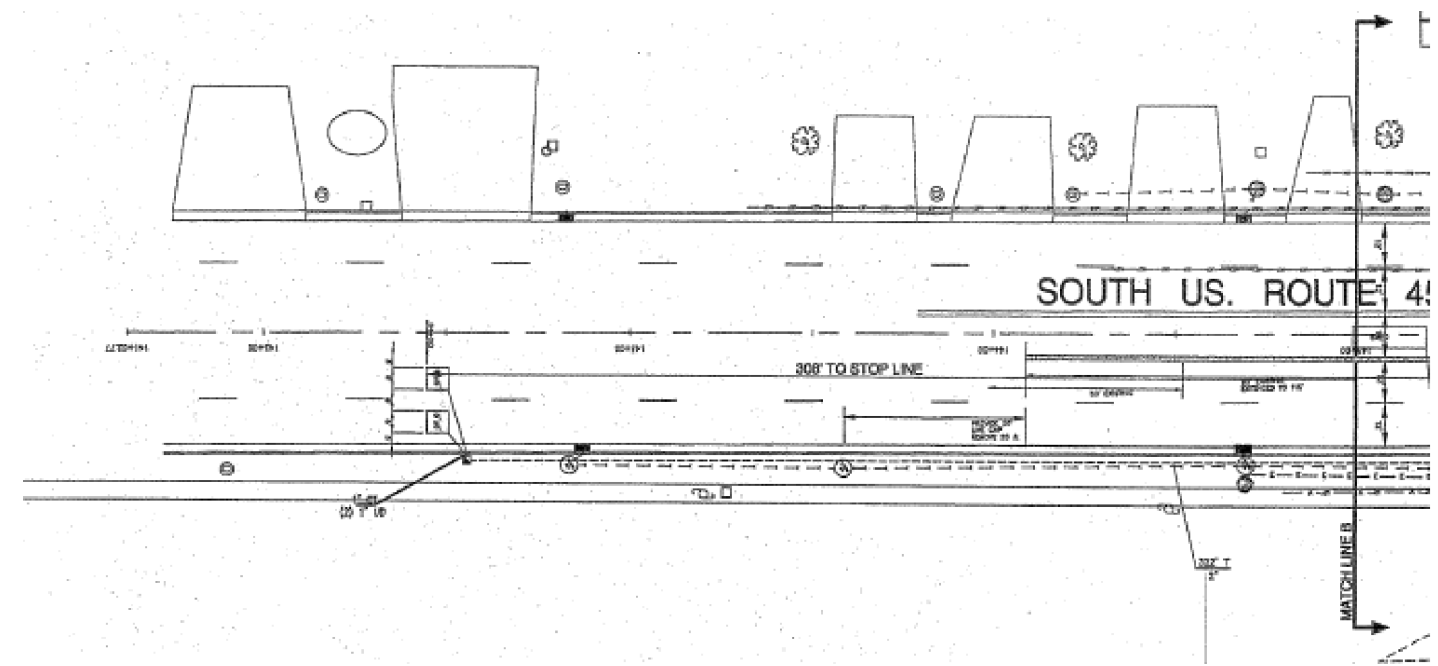
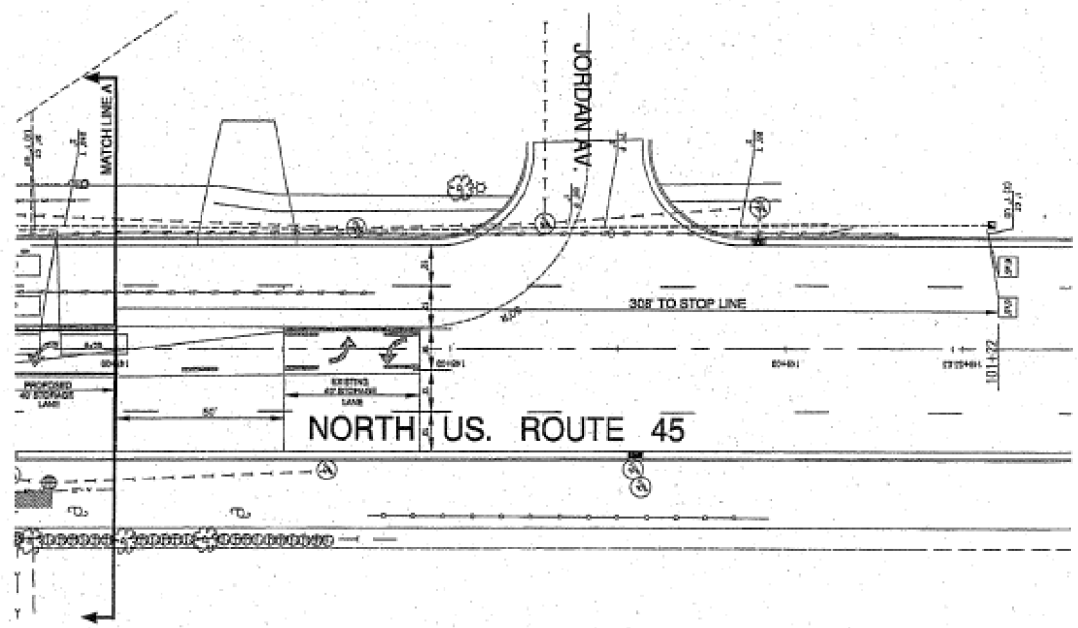

**FOR INFORMATION ONLY**

DETECTOR LOOP REPLACEMENT AT BETHEL ROAD		
	DETECTOR LOOP TYPE I	DETECTOR LOOP TESTING
ENTIRE INTERSECTION	1531	1
TOTAL	1531	1

- NOTES:**
- PLEASE CONTACT TRAFFIC SIGNAL SECTION FOR PROPOSED DETECTOR LOOP DESIGN AT 815-434-8505 IF ANY OTHER LOOPS ARE DAMAGED.
  - VARIOUS SIZE DETECTOR LOOPS WITH TYPICAL 6' SPACING 10' FROM PROJECTED EDGE LINE OR DISTANCE FROM STOP BAR AS NOTED.
  - 4 TURNS REQUIRED ON ALL DETECTOR LOOPS.
  - DETECTOR LOOPS SHALL BE INSTALLED IN THE MILLED SURFACE PRIOR TO RESURFACING.

DETECTOR LOOP REPLACEMENT AT MEADOWS / DENNISON		
	DETECTOR LOOP TYPE I	DETECTOR LOOP TESTING
SOUTH LEG	455	
WEST LEG	190	
NORTH LEG	465	
EAST LEG	347	
<b>TOTAL</b>	<b>1457</b>	<b>1</b>

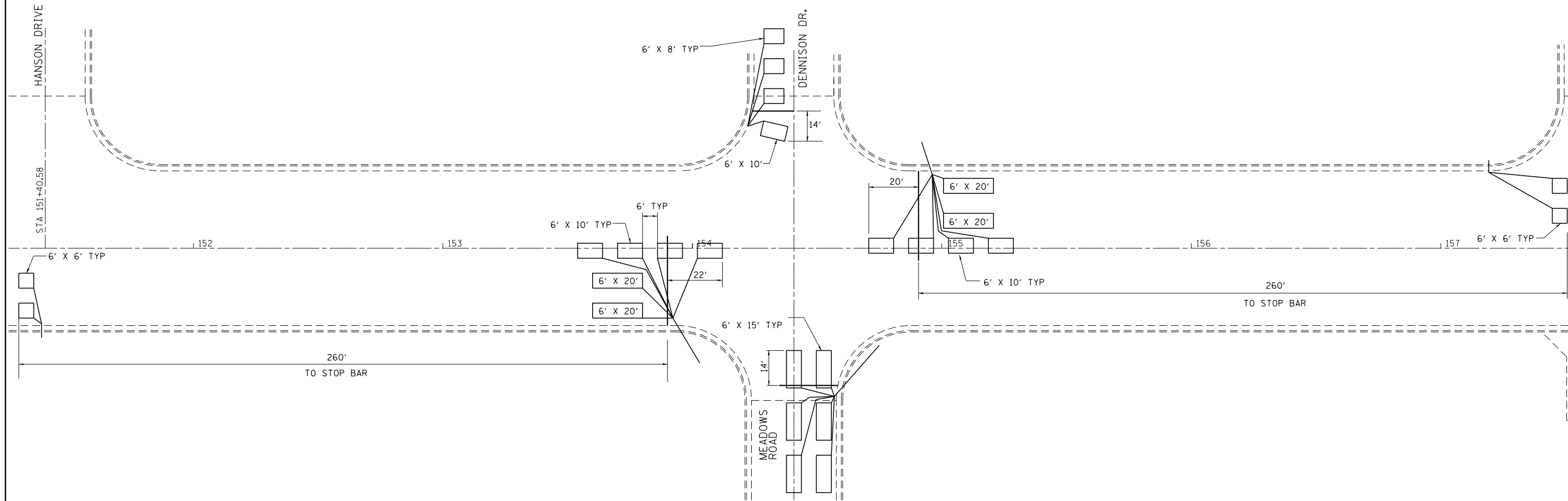
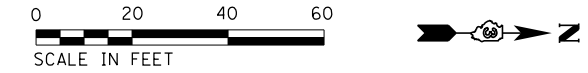

**LEGEND**

- PROPOSED DETECTOR LOOP
- EXISTING DETECTOR LOOP

FILE NAME =	USER NAME = carpenterdj	DESIGNED -	REVISED -
ci:\pw\work\p\dot\carpenterdj\dms82592\	sheets.dgn	DRAWN -	REVISED -
Default	PLOT SCALE = 40.0000' / in.	CHECKED -	REVISED -
	PLOT DATE = 6/6/2014	DATE -	REVISED -

**STATE OF ILLINOIS  
DEPARTMENT OF TRANSPORTATION**

**DETECTOR LOOP DETAILS  
MEADOWS RD /DENNISON DR**

SCALE: SHEET OF SHEETS STA. TO STA.

F.A.P. RTE.	SECTION	COUNTY	TOTAL SHEETS	SHEET NO.
330	(15)RS-5	KANKAKEE	31	23
ILLINOIS FED. AID PROJECT			CONTRACT NO. 66427	

- NOTES:**
- PLEASE CONTACT TRAFFIC SIGNAL SECTION FOR PROPOSED DETECTOR LOOP DESIGN AT 815-434-8505 IF ANY OTHER LOOPS ARE DAMAGED.
  - VARIOUS SIZE DETECTOR LOOPS WITH TYPICAL 6' SPACING 10' FROM PROJECTED EDGE LINE OR DISTANCE FROM STOP BAR AS NOTED.
  - 4 TURNS REQUIRED ON ALL DETECTOR LOOPS.
  - DETECTOR LOOPS SHALL BE INSTALLED IN THE MILLED SURFACE PRIOR TO RESURFACING.
  - THE INTERSECTION OF US 45/52 WITH KIM DRIVE AND LARRY POWER ROAD SHALL BE CONSIDERED AS ONE INTERSECTION. DETECTOR LOOP TESTING WILL BE PAID FOR AS 1 EACH.

DETECTOR LOOP REPLACEMENT AT KIM DR. / LARRY POWER RD.		
	DETECTOR LOOP TYPE I	DETECTOR LOOP TESTING
SOUTH LEG	427	
WEST LEG	123	
NORTH LEG	432	
EAST LEG	268	
TOTAL	1250	1

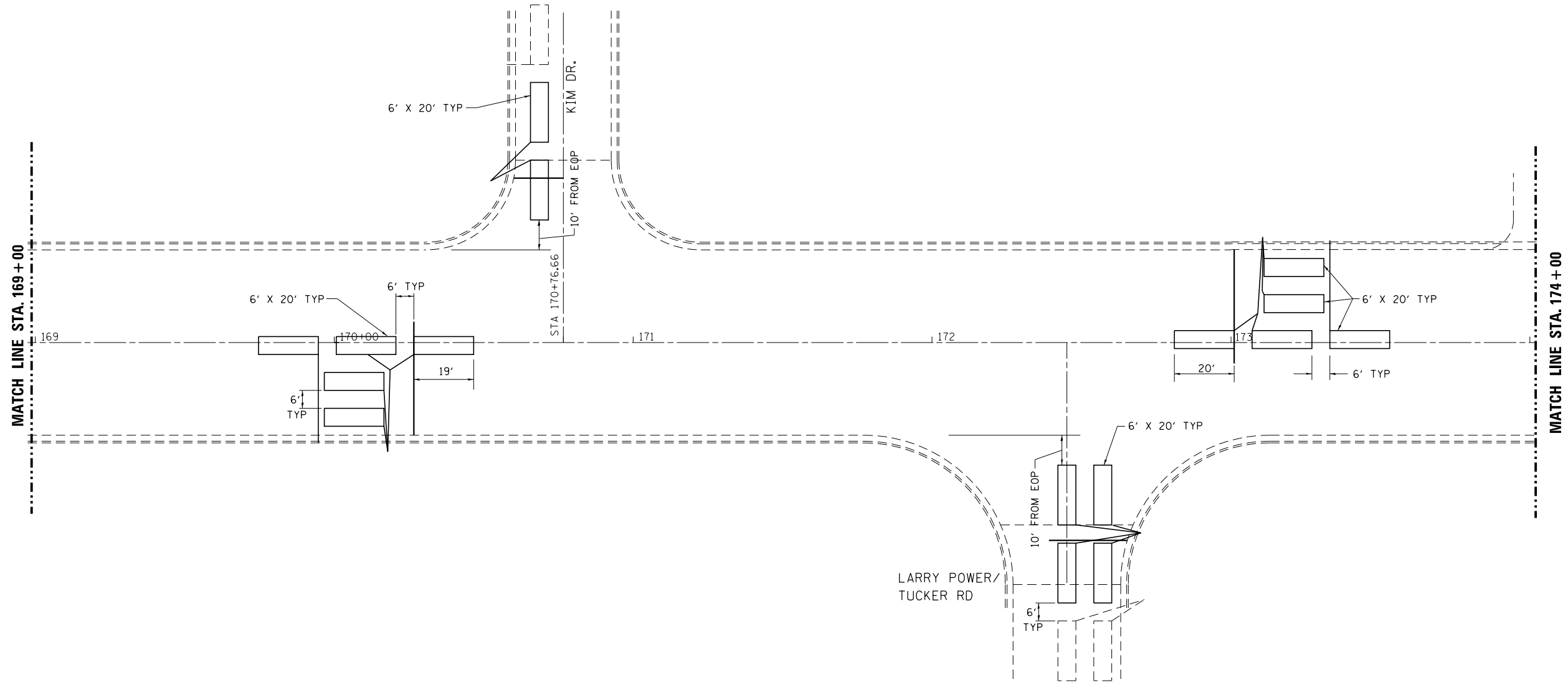

**LEGEND**

- PROPOSED DETECTOR LOOP
- EXISTING DETECTOR LOOP

FILE NAME =	USER NAME = carpenterdj	DESIGNED -	REVISED -
ci:\pw\work\p\dot\carpenterdj\dms82592\	sheets.dgn	DRAWN -	REVISED -
Default	PLOT SCALE = 40.0000' / in.	CHECKED -	REVISED -
	PLOT DATE = 6/6/2014	DATE -	REVISED -

**STATE OF ILLINOIS  
DEPARTMENT OF TRANSPORTATION**

**DETECTOR LOOP DETAILS  
LARRY POWER RD /KIM DR**

SCALE:      SHEET      OF      SHEETS      STA.      TO      STA.

F.A.P. RTE.	SECTION	COUNTY	TOTAL SHEETS	SHEET NO.
330	(15)RS-5	KANKAKEE	31	24
ILLINOIS FED. AID PROJECT			CONTRACT NO. 66427	



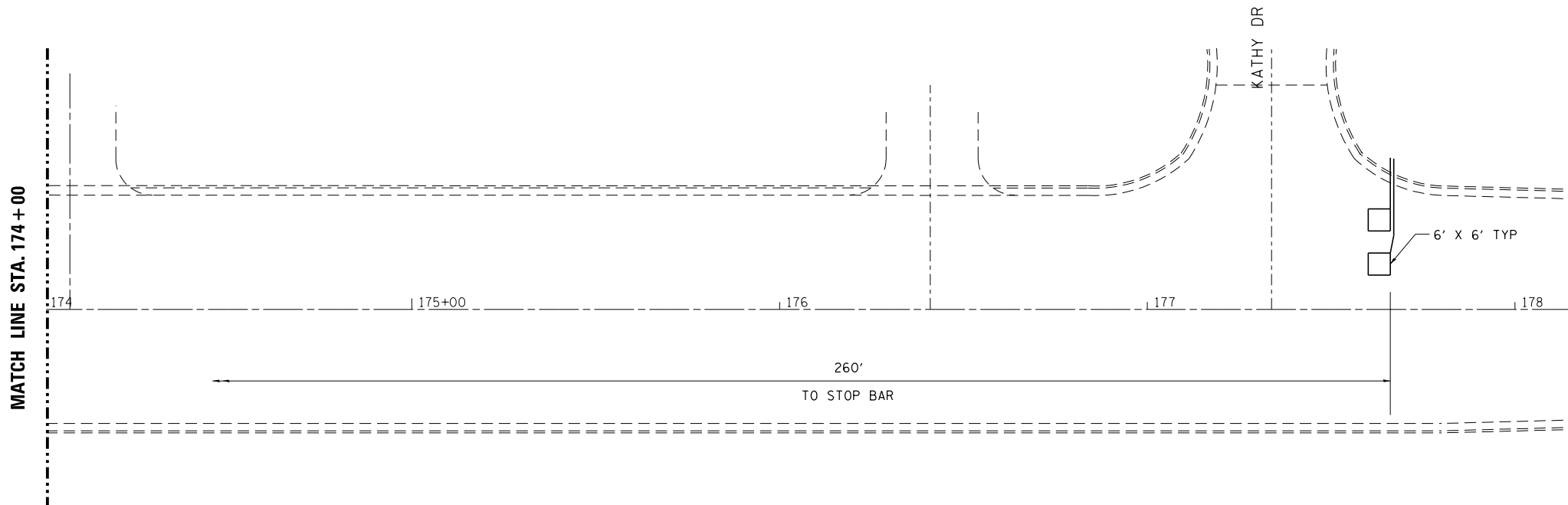
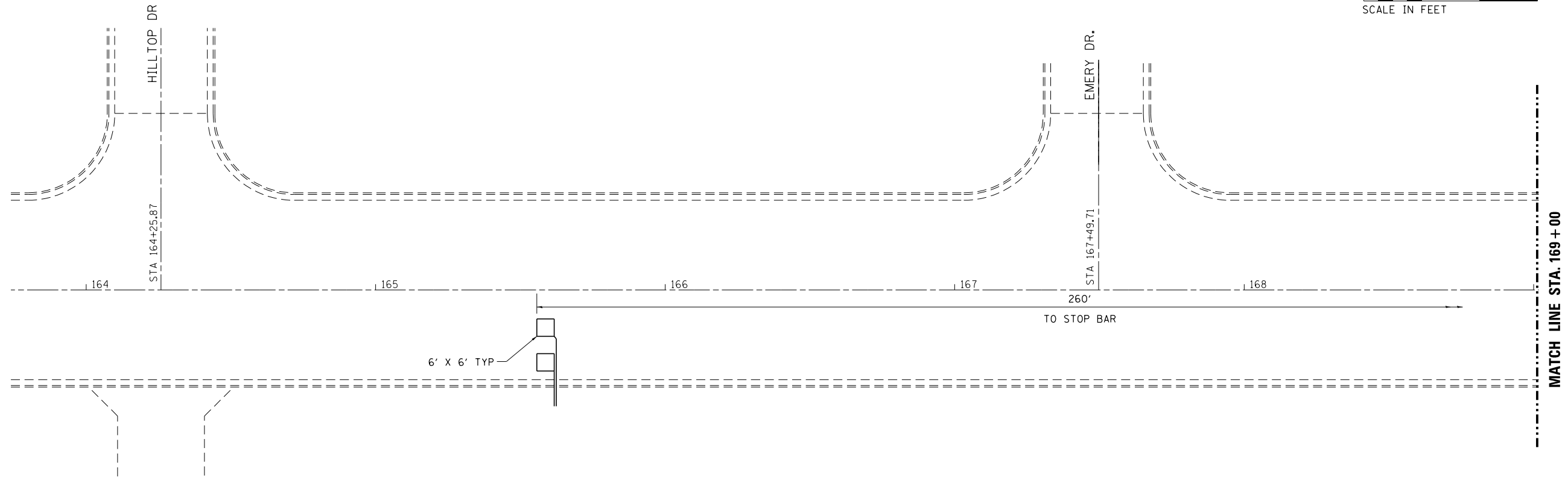
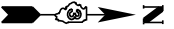

- NOTES:**
- PLEASE CONTACT TRAFFIC SIGNAL SECTION FOR PROPOSED DETECTOR LOOP DESIGN AT 815-434-8505 IF ANY OTHER LOOPS ARE DAMAGED.
  - VARIOUS SIZE DETECTOR LOOPS WITH TYPICAL 6' SPACING 10' FROM PROJECTED EDGE LINE OR DISTANCE FROM STOP BAR AS NOTED.
  - 4 TURNS REQUIRED ON ALL DETECTOR LOOPS.
  - DETECTOR LOOPS SHALL BE INSTALLED IN THE MILLED SURFACE PRIOR TO RESURFACING.
  - THE INTERSECTION OF US 45/52 WITH KIM DRIVE AND LARRY POWER ROAD SHALL BE CONSIDERED AS ONE INTERSECTION. DETECTOR LOOP TESTING WILL BE PAID FOR AS 1 EACH.

**LEGEND**

- PROPOSED DETECTOR LOOP
- EXISTING DETECTOR LOOP

FILE NAME =	USER NAME = carpenterdj	DESIGNED -	REVISED -
ci:\pw\work\p\midot\carpenterdj\dms82592\	sheets.dgn	DRAWN -	REVISED -
Default	PLOT SCALE = 40.0000' / in.	CHECKED -	REVISED -
	PLOT DATE = 6/6/2014	DATE -	REVISED -

**STATE OF ILLINOIS  
DEPARTMENT OF TRANSPORTATION**

**DETECTOR LOOP DETAILS  
LARRY POWER RD /KIM DR**

SCALE: SHEET OF SHEETS STA. TO STA.

F.A.P. RTE.	SECTION	COUNTY	TOTAL SHEETS	SHEET NO.
330	(15)RS-5	KANKAKEE	31	25
			CONTRACT NO. 66427	
ILLINOIS FED. AID PROJECT				

SEE SHEET 18  
MATCH LINE - STA. 201+00

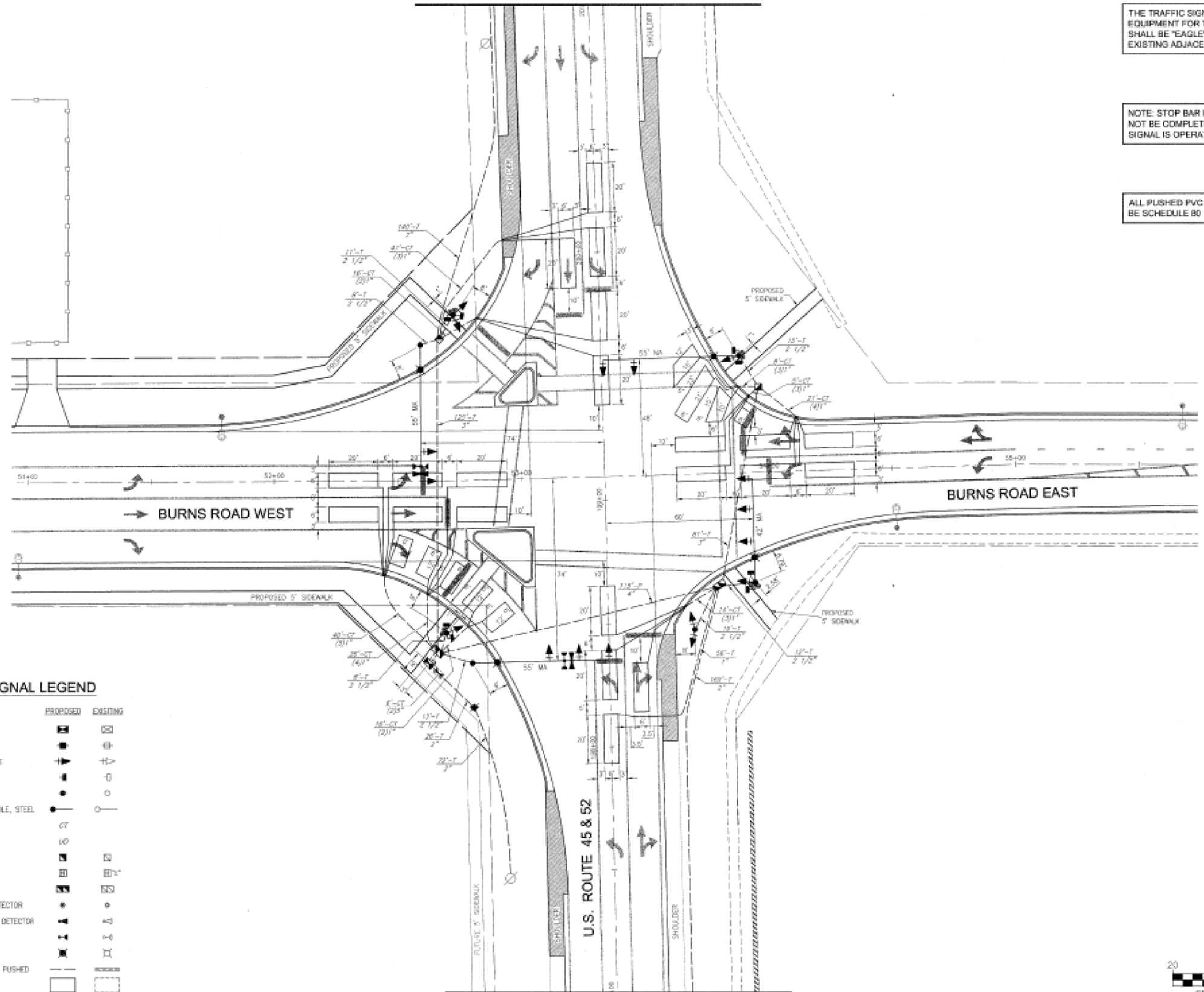

THE TRAFFIC SIGNAL CONTROL EQUIPMENT FOR THIS PROJECT SHALL BE "EAGLE" TO MATCH THE EXISTING ADJACENT SYSTEM

NOTE: STOP BAR INSTALLATION SHALL NOT BE COMPLETED UNTIL THE TRAFFIC SIGNAL IS OPERATIONAL

ALL PUSHED PVC CONDUIT SHALL BE SCHEDULE 80

**TRAFFIC SIGNAL LEGEND**

	PROPOSED	EXISTING
CONTROLLER		
SERVICE INSTALLATION		
SIGNAL HEAD WITH BACKPLATE		
SIGNAL HEAD, PEDESTRIAN		
SIGNAL POST		
MAST ARM ASSEMBLY AND POLE, STEEL		
COMMON TRENCH	CT	
UNT DUCT		
HAND-HOLE		
HEAVY DUTY HANDHOLE		
DOUBLE HANDHOLE		
PEDESTRIAN PUSHBUTTON DETECTOR		
EMERGENCY VEHICLE SYSTEM DETECTOR		
CONFIRMATION BEACON		
STREET LIGHT		
PVC CONDUIT IN TRENCH OR PUSHED		
DETECTION LOOP		

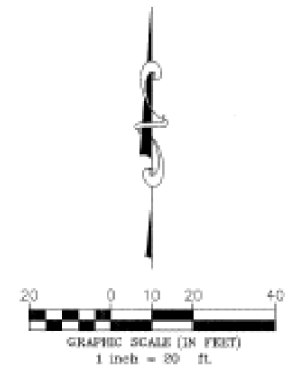

MATCH LINE - STA. 197+00  
SEE SHEET 18

**FOR INFORMATION ONLY**

FILE NAME =	USER NAME = carpenterdj	DESIGNED -	REVISED -
c:\pwork\pwork\carpenterdj\dms82592\	sheets.dgn	DRAWN -	REVISED -
Default	PLOT SCALE = 48.0000' / in.	CHECKED -	REVISED -
	PLOT DATE = 6/6/2014	DATE -	REVISED -

STATE OF ILLINOIS  
DEPARTMENT OF TRANSPORTATION

DETECTOR LOOP DETAILS			
BURNS RD			
SCALE:	SHEET	OF SHEETS	STA. TO STA.

F.A.P. RTE.	SECTION	COUNTY	TOTAL SHEETS	SHEET NO.
330	(15)RS-5	KANKAKEE	31	26
CONTRACT NO. 66427				
ILLINOIS FED. AID PROJECT				



**NOTES:**

- PLEASE CONTACT TRAFFIC SIGNAL SECTION FOR PROPOSED DETECTOR LOOP DESIGN AT 815-434-8505 IF ANY OTHER LOOPS ARE DAMAGED.
- VARIOUS SIZE DETECTOR LOOPS WITH TYPICAL 6' SPACING 10' FROM PROJECTED EDGE LINE OR DISTANCE FROM STOP BAR AS NOTED.
- 4 TURNS REQUIRED ON ALL DETECTOR LOOPS.
- DETECTOR LOOPS SHALL BE INSTALLED IN THE MILLED SURFACE PRIOR TO RESURFACING.

DETECTOR LOOP REPLACEMENT AT INDIAN OAKS		
	DETECTOR LOOP TYPE I	DETECTOR LOOP TESTING
SOUTH LEG	39	
WEST LEG	0	
NORTH LEG	0	
EAST LEG	0	
<b>TOTAL</b>	<b>39</b>	<b>1</b>

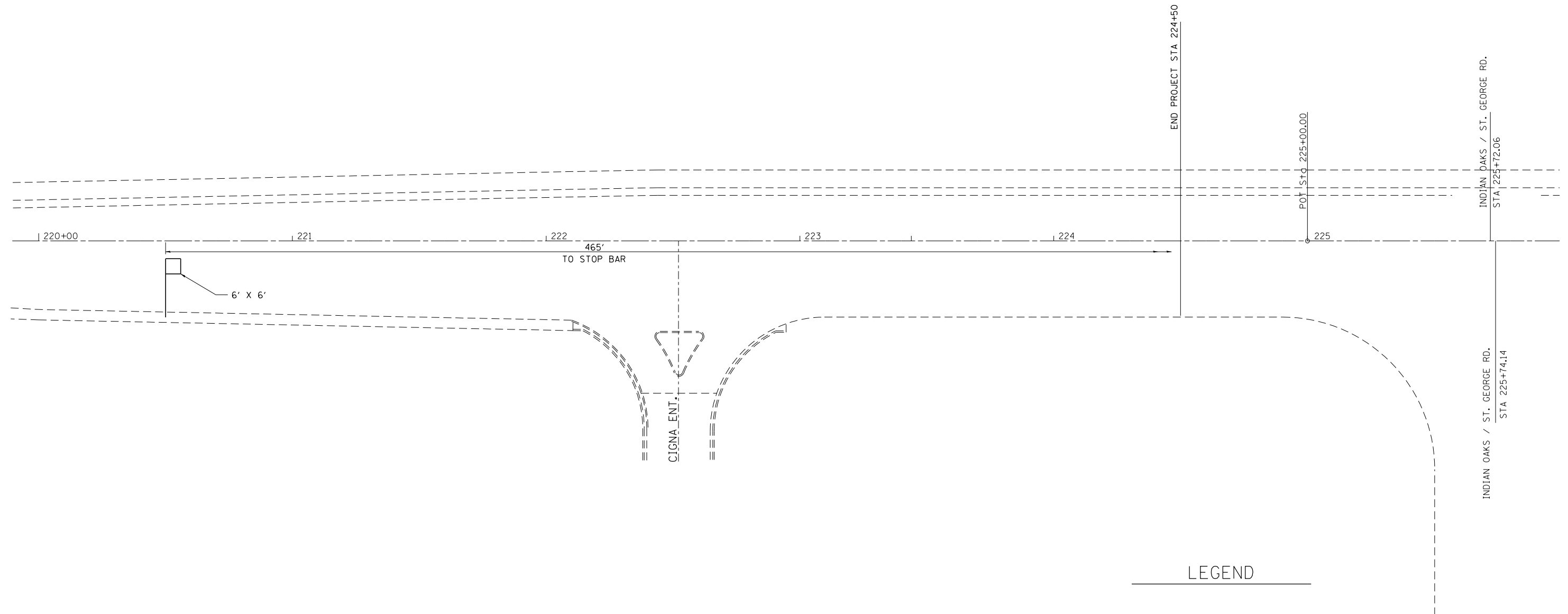
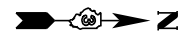

**LEGEND**

- PROPOSED DETECTOR LOOP
- EXISTING DETECTOR LOOP

FILE NAME =	USER NAME = carpenterdj	DESIGNED -	REVISED -
ci:\pw\work\p\dot\carpenterdj\dms82592\	sheets.dgn	DRAWN -	REVISED -
Default	PLOT SCALE = 40.0000' / in.	CHECKED -	REVISED -
	PLOT DATE = 6/6/2014	DATE -	REVISED -

**STATE OF ILLINOIS  
DEPARTMENT OF TRANSPORTATION**

**DETECTOR LOOP DETAILS  
INDIAN OAKS RD /ST GEORGE RD**

SCALE: SHEET OF SHEETS STA. TO STA.

F.A.P. RTE.	SECTION	COUNTY	TOTAL SHEETS	SHEET NO.
330	(15)RS-5	KANKAKEE	31	28
ILLINOIS FED. AID PROJECT			CONTRACT NO. 66427	

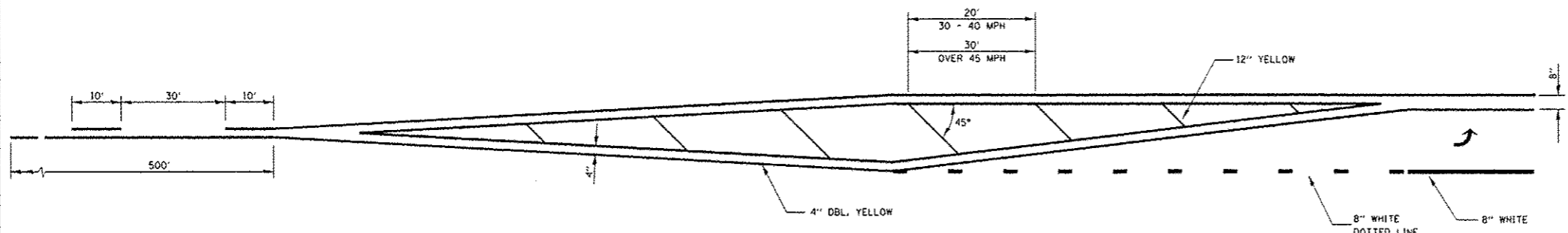

**TYPICAL APPLICATION  
MEDIAN AND LEFT TURN LANE**

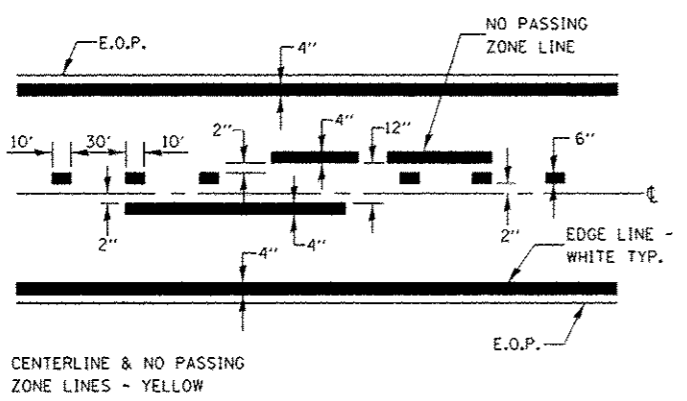

CENTERLINE & NO PASSING  
ZONE LINES - YELLOW

**PAVEMENT MARKING**

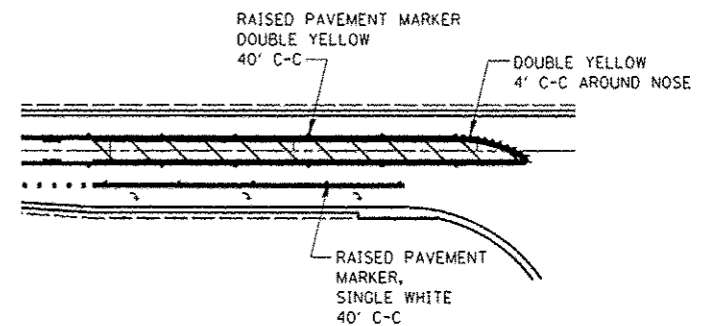

**RAISED REFLECTIVE PAVEMENT MARKERS  
MEDIAN AND RIGHT TURN LANE**

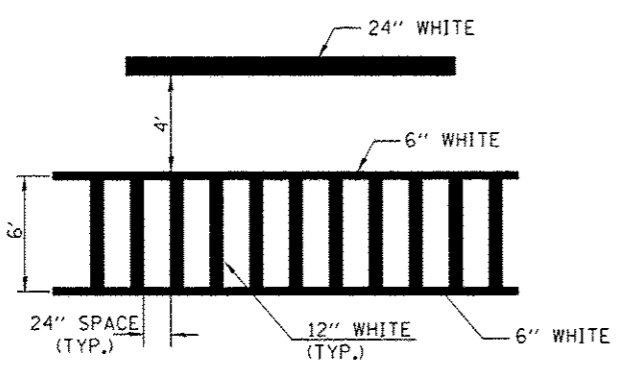

**TYPICAL SPACING DETAIL FOR  
CROSSWALKS AND STOP BARS**

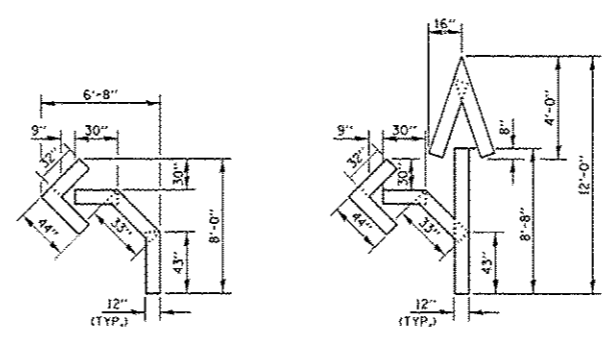

QUANTITY  
12" LINE = 16 LIN. FT.  
OR 4" LINE = 48 LIN. FT.

QUANTITY  
12" LINE = 29 LIN. FT.  
OR 4" LINE = 87 LIN. FT.

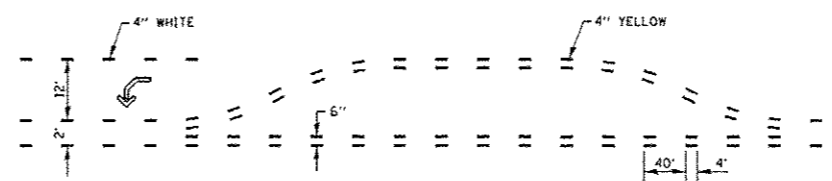

**SHORT-TERM PAVEMENT MARKING  
FOR MEDIANS AND ARROWS**

FILE NAME -	USER NAME - carpenteraj	DESIGNED -	REVISED -
c:\pwork\pwork\carpenteraj\dms02592	sheet.dgn	DRAWN -	REVISED -
Defaults	PLOT SCALE = 40.0000' / 1"	CHECKED -	REVISED -
	PLOT DATE = 6/2/2014	DATE -	REVISED -

**STATE OF ILLINOIS  
DEPARTMENT OF TRANSPORTATION**

**DETAILS**

SCALE: SHEET OF SHEETS STA. TO STA.

F.A.P. RTE.	SECTION	COUNTY	TOTAL SHEETS	SHEET NO.
330	(15)RS-5	KANKAKEE	31	29
CONTRACT NO. 66427				
ILLINOIS FED. AID PROJECT				



