

**SIDE VIEW**

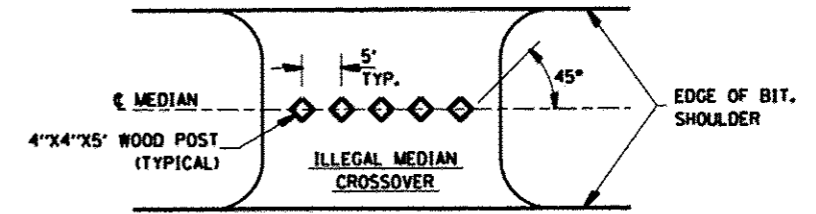

**PLAN**

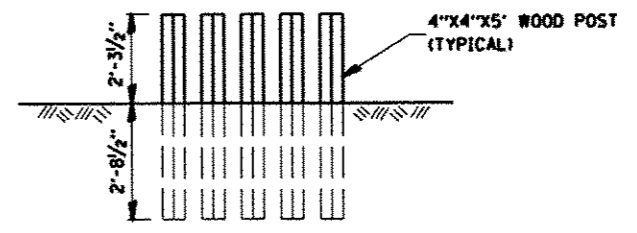

**ELEVATION**

**WOOD POST DETAIL**

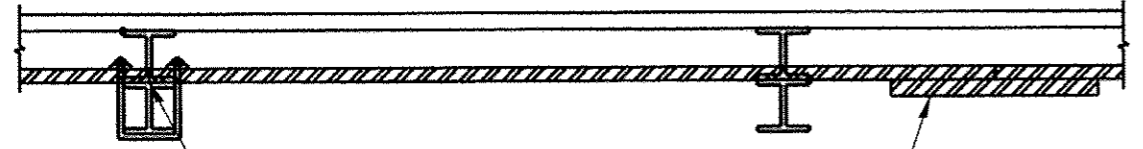

**TOP VIEW**

**IMPACT ATTENUATOR LAYOUT PLAN**

**NOTE:**  
 THE TREATED TIMBER SHALL BUTT TOGETHER AT THE GUARDRAIL POST OR SPLICED AS SHOWN ON THE DETAIL.

THE TREATED TIMBER SHALL BE TREATED IN ACCORDANCE TO ARTICLE 1007.12 AND ALL PRESERVATIVES SPECIFIED IN THE ARTICLE WILL BE ALLOWED.

THE PRICE FOR EROSION CONTROL CURB SHALL INCLUDE THE U-BOLTS ATTACHING THE TREATED TIMBER TO THE GUARDRAIL POSTS, TREATED TIMBER, AND THE NECESSARY GRADING TO COMPLETE THIS WORK.

HMA CURB REPAIR SHALL BE MEASURED AND PAID FOR AT CONTRACT UNIT PRICE PER TON.

HMA CURB REPAIR SHALL BE IN ACCORDANCE WITH SECTION 408 OF THE STANDARD SPECIFICATIONS.

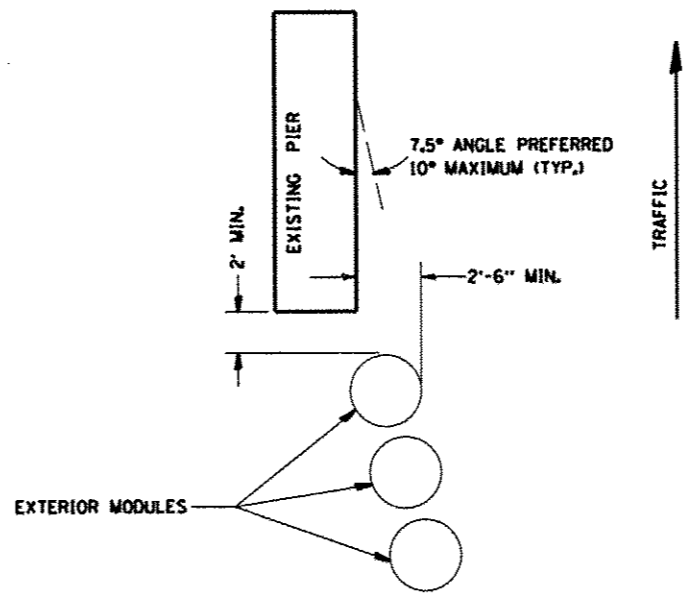

**TYPICAL EXTERIOR MODULE LAYOUT**

- NOTES:**
1. THE PAY ITEM "REPLACE IMPACT ATTENUATORS, (NON-REDIRECTIVE), TEST LEVEL 3" HAS BEEN INCLUDED TO REPLACE INDIVIDUAL DAMAGED SAND MODULES.
  2. REPLACEMENT MODULES SHALL MATCH THE KIND OF MODULES THAT ARE REMAINING.
  3. IMPACT ATTENUATORS SHALL BE IN ACCORDANCE WITH SECTION 643 FOR IMPACT ATTENUATORS.
  4. THIS SHEET SHOWS THE LAYOUT INFORMATION FOR REPLACEMENT OF SAND MODULES (IMPACT ATTENUATORS) AT A TYPICAL INTERSTATE LOCATION.
  5. ADJACENT SAND MODULE IMPACT ATTENUATORS THAT ARE NOT DAMAGED, BUT HAVE BEEN SHIFTED Laterally FROM THEIR ORIGINAL POSITION, AS DIRECTED BY THE ENGINEER, REALIGNMENT OR MOVING OF ADJACENT UN-DAMAGED MODULES SHALL NOT BE PAID FOR SEPARATELY BUT SHALL BE CONSIDERED INCLUDED IN THE COST OF REPLACEMENT. THE WORK TO REALIGN OR SHIFT UP TO 2 MODULES SHALL BE INCLUDED WITH EACH REPLACED SAND MODULE IMPACT ATTENUATOR.

**TIMBER CURB & HMA CURB REPAIR**

FILE NAME *	USER NAME * #USER#	DESIGNED -	REVISED -	STATE OF ILLINOIS DEPARTMENT OF TRANSPORTATION	TIMBER CURB & BITUMINOUS CURB REPAIR & GUARD-POST-DETAIL & IMPACT ATTENUATOR PLAN	F.A. RTE.	SECTION	COUNTY	TOTAL SHEETS	SHEET NO.	
#FILE#		DRAWN -	REVISED -			VAR.		VAR.	43	9	
PLOT SCALE * #SCALE#		CHECKED -	REVISED -			SCALE: _____ SHEET NO. ____ OF ____ SHEETS STA. _____ TO STA. _____		CONTRACT NO. 66015			
PLOT DATE * #DATE#		DATE -	REVISED -			FED. ROAD DIST. NO. _____ ILLINOIS FED. AID PROJECT					

• D-3 HIGHWAY DAMAGE REPAIR 2015