

STATE OF ILLINOIS  
DEPARTMENT OF TRANSPORTATION  
DIVISION OF HIGHWAYS  
**PROPOSED  
SPRING ROAD REPAIR**

FOR INDEX OF SHEETS, SEE SHEET NO. 2

FAP ROUTE 506 (IL 96)  
SECTION (10) I

BRIDGE DECK PATCHING  
ADAMS COUNTY

C-96-094-14

WHEREVER IN THESE PLANS SECTION D6 SPRING RD REPAIR 2014-22 IS MENTIONED, IT SHALL MEAN SECTION (10) I

F.A.P. RTE.	SECTION	COUNTY	TOTAL SHEETS	SHEET NO.
506		ADAMS	8	1

\*(10) I

D-96-094-14

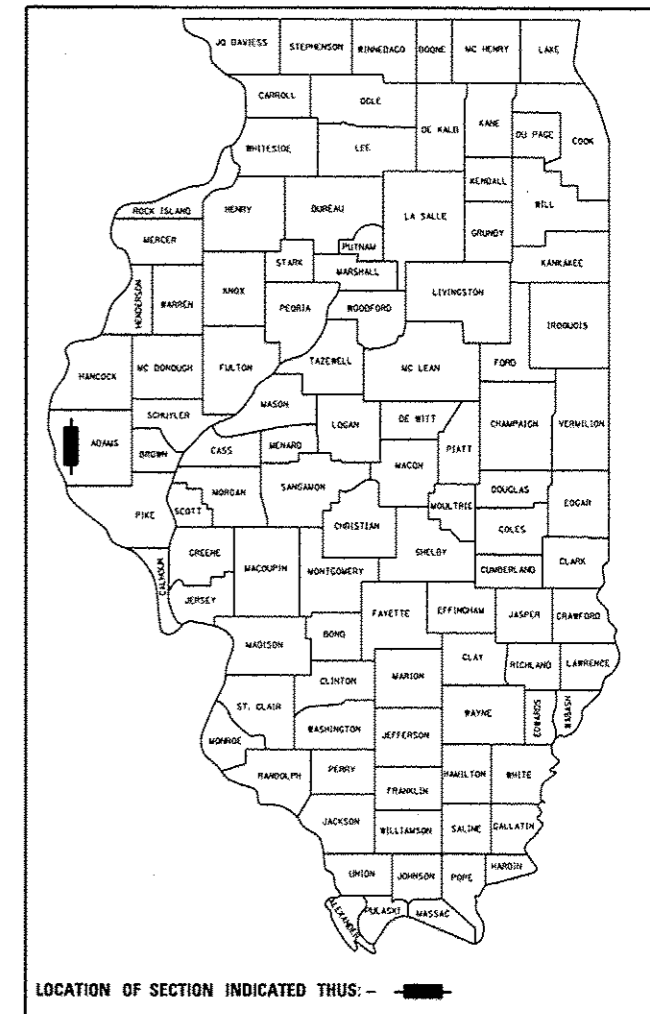

F.A.P. 506 (IL 96)  
ADT (2013) : 4550  
HCV = 5.93% SU = 2.64% MU = 3.30%  
SPEED LIMIT: 55 MPH (POSTED)

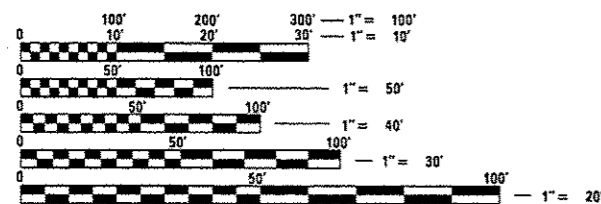

FULL SIZE PLANS HAVE BEEN PREPARED USING STANDARD ENGINEERING SCALES. REDUCED SIZED PLANS WILL NOT CONFORM TO STANDARD SCALES. IN MAKING MEASUREMENTS ON REDUCED PLANS, THE ABOVE SCALES MAY BE USED.

J.U.L.I.E.  
JOINT UTILITY LOCATION INFORMATION FOR EXCAVATION  
1-800-892-0123  
OR 811

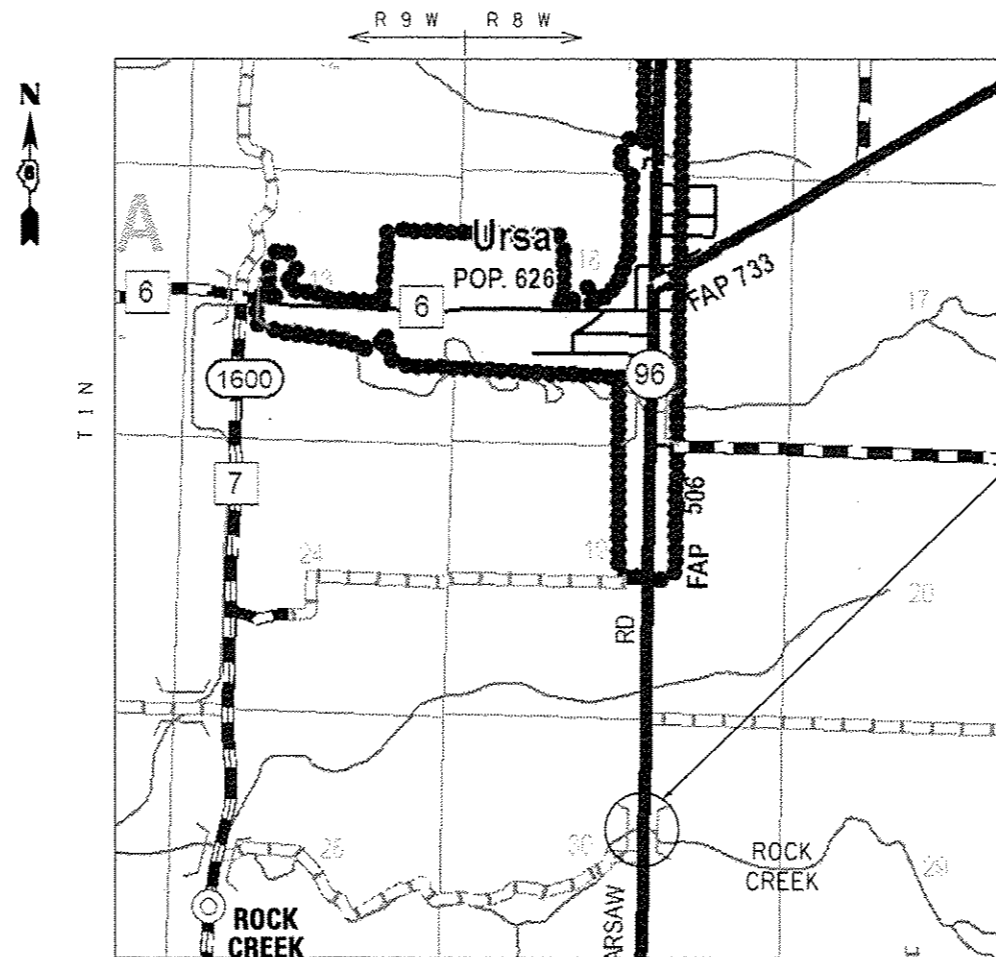

PROJECT LOCATION:  
SN 001-0008  
STA. 141+19.55  
BRIDGE OVER ROCK CREEK

LOCATION MAP

NET LENGTH = 107.50 FT = 0.020 MILE

BRIDGE MAINTENANCE ENGINEER (ACTING): BRANDON DUDLEY (217) 785-9290  
BRIDGE INSPECTION ENGINEER: DAVE COPENBARGER (217) 785-5306

CONTRACT NO. 72H23

STATE OF ILLINOIS  
DEPARTMENT OF TRANSPORTATION  
DIVISION OF HIGHWAYS

SUBMITTED May 16 20 14  
*Regis Z. Drubka*  
DEPUTY DIRECTOR OF HIGHWAYS, REGION ENGINEER

June 27 20 14  
*John D. Baranzelli, P.E.*  
ENGINEER OF DESIGN AND ENVIRONMENT

June 27 20 14  
*Chris Osman, P.E.*  
DIRECTOR OF HIGHWAYS, CHIEF ENGINEER

**PRINTED BY THE AUTHORITY  
OF THE STATE OF ILLINOIS**