

**STATE OF ILLINOIS**  
**DEPARTMENT OF TRANSPORTATION**  
**DIVISION OF HIGHWAYS**  
**PROPOSED**  
**HIGHWAY PLANS**

F.A.P. RTE.	SECTION	COUNTY	TOTAL SHEETS	SHEET NO.
717	(102)RS-4, (103)RS-3	LOGAN	25	1
		ILLINOIS	CONTRACT NO. 72H27	

**INDEX OF SHEETS**

- 1: COVER SHEET
- 2: GENERAL NOTES
- 3-4: SUMMARY OF QUANTITIES
- 5-7: TYPICAL SECTIONS
- 8-11: SCHEDULE OF QUANTITIES
- 12-21: PLAN SHEETS
- 22: BUTT JOINT & RAMP DETAILS
- 23: SUPERELEVATION TRANSITION DETAILS
- 24-25: ENTRANCE DETAIL

**HIGHWAY STANDARDS**

000001-06	701201-04
001006	701306-03
442201-03	701311-03
630001-10	701421-06
701001-02	701901-03
701006-05	780001-04
701011-04	781001-03

FAP 717(IL 10)  
 ADT 2800 (2012)  
 TRUCK 530 (2012)  
 SU 15.71%  
 MU 3.21%

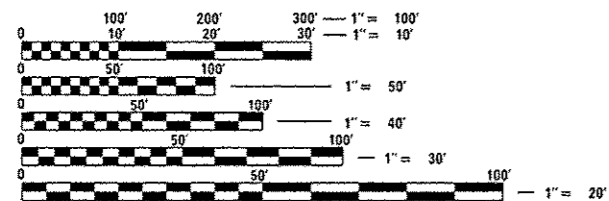

FULL SIZE PLANS HAVE BEEN PREPARED USING STANDARD ENGINEERING SCALES. REDUCED SIZED PLANS WILL NOT CONFORM TO STANDARD SCALES. IN MAKING MEASUREMENTS ON REDUCED PLANS, THE ABOVE SCALES MAY BE USED.

J.U.L.I.E.  
 JOINT UTILITY LOCATION INFORMATION FOR EXCAVATION  
 1-800-892-0123  
 OR 811

**PROJECT ENGINEER: KEITH DONOVAN (217)782-4761**  
**TEAM MANAGER: ED KERN (217)524-7547**  
**CONTRACT NO. 72H27**

**FAP ROUTE 717 (IL 10)**  
**SECTION (102)RS-4, (103)RS-3**

**LOGAN COUNTY**  
**C-96-098-14**

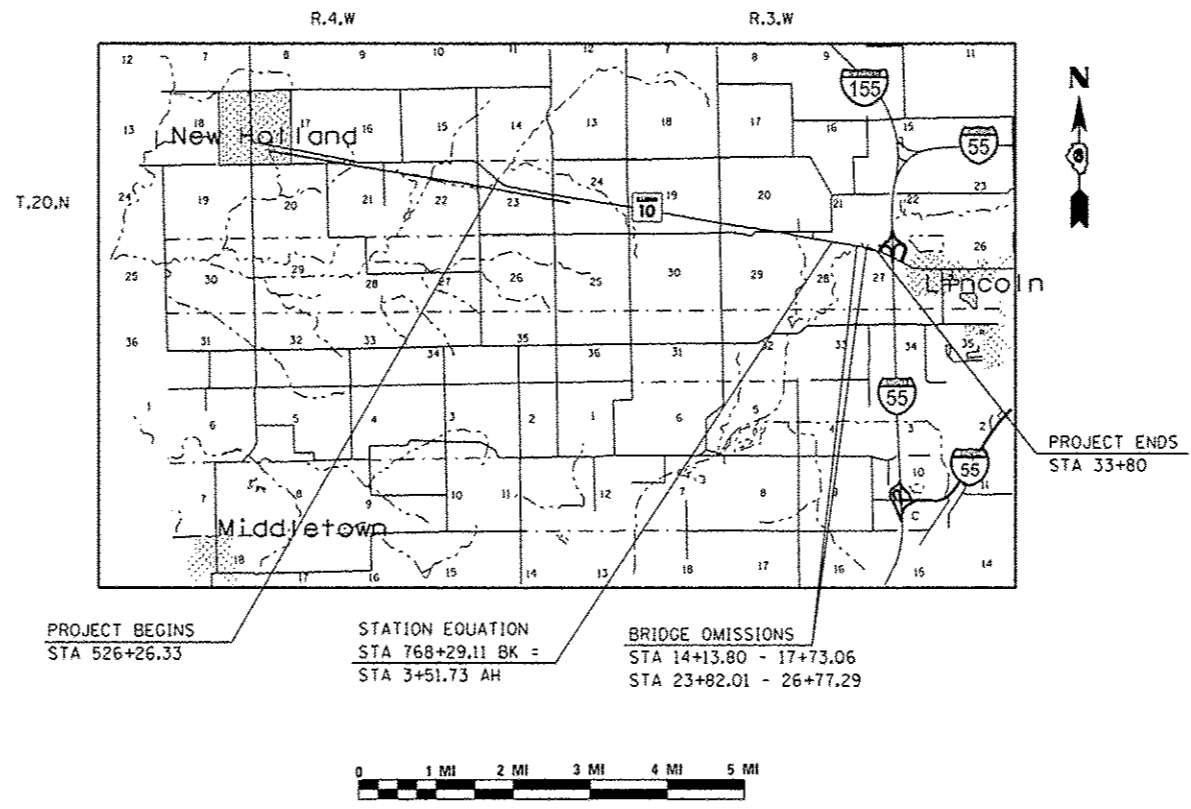

PROJECT BEGINS STA 526+26.33

STATION EQUATION  
 STA 768+29.11 BK =  
 STA 3+51.73 AH

BRIDGE OMISSIONS  
 STA 14+13.80 - 17+73.06  
 STA 23+82.01 - 26+77.29



LOCATION OF SECTION INDICATED THUS: ———

STATE OF ILLINOIS  
 DEPARTMENT OF TRANSPORTATION  
 DIVISION OF HIGHWAYS

SUBMITTED June 6, 2014  
Roger L. Driskell, JEM  
 DEPUTY DIRECTOR OF HIGHWAYS, REGION ENGINEER

June 27, 2014  
John D. Baranzelli, P.E.  
 acting ENGINEER OF DESIGN AND ENVIRONMENT

June 27, 2014  
Omer Osman, P.E.  
 DIRECTOR OF HIGHWAYS, CHIEF ENGINEER

**PRINTED BY THE AUTHORITY**  
**OF THE STATE OF ILLINOIS**

GROSS LENGTH = 27,231.05 FT. = 5.16 MILE  
 NET LENGTH = 26,576.51 FT. = 5.03 MILE

# GENERAL NOTES

## GENERAL NOTES

- ① WHERE SECTION OR SUBSECTION MONUMENTS ARE ENCOUNTERED, THE ENGINEER SHALL BE NOTIFIED BEFORE SUCH MONUMENTS ARE REMOVED. THE CONTRACTOR SHALL PROTECT AND CAREFULLY PRESERVE ALL PROPERTY MARKS, MONUMENTS, AND PERMANENT SURVEY MARKERS UNTIL THE OWNER, AND AUTHORIZED SURVEYOR OR AGENT HAS WITNESSES OR OTHERWISE REFERENCED THEIR LOCATION.
- ② THE NOMINAL THICKNESS FOR BASE AND SURFACE COURSES ARE SHOWN ON THE TYPICAL SECTIONS, STANDARDS, SCHEDULES, OR SPECIAL DETAILS. THE CONSTRUCTED THICKNESS OF THE ABOVE ITEM SHALL NOT BE LESS THAN 90 PERCENT OF THE NOMINAL THICKNESS AT ANY LOCATION.
- ③ THE THICKNESS OF BITUMINOUS MIXTURE SHOWN ON THE PLANS IS THE NOMINAL THICKNESS. DEVIATIONS FROM THE NOMINAL THICKNESS WILL BE PERMITTED WHEN SUCH DEVIATION OCCUR DUE TO IRREGULARITIES IN THE EXISTING SURFACE OR BASE ON WHICH THE BITUMINOUS MIXTURE IS PLACED.
- ④ ANY REFERENCE TO A STANDARD IN THE PLANS SHALL BE INTERPRETED TO MEAN THE EDITION, AS INDICATED BY THE SUB-NUMBER LISTED IN THE INDEX OF SHEETS, OR THE COPY OF THE STANDARD INCLUDED IN THE PLANS.
- ⑤ UNLESS NOTED OTHERWISE, STATIONS AND OFFSETS REFER TO CENTERLINE OF PROJECT.
- ⑥ IN ADDITION TO FIELD SURVEYS AND AERIAL SURVEYS, PLAN DIMENSIONS AND DETAILS RELATIVE TO THE EXISTING FACILITIES HAVE BEEN TAKEN FROM EXISTING PLANS AND ARE SUBJECT TO CONSTRUCTION VARIATIONS. IT SHALL BE THE CONTRACTORS RESPONSIBILITY TO VERIFY SUCH DIMENSIONS AND DETAILS IN THE FIELD. SUCH VARIATIONS SHALL NOT BE A CAUSE FOR ADDITIONAL COMPENSATIONS DUE TO A CHANGE IN THE SCOPE OF THE WORK, HOWEVER, THE CONTRACTOR WILL BE PAID FOR THE QUANTITY ACTUALLY FURNISHED AT THE UNIT PRICE BID FOR THE WORK.
- ⑦ CONTACT OPERATIONS TO VERIFY NO PASSING ZONES AT (217) 785-5312.

⑧ THE FOLLOWING MIXTURE REQUIREMENTS ARE APPLICABLE:

Location(s):	
Mixture Use(s):	Leveling Binder
PG:	PG 64-22
Design Air Voids:	4.0% @ N70
Mixture Composition:	IL 9.5
Friction Aggregate:	N/A
Quality Management:	OCP

Location(s):	
Mixture Use(s):	Surface/HMA Shoulders
PG:	PG 64-22
Design Air Voids:	4.0% @ N70
Mixture Composition:	IL 9.5 or 12.5
Friction Aggregate:	Mix C
Quality Management:	OCP

Location(s):	
Mixture Use(s):	Incidental
PG:	PG 64-22
Design Air Voids:	4.0% @ N50
Mixture Composition:	IL 9.5 or 12.5
Friction Aggregate:	Mix C
Quality Management:	OC/OA

Location(s):	
Mixture Use(s):	Pavement Patching
PG:	PG 64-22
Design Air Voids:	4.0% @ N70
Mixture Composition:	IL 19.0
Friction Aggregate:	N/A
Quality Management:	OC/OA

## RATES OF APPLICATION TABLES

THE FOLLOWING RATES OF APPLICATION HAVE BEEN ASSUMED IN CALCULATING PLAN QUANTITIES.

BITUMINOUS MATERIALS (PRIME COAT): 0.00038 TON / SQ YD  
 AGGREGATE MATERIALS (PRIME COAT): 0.002 TON / SQ YD  
 HOT-MIX ASPHALT SURFACE LEVELING BINDER (112 LBS): 0.056 TON / SQ YD • in  
 HOT-MIX ASPHALT SURFACE MIX D (112 LBS): 0.056 TON / SQ YD • in  
 AGGREGATE MATERIALS: 1.85 TON / CU YD

## COMMITMENTS

THE RESIDENT ENGINEER SHALL CONTACT STUDIES AND PLANS ON ANY MAJOR PLAN CHANGES MADE DURING CONSTRUCTION.

DISTRICT SIX	
EXAMINED	JUNE 5 <sup>th</sup> 20 14
<i>John C. Cunningham</i>	
OPERATIONS ENGINEER	
EXAMINED	JUNE 5 20 14
<i>Bonnie Chamberlain</i>	
PROJECT IMPLEMENTATION ENGINEER	
EXAMINED	JUNE 5 20 14
<i>Jeffrey P. Meyer</i>	
PROGRAM DEVELOPMENT ENGINEER	

CODE NO.	ITEM	UNIT	TOTAL QUANTITY	CONSTR. CODE
				100% STATE IL 10 LOGAN ROADWAY 0005 RURAL
35800100	PREPARATION OF BASE	SO YD	756	756
40200800	AGGREGATE SURFACE COURSE, TYPE B	TON	22	22
40600275	BITUMINOUS MATERIALS (PRIME COAT)	POUND	59,000	59,000
40600300	AGGREGATE (PRIME COAT)	TON	155.1	155.1
40600635	LEVELING BINDER (MACHINE METHOD), N70	TON	3,105	3,105
40600982	HOT-MIX ASPHALT SURFACE REMOVAL - BUTT JOINT	SO YD	1,050	1,050
40600990	TEMPORARY RAMP	SO YD	142	142
40603315	HOT-MIX ASPHALT SURFACE COURSE, MIX "C", N70	TON	6,210	6,210
40800050	INCIDENTAL HOT-MIX ASPHALT SURFACING	TON	400	400
44000158	HOT-MIX ASPHALT SURFACE REMOVAL, 2 1/4"	SO YD	12,338	12,338
44200168	PAVEMENT PATCHING, TYPE II, 14 INCH	SO YD	544	544
44200172	PAVEMENT PATCHING, TYPE III, 14 INCH	SO YD	200	200
44200174	PAVEMENT PATCHING, TYPE IV, 14 INCH	SO YD	60	60
48102100	AGGREGATE WEDGE SHOULDER, TYPE B	TON	1,214	1,214

CODE NO.	ITEM	UNIT	TOTAL QUANTITY	CONSTR. CODE
				100% STATE IL 10 LOGAN ROADWAY 0005 RURAL
48203100	HOT-MIX ASPHALT SHOULDERS	TON	479	479
67000400	ENGINEER'S FIELD OFFICE, TYPE A	CAL MO	6	6
67100100	MOBILIZATION	L SUM	1	1
70100310	TRAFFIC CONTROL AND PROTECTION, STANDARD 701421	L SUM	1	1
70100450	TRAFFIC CONTROL AND PROTECTION, STANDARD 701201	L SUM	1	1
70100460	TRAFFIC CONTROL AND PROTECTION, STANDARD 701306	L SUM	1	1
70300100	SHORT TERM PAVEMENT MARKING	FOOT	11,487	11,487
70301000	WORK ZONE PAVEMENT MARKING REMOVAL	SO FT	1,276	1,276
* 78000300	THERMOPLASTIC PAVEMENT MARKING - LINE 5"	FOOT	2,210	2,210
* 78000600	THERMOPLASTIC PAVEMENT MARKING - LINE 12"	FOOT	330	330
* 78001120	PAINT PAVEMENT MARKING - LINE 5"	FOOT	69,148	69,148
* 78001180	PAINT PAVEMENT MARKING - LINE 24"	FOOT	29	29
* 78100100	RAISED REFLECTIVE PAVEMENT MARKER	EACH	359	359
78300200	RAISED REFLECTIVE PAVEMENT MARKER REMOVAL	EACH	359	359

\* SPECIALTY ITEM

FILE NAME :	USER NAME : sperkagu	DESIGNED -	REVISED -	<b>STATE OF ILLINOIS DEPARTMENT OF TRANSPORTATION</b>	<b>SUMMARY OF QUANTITIES</b>				F.A.P. RTE.	SECTION	COUNTY	TOTAL SHEETS	SHEET NO.		
d:\pc\work\p\dot\sparkagu\0402311\0672	27-ahf-500.dgn	DRAWN -	REVISED -		SCALE:	SHEET	OF	SHEETS	STA.	TO STA.	117	102IRS-4,103IRS-3	LOGAN	25	3
Default	PLOT SCALE * 100.0000 / in	CHECKED -	REVISED -		CONTRACT NO. 72H27										
	PLOT DATE * Jun-05-2014 01:52:41PM	DATE -	REVISED -		ILLINOIS FED. AID PROJECT										

10/28/14

CODE NO.	ITEM	UNIT	TOTAL QUANTITY	CONSTR. CODE	
				100% STATE IL 10 LOGAN ROADWAY 0005 RURAL	
X4401198	HOT-MIX ASPHALT SURFACE REMOVAL, VARIABLE DEPTH	SQ YD	64,404	64,404	
* X6330200	VERTICAL ADJUSTMENT OF TRAFFIC BARRIER TERMINAL	EACH	12	12	
* X6330900	VERTICAL ADJUSTMENT OF GUARDRAIL	FOOT	3,656	3,656	

3

\* SPECIALTY ITEM

FILE NAME : c:\pwork\pwork\sparkg\10402311\0672				USER NAME : sparkg				DESIGNED -		REVISED -		<b>STATE OF ILLINOIS DEPARTMENT OF TRANSPORTATION</b>				<b>SUMMARY OF QUANTITIES</b>				F.A.P. RTE.	SECTION		COUNTY	TOTAL SHEETS	SHEET NO.
PLOT SCALE : 100.0000 / in				DRAWN -				REVISED -		717	1102/RS-4,1103/RS-3									LOGAN	25	4			
PLOT DATE : Jun-05-2014 01:52:11PM				CHECKED -				REVISED -		SCALE: SHEET OF SHEETS STA. TO STA.						CONTRACT NO. 72H27									
Default				DATE -				REVISED -		ILLINOIS FED. AID PROJECT															



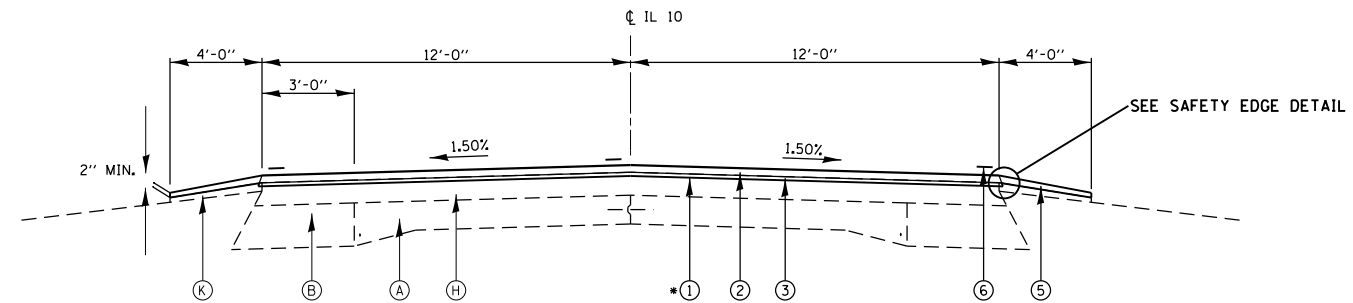

**TYPICAL #3**

STA. 566+00 TO STA. 768+29.11

S.O. STA. 768+29.11 BK = STA. 3+51.73 AH

STA. 3+51.73 TO STA. 4+22.62

\*⑦ STA 766+35 TO 4+22.62

**LEGEND**

- Ⓐ EXIST. PCC PAVEMENT 9-6-9
- Ⓑ EXIST. HMA BASE COURSE WIDENING 9"
- Ⓒ EXIST. PCC BASE COURSE WIDENING 8"
- Ⓓ EXIST. HMA BASE COURSE 10"
- Ⓔ EXIST. SUB-BASE GRANULAR MAT. TY A 4"
- Ⓕ EXIST. HMA OVERLAY, 3"
- Ⓖ EXIST. HMA OVERLAY, 3 3/4"
- Ⓗ EXIST. HMA OVERLAY, 4 3/4"
- ① EXIST. HMA OVERLAY, 5 3/4"
- Ⓙ EXIST. HMA SHOULDER
- Ⓚ EXIST. AGGREGATE SHOULDER
  
- ① PROP. HMA SURFACE REMOVAL, VARIABLE DEPTH"
- ② PROP. HMA SURFACE COURSE, MIX "C" N70, 1.5"
- ③ PROP. HMA LEVEL BINDER (MACHINE METHOD) 3/4"
- ④ PROP. HMA SHOULDERS
- ⑤ PROP. AGGREGATE WEDGE SHOULDERS, TY B
- ⑥ PROP. PAVEMENT MARKING, 5"
- ⑦ PROP. HMA SURFACE REMOVAL, 2 1/4"

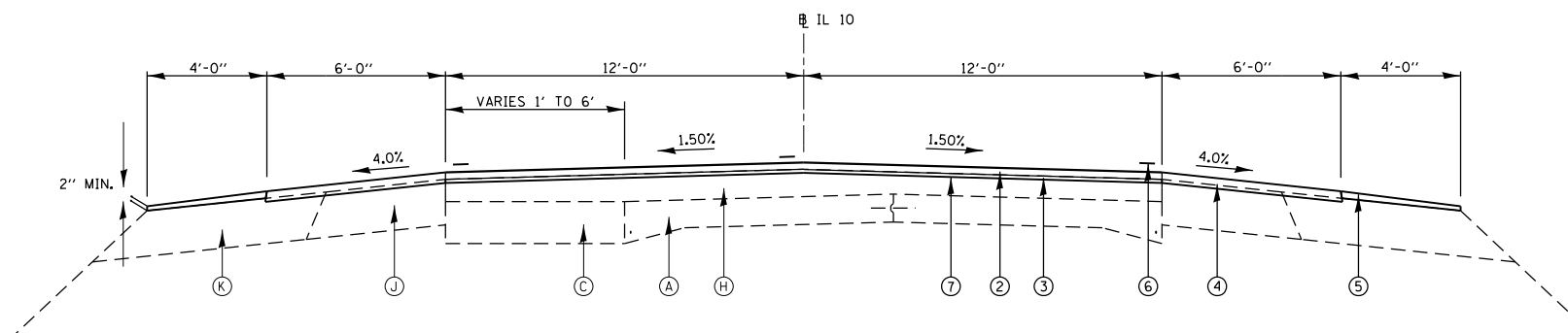

**TYPICAL #4**

STA. 4+22.62 TO STA. 14+13.80

BRIDGE OMISSION STA. 14+13.80 TO STA. 17+73.06

STA. 17+73.06 TO STA. 23+82.01

BRIDGE OMISSION STA. 23+82.01 TO STA. 26+77.29

**NOTES:**

1. WIDENING TAPERS FROM 4' TO 3' @ STA. 565+75 TO 566+00.
2. OUTSIDE AGGREGATE SHOULDER THICKNESS HAS BEEN INCREASED FROM PAST DISTRICT 6 DESIGNS OF 1". THIS ADDITIONAL THICKNESS IS TO PROVIDE D6 OPERATIONS ADDITIONAL MATERIAL TO PULL UP FOR MAINTENANCE PURPOSES.
3. WHERE THE EARTH SHOULDER IS NOT WIDE ENOUGH FOR A 4' AGGREGATE SHOULDER, MATCH THE EARTH SHOULDER WIDTH

FILE NAME =	USER NAME = sparksgw	DESIGNED -	REVISED -	<b>STATE OF ILLINOIS DEPARTMENT OF TRANSPORTATION</b>	<b>TYPICAL SECTIONS</b>			F.A.P. RTE.	SECTION	COUNTY	TOTAL SHEETS	SHEET NO.
Default	Plot Scale = 100.0000' / in.	DRAWN -	REVISED -					SCALE:	SHEET OF SHEETS	STA. TO STA.	717	(102)RS-4,(103)RS-3
	PLOT DATE = Jun-06-2014 01:53:49PM	CHECKED -	REVISED -					CONTRACT NO. 72H27				
		DATE -	REVISED -					ILLINOIS FED. AID PROJECT				



40603315		HOT-MIX ASPHALT SURFACE COURSE, MIX "C", N70							TONS	
LOCATION	DIRECTION	STATION	TO	STATION	LENGTH (FOOT)	AVG. WIDTH (FOOT)	AREA (SQ YD)	QUANTITY (TONS)	REMARKS	
ML	EB	526+26.33	TO	566+00.00	3973.67	13.0	5,739.7	482.1		
ML	EB	566+00.00	TO	768+29.11	20229.11	12.0	26,972.1	2,265.7		
STATION EQUATION 768+29.11 BK = 3+51.73 AH										
ML	EB	3+51.73	TO	14+13.80	1062.07	12.0	1,416.1	119.0		
BRIDGE OMISSION 14+13.80 TO 17+73.06										
ML	EB	17+73.06	TO	23+82.01	608.95	12.0	811.9	68.2		
BRIDGE OMISSION 23+82.01 TO 26+77.29										
ML	EB	26+77.29	TO	28+08.00	130.71	22.0	319.5	26.8		
EB PASSING LANE		28+08.00	TO	33+80.00	572.00	12.0	762.7	64.1		
EB DRIVING LANE		28+08.00	TO	33+80.00	572.00	12.0	762.7	64.1		
<b>TOTAL</b>								<b>3,089.9</b>		
ML	WB	526+26.33	TO	566+00.00	3973.67	13.0	5,739.7	482.1		
ML	WB	566+00.00	TO	768+29.11	20229.11	12.0	26,972.1	2,265.7		
STATION EQUATION 768+29.11 BK = 3+51.73 AH										
ML	WB	3+51.73	TO	14+13.80	1062.07	12.0	1,416.1	119.0		
BRIDGE OMISSION 14+13.80 TO 17+73.06										
ML	WB	17+73.06	TO	23+82.01	608.95	12.0	811.9	68.2		
BRIDGE OMISSION 23+82.01 TO 26+77.29										
ML	WB	26+77.29	TO	28+08.00	130.71	14.7	213.5	17.9	WIDTH VARIES FROM 11'-4" TO 18'	
WB DRIVING LANE		28+08.00	TO	33+80.00	572.00	19.5	1,239.3	104.1	WIDTH VARIES FROM 16' TO 23'	
GORE AREA		28+08.00	TO	33+80.00	572.00	11.8	746.8	62.7	WIDTH VARIES FROM 2' TO 21'-6"	
<b>TOTAL</b>								<b>3,119.7</b>		
<b>GRAND TOTAL</b>								<b>6,209.6</b>		

48203100		HOT-MIX ASPHALT SHOULDERS							TONS	
LOCATION	DIRECTION	STATION	TO	STATION	LENGTH (FOOT)	AVG. WIDTH (FOOT)	AREA (SQ YD)	DEPTH (IN)	QUANTITY (TONS)	REMARKS
ML	EB	526+26.33	TO	527+00.00	73.7	3.0	24.6	2.25	3.1	
ML	EB	4+22.62	TO	14+13.80	991.2	6.0	660.8	2.25	83.3	
BRIDGE OMISSION 14+13.80 TO 17+73.06										
ML	EB	17+73.06	TO	23+82.01	609.0	6.0	406.0	2.25	51.2	
BRIDGE OMISSION 23+82.01 TO 26+77.29										
ML	EB	26+77.29	TO	33+80.00	702.7	11.0	858.9	2.25	108.2	
ML	WB	526+26.33	TO	527+00.00	73.7	3.0	24.6	2.25	3.1	
ML	WB	4+22.62	TO	14+13.80	991.2	6.0	660.8	2.25	83.3	
BRIDGE OMISSION 14+13.80 TO 17+73.06										
ML	WB	17+73.06	TO	23+82.01	609.0	6.0	406.0	2.25	51.2	
BRIDGE OMISSION 23+82.01 TO 26+77.29										
ML	WB	26+77.29	TO	33+80.00	702.7	10.0	780.8	2.25	98.4	
<b>TOTAL</b>								<b>478.5</b>		

40600635		LEVELING BINDER (MACHINE METHOD), N70							TONS	
LOCATION	DIRECTION	STATION	TO	STATION	LENGTH (FOOT)	AVG. WIDTH (FOOT)	AREA (SQ YD)	QUANTITY (TONS)	REMARKS	
ML	EB	526+26.33	TO	566+00.00	3973.67	13.0	5,739.7	241.1		
ML	EB	566+00.00	TO	768+29.11	20229.11	12.0	26,972.1	1,132.8		
STATION EQUATION 768+29.11 BK = 3+51.73 AH										
ML	EB	3+51.73	TO	14+13.80	1062.07	12.0	1,416.1	59.5		
BRIDGE OMISSION 14+13.80 TO 17+73.06										
ML	EB	17+73.06	TO	23+82.01	608.95	12.0	811.9	34.1		
BRIDGE OMISSION 23+82.01 TO 26+77.29										
ML	EB	26+77.29	TO	28+08.00	130.71	22.0	319.5	13.4		
EB PASSING LANE		28+08.00	TO	33+80.00	572.00	12.0	762.7	32.0		
EB DRIVING LANE		28+08.00	TO	33+80.00	572.00	12.0	762.7	32.0		
<b>TOTAL</b>								<b>1,545.0</b>		
ML	WB	526+26.33	TO	566+00.00	3973.67	13.0	5,739.7	241.1		
ML	WB	566+00.00	TO	768+29.11	20229.11	12.0	26,972.1	1,132.8		
STATION EQUATION 768+29.11 BK = 3+51.73 AH										
ML	WB	3+51.73	TO	14+13.80	1062.07	12.0	1,416.1	59.5		
BRIDGE OMISSION 14+13.80 TO 17+73.06										
ML	WB	17+73.06	TO	23+82.01	608.95	12.0	811.9	34.1		
BRIDGE OMISSION 23+82.01 TO 26+77.29										
ML	WB	26+77.29	TO	28+08.00	130.71	14.7	213.5	9.0	WIDTH VARIES FROM 11'-4" TO 18'	
WB DRIVING LANE		28+08.00	TO	33+80.00	572.00	19.5	1,239.3	52.1	WIDTH VARIES FROM 16' TO 23'	
GORE AREA		28+08.00	TO	33+80.00	572.00	11.8	746.8	31.4	WIDTH VARIES FROM 2' TO 21'-6"	
<b>TOTAL</b>								<b>1,559.9</b>		
<b>GRAND TOTAL</b>								<b>3,104.8</b>		

48102100		AGGREGATE WEDGE SHOULDERS, TYPE B							TONS	
LOCATION	DIRECTION	STATION	TO	STATION	LENGTH (FOOT)	AVG. WIDTH (FOOT)	AREA (SQ YD)	QUANTITY (TONS)	REMARKS	
ML	EB	526+26.33	TO	768+29.11	24202.8	4.0	10,756.8	552.8		
STATION EQUATION 768+29.11 BK = 3+51.73 AH										
ML	EB	3+51.73	TO	14+13.80	1062.1	4.0	472.0	24.3		
BRIDGE OMISSION 14+13.80 TO 17+73.06										
ML	EB	17+73.06	TO	23+82.01	609.0	4.0	270.6	13.9		
BRIDGE OMISSION 23+82.01 TO 26+77.29										
ML	EB	26+77.29	TO	33+80.00	702.7	4.0	312.3	16.0		
ML	WB	526+26.33	TO	768+29.11	24202.8	4.0	10,756.8	552.8		
STATION EQUATION 768+29.11 BK = 3+51.73 AH										
ML	WB	3+51.73	TO	14+13.80	1062.1	4.0	472.0	24.3		
BRIDGE OMISSION 14+13.80 TO 17+73.06										
ML	WB	17+73.06	TO	23+82.01	609.0	4.0	270.6	13.9		
BRIDGE OMISSION 23+82.01 TO 26+77.29										
ML	WB	26+77.29	TO	33+80.00	702.7	4.0	312.3	16.0		
<b>TOTAL</b>								<b>1,214.0</b>		



40600200		BITUMINOUS MATERIALS (PRIME COAT)								TONS
40600300		AGGREGATE (PRIME COAT)								TONS
MAINLINE										
LOCATION	DIRECTION	STATION	TO	STATION	LENGTH (FOOT)	AVG. WIDTH (FOOT)	AREA (SQ YD)	BIT (PC) QUANTITY (TON)	AGG (PC) QUANTITY (TON)	REMARKS
ML	EB	526+26.33	TO	566+00.00	3973.67	13.0	5,739.7	2.2	11.5	
ML	EB	566+00.00	TO	768+29.11	20229.11	12.0	26,972.1	10.2	53.9	
STATION EQUATION 768+29.11 BK = 3+51.73 AH										
ML	EB	3+51.73	TO	14+13.80	1062.07	12.0	1,416.1	0.5	2.8	
BRIDGE OMISSION 14+13.80 TO 17+73.06										
ML	EB	17+73.06	TO	23+82.01	608.95	12.0	811.9	0.3	1.6	
BRIDGE OMISSION 23+82.01 TO 26+77.29										
ML	EB	26+77.29	TO	28+08.00	130.71	22.0	319.5	0.1	0.6	
EB PASSING LANE		28+08.00	TO	33+80.00	572.00	12.0	762.7	0.3	1.5	
EB DRIVING LANE		28+08.00	TO	33+80.00	572.00	12.0	762.7	0.3	1.5	
SUBTOTAL								14.0	73.6	
ML	WB	526+26.33	TO	566+00.00	3973.67	13.0	5,739.7	2.2	11.5	
ML	WB	566+00.00	TO	768+29.11	20229.11	12.0	26,972.1	10.2	53.9	
STATION EQUATION 768+29.11 BK = 3+51.73 AH										
ML	WB	3+51.73	TO	14+13.80	1062.07	12.0	1,416.1	0.5	2.8	
BRIDGE OMISSION 14+13.80 TO 17+73.06										
ML	WB	17+73.06	TO	23+82.01	608.95	12.0	811.9	0.3	1.6	
BRIDGE OMISSION 23+82.01 TO 26+77.29										
ML	WB	26+77.29	TO	28+08.00	130.71	14.7	213.5	0.1	0.4	
WB DRIVING LANE		28+08.00	TO	33+80.00	572.00	19.5	1,239.3	0.5	2.5	
GORE AREA		28+08.00	TO	33+80.00	572.00	11.8	746.8	0.3	1.5	
SUBTOTAL								14.1	74.3	
SHOULDERS										
	EB	4+22.62	TO	14+13.80	991.2	6.0	660.8	0.3	1.3	
BRIDGE OMISSION 14+13.80 TO 17+73.06										
	EB	17+73.06	TO	23+82.01	609.0	6.0	406.0	0.2	0.8	
BRIDGE OMISSION 23+82.01 TO 26+77.29										
	EB	26+77.29	TO	33+80.00	702.7	11.0	858.9	0.3	1.7	
SUBTOTAL								0.7	3.9	
	WB	4+22.62	TO	14+13.80	991.2	6.0	660.8	0.3	1.3	
BRIDGE OMISSION 14+13.80 TO 17+73.06										
	WB	17+73.06	TO	23+82.01	609.0	6.0	406.0	0.2	0.8	
BRIDGE OMISSION 23+82.01 TO 26+77.29										
	WB	26+77.29	TO	33+80.00	702.7	10.0	780.8	0.3	1.6	
SUBTOTAL								0.7	3.7	
TOTAL								28.8	151.5	

X4401198	HOT-MIX ASPHALT SURFACE REMOVAL, VARIABLE DEPTH								SQ YD	
44000158	HOT-MIX ASPHALT SURFACE REMOVAL, 2 1/4"								SQ YD	
LOCATION	DIRECTION	STATION	TO	STATION	LENGTH (FOOT)	AVG.WIDTH (FOOT)	AREA (SQ FT)	AREA, HMA SURFACE REM VD (SQ YD)	AREA, HMA SURFACE REM 2 1/4" (SQ YD)	
ML	EB	526+26.33	TO	527+00.	73.7	16.0	1,178.7		130.97	
ML	EB	527+00.	TO	528+00.	100.0	13.0	1,300.0		144.44	
ML	EB	528+00.00	TO	566+00.00	3,800.0	13.0	49,400.0	5,488.9		
ML	EB	566+00.00	TO	766+35.00	20,035.0	12.0	240,420.0	26,713.3		
ML	EB	766+35.00	TO	768+29.11	194.1	12.0	2,329.3		258.81	
STATION EQUATION 768+29.11 BK = 3+51.73 AH										
ML	EB	3+51.73	TO	3+91.00	39.3	12.0	471.2		52.4	
ML	EB	3+91.00	TO	8+83.00	492.0	12 TO 16	6,888.0		765.3	
ML	EB	8+83.00	TO	14+13.80	530.8	16.0	8,492.8		943.6	
BRIDGE OMISSION 14+13.80 TO 17+73.06										
ML	EB	17+73.06	TO	23+82.01	609.0	16.0	9,743.2		1,082.6	
BRIDGE OMISSION 23+82.01 TO 26+77.29										
ML	EB	26+77.29	TO	33+80.00	702.7	35.0	24,594.9		2,732.8	
ML	WB	526+26.33	TO	527+00.	73.7	16.0	1,178.7		130.97	
ML	WB	527+00.	TO	528+00.	100.0	13.0	1,300.0		144.44	
ML	WB	528+00.00	TO	566+00.00	3,800.0	13.0	49,400.0	5,488.9		
ML	WB	566+00.00	TO	766+35.00	20,035.0	12.0	240,420.0	26,713.3		
ML	WB	766+35.00	TO	768+29.11	194.1	12.0	2,329.3		258.81	
STATION EQUATION 768+29.11 BK = 3+51.73 AH										
ML	WB	3+51.73	TO	3+91.00	39.3	12.0	471.2		52.4	
ML	WB	3+91.00	TO	8+83.00	492.0	12 TO 16	6,888.0		765.3	
ML	WB	8+83.00	TO	14+13.80	530.8	16.0	8,492.8		943.6	
BRIDGE OMISSION 14+13.80 TO 17+73.06										
ML	WB	17+73.06	TO	22+80.00	506.9	16.0	8,111.0		901.2	
ML	WB	22+80.00	TO	23+82.01	102.0	16 TO 22	1,938.2		215.4	
BRIDGE OMISSION 23+82.01 TO 26+77.29										
ML	WB	26+77.29	TO	33+80.00	702.7	16.6 TO 55.5	25,332.7		2,814.7	
TOTAL								64,404.4	12,337.8	

40600990		TEMPORARY RAMP							(SQ YD)
LOCATION	DIRECTION	STATION	TO	STATION	LENGTH (FOOT)	WIDTH (FOOT)	TEMP RAMP AREA (SQ YD)	REMARKS	
ML	EB	526+26.33	TO	526+31.33	5.00	13	7.2		
ML	EB	14+08.80	TO	14+13.80	5.00	12	6.7		
ML	EB	17+73.06	TO	17+78.06	5.00	16	8.9		
ML	EB	23+77.01	TO	23+82.01	5.00	16	8.9		
ML	EB	26+77.29	TO	26+82.29	5.00	30	16.7		
ML	EB	33+75.00	TO	33+80.00	5.00	34	18.9		
ML	WB	526+26.33	TO	526+31.33	5.00	13	7.2		
ML	WB	14+08.80	TO	14+13.80	5.00	12	6.7		
ML	WB	17+73.06	TO	17+78.06	5.00	16	8.9		
ML	WB	23+77.01	TO	23+82.01	5.00	16	8.9		
ML	WB	26+77.29	TO	26+82.29	5.00	22.33	12.4		
ML	WB	33+75.00	TO	33+80.00	5.00	55.5	30.8		
TOTAL							142.1		

STATION EQUATION 768+29.11 BK = 3+51.73 AH  
BRIDGE OMISSION 14+13.80 TO 17+73.06  
BRIDGE OMISSION 23+82.01 TO 26+77.29

FILE NAME =	USER NAME = sparksgw	DESIGNED -	REVISED -
c:\pwork\pwork\sparksgw\10402311\0672727-sht-schedule.dgn		DRAWN -	REVISED -
Default	PLOT SCALE = 100.0000' / 1in.	CHECKED -	REVISED -
	PLOT DATE = Jun-06-2014 01:53:53PM	DATE -	REVISED -

STATE OF ILLINOIS  
DEPARTMENT OF TRANSPORTATION

SCHEDULE OF QUANTITIES

SCALE: SHEET OF SHEETS STA. TO STA.

F.A.P. RTE.	SECTION	COUNTY	TOTAL SHEETS	SHEET NO.
717	(102)RS-4,(103)RS-3	LOGAN	25	9
ILLINOIS FED. AID PROJECT			CONTRACT NO. 72H27	

78001120	PAINT PAVEMENT MARKING - LINE 5"				FOOT							
78001180	PAINT PAVEMENT MARKING - LINE 24"				FOOT							
78000300	THERMOPLASTIC PAVEMENT MARKING - LINE 5"				FOOT							
78000600	THERMOPLASTIC PAVEMENT MARKING - LINE 12"				FOOT							
LOCATION	DIRECTION	STATION	TO	STATION	PAINT				PAINT STOP BAR WHITE 24" (FOOT)	THERMOPLASTIC		
					SOLID YELLOW 5" (FOOT)	SKIP-DASH YELLOW 5" (FOOT) 10' PER 40'	SKIP-DASH WHITE 5" (FOOT) 10' PER 40'	EDGE LINE WHITE 5" (FOOT)		SOLID YELLOW 5" (FOOT)	SOLID YELLOW 12" (FOOT)	
NPZ	EB	526+26.33	TO	537+84	1158			1158				
NPZ	WB	526+26.33	TO	543+50	1724			1724				
	EB	537+84	TO	543+50		142		566				
	EB, WB	543+50	TO	762+75		5482		43850				
NPZ	EB, WB	762+75	TO	768+29	1108			1108				
STATION EQUATION 768+29.11 BK = 3+51.73 AH												
NPZ	EB, WB	3+51	TO	28+08	4914			4914				
	EB	28+08	TO	33+80			140	572				
	WB	28+08	TO	33+80				572				
	MEDIAN	28+08	TO	33+80					2210	330		
SIDE ROAD	RT	707+64			16			29				
SUBTOTALS					8,920	5,624	140	54,464	29	2,210	330	
TOTAL					69,148			29	2,210	330		

78100100	RAISED REFLECTIVE PAVEMENT MARKER				EACH	
78300200	RAISED REFLECTIVE PAVEMENT MARKER REMOVAL				EACH	
LOCATION	DIRECTION	STATION	TO	STATION	LENGTH (FOOT)	PAVEMENT MARKER AND REMOVAL
ML	EB	526+26.33	TO	768+29.11	24,202.8	303
STATION EQUATION 768+29.11 BK = 3+51.73 AH						
ML	EB	3+51.73	TO	14+13.80	1,062.1	13
BRIDGE OMISSION 14+13.80 TO 17+73.06						
ML	EB	17+73.06	TO	23+82.01	609.0	8
BRIDGE OMISSION 23+82.01 TO 26+77.29						
ML	EB	26+77.29	TO	33+80.00	702.7	36
TOTAL						359

70300100	SHORT-TERM PAVEMENT MARKING				FOOT			
70301000	WORK ZONE PAVEMENT MARKING REMOVAL				SO FT			
LOCATION	DIRECTION	STATION	TO	STATION	LENGTH (FOOT)	SHORT - TERM CENTERLINE APPLICATION 4' PER 40'	PAVEMENT MARKING REMOVAL (SO FT)	REMARKS
	EB, WB	526+26.33	TO	768+29	24203	2420		APPLICATION 1 DONE AFTER MILLING
STATION EQUATION 768+29.11 BK = 3+51.73 AH								
	EB, WB	3+51	TO	28+08	2457	246		APPLICATION 1 DONE AFTER MILLING
	EB	28+08	TO	33+80	572	58		
	WB	28+08	TO	33+80	572			APPLICATION 1 DONE AFTER MILLING
	MEDIAN	28+08	TO	33+80		1105		
SUBTOTAL					3829	0		

	EB, WB	526+26.33	TO	768+29	24203	2420		
STATION EQUATION 768+29.11 BK = 3+51.73 AH								APPLICATION 2 DONE AFTER BINDER
	EB, WB	3+51	TO	28+08	2457	246		
	EB	28+08	TO	33+80	572	58		APPLICATION 2 DONE AFTER BINDER
	WB	28+08	TO	33+80	572			
	MEDIAN	28+08	TO	33+80		1105		APPLICATION 2 DONE AFTER BINDER
SUBTOTAL					3829	0		

	EB, WB	526+26.33	TO	768+29	24203	2420	807	
STATION EQUATION 768+29.11 BK = 3+51.73 AH								APPLICATION 3 DONE AFTER SURFACE
	EB, WB	3+51	TO	28+08	2457	246	82	
	EB	28+08	TO	33+80	572	58	19	APPLICATION 3 DONE AFTER SURFACE
	WB	28+08	TO	33+80	572		0	
	MEDIAN	28+08	TO	33+80		1105	368	APPLICATION 3 DONE AFTER SURFACE
SUBTOTAL					3829	1276		
TOTAL					11487	1276		

FILE NAME =	USER NAME = sparksgw	DESIGNED -	REVISED -
c:\pwork\pwork\sparks\10402311\0672\27-sh-t-schedule.dgn		DRAWN -	REVISED -
Default	PLOT SCALE = 100.0000' / 1in.	CHECKED -	REVISED -
	PLOT DATE = Jun-06-2014 01:53:53PM	DATE -	REVISED -

**STATE OF ILLINOIS  
DEPARTMENT OF TRANSPORTATION**

**SCHEDULE OF QUANTITIES**

SCALE: SHEET OF SHEETS STA. TO STA.

F.A.P. RTE.	SECTION	COUNTY	TOTAL SHEETS	SHEET NO.
717	(102)RS-4,(103)RS-3	LOGAN	25	10
CONTRACT NO. 72H27			ILLINOIS FED. AID PROJECT	

ENTRANCE IMPROVEMENT SCHEDULE FOR RURAL / URBAN "PPP" PROJECTS															
LOCATION	TYPE OF ENTRANCE	EX MATERIAL TYPE	WIDTH 1	WIDTH 2	WIDTH 3	WIDTH 4	LENGTH A	LENGTH B	PR HMA CONC. THICKNESS	HMA SURF. REMOVAL - BUTT JOINT	PREP OF BASE	AGGREGATE SURFACE COURSE TY - B	BIT (P.C.)	AGG (P.C.)	INCIDENTAL HMA SURF.
(LT / RT) (STA) ( + )	(FE / PE / CE / MB) - (RURAL / URBAN)	(EARTH / AGG. / HMA / P.C.C.)	FOOT	FOOT	FOOT	FOOT	FOOT	FOOT	INCH	SO. YD.	SO. YD.	TON	TON	TON	TON
RT 527+75	PE	AGG	12.0	15.0	39.0		8.0	7.0	3.50		24.0	1.2	0.01	0.0	4.7
LT 566+67	TR 500	O&C		23.0	51.0		10.0		8.00		41.1		0.02	0.1	18.4
RT 566+75	TR 500	O&C		19.0	44.0		10.0		8.00		35.0		0.01	0.1	15.7
LT 620+62	TR 600	O&C		56.0	94.0		10.0		8.00		83.3		0.03	0.2	37.3
RT 620+62	TR 600	HMA		68.0	155.0		10.0		2.00	123.9			0.05	0.2	13.9
LT 622+67	CE	HMA		40.0	58.0		10.0		2.00	54.4			0.02	0.1	6.1
RT 622+71	CE	AGG	35.0	37.0	57.0		10.0	5.0	8.00		52.2	2.3	0.02	0.1	23.4
RT 628+06	CE	AGG	24.0	25.0	50.0		10.0	5.0	8.00		41.7	1.6	0.02	0.1	18.7
RT 629+24	CE	AGG	24.0	24.0	50.0		10.0	5.0	8.00		41.1	1.5	0.02	0.1	18.4
RT 631+19	CE	AGG	24.0	26.0	52.0		10.0	5.0	8.00		43.3	1.6	0.02	0.1	19.4
RT 632+29	CE	AGG	24.0	27.0	44.0		10.0	5.0	8.00		39.4	1.6	0.01	0.1	17.7
RT 639+18	CE	AGG	24.0	24.0	46.0		10.0	5.0	8.00		38.9	1.5	0.01	0.1	17.4
LT 686+46	TR 700	O&C		28.0	48.0		10.0		8.00		42.2		0.02	0.1	18.9
RT 686+67	TR 700	HMA		90.0	157.0		10.0		2.00	137.2			0.05	0.3	15.4
RT 707+64	TR 1700	HMA		90.0	137.0		10.0		2.00	126.1			0.05	0.3	14.1
LT 713+03	PE	HMA		13.0	32.0		8.0		2.00	20.0			0.01	0.0	2.2
RT 713+61	PE	AGG	24.0	43.0	68.0		8.0	7.0	3.50		49.3	3.0	0.02	0.1	9.7
RT 719+43	PE	HMA		33.0	40.0		8.0		2.00	32.4			0.01	0.1	3.6
LT 726+82	TR 1700	HMA		55.0	102.0		10.0		2.00	87.2			0.03	0.2	9.8
RT 726+85	PE	HMA		26.0	36.0		8.0		2.00	27.6			0.01	0.1	3.1
LT 741+86	PE	HMA		20.0	63.0	26.0	8.0		2.00	48.4			0.02	0.1	5.4
LT 747+50	PE	HMA		30.0	64.0	22.0	8.0		2.00	51.6			0.02	0.1	5.8
LT 748+28	PE	HMA		10.0	23.0		8.0		2.00	14.7			0.01	0.0	1.6
LT 750+83	PE	HMA		27.0	69.0	24.0	8.0		2.00	53.3			0.02	0.1	6.0
LT 753+60	TR 825	O&C		30.0	63.0		10.0		8.00		51.7		0.02	0.1	23.1
RT 753+70	TR 825	O&C		25.0	45.0		10.0		8.00		38.9		0.01	0.1	17.4
LT 756+51	PE	HMA		30.0	63.0	21.0	8.0		2.00	50.7			0.02	0.1	5.7
LT 758+60	PE	AGG	24.0	25.0	56.0	20.0	8.0	7.0	3.50		36.0	2.2	0.01	0.1	7.1
LT 760+03	PE	AGG	24.0	42.0	65.0	29.0	8.0	7.0	3.50		47.6	2.9	0.02	0.1	9.3
LT 760+91	PE	HMA		15.0	57.0	17.0	8.0		2.00	39.6			0.02	0.1	4.4
LT 761+88	PE	HMA		42.0	69.0	22.0	8.0		2.00	59.1			0.02	0.1	6.6
RT 761+80	TR 840	HMA		50.0	83.0		10.0		2.00	73.9			0.03	0.1	8.3
TOKEN QUANTITY TO BE USED AT THE DISCRETION OF THE ENGINEER										50.0	50.0	3.0	0.04	0.2	11.2
<b>TOTAL =</b>										<b>1050.1</b>	<b>756</b>	<b>22</b>	<b>0.7</b>	<b>3.6</b>	<b>400</b>

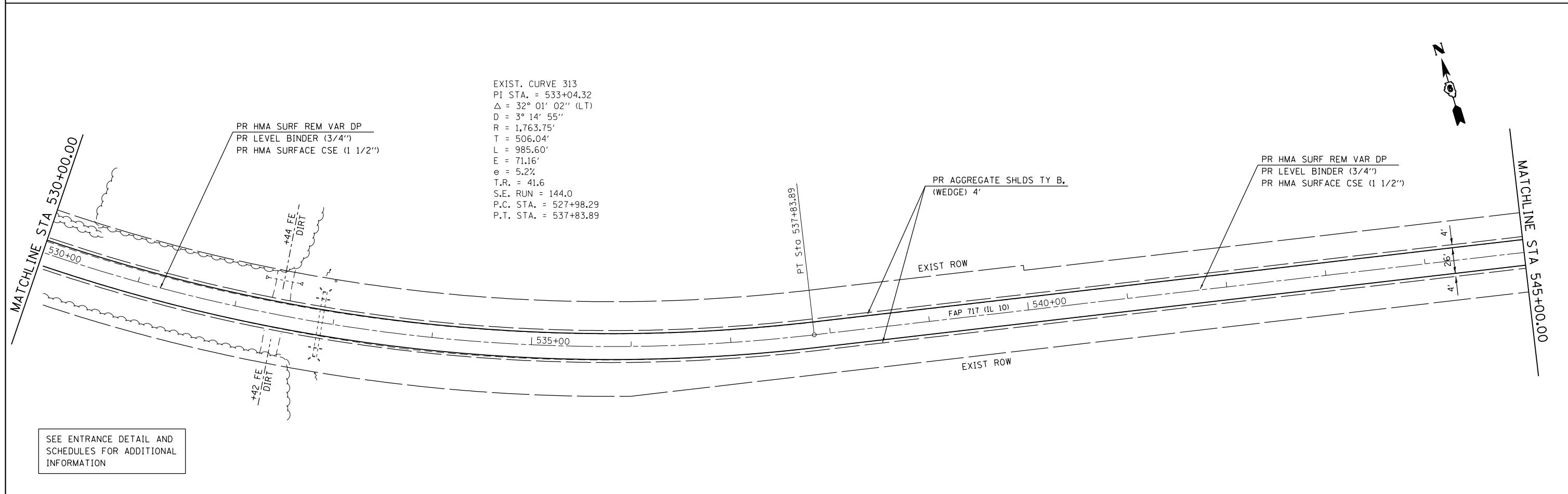
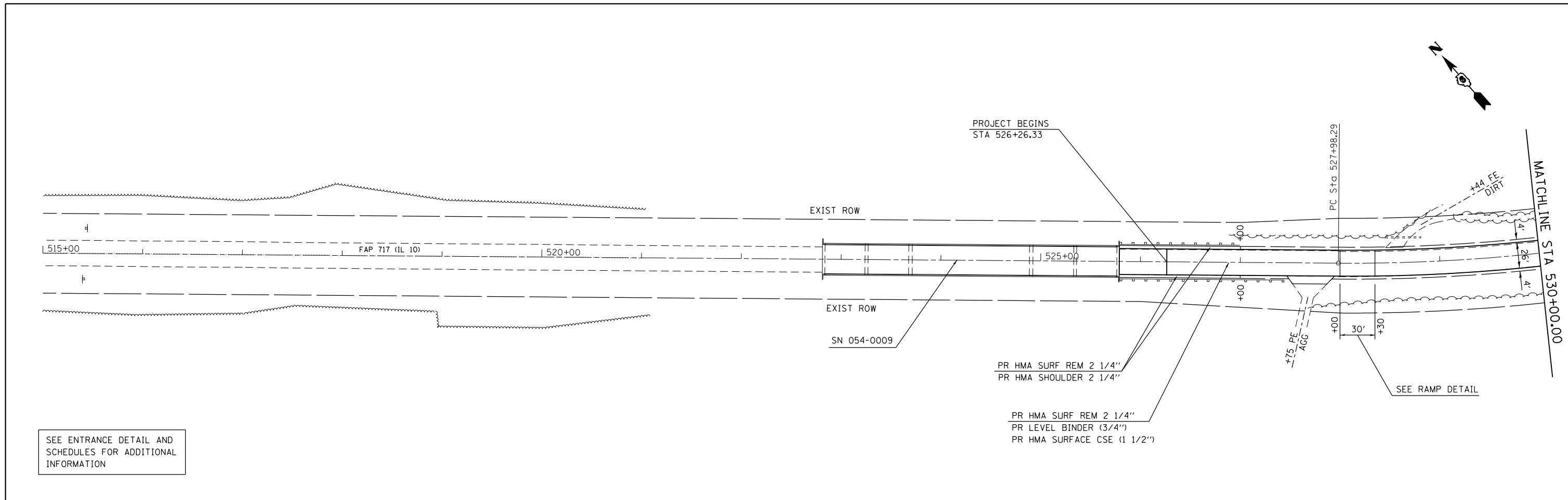

EXIST. CURVE 313  
 PI STA. = 533+04.32  
 $\Delta = 32^\circ 01' 02''$  (LT)  
 $D = 3^\circ 14' 55''$   
 $R = 1,763.75'$   
 $T = 506.04'$   
 $L = 985.60'$   
 $E = 71.16'$   
 $e = 5.2\%$   
 $T.R. = 41.6$   
 $S.E. RUN = 144.0$   
 $P.C. STA. = 527+98.29$   
 $P.T. STA. = 537+83.89$

FILE NAME = c:\pwwork\pwwork\sparksgw\10402311\0672\127-sht-plan.dgn	USER NAME = sparksgw	DESIGNED -	REVISED -	<b>STATE OF ILLINOIS DEPARTMENT OF TRANSPORTATION</b>	<b>PLAN SHEET FAP 717 (IL 10)</b>			F.A.P. RTE.	SECTION	COUNTY	TOTAL SHEETS	SHEET NO.
	PLOT SCALE = 100.0000' / 1" =	CHECKED -	REVISED -					717	(102)RS-4, (103)RS-3	LOGAN	25	12
PLOT DATE = Jun-06-2014 01:54:08PM	DATE -	REVISED -	REVISED -	SCALE:	SHEET NO.	OF SHEETS	STA.	TO STA.	CONTRACT NO. 72H27			
ILLINOIS FED. AID PROJECT												

MATCHLINE STA 545+00.00

MATCHLINE STA 560+00.00

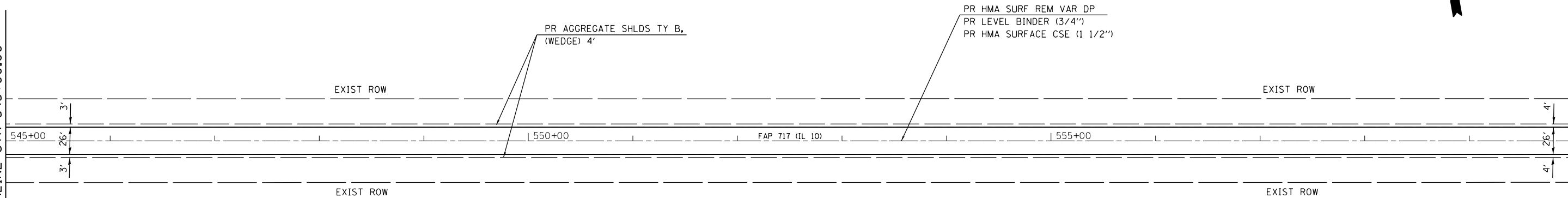

SEE ENTRANCE DETAIL AND SCHEDULES FOR ADDITIONAL INFORMATION

MATCHLINE STA 560+00.00

MATCHLINE STA 575+00.00

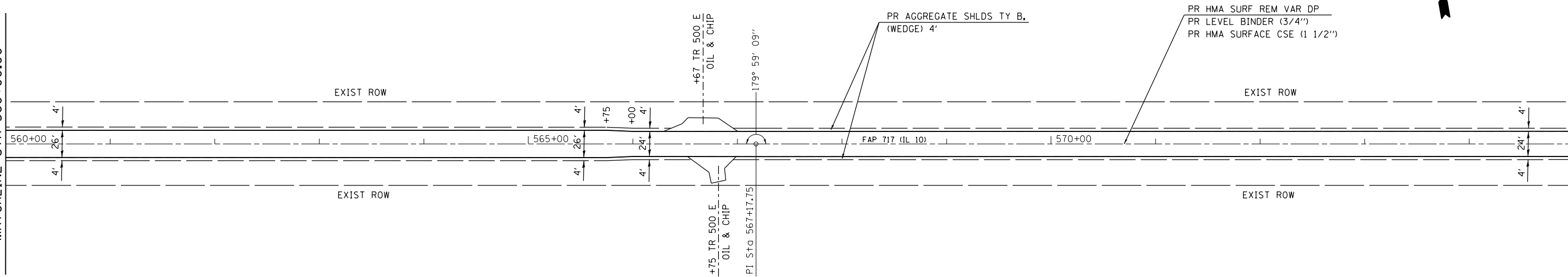

SEE ENTRANCE DETAIL AND SCHEDULES FOR ADDITIONAL INFORMATION

FILE NAME =	USER NAME = sparksgw	DESIGNED -	REVISED -	<b>STATE OF ILLINOIS DEPARTMENT OF TRANSPORTATION</b>	<b>PLAN SHEET FAP 717 (IL 10)</b>				F.A.P. RTE.	SECTION	COUNTY	TOTAL SHEETS	SHEET NO.
ci:\pw\work\p\id\sparksgw\10402311\0672\27-sht-plan.dgn		DRAWN -	REVISED -		717	(102)RS-4, (103)RS-3	LOGAN	25	13				
	PLOT SCALE = 100.0000' / in.	CHECKED -	REVISED -						CONTRACT NO. 72H27				
	PLOT DATE = Jun-06-2014 01:54:09PM	DATE -	REVISED -						ILLINOIS FED. AID PROJECT				
					SCALE:	SHEET NO.	OF SHEETS	STA.	TO STA.				

MATCHLINE STA 575+00.00

MATCHLINE STA 590+00.00

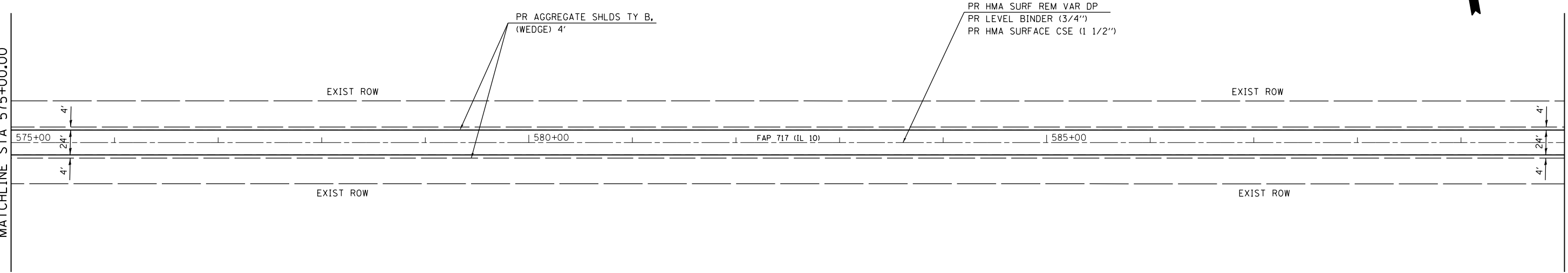

SEE ENTRANCE DETAIL AND SCHEDULES FOR ADDITIONAL INFORMATION

MATCHLINE STA 590+00.00

MATCHLINE STA 605+00.00

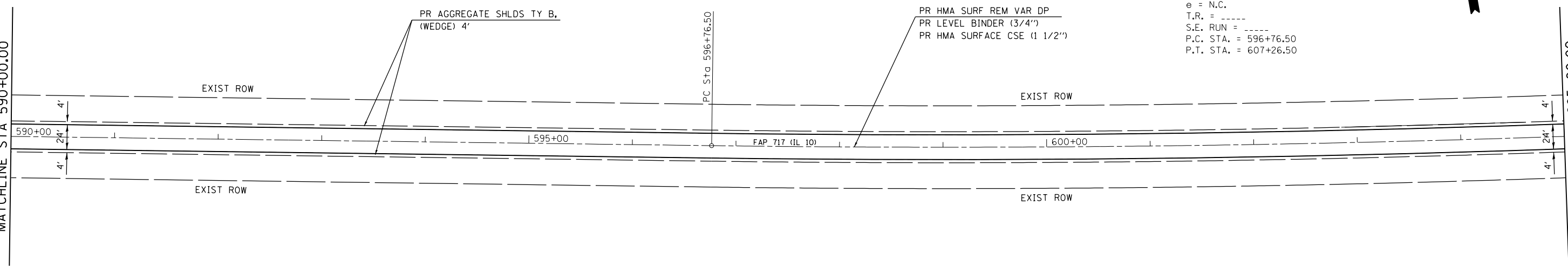

EXIST. CURVE 314  
 PI STA. = 602+01.66  
 $\Delta$  = 3° 31' 22" (LT)  
 D = 0° 20' 08"  
 R = 17,077.02'  
 T = 525.17'  
 L = 1,050.00'  
 E = 8.07'  
 e = N.C.  
 T.R. = -----  
 S.E. RUN = -----  
 P.C. STA. = 596+76.50  
 P.T. STA. = 607+26.50

SEE ENTRANCE DETAIL AND SCHEDULES FOR ADDITIONAL INFORMATION

FILE NAME =	USER NAME = sparksgw	DESIGNED -	REVISED -
c:\pwwork\pwwork\sparksgw\10402311\0672\127-sht-plan.dgn		DRAWN -	REVISED -
	PLOT SCALE = 100.0000' / 1in.	CHECKED -	REVISED -
	PLOT DATE = Jun-06-2014 01:54:09PM	DATE -	REVISED -

**STATE OF ILLINOIS  
 DEPARTMENT OF TRANSPORTATION**

**PLAN SHEET  
 FAP 717 (IL 10)**

SCALE: SHEET NO. OF SHEETS STA. TO STA.

F.A.P. RTE.	SECTION	COUNTY	TOTAL SHEETS	SHEET NO.
717	(102)RS-4, (103)RS-3	LOGAN	25	14
CONTRACT NO. 72H27			ILLINOIS FED. AID PROJECT	

EXIST. CURVE 315  
 PI STA. = 615+23.17  
 $\Delta = 3^\circ 31' 41''$  (RT)  
 $D = 0^\circ 20' 10''$   
 $R = 17,052.46'$   
 $T = 525.17'$   
 $L = 1,050.00'$   
 $E = 8.08'$   
 $e = N.C.$   
 $T.R. = \text{-----}$   
 $S.E. \text{ RUN} = \text{-----}$   
 $P.C. \text{ STA.} = 609+98.01$   
 $P.T. \text{ STA.} = 620+48.01$

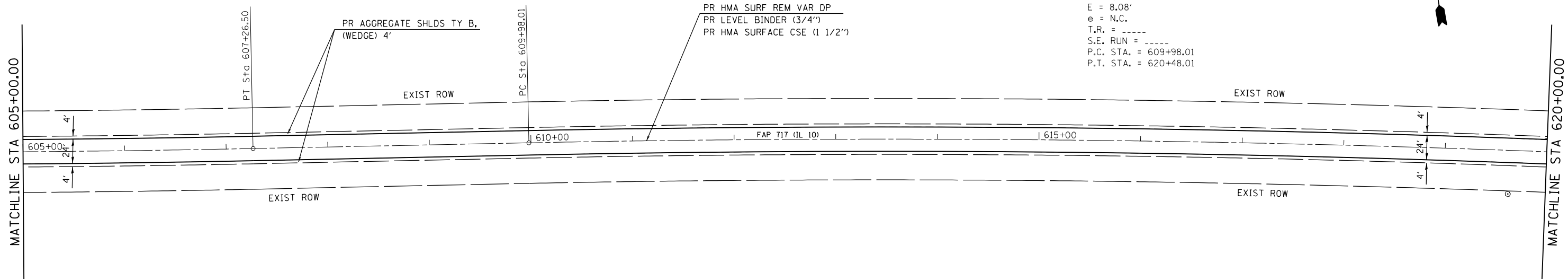

SEE ENTRANCE DETAIL AND SCHEDULES FOR ADDITIONAL INFORMATION

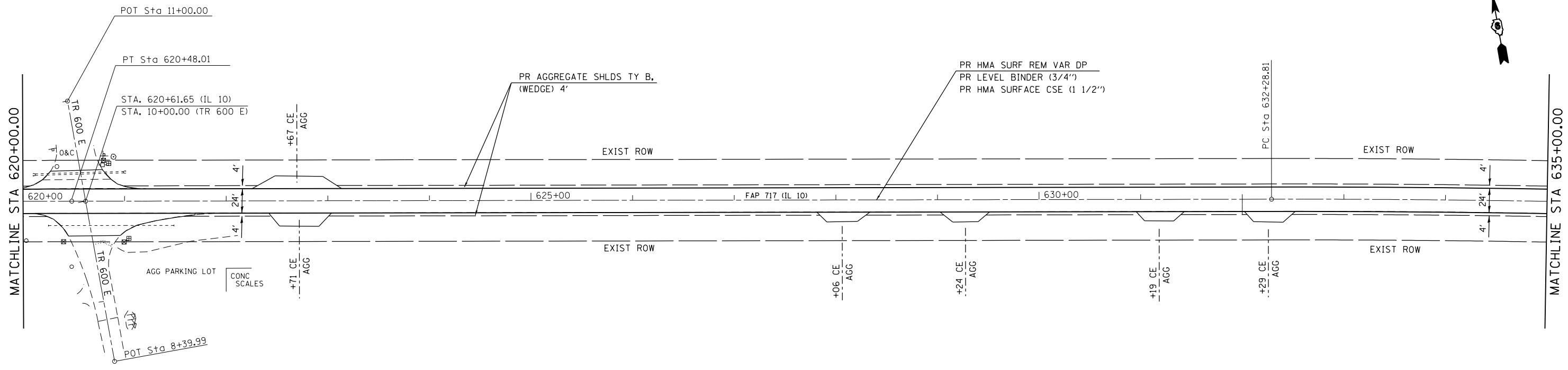

SEE ENTRANCE DETAIL AND SCHEDULES FOR ADDITIONAL INFORMATION

FILE NAME =	USER NAME = sparksgw	DESIGNED -	REVISED -
c:\pwwork\pwwork\sparksgw\10402311\0672\127-shr-plan.dgn		DRAWN -	REVISED -
	PLOT SCALE = 100.0000' / 1"	CHECKED -	REVISED -
	PLOT DATE = Jun-06-2014 01:54:09PM	DATE -	REVISED -

**STATE OF ILLINOIS  
 DEPARTMENT OF TRANSPORTATION**

**PLAN SHEET  
 FAP 717 (IL 10)**

SCALE: SHEET NO. OF SHEETS STA. TO STA.

F.A.P. RTE.	SECTION	COUNTY	TOTAL SHEETS	SHEET NO.
717	(102)RS-4, (103)RS-3	LOGAN	25	15
CONTRACT NO. 72H27			ILLINOIS FED. AID PROJECT	

EXIST. CURVE 316  
 PI STA. = 637+56.15  
 $\Delta = 4^\circ 13' 42''$  (RT)  
 $D = 0^\circ 24' 04''$   
 $R = 14,285.02'$   
 $T = 527.34'$   
 $L = 1,054.20'$   
 $E = 9.73'$   
 $e = N.C.$   
 T.R. = -----  
 S.E. RUN = -----  
 P.C. STA. = 632+28.81  
 P.T. STA. = 642+83.01

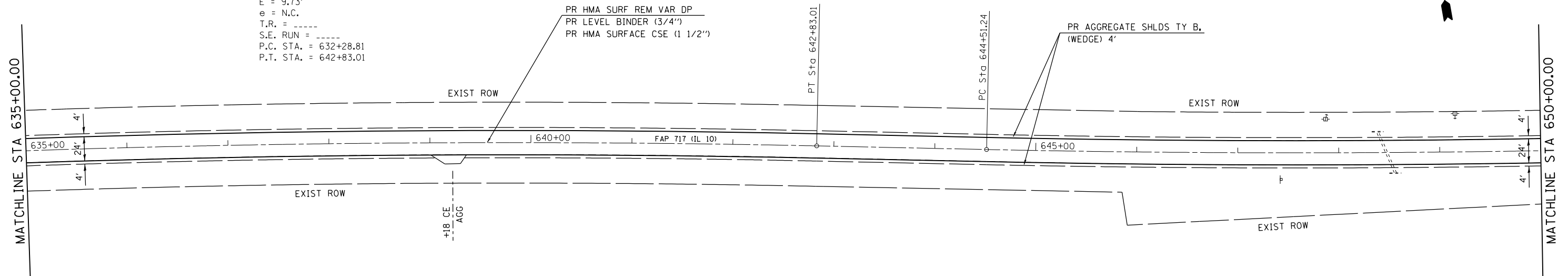

SEE ENTRANCE DETAIL AND SCHEDULES FOR ADDITIONAL INFORMATION

EXIST. CURVE 317  
 PI STA. = 649+82.73  
 $\Delta = 4^\circ 14' 35''$  (LT)  
 $D = 0^\circ 23' 58''$   
 $R = 14,347.44'$   
 $T = 531.49'$   
 $L = 1,062.50'$   
 $E = 9.84'$   
 $e = N.C.$   
 T.R. = -----  
 S.E. RUN = -----  
 P.C. STA. = 644+51.24  
 P.T. STA. = 655+13.74

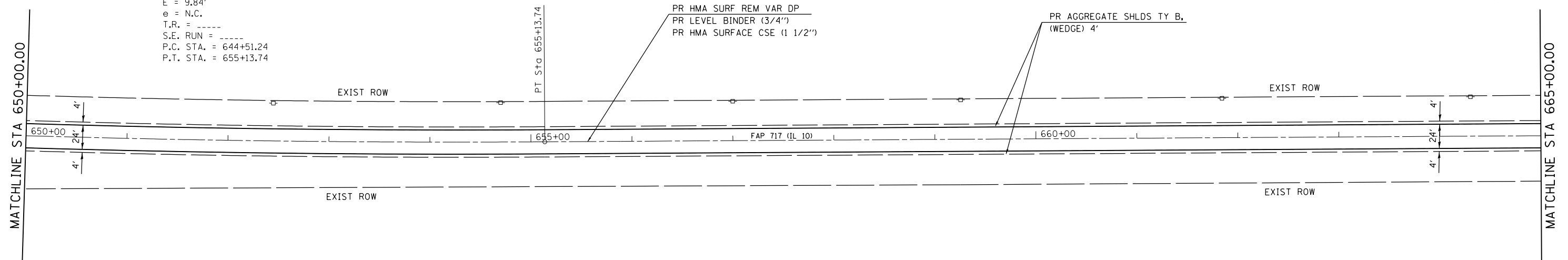

SEE ENTRANCE DETAIL AND SCHEDULES FOR ADDITIONAL INFORMATION

FILE NAME =	USER NAME = sparksgw	DESIGNED -	REVISED -
ci:\pw\work\pwidot\sparksgw\10402311\0672\27-shr-plan.dgn		DRAWN -	REVISED -
PLOT SCALE = 100.0000' / in.		CHECKED -	REVISED -
PLOT DATE = Jun-06-2014 01:54:09PM		DATE -	REVISED -

STATE OF ILLINOIS  
 DEPARTMENT OF TRANSPORTATION

PLAN SHEET  
 FAP 717 (IL 10)

SCALE: SHEET NO. OF SHEETS STA. TO STA.

F.A.P. RTE.	SECTION	COUNTY	TOTAL SHEETS	SHEET NO.
717	(102)RS-4, (103)RS-3	LOGAN	25	16
CONTRACT NO. 72H27			ILLINOIS FED. AID PROJECT	



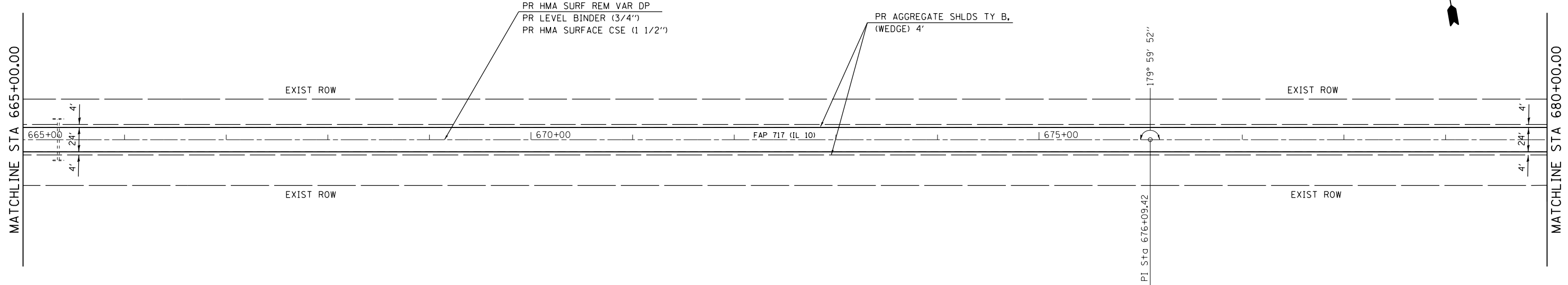

SEE ENTRANCE DETAIL AND SCHEDULES FOR ADDITIONAL INFORMATION

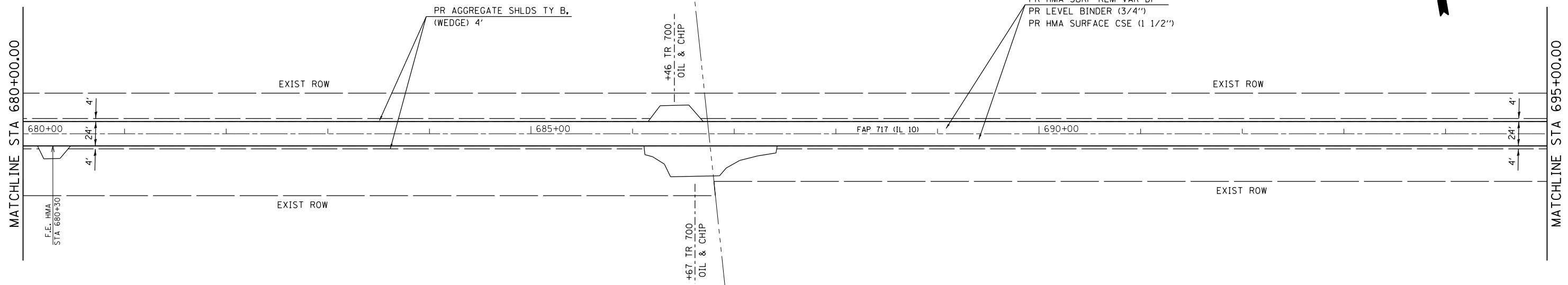

SEE ENTRANCE DETAIL AND SCHEDULES FOR ADDITIONAL INFORMATION

FILE NAME =	USER NAME = sparksgw	DESIGNED -	REVISED -
ci:\pw\work\p\dot\sparksgw\10402311\0672\27-sht-plan.dgn		DRAWN -	REVISED -
	PLOT SCALE = 100.0000' / in.	CHECKED -	REVISED -
	PLOT DATE = Jun-06-2014 01:54:10PM	DATE -	REVISED -

STATE OF ILLINOIS  
DEPARTMENT OF TRANSPORTATION

PLAN SHEET  
FAP 717 (IL 10)

SCALE:	SHEET NO.	OF	SHEETS	STA.	TO	STA.
--------	-----------	----	--------	------	----	------

F.A.P. RTE.	SECTION	COUNTY	TOTAL SHEETS	SHEET NO.
717	(102)RS-4, (103)RS-3	LOGAN	25	17
CONTRACT NO. 72H27			ILLINOIS FED. AID PROJECT	

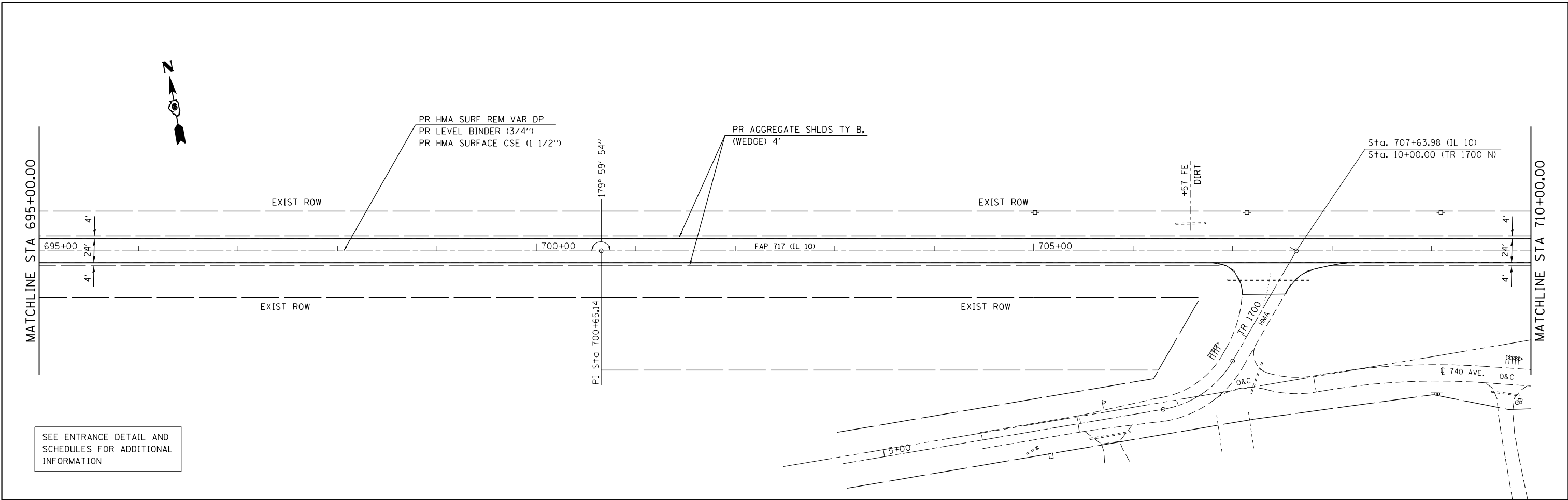

SEE ENTRANCE DETAIL AND SCHEDULES FOR ADDITIONAL INFORMATION

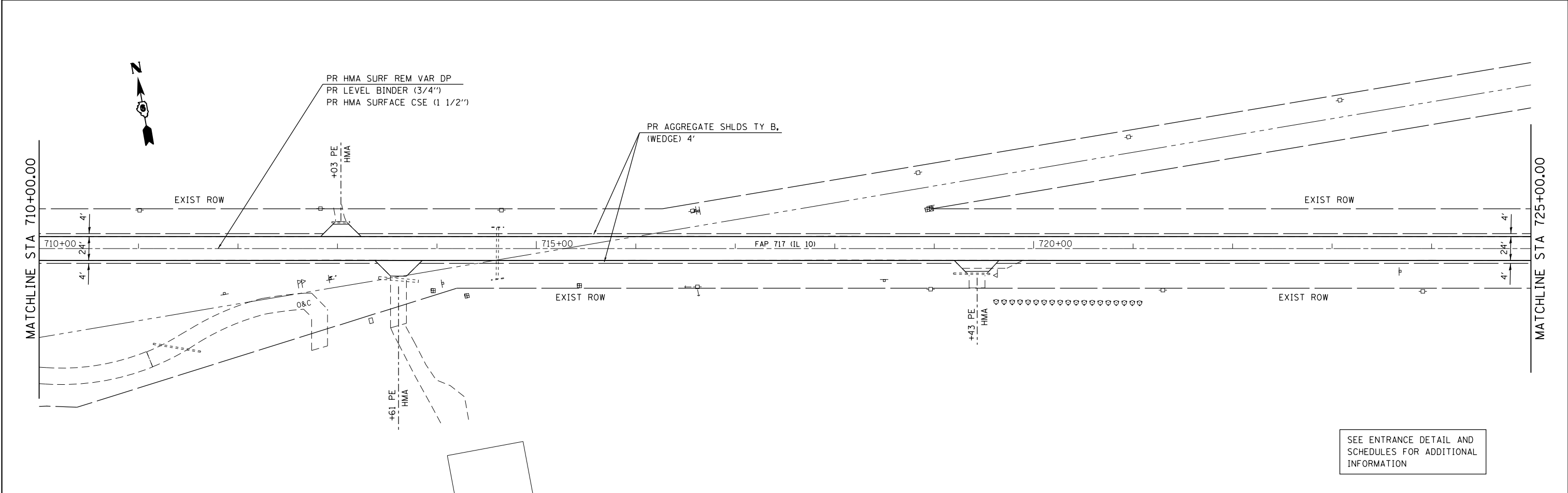

SEE ENTRANCE DETAIL AND SCHEDULES FOR ADDITIONAL INFORMATION

FILE NAME =	USER NAME = sparksgw	DESIGNED -	REVISED -
ci:\pw\work\pwidot\sparksgw\10402311\0672\127-sht-plan.dgn		DRAWN -	REVISED -
	PLOT SCALE = 100.0000' / in.	CHECKED -	REVISED -
	PLOT DATE = Jun-06-2014 01:54:10PM	DATE -	REVISED -

**STATE OF ILLINOIS  
DEPARTMENT OF TRANSPORTATION**

<b>PLAN SHEET FAP 717 (IL 10)</b>			
SCALE:	SHEET NO.	OF SHEETS	STA. TO STA.

F.A.P. RTE.	SECTION	COUNTY	TOTAL SHEETS	SHEET NO.
717	(102)RS-4, (103)RS-3	LOGAN	25	18
CONTRACT NO. 72H27			ILLINOIS FED. AID PROJECT	

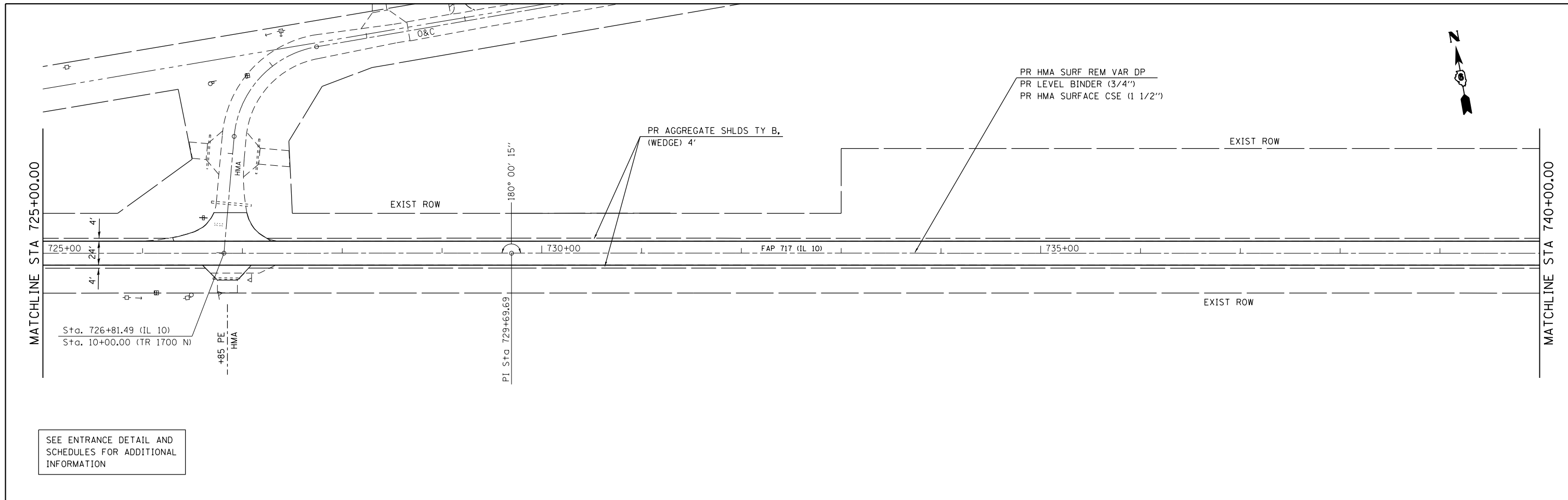

SEE ENTRANCE DETAIL AND SCHEDULES FOR ADDITIONAL INFORMATION

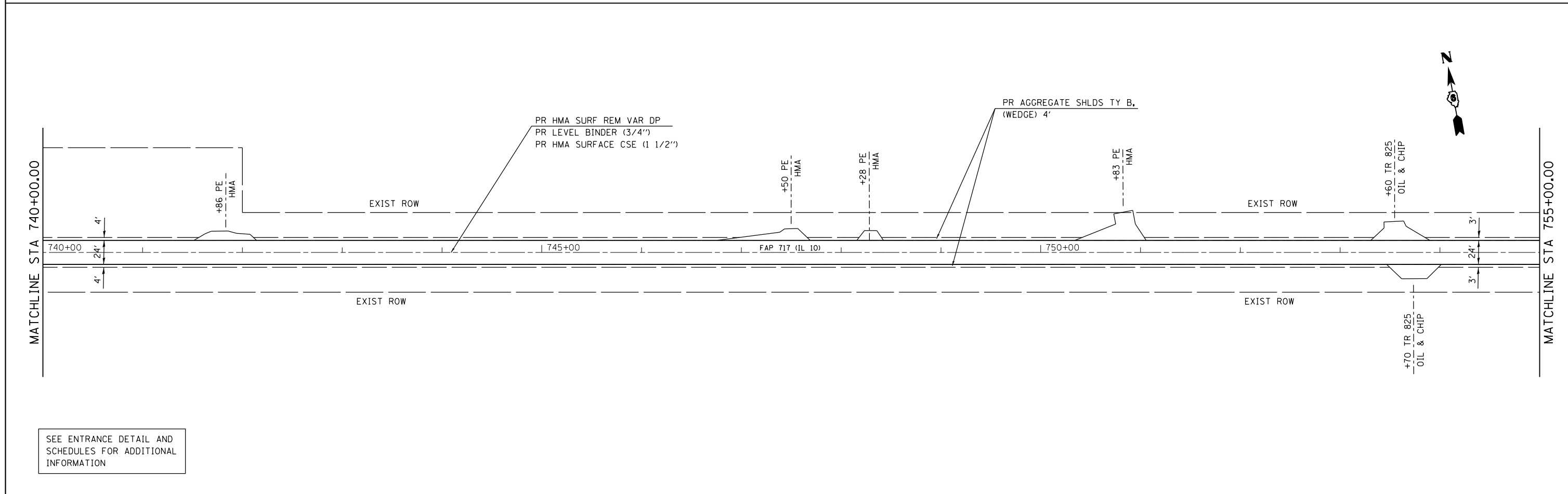

SEE ENTRANCE DETAIL AND SCHEDULES FOR ADDITIONAL INFORMATION

FILE NAME =	USER NAME = sparksgw	DESIGNED -	REVISED -	<b>STATE OF ILLINOIS DEPARTMENT OF TRANSPORTATION</b>	<b>PLAN SHEET FAP 717 (IL 10)</b>			F.A.P. RTE.	SECTION	COUNTY	TOTAL SHEETS	SHEET NO.
ci:\pwwork\pwwork\sparksgw\10402311\0672\127-sht-plan.dgn	DRAWN -	REVISED -	REVISED -					717	(102)RS-4, (103)RS-3	LOGAN	25	19
PLOT SCALE = 100.0000' / 1" =	CHECKED -	REVISED -	REVISED -		CONTRACT NO. 72H27							
PLOT DATE = Jun-06-2014 01:54:12PM	DATE -	REVISED -	REVISED -		ILLINOIS FED. AID PROJECT							
				SCALE:	SHEET NO.	OF	SHEETS	STA.	TO	STA.		

HMA SHLDR TAPERS 1' TO 4'  
STA 3+91 TO STA 8+83

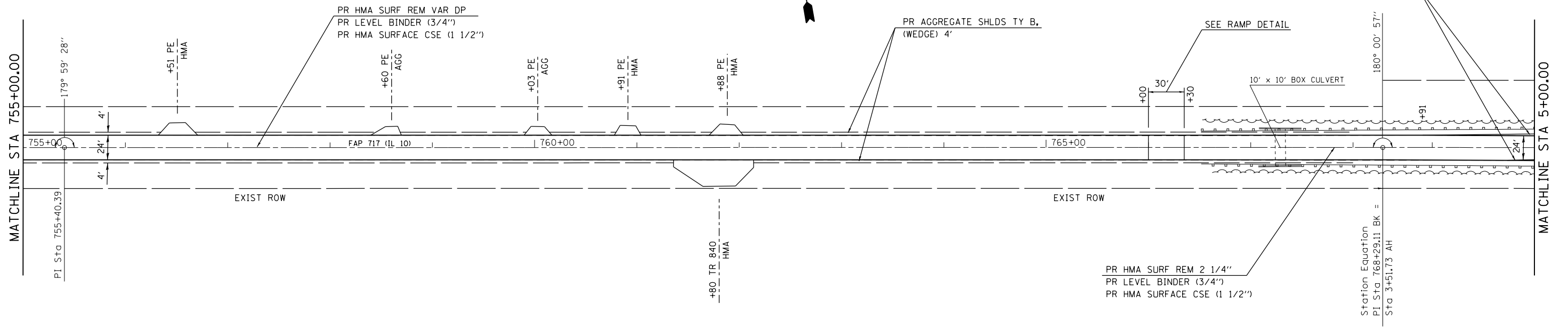

SEE ENTRANCE DETAIL AND SCHEDULES FOR ADDITIONAL INFORMATION

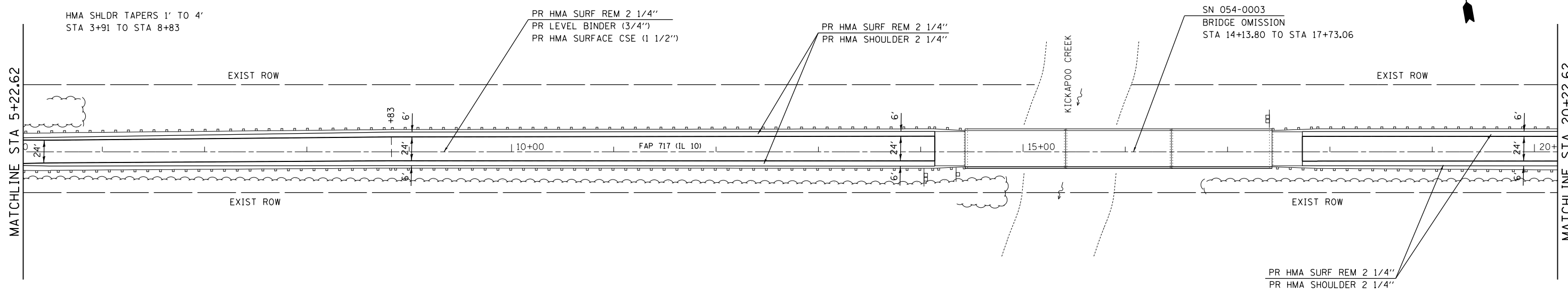

SEE ENTRANCE DETAIL AND SCHEDULES FOR ADDITIONAL INFORMATION

FILE NAME =	USER NAME = sparksgw	DESIGNED -	REVISED -	<b>STATE OF ILLINOIS DEPARTMENT OF TRANSPORTATION</b>	<b>PLAN SHEET FAP 717 (IL 10)</b>				F.A.P. RTE.	SECTION	COUNTY	TOTAL SHEETS	SHEET NO.
c:\pwork\pwork\sparksgw\0402311\0672\27-sht-plan.dgn		DRAWN -	REVISED -		717	(102)RS-4, (103)RS-3	LOGAN	25	20				
PLOT SCALE = 100.0000' / 1"		CHECKED -	REVISED -		SCALE:      SHEET NO.    OF    SHEETS    STA.            TO STA.				CONTRACT NO. 72H27				
PLOT DATE = Jun-06-2014 01:54:14PM		DATE -	REVISED -		ILLINOIS FED. AID PROJECT								

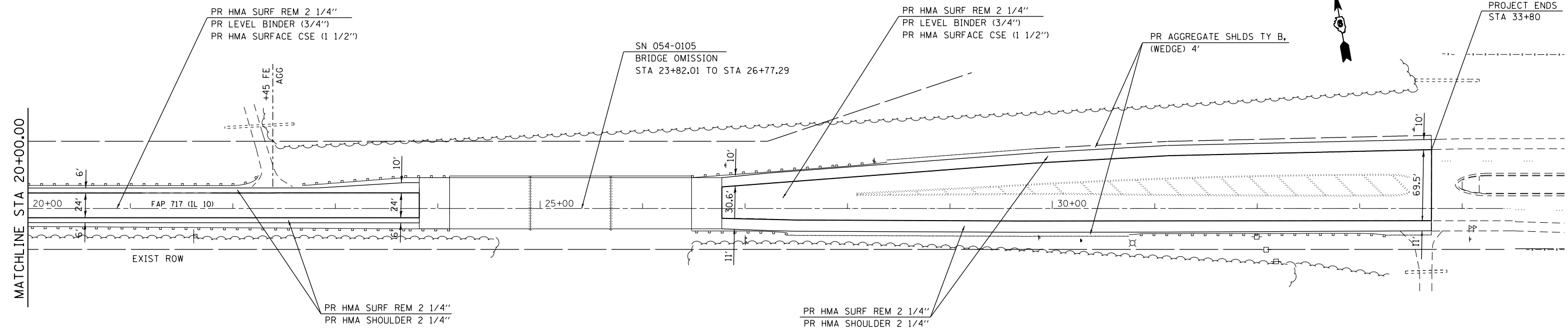

SEE ENTRANCE DETAIL AND SCHEDULES FOR ADDITIONAL INFORMATION

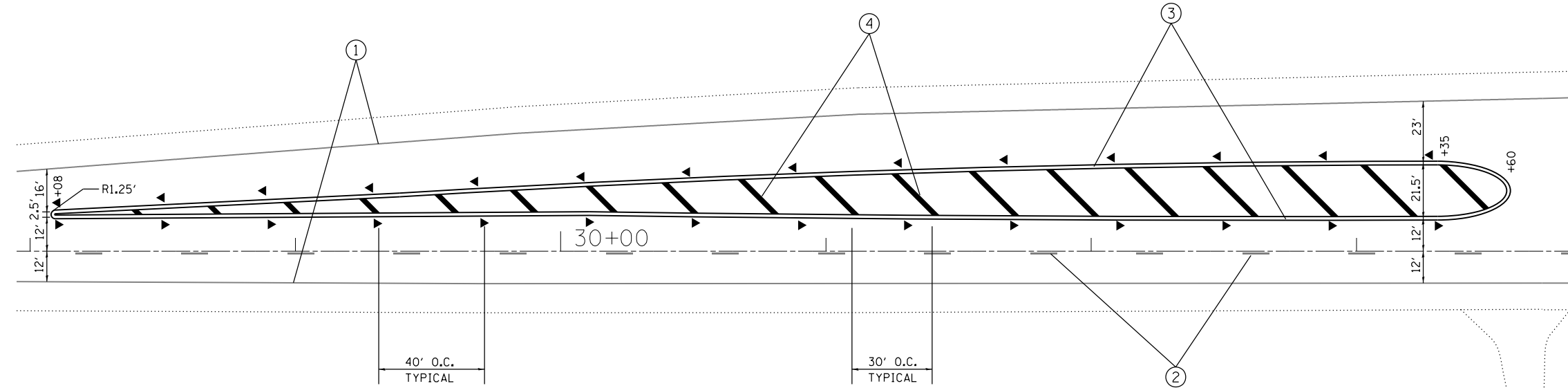

PAVEMENT MARKING LEGEND	
①	PAINT PAVEMENT MARKING - LINE 5" (SOLID WHITE LINE)
②	PAINT PAVEMENT MARKING - LINE 5" (WHITE SKIP DASH)
③	THERMOPLASTIC PAVEMENT MARKING - LINE 5" (DOUBLE YELLOW)
④	THERMOPLASTIC PAVEMENT MARKING - LINE 12" (SOLID YELLOW LINE)

RAISED REFLECTIVE PAVEMENT MARKER	
◀	- ONE-WAY AMBER MARKER
▷	- ONE-WAY CRYSTAL MARKER
◆	- TWO-WAY MARKER

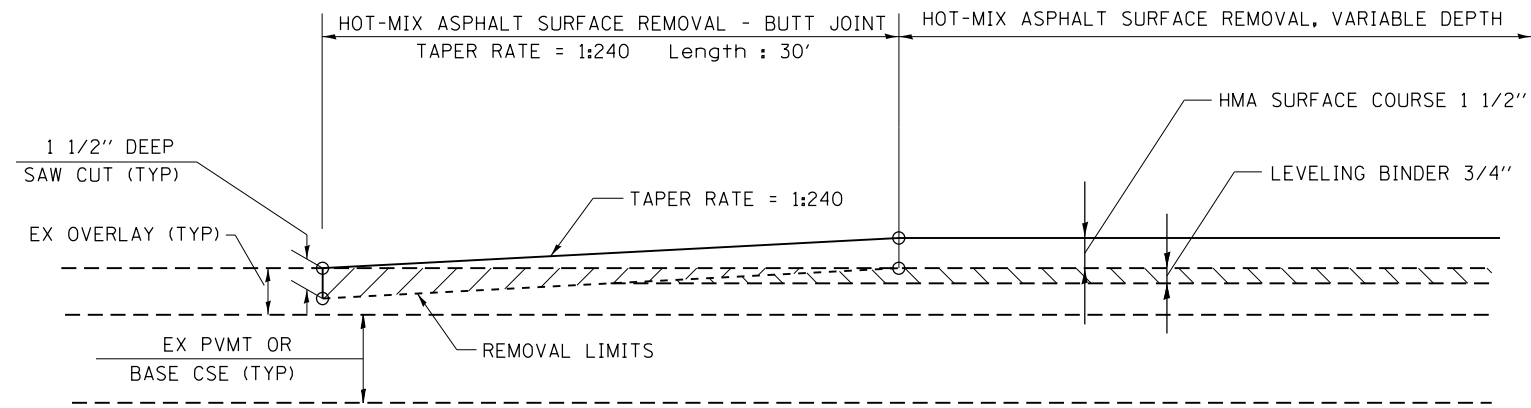

**BUTT JOINT DETAIL**

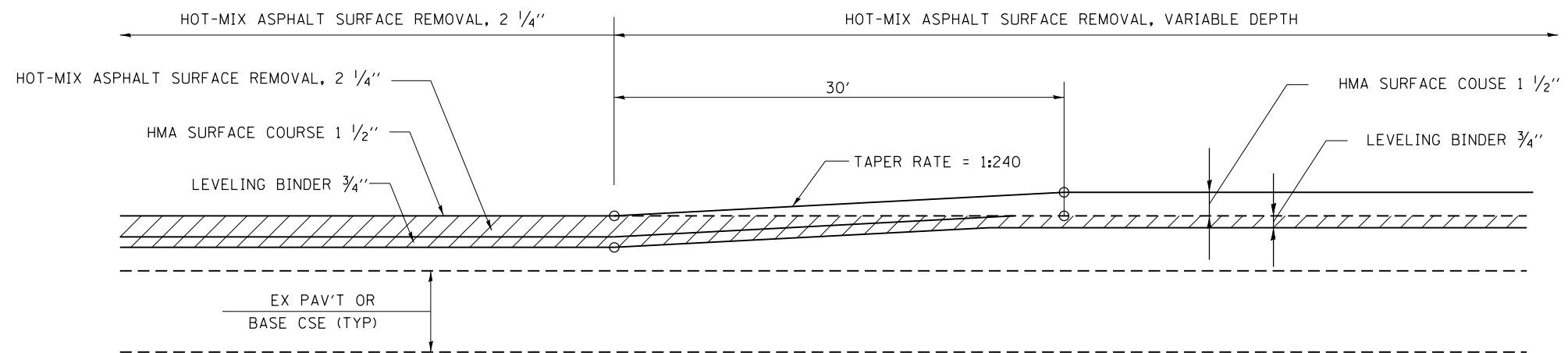

**RAMP DETAIL**  
SEE PLAN SHEETS FOR LOCATIONS

\* SAW CUT IS INCLUDED IN THE COST OF HMA SURFACE REMOVAL - BUTT JOINT, AND IS NOT TO BE PAID SEPARATELY.

FILE NAME =	USER NAME = sparksgw	DESIGNED -	REVISED -	<b>STATE OF ILLINOIS DEPARTMENT OF TRANSPORTATION</b>	<b>BUTT JOINT AND RAMP DETAIL</b>			F.A.P. RTE.	SECTION	COUNTY	TOTAL SHEETS	SHEET NO.
c:\pwwork\pwwork\sparksgw\d0402311\0672\27-shtrmp-detail.dgn	DRAWN -	REVISED -	717					(102)RS-4,(103)RS-3	LOGAN	25	22	
Default	PLOT SCALE = 100.0000' / in.	CHECKED -	REVISED -		SCALE: SHEET OF SHEETS STA. TO STA.			CONTRACT NO. 72H27				
	PLOT DATE = Jun-06-2014 01:54:18PM	DATE -	REVISED -		ILLINOIS FED. AID PROJECT							

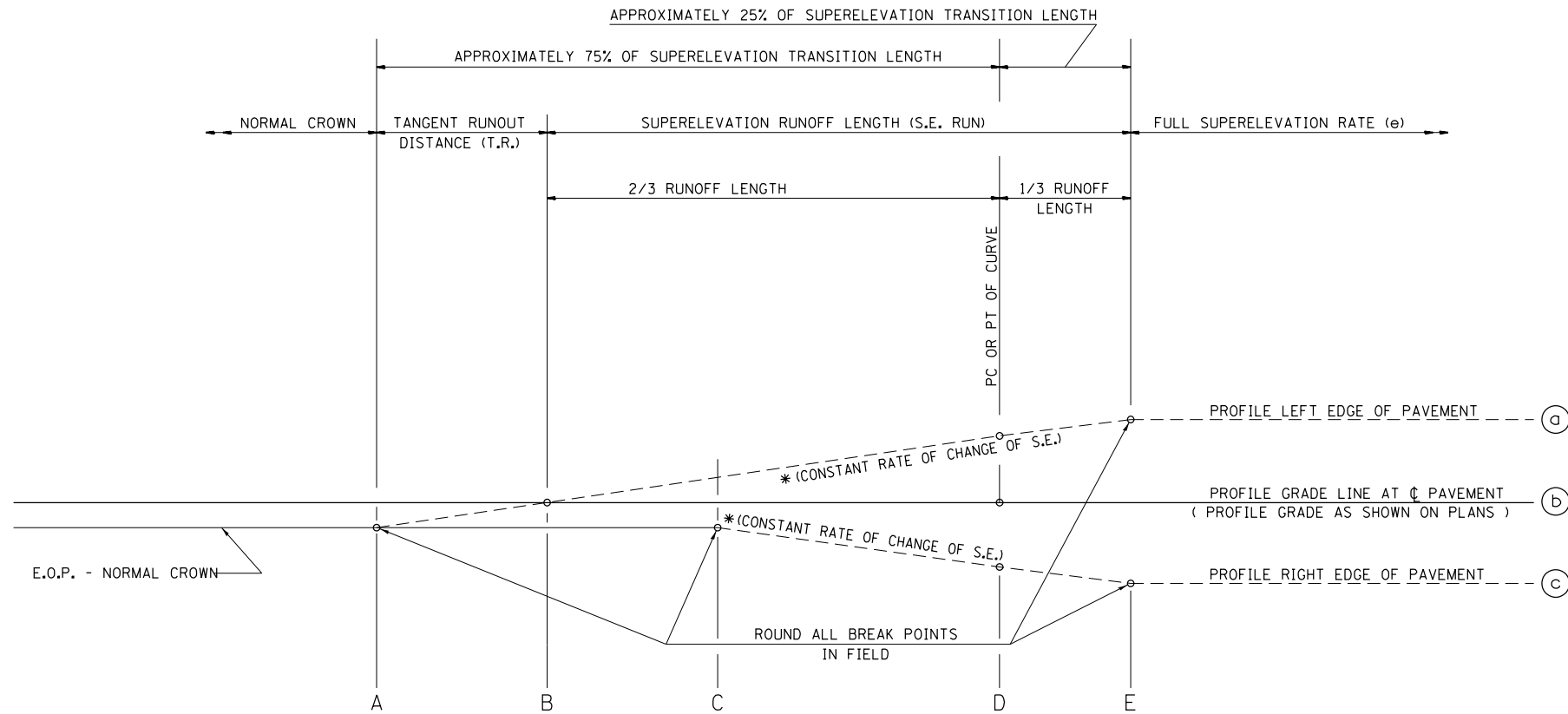

SEE PLANS FOR CURVE DATA INFORMATION  
 CURVE DATA  
 P.I. STA=  
 $\Delta$ =  
 R=  
 T=  
 L=  
 E=  
 $e$ = SUPERELEVATION RATE IN PERCENT  
 T.R.= TANGENT RUNOUT DISTANCE  
 S.E. RUN= SUPERELEVATION RUNOFF LENGTH  
 P.C. STA=  
 P.T. STA=

TYPICAL PROFILE - S.E. TRANSITION

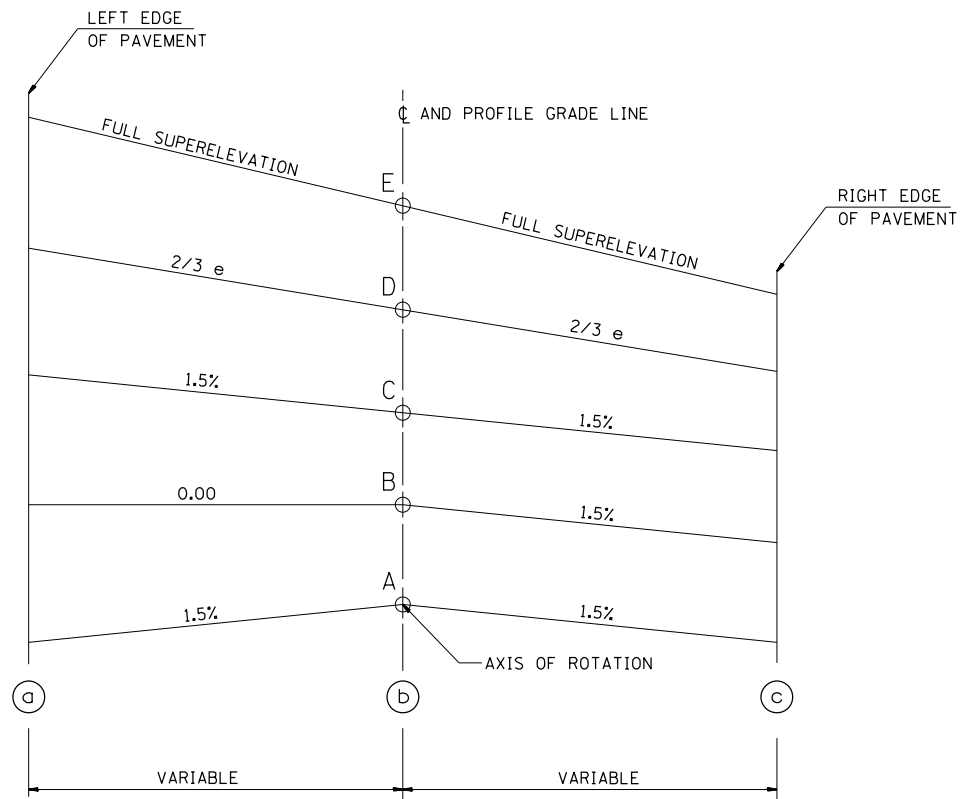

TYPICAL CROSS SECTION - S.E. TRANSITION

CURVE NO.	$e$	A	B	C	D	E	TRANSITION
313	5.2%	526+60.69	527+02.29	527+43.89	527+98.29	528+46.29	Trans. In
		539+21.49	538+79.89	538+38.29	537+83.89	537+35.89	Trans. Out

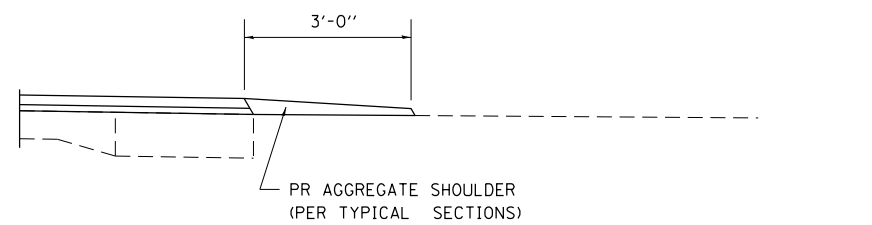

**SECTION A-A FOR EX EARTH/ AGGREGATE FE**

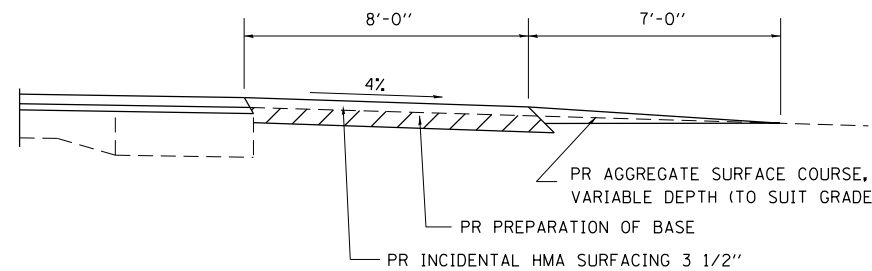

**SECTION A-A FOR EX EARTH/AGGREGATE PE**

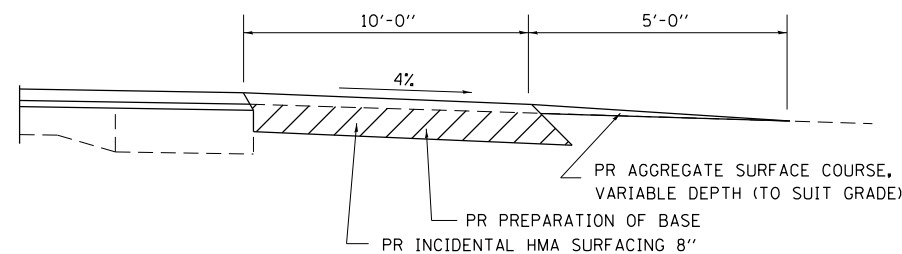

**SECTION A-A FOR EX EARTH/AGGREGATE CE & SIDE ROAD**

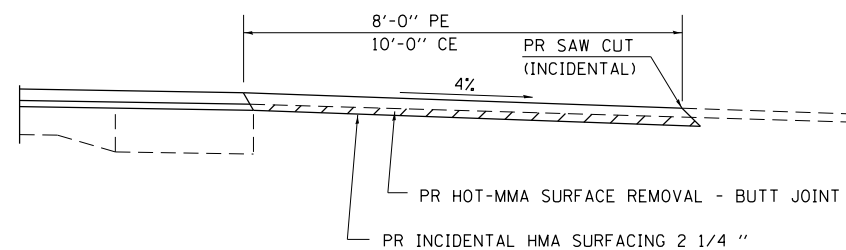

**SECTION A-A FOR EX EARTH/AGGREGATE PE/CE & SIDE ROAD WITH EXISTING HMA APRON**

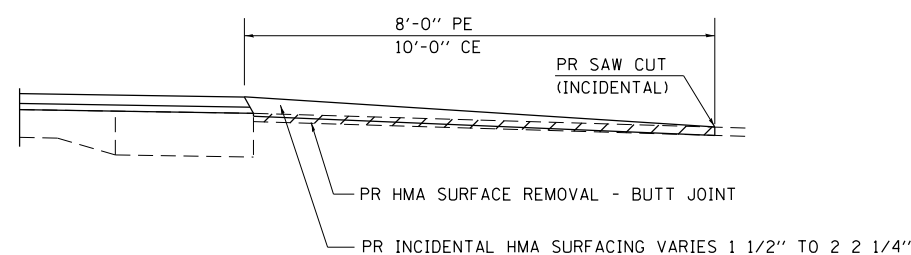

**SECTION A-A FOR EX BITUMINOUS/ PC CONCRETE PE, CE & SIDE ROAD**

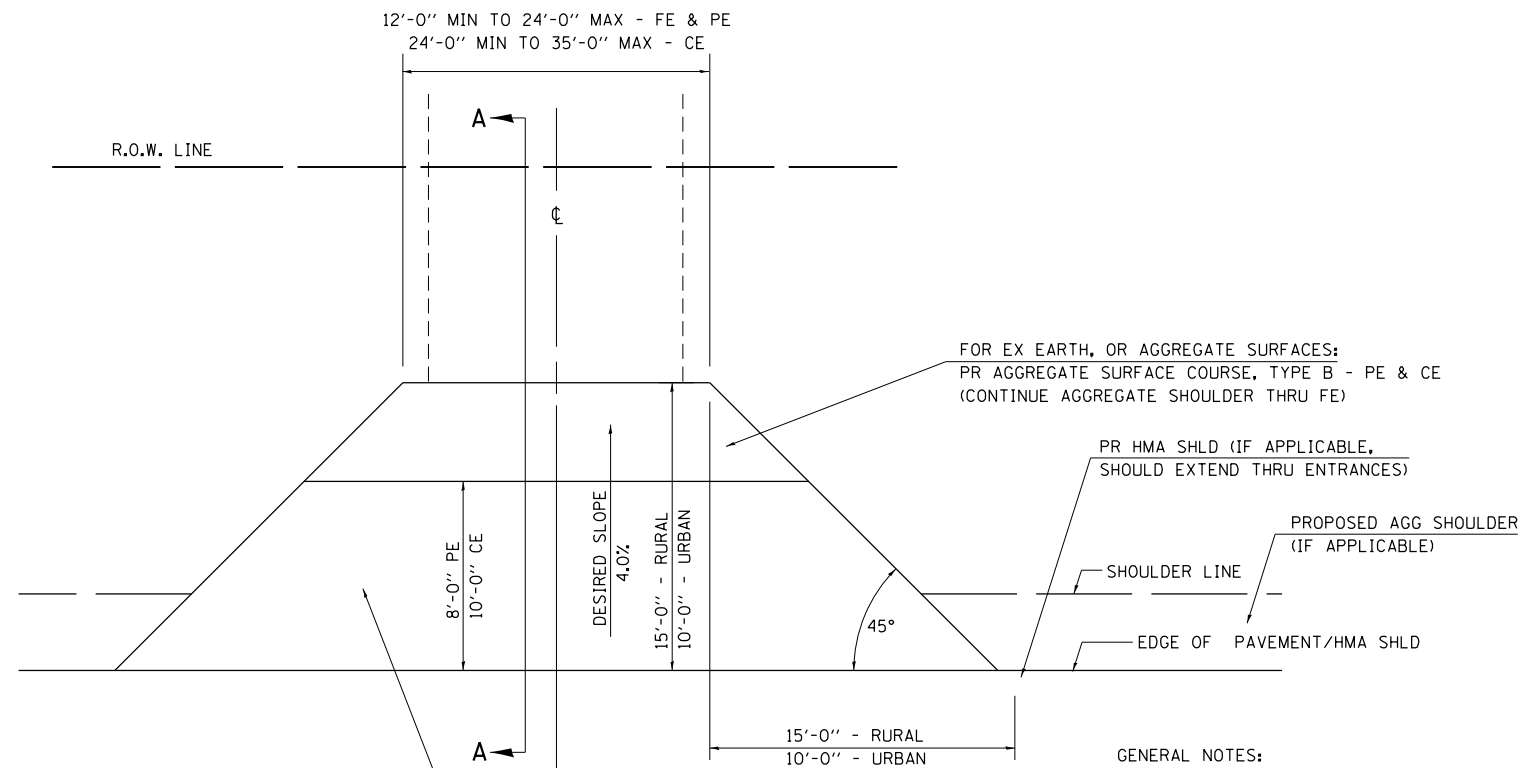

FOR EX EARTH OR AGGREGATE SURFACES WITH HMA APRONS:  
 PR HMA SURFACE REMOVAL VD (IF APPLICABLE)  
 PR AGGREGATE SHOULDER THRU - FE  
 PR INCIDENTAL HMA SURF 2 1/4 " - PE  
 PR INCIDENTAL HMA SURF 2 1/4 " - CE

FOR EX HOT-MIX ASPHALT SURFACES:  
 PR HMA SURFACE REMOVAL - BUTT JOINT

FOR EX PCC SURFACES:  
 PR HMA SURFACE REMOVAL - BUTT JOINT

**GENERAL NOTES:**

THE RESIDENT ENGINEER WILL DETERMINE THE EXACT TYPE OF IMPROVEMENT TO BE COMPLETED FOR ALL ENTRANCES, SIDEROADS AND MAILBOX TURNOUTS ON THIS PROJECT.

THE PLAN DETAILS AND SCHEDULES SHOULD BE USED AS A GUIDE FOR THE ENGINEER TO IMPLEMENT THE FINAL DESIGN. THE ENGINEER MAY DECIDE TO SALVAGE PORTIONS OF THE EXISTING ENTRANCE PAVEMENT STRUCTURE; THEREFORE, REDUCING PAY ITEM QUANTITIES. NO ADDITIONAL PAYMENT WILL BE ALLOWED FOR THIS REDUCTION IN QUANTITIES.

ANY WORK THE ENGINEER REQUIRES WHICH IS NOT COVERED BY A PAY ITEM CONTAINED IN THE PLANS WILL BE PAID FOR IN ACCORDANCE WITH ARTICLE 109.04 OF THE STANDARD SPECIFICATIONS.

HOT-MIX ASPHALT REQUIRED TO CONSTRUCT THE ENTRANCES SHALL BE IN ACCORDANCE WITH THE APPLICABLE PORTIONS OF SECTION 406 AND 408 OF THE STANDARD SPECIFICATIONS AND AS DIRECTED BY THE ENGINEER.

WHEN THE HOT-MIX ASPHALT PROPOSED FOR THE IMPROVEMENT IS THICKER THAN 3 INCHES AND REQUIRE PLACEMENT IN MORE THAN ONE LIFT. THE BOTTOM LIFT(S) SHALL MEET THE REQUIREMENTS OF BITUMINOUS BASE COURSE IN SECTION 406 OF THE STANDARD SPECIFICATIONS AND THE TOP LIFT OF 2 INCHES SHALL MEET THE REQUIREMENTS OF HOT-MIX ASPHALT SURFACE COURSE.

THIS WORK WILL BE PAID FOR IN ACCORDANCE WITH SECTIONS 351, 358, 408, 423 AND 440 OF THE STANDARD SPECIFICATIONS.

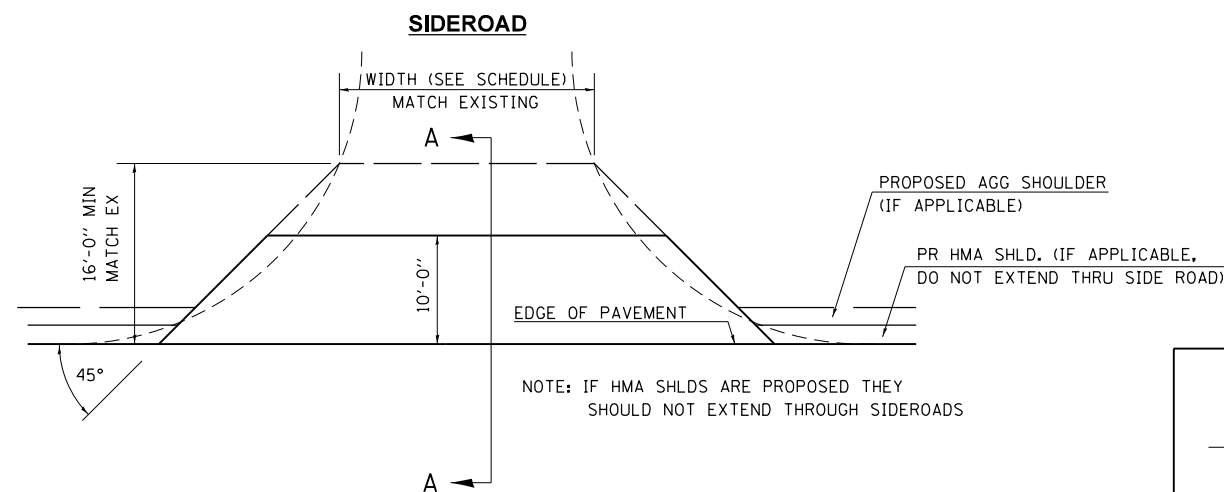

NOTE: IF HMA SHLDS ARE PROPOSED THEY SHOULD NOT EXTEND THROUGH SIDEROADS

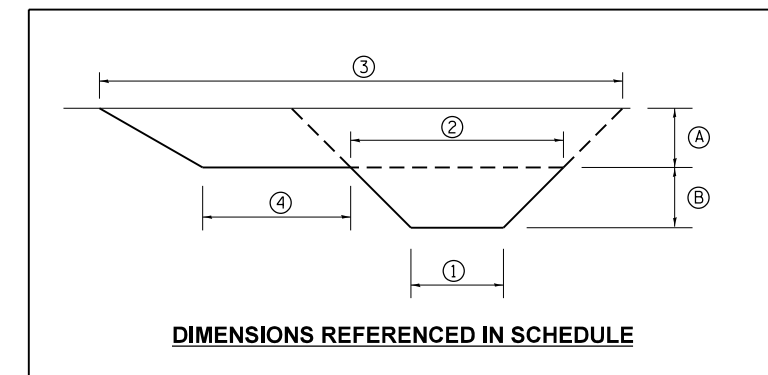

FILE NAME =	USER NAME = sparksgw	DESIGNED -	REVISED -
c:\pwork\work\pwork\sparksgw\0402311\0672\27-sht-ent-details.dgn		DRAWN -	REVISED -
Default	PLOT SCALE = 100.0000' / in.	CHECKED -	REVISED -
	PLOT DATE = Jun-06-2014 01:54:21PM	DATE -	REVISED -

**STATE OF ILLINOIS  
DEPARTMENT OF TRANSPORTATION**

**DIST. 6 DETAILS FOR RURAL/URBAN ENT., MAILBOX  
TURNOUT & SIDEROADS W/O CONC. GUTTER (3P-PROJ.)**

SCALE: SHEET OF SHEETS STA. TO STA.

F.A.P. RTE.	SECTION	COUNTY	TOTAL SHEETS	SHEET NO.
717	(102)RS-4,(103)RS-3	LOGAN	25	24
CONTRACT NO. 72H27			ILLINOIS FED. AID PROJECT	



# DETAILS OF MAILBOX TURNOUTS

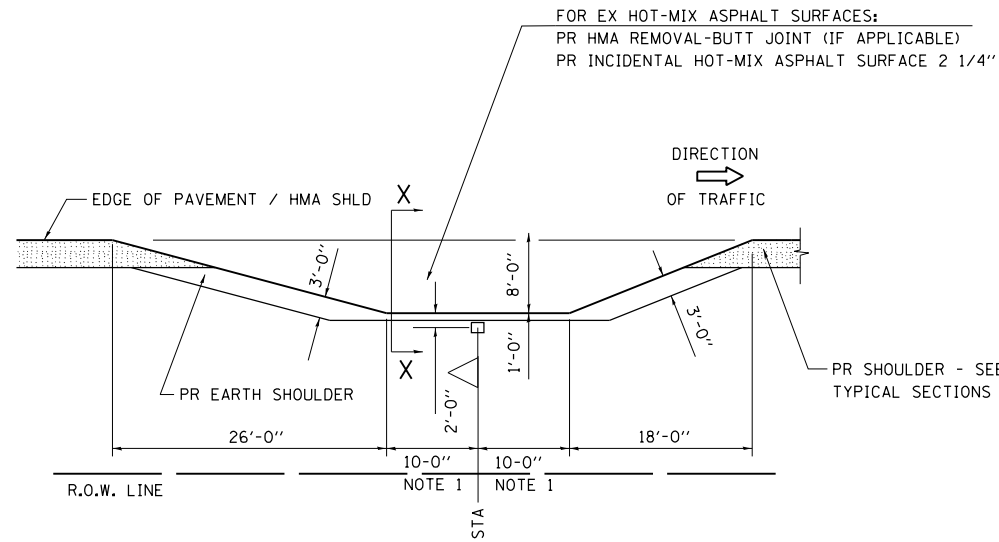

**PLAN - MAILBOX TURNOUTS**

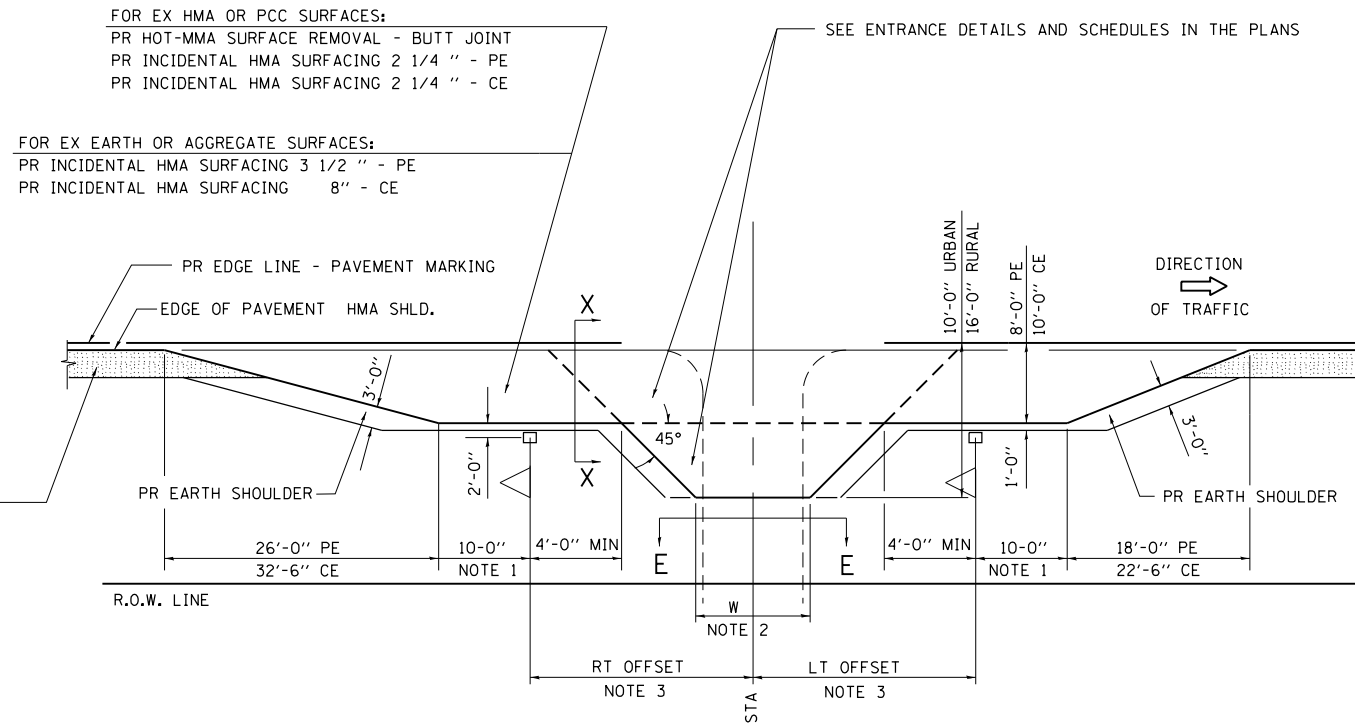

**PLAN - COMBINED MAILBOX TURNOUT WITH TRAILING OR LEADING ENTRANCE**

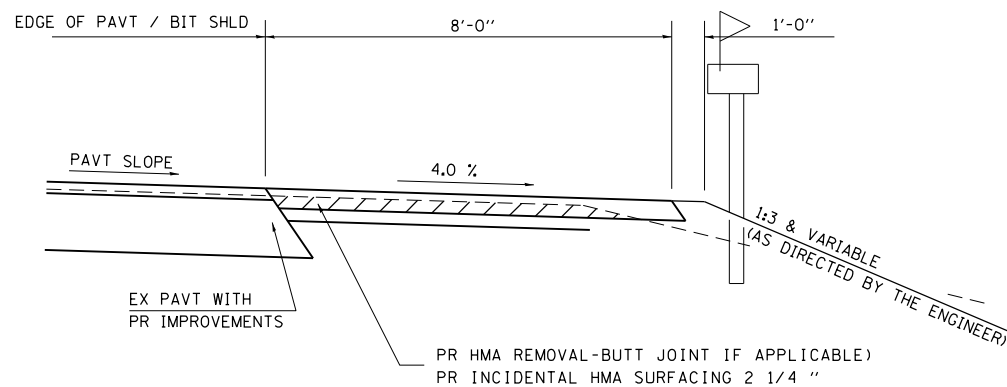

**SECTION X-X THRU MAILBOX TURNOUT  
 ALSO APPLIES TO MAILBOX TURNOUTS COMBINED WITH  
 EX EARTH, AGGREGATE, OR BITUMINOUS PE & FE**

(DETAIL APPLIES WHEN M.B. TURNOUT DOES NOT EXIST.  
 IF EXISTING, TREAT SAME AS ENTRANCE.)

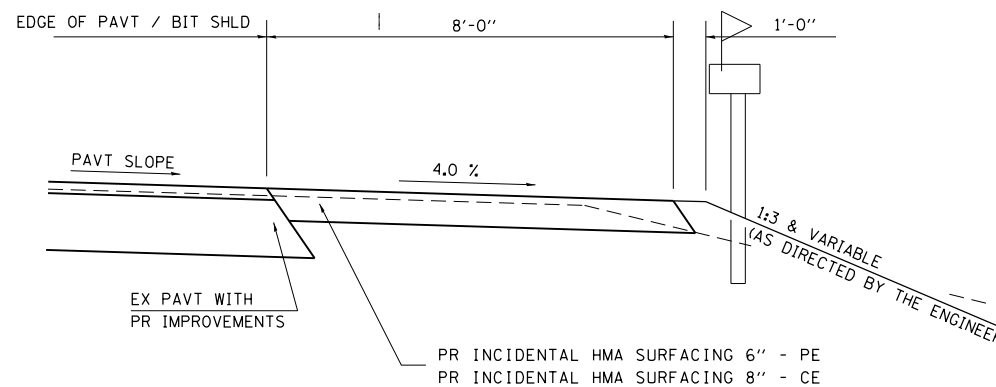

**SECTION X-X THRU MAILBOX TURNOUT  
 COMBINED WITH EX BITUMINOUS CONC & PC CONC PE & CE**

(DETAIL APPLIES WHEN M.B. TURNOUT DOES NOT EXIST.  
 IF EXISTING, TREAT SAME AS ENTRANCE.)

- NOTE 1 IF MORE THAN ONE MAILBOX IS PRESENT, DIMENSION FROM CENTER OF END MAILBOX.
- NOTE 2 FOR ENTRANCE LAYOUT DIMENSIONS AND SECTIONS A-A & E-E REFER TO THE SCHEDULES IN THE PLANS.
- NOTE 3 BOTH LT OR RT OFFSETS FOR MAILBOX SHOWN USE OFFSET DIMENSION PER SCHEDULE AND REFER TO LAYOUT SHOWN ON THE PLAN.

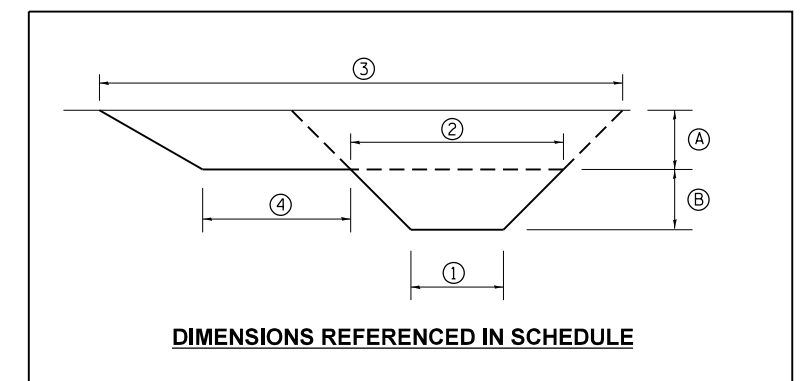

FILE NAME =	USER NAME = sparksgw	DESIGNED -	REVISED -	<b>STATE OF ILLINOIS DEPARTMENT OF TRANSPORTATION</b>	<b>DIST. 6 DETAILS FOR RURAL/URBAN ENT., MAILBOX TURNOUT &amp; SIDEROADS W/O CONC. GUTTER (3P-PROJ.)</b>	F.A.P. RTE.	SECTION	COUNTY	TOTAL SHEETS	SHEET NO.	
		DRAWN -	REVISED -			717	(102)RS-4,(103)RS-3	LOGAN	25	25	
		CHECKED -	REVISED -			CONTRACT NO. 72H27					
		DATE -	REVISED -			ILLINOIS FED. AID PROJECT					
Default	PLOT DATE = Jun-06-2014 01:54:21PM			SCALE:	SHEET OF SHEETS	STA.	TO STA.				