

|                     |                |                    |                 |             |
|---------------------|----------------|--------------------|-----------------|-------------|
| F.A.P. RTE. 781     | SECTION 109B-1 | COUNTY LAWRENCE    | TOTAL SHEETS 34 | SHEET NO. 1 |
| FED. ROAD DIST. NO. | ILLINOIS       | CONTRACT NO. 74105 |                 |             |

D-97-034-05 \*34+1=35

STATE OF ILLINOIS  
DEPARTMENT OF TRANSPORTATION  
DIVISION OF HIGHWAYS

**PROPOSED  
HIGHWAY PLANS**

FAP RTE 781 (IL 33)  
SECTION 109B-1

LAWRENCE COUNTY

C - 97 - 069 - 05

STRUCTURE REPLACEMENT  
OVER UNNAMED STREAM

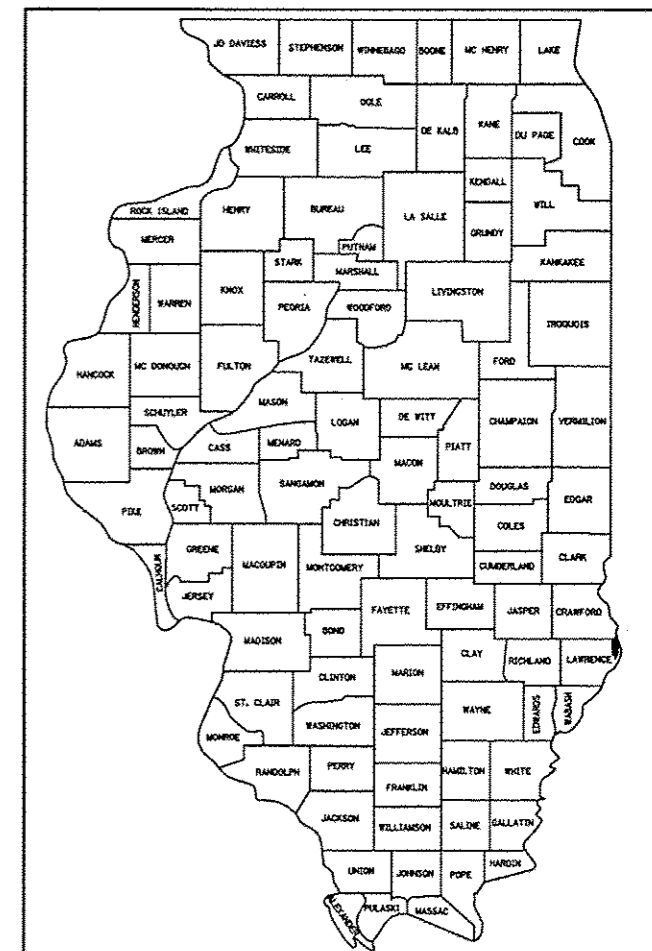

LOCATION OF SECTION INDICATED THIS: —

FUNCTIONAL CLASSIFICATION: RURAL MINOR ARTERIAL

|               |           |
|---------------|-----------|
| DESIGN SPEED: | 55 mph    |
| POSTED SPEED: | 55 mph    |
| ADT:          | 859(2011) |
| PV:           | 88.7%     |
| SU:           | 5.0%      |
| MU:           | 6.3%      |

STATE OF ILLINOIS  
DEPARTMENT OF TRANSPORTATION  
DIVISION OF HIGHWAYS

SUBMITTED July 2 2014  
*Raymond L. Driskell*  
DEPUTY DIRECTOR OF HIGHWAYS, REGION ENGINEER

June 27 2014  
*John D. Baranzelli* P.E.  
acting ENGINEER OF DESIGN AND ENVIRONMENT

June 27 2014  
*Omer Osman* P.E.  
DIRECTOR OF HIGHWAYS, CHIEF ENGINEER

**INDEX OF SHEETS**

| SHEET NO.                       | DESCRIPTION                                       |
|---------------------------------|---------------------------------------------------|
| <b>ROADWAY PLANS</b>            |                                                   |
| 1.                              | COVER SHEET                                       |
| 2.                              | GENERAL NOTES                                     |
| 3.                              | STANDARDS                                         |
| 4.                              | SUMMARY OF QUANTITIES                             |
| 5.                              | TYPICAL SECTIONS                                  |
| 6.                              | SCHEDULES OF QUANTITIES                           |
| 7.-9.                           | FAP RTE 781 (IL 33) PLAN AND PROFILE              |
| 10.-11.                         | STAGE CONSTRUCTION PLANS                          |
| 12.                             | STAGE CONSTRUCTION DETAILS                        |
| 13.                             | EROSION CONTROL AND DRAINAGE PLAN                 |
| 14.                             | MISCELLANEOUS DETAILS                             |
| <b>STRUCTURE PLANS</b>          |                                                   |
| 15.                             | GENERAL PLAN                                      |
| 16.                             | GENERAL DATA                                      |
| 17.-18.                         | STAGE CONSTRUCTION DETAILS                        |
| 19.-20.                         | BOX CULVERT DETAILS                               |
| 21.                             | STEEL SHEET PILING WALL DETAILS                   |
| 22.                             | BAR SPLICER ASSEMBLY DETAILS                      |
| 23.                             | TEMPORARY CONCRETE BARRIER FOR STAGE CONSTRUCTION |
| 24.                             | BORING LOGS                                       |
| <b>EXISTING STRUCTURE PLANS</b> |                                                   |
| 25.-28.                         | EXISTING STRUCTURE PLANS                          |
| <b>CROSS SECTIONS</b>           |                                                   |
| 29.-34.                         | FAP 781 (IL 33) CROSS SECTIONS                    |

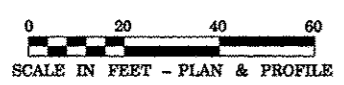

FULL SIZE PLANS HAVE BEEN PREPARED USING STANDARD ENGINEERING SCALES. REDUCED SIZED PLANS WILL NOT CONFORM TO STANDARD SCALES. IN MAKING MEASUREMENTS ON REDUCED PLANS, THE ABOVE SCALES MAY BE USED.

MICROFILMED \_\_\_\_\_  
REEL NUMBER \_\_\_\_\_  
AWARDED \_\_\_\_\_  
RESIDENT ENGINEER \_\_\_\_\_  
AS BUILT CHANGES WERE MADE ON THE FOLLOWING SHEETS \_\_\_\_\_

J.U.L.I.E.  
JOINT UTILITY LOCATION INFORMATION FOR EXCAVATION  
1-800-892-0123  
OR 811

DISTRICT 7 NO. (217) 342-3951  
PROJECT ENGINEER: TOM RONAN  
UNIT CHIEF:  
TOWNSHIP: RUSSELL  
CONTRACT NO.: 74105

**ESCA**  
CONSULTANTS, INC.

CIVIL & STRUCTURAL ENGINEERS  
URBANA, ILLINOIS  
ESCA JOB NO. 933.13



*Richard D. Payne*  
DATE: 06/30/11  
ILLINOIS PROFESSIONAL LICENSE NO. 37421  
(EXPIRATION DATE: 11-30-11)

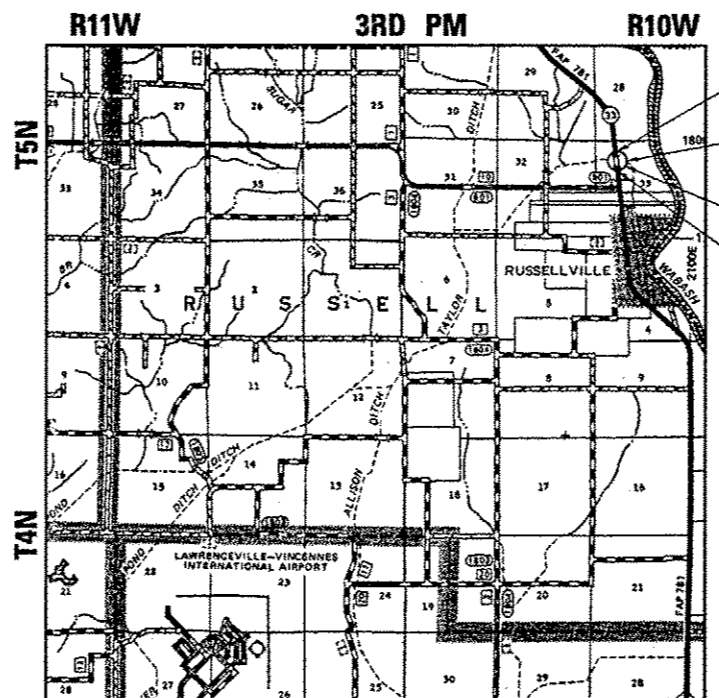

LOCATION MAP

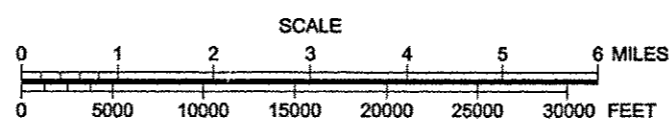

GROSS LENGTH = 720.5 FT. = 0.136 MI.  
NET LENGTH = 720.5 FT. = 0.136 MI.

DESIGN DESIGNATION  
N.A.

PRINTED BY THE AUTHORITY  
OF THE STATE OF ILLINOIS