

- LEGEND**
- TRAFFIC SIGNAL WITH BACKPLATE, SIGNAL DIRECTION INDICATED
  - PCC BASE COURSE WIDENING, 8"
  - PAVEMENT REMOVAL

**SCHEDULE OF QUANTITIES**

TEMPORARY CONCRETE BARRIER		
STATION TO	STATION	FEET
704+52.5	706+40	187.5
		TOTAL 187.5

TEMPORARY BRIDGE TRAFFIC SIGNALS - 1 EACH  
 TEMPORARY RUMBLE STRIPS - 6 EACH  
 IMPACT ATTENUATORS, TEMPORARY (NON-REDIRECTIVE), TEST LEVEL 3 - 2 EACH

**GENERAL NOTES**

1. TRAFFIC CONTROL SHALL BE ERECTED AS SHOWN AND ACCORDING TO "TRAFFIC CONTROL AND PROTECTION, STANDARD 701321."
2. SEE SPECIAL PROVISIONS FOR ADDITIONAL TRAFFIC CONTROL REQUIREMENTS.
3. COORDINATE LOCATION OF SIGNALS WITH FINAL WORK AS DIRECTED BY THE ENGINEER.
4. CONSTRUCT TEMPORARY RUMBLE STRIPS AT LOCATIONS SHOWN ON STANDARD 701321.
5. ADDITIONAL SIGNAGE FOR SIDE-ROADS AND ENTRANCES SHALL BE INCLUDED IN THE COST OF STANDARD 701321.
6. THE DIMENSION SHOWN ON THE WIDTH RESTRICTION SIGN (W2-1102(O)-48) SHOWN ON STANDARD 701321 SHALL BE 12'-4" FOR STAGE I CONSTRUCTION.

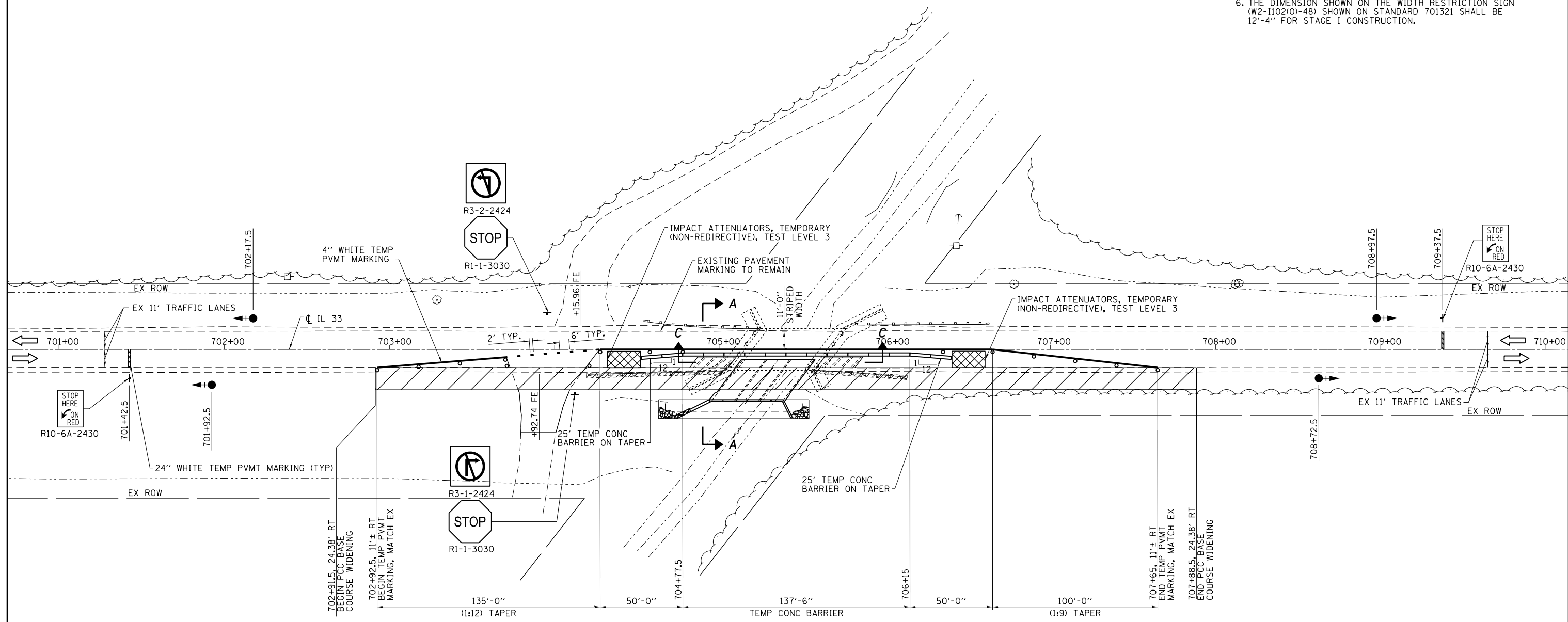

FILE NAME =	USER NAME = steffennk	DESIGNED - DAJ	REVISED -	<b>STATE OF ILLINOIS DEPARTMENT OF TRANSPORTATION</b>	<b>STAGE I CONSTRUCTION</b>	F.A.P. RTE.	SECTION	COUNTY	TOTAL SHEETS	SHEET NO.
74105A.dwg	06/09/14 09:33.13	DRAWN - HAS	REVISED -			781	109B-1	LAWRENCE	34	10
PLOT SCALE = 0.1667' / in.	CHECKED - ELH	REVISIED -	REVISIED -			CONTRACT NO. 74105				
PLOT DATE = 6/2/2014 1:30:27 PM	DATE - 06/11	REVISIED -	REVISIED -			FED. ROAD DIST. NO.	ILLINOIS	FED. AID PROJECT		