

•PAID FOR AS HMA SHOULDERS, 13"
PRE-STAGE I TYPICAL SECTION

WB STA 1042+00 TO STA 1070+60	EB STA 1036+00 TO STA 1070+30
WB STA 1076+10 TO STA 1140+80	EB STA 1075+80 TO STA 1140+45
WB STA 1147+50 TO STA 1171+05	EB STA 1147+15 TO STA 1170+70
WB STA 1173+50 TO STA 1239+85	EB STA 1173+20 TO STA 1239+80
WB STA 1245+95 TO STA 1297+45	EB STA 1245+30 TO STA 1296+80
WB STA 1302+95 TO STA 1416+40	EB STA 1300+90 TO STA 1416+05
WB STA 1422+50 TO STA 1531+50	EB STA 1422+15 TO STA 1523+85

HMA BINDER COURSE, IL-19.0 N70 (6'')
 HMA BINDER COURSE, IL-19.0 N70 (4'')
 HMA BINDER COURSE, IL-19.0 N90 (3'')

HMA SURFACE REMOVAL 6''
 RUBBLIZING PCC PAVEMENT

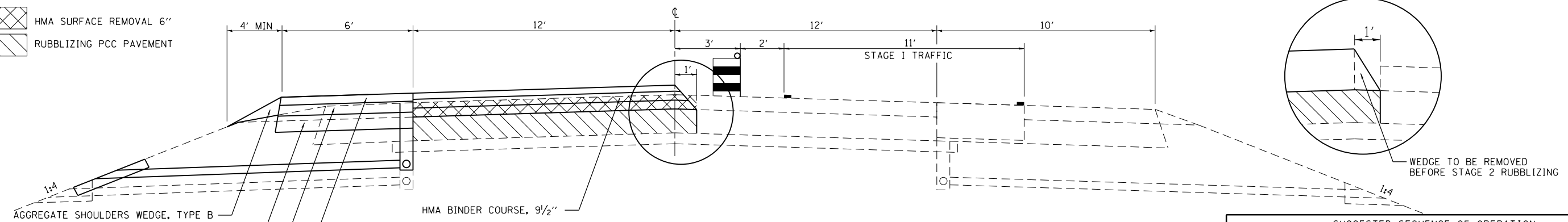

•PAID FOR AS HMA SHOULDERS, 13"
STAGE I TYPICAL SECTION

EB STA 1043+44 TO STA 1070+30	WB STA 1043+44 TO STA 1070+60
EB STA 1075+80 TO STA 1140+45	WB STA 1076+10 TO STA 1140+80
EB STA 1147+15 TO STA 1239+80	WB STA 1147+50 TO STA 1239+85
EB STA 1245+30 TO STA 1296+80	WB STA 1245+95 TO STA 1297+45
EB STA 1302+90 TO STA 1416+05	WB STA 1302+95 TO STA 1416+40
EB STA 1422+15 TO STA 1523+85	WB STA 1422+50 TO STA 1524+20

AGGREGATE SHOULDERS WEDGE, TYPE B
 HMA BINDER COURSE, IL-19.0 N70 (6'')
 HMA BINDER COURSE, IL-19.0 N70 (4'')
 HMA BINDER COURSE, IL-19.0 N90 (3'')

SUGGESTED SEQUENCE OF OPERATION

Both stages of rubblization/replacement sections shall be complete, with the exception of SMA surface course, prior to opening both lanes to traffic.

The following is a suggested sequence of operations:

1. Patch diving lane pavement on entire project. Patch both lanes from the beginning of the closure tapers through the beginning of the traffic control setup.
2. Remove 4' of driving lane shoulder and construct HMA Shoulder 13" (pre-stage 1).
3. Install pipe underdrain on passing lane side (stage I).
4. Remove 4' passing lane shoulder and construct 6' HMA Shoulder 13" (stage I).
5. Construct stage I rubblization sections and pavement replacement under the overhead structures.
6. Install pipe underdrain on driving lane side (stage II).
7. Construct stage II rubblization sections and pavement replacement under the overhead structures.
8. Construct SMA Surface course on mainline.

HMA SURFACE REMOVAL 6''
 RUBBLIZING PCC PAVEMENT

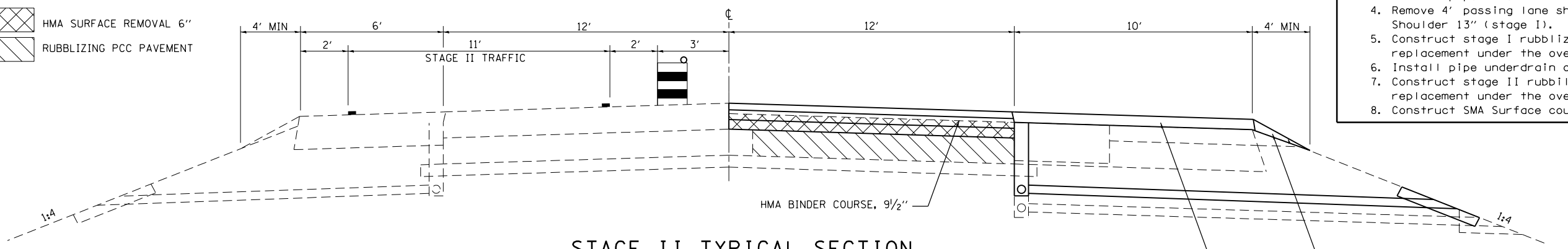

STAGE II TYPICAL SECTION

EB STA 1043+44 TO STA 1070+30	WB STA 1043+44 TO STA 1070+60
EB STA 1075+80 TO STA 1140+45	WB STA 1076+10 TO STA 1140+80
EB STA 1147+15 TO STA 1239+80	WB STA 1147+50 TO STA 1239+85
EB STA 1245+30 TO STA 1296+80	WB STA 1245+95 TO STA 1297+45
EB STA 1302+90 TO STA 1416+05	WB STA 1302+95 TO STA 1416+40
EB STA 1422+15 TO STA 1523+85	WB STA 1422+50 TO STA 1524+20

AGGREGATE SHOULDERS WEDGE, TYPE B
 HMA SHOULDERS (3 1/2'')

• EFFINGHAM & FAYETTE

FILE NAME =	USER NAME = swartzrw	DESIGNED -	REVISED -	STATE OF ILLINOIS DEPARTMENT OF TRANSPORTATION	RUBBLIZATION STAGE CONSTRUCTION DETAILS			F.A.I. RTE.	SECTION	COUNTY	TOTAL SHEETS	SHEET NO.	
Default	ei:\pw\work\pwidot\swartzrw\d0186577\077469-sht-stage1typicals.dgn	DRAWN -	REVISED -		SCALE: NA	SHEET 1	OF 2 SHEETS	STA.	TO STA.	70	(26-5,26-5-1,25-1-1R)	92	47
	PLOT SCALE = 100.0000' / in.	CHECKED -	REVISED -		CONTRACT NO. 74469								
	PLOT DATE = 6/5/2014	DATE -	REVISED -		ILLINOIS FED. AID PROJECT								