

STATE OF ILLINOIS  
DEPARTMENT OF TRANSPORTATION  
DIVISION OF HIGHWAYS

**PROPOSED  
HIGHWAY PLANS**

F.A.P. ROUTES 328 / 821 (U.S. RTE. 45 / IL. RTE. 15)  
SECTION D7 HMA RESURF 2015-9

FOR INDEX OF SHEETS, SEE SHEET NO. 2

ADT = 3500

INTERMITTENT RESURFACING  
WAYNE COUNTY

C-97-097-14

F.A.P. RTE.	SECTION	COUNTY	TOTAL SHEETS	SHEET NO.
328	D7 HMA RESURF 2015-9	WAYNE	12	1
ILLINOIS			CONTRACT NO. 74690	

D-97-051-14

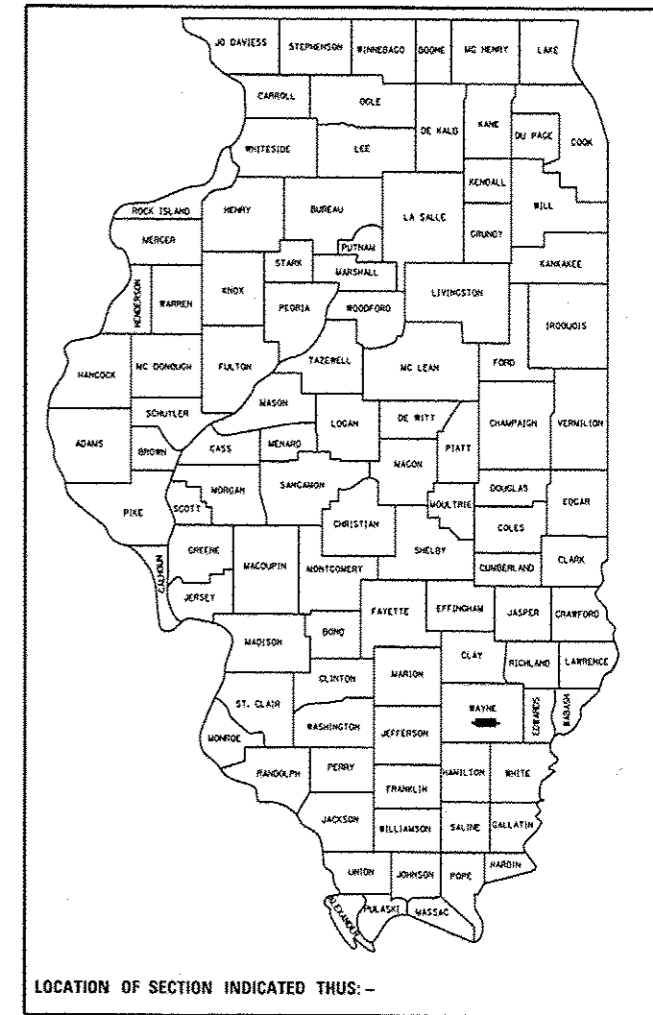

F.A.P. ROUTES 328 & 821  
(U.S. RTE. 45 & IL. RTE. 15)  
SECTION D7 HMA RESURF 2015-9  
WAYNE COUNTY

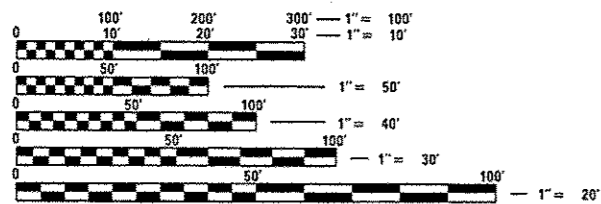

FULL SIZE PLANS HAVE BEEN PREPARED USING STANDARD ENGINEERING SCALES. REDUCED SIZED PLANS WILL NOT CONFORM TO STANDARD SCALES. IN MAKING MEASUREMENTS ON REDUCED PLANS, THE ABOVE SCALES MAY BE USED.

J.U.L.I.E.  
JOINT UTILITY LOCATION INFORMATION FOR EXCAVATION  
1-800-892-0123  
OR 811

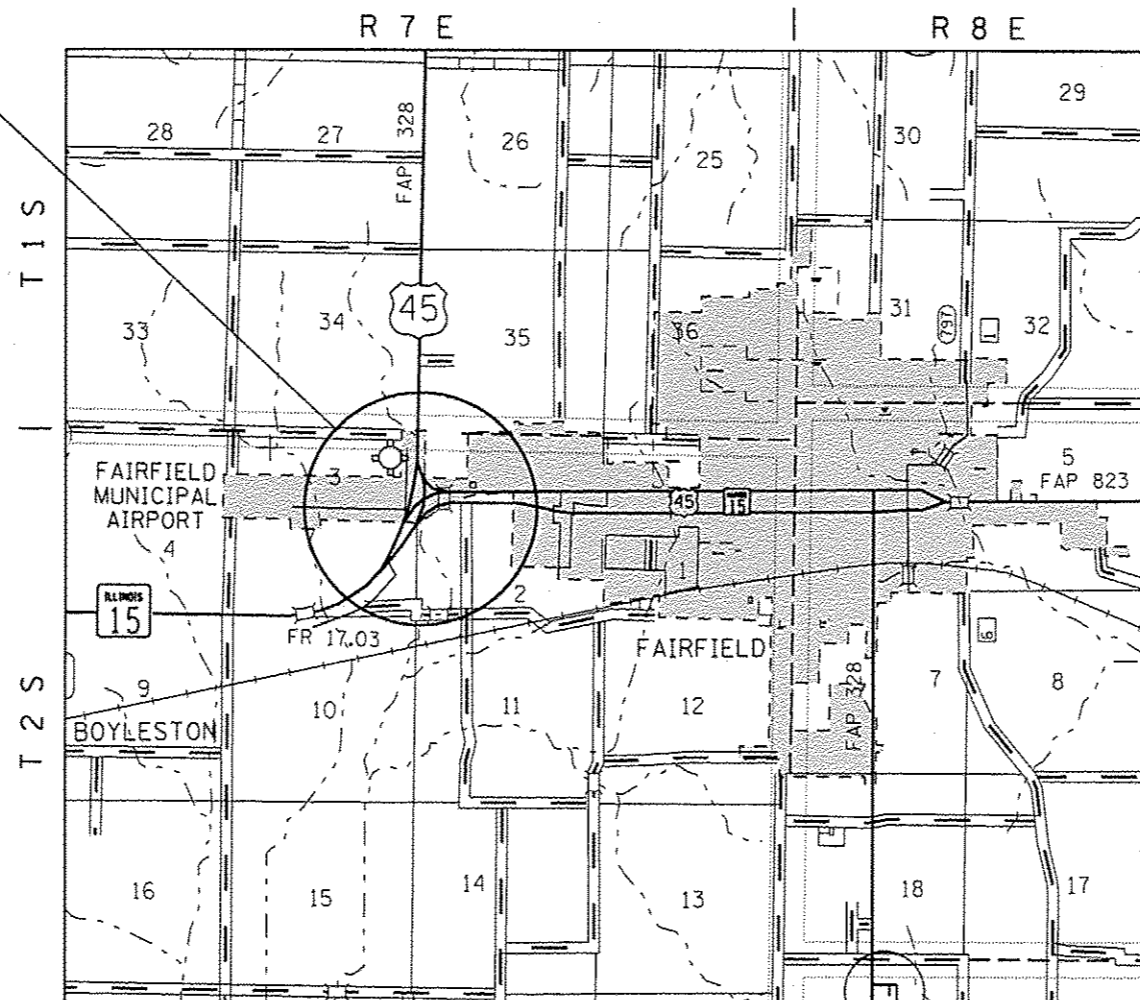

PROJECT ENGINEER: TOM RONAN  
PROJECT MANAGER: JENNY SHULL  
PHONE: (217)-342-8361  
CONTRACT NO. 74690

STATE OF ILLINOIS  
DEPARTMENT OF TRANSPORTATION  
DIVISION OF HIGHWAYS

SUBMITTED May 22 2014  
*[Signature]*  
DEPUTY DIRECTOR OF HIGHWAYS, REGION ENGINEER

June 27 2014  
*John D. Baranzoni, PE*  
ENGINEER OF DESIGN AND ENVIRONMENT

June 27 2014  
*Omer Osman, PE*  
DIRECTOR OF HIGHWAYS, CHIEF ENGINEER

PRINTED BY THE AUTHORITY  
OF THE STATE OF ILLINOIS

## INDEX OF SHEETS

SHEET NO.	ITEM
1	COVER SHEET
2	INDEX OF SHEETS & GENERAL NOTES
3	SUMMARY OF QUANTITIES
4	TYPICAL SECTION
5-6	SCHEDULE OF QUANTITIES
7-8	PLAN SHEETS
9-12	PAVEMENT MARKING DETAILS

THE FOLLOWING STANDARDS ARE A PART OF THESE PLANS AND ARE INCLUDED AFTER SHEET NO. 12:

STD. NO.	DESCRIPTION
000001-06	STANDARD SYMBOLS, ABBREVIATIONS AND PATTERNS
001006	DECIMAL OF AN INCH AND OF A FOOT
442201-03	CLASS C AND D PATCHES
701001-02	OFF-RD OPERATIONS, 2L, 2W, MORE THAN 15' AWAY
701006-05	OFF-RD OPERATIONS, 2L, 2W, 15' TO 24" FROM PAVEMENT EDGE
701011-04	OFF-RD MOVING OPERATIONS, 2L, 2W, DAY ONLY
701301-04	LANE CLOSURE, 2L, 2W, SHORT TIME OPERATIONS
701311-03	LANE CLOSURE, 2L, 2W, MOVING OPERATIONS - DAY ONLY
701411-08	LANE CLOSURE, MULTILANE, AT ENTRANCE OR EXIT RAMP, FOR SPEEDS >= 45 MPH
701426-06	LANE CLOSURE, MULTILANE, INTERMITTENT OR MOVING OPER., FOR SPEEDS >= 45 MPH
701501-06	URBAN LANE CLOSURE, 2L, 2W, UNDIVIDED
701601-09	URBAN LANE CLOSURE, MULTILANE, 1W OR 2W WITH NONTRAVERSABLE MEDIAN
701901-03	TRAFFIC CONTROL DEVICES
780001-04	TYPICAL PAVEMENT MARKINGS
781001-03	TYPICAL APPLICATIONS RAISED REFLECTIVE PAVEMENT MARKERS

## GENERAL NOTES

THIS SECTION SHALL BE CONSTRUCTED IN ACCORDANCE WITH THE PLANS; THE "STANDARD SPECIFICATIONS FOR ROAD AND BRIDGE CONSTRUCTION" ADOPTED JANUARY 1, 2012; AND THE SPECIAL PROVISIONS INCLUDED IN THE PROPOSAL.

THIS PROJECT IS LOCATED AT THE INTERSECTION OF US 45 AND IL 15, WEST OF FAIRFIELD IN WAYNE COUNTY. THE WORK INCLUDED IN SECTION 07 HMA RESURF 2015-9 CONSISTS OF PATCHING, HOT-MIX ASPHALT SURFACE REMOVAL, HOT-MIX ASPHALT RESURFACING, PAVEMENT MARKING, AND ANY OTHER WORK NECESSARY TO COMPLETE THE SECTION.

PAVEMENT MARKING SHALL BE APPLIED IN ACCORDANCE WITH SECTION 780 OF THE STANDARD SPECIFICATIONS. SHORT TERM PAVEMENT MARKING SHALL BE APPLIED TO THE MILLED SURFACE, BITUMINOUS MATERIALS (PRIME COAT), AND HOT-MIX ASPHALT SURFACE COURSE AS SPECIFIED IN SECTION 703 OF THE STANDARD SPECIFICATIONS. TEMPORARY TAPE SHALL BE USED ON THE SURFACE COURSE. PAINT SHALL BE USED ON MILLED SURFACES.

THE TOTAL QUANTITY OF THERMOPLASTIC PAVEMENT MARKING - LINE 4" CONSISTS OF 10050 FEET OF YELLOW AND 13552 FEET OF WHITE.

THE TOTAL QUANTITY OF THERMOPLASTIC PAVEMENT MARKING - LINE 8" CONSISTS OF 487 FEET OF YELLOW AND 1598 FEET OF WHITE.

THE TOTAL QUANTITY OF THERMOPLASTIC PAVEMENT MARKING - LINE 12" CONSISTS OF 30 FEET OF YELLOW AND 114 FEET OF WHITE.

THE TOTAL QUANTITY OF THERMOPLASTIC PAVEMENT MARKING - LINE 24" CONSISTS OF 58 FEET OF WHITE.

RAISED REFLECTIVE PAVEMENT MARKERS SHALL BE INSTALLED IN ACCORDANCE WITH SECTION 781 OF THE STANDARD SPECIFICATIONS. THE TOTAL QUANTITY OF RAISED REFLECTIVE PAVEMENT MARKERS CONSISTS OF 114 ONE-WAY CRYSTAL MARKERS AND 13 TWO-WAY AMBER MARKERS.

THE EXISTING PAVEMENT SHALL BE PATCHED IN ACCORDANCE WITH SECTION 442 OF THE STANDARD SPECIFICATIONS AND THE SPECIAL PROVISIONS. THE QUANTITY OF PATCHING SHOWN ON THE PLANS IS AN ESTIMATE ONLY. THE FINAL LOCATIONS AND QUANTITY SHALL BE DETERMINED BY THE ENGINEER IN THE FIELD.

THE RESIDENT ENGINEER SHALL BE THE SOLE JUDGE CONCERNING THE CURING TIME FOR THE VARIOUS HOT-MIX ASPHALT LIFTS.

THE CONTRACTOR SHALL PROVIDE INTERNET ACCESSIBILITY TO THE HOT-MIX ASPHALT PLANT QUALITY CONTROL LAB SO THAT HOT-MIX ASPHALT PLANT REPORTS CAN BE E-MAILED TO THE DISTRICT HEADQUARTERS. THIS WORK SHALL BE INCLUDED IN THE COST OF ALL HOT-MIX ASPHALT ITEMS.

IN ADDITION TO THE REQUIREMENTS IN ARTICLE 701.15( J), A LAPTOP COMPUTER SHALL BE SUPPLIED BY THE CONTRACTOR.

THE PAY ITEM TEMPORARY RAMP HAS BEEN INCLUDED FOR THE CONSTRUCTION OF TEMPORARY RAMPS IN ACCORDANCE WITH ARTICLE 406.08 OF THE STANDARD SPECIFICATIONS. THE CONTRACT UNIT PRICE PER SQUARE YARD FOR TEMPORARY RAMP SHALL INCLUDE BOTH THE INSTALLATION AND THE REMOVAL OF THE RAMPS.

A UNIFORMLY STRAIGHT SAW CUT SHALL BE MADE AT LOCATIONS WHERE PROPOSED NEW CONSTRUCTION WILL ABUT EXISTING HOT-MIX ASPHALT SURFACES. THE SAW CUT SHALL BE MADE FULL DEPTH THROUGH THE EXISTING SURFACE. THIS WORK WILL BE CONSIDERED INCLUDED IN THE COST OF THE CONTRACT ITEMS INVOLVED AND NO EXTRA COMPENSATION WILL BE ALLOWED.

THE FOLLOWING MIXTURE REQUIREMENTS ARE APPLICABLE FOR THIS PROJECT:

APPLICATION	AC/PG	DESIGN AIR VOIDS	MIXTURE COMPOSITION	FRICTION AGGREGATE
HMA SURFACE COURSE - HOT-MIX ASPHALT SURFACE COURSE, MIX "D", N90	PG 64-22	4.0% @ N=90	IL - 9.5	MIXTURE D
CLASS D PATCHES - HOT-MIX ASPHALT BINDER COURSE, IL-19.0, N70	PG 64-22	4.0% @ N=70	IL - 19.0	N/A

THE FOLLOWING RATES OF APPLICATION HAVE BEEN USED IN THE CALCULATING PLAN QUANTITIES:

BITUMINOUS MATERIALS (PRIME COAT)	0.05 LBS/SQ FT
HOT-MIX ASPHALT	112 LBS/SQ YD/INCH

FILE NAME =	USER NAME = staffanek	DESIGNED -	REVISED -	<b>STATE OF ILLINOIS DEPARTMENT OF TRANSPORTATION</b>	<b>INDEX OF SHEETS AND GENERAL NOTES</b>	F.A.P. RTE.	SECTION	COUNTY	TOTAL SHEETS	SHEET NO.
c:\pwork\pwork\staffanek\0397316\074690-shr-index.dgn	DRAWN -	REVISED -	320			07 HMA RESURF 2015-9	WAYNE	12	2	
PLOT SCALE = 1/8" = 1' / in.	CHECKED -	REVISED -	321			CONTRACT NO. 74690				
Default	PLOT DATE = 5/22/2014	DATE -	REVISED -			ILLINOIS FED. AID PROJECT				
						SCALE: N/A	SHEET 1	OF 1	SHEETS	STA. TO STA.

SUMMARY OF QUANTITIES			TOTAL QUANTITIES	CONSTRUCTION TYPE CODE		
CODE NO	ITEM	UNIT		0005		
40600990	TEMPORARY RAMP	SO YD	334	334		
40603345	HOT-MIX ASPHALT SURFACE COURSE, MIX "D", N90	TON	2999	2999		
44000155	HOT-MIX ASPHALT SURFACE REMOVAL, 1 1/2"	SO YD	35696	35696		
44201773	CLASS D PATCHES, TYPE I, 11 INCH	SO YD	5	5		
44201777	CLASS D PATCHES, TYPE II, 11 INCH	SO YD	354	354		
44201781	CLASS D PATCHES, TYPE III, 11 INCH	SO YD	71	71		
44201783	CLASS D PATCHES, TYPE IV, 11 INCH	SO YD	279	279		
67100100	MOBILIZATION	L SUM	1	1		
70300100	SHORT TERM PAVEMENT MARKING	FOOT	3120	3120		
70300220	TEMPORARY PAVEMENT MARKING - LINE 4"	FOOT	23602	23602		
70300250	TEMPORARY PAVEMENT MARKING - LINE 8"	FOOT	2085	2085		
70300260	TEMPORARY PAVEMENT MARKING - LINE 12"	FOOT	144	144		
70300280	TEMPORARY PAVEMENT MARKING - LINE 24"	FOOT	58	58		
70301000	WORK ZONE PAVEMENT MARKING REMOVAL	SO FT	347	347		

SUMMARY OF QUANTITIES			TOTAL QUANTITIES	CONSTRUCTION TYPE CODE		
CODE NO	ITEM	UNIT		0005		
* 78000200	THERMOPLASTIC PAVEMENT MARKING - LINE 4"	FOOT	23602	23602		
* 78000500	THERMOPLASTIC PAVEMENT MARKING - LINE 8"	FOOT	2085	2085		
* 78000600	THERMOPLASTIC PAVEMENT MARKING - LINE 12"	FOOT	144	144		
* 78000650	THERMOPLASTIC PAVEMENT MARKING - LINE 24"	FOOT	58	58		
* 78100100	RAISED REFLECTIVE PAVEMENT MARKER	EACH	127	127		
X4060110	BITUMINOUS MATERIALS (PRIME COAT)	POUND	16063	16063		
X7010216	TRAFFIC CONTROL AND PROTECTION, (SPECIAL)	L SUM	1	1		
X7015005	CHANGEABLE MESSAGE SIGN	CAL DA	42	42		
* X7830070	GROOVING FOR RECESSED PAVEMENT MARKING 5"	FOOT	23602	23602		
* X7830076	GROOVING FOR RECESSED PAVEMENT MARKING 9"	FOOT	2085	2085		
* X7830078	GROOVING FOR RECESSED PAVEMENT MARKING 13"	FOOT	144	144		
* X7830090	GROOVING FOR RECESSED PAVEMENT MARKING 25"	FOOT	58	58		

12 \* SPECIALTY ITEM

TYPICAL CROSS SECTION  
IL ROUTE 15 & US ROUTE 45

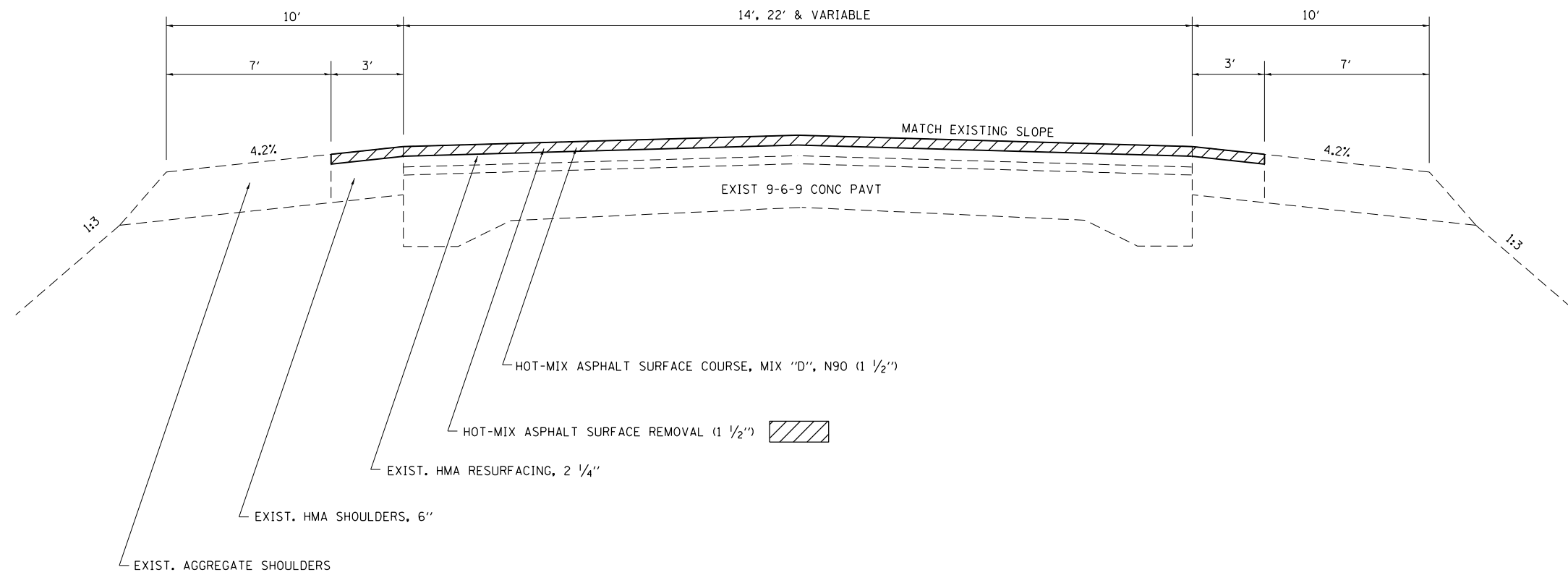

FILE NAME =	USER NAME = steffenmk	DESIGNED -	REVISED -
c:\pwork\pwork\stefjenmk\d0397316\074690-sh-typical.dgn		DRAWN -	REVISED -
Default	PLOT SCALE = 100.0000' / 1in.	CHECKED -	REVISED -
	PLOT DATE = 5/22/2014	DATE -	REVISED -

**STATE OF ILLINOIS**  
**DEPARTMENT OF TRANSPORTATION**

<b>TYPICAL CROSS SECTIONS</b>			
SCALE: N/A	SHEET 1	OF 1 SHEETS	STA. TO STA.

F.A.P. RTE.	SECTION	COUNTY	TOTAL SHEETS	SHEET NO.
328 821	D7 HMA RESURF 2015-9	WAYNE	12	4
<b>CONTRACT NO. 74690</b>				
ILLINOIS FED. AID PROJECT				

RESURFACING SCHEDULE

STATION TO STATION	LENGTH FOOT	HOT-MIX ASPHALT SURFACE REMOVAL, 1 1/2" SQ YD	BITUMINOUS MATERIALS (PRIME COAT) POUND	HOT-MIX ASPHALT SURFACE COURSE, MIX "D", N90 TON	TEMPORARY RAMP SQ YD
IL 15 EB					
81+67.00 TO 120+50.00	3883.0	14487.2	6519.3	1216.9	114.4
IL 15 WB					
81+50.00 TO 115+02.87	3352.9	10113.9	4551.3	849.6	71.1
US 45 & CURVE C					
97+92.42 TO 111+87.35	1394.9	4322.4	1945.1	363.1	77.8
CURVE F					
1+15.00 TO 9+77.00	862.0	1797.2	808.8	151.0	0.0
CURVE D					
3+78.53 TO 11+77.16	798.6	1552.6	698.7	130.4	43.3
CURVE B					
96+18.00 TO 106+12.19	994.2	3422.6	1540.2	287.5	27.8
TOTALS		35696.0	16063.0	2999.0	334.0

PATCHING SCHEDULE

	CLASS D PATCHES, TYPE I, 11 INCH	CLASS D PATCHES, TYPE II, 11 INCH	CLASS D PATCHES, TYPE III, 11 INCH	CLASS D PATCHES, TYPE IV, 11 INCH
	SQ YD	SQ YD	SQ YD	SQ YD
TOTALS	5.0	354.0	71.0	279.0

PAVEMENT MARKING SCHEDULE

STATION TO STATION	LENGTH	THERMOPLASTIC PAVEMENT MARKING • LINE 4" WHITE	THERMOPLASTIC PAVEMENT MARKING • LINE 4" YELLOW	THERMOPLASTIC PAVEMENT MARKING • LINE 8" WHITE	THERMOPLASTIC PAVEMENT MARKING • LINE 8" YELLOW	THERMOPLASTIC PAVEMENT MARKING • LINE 12" WHITE	THERMOPLASTIC PAVEMENT MARKING • LINE 12" YELLOW	THERMOPLASTIC PAVEMENT MARKING • LINE 24" WHITE	GROOVING FOR RECESSED PAVEMENT MARKING 5'	GROOVING FOR RECESSED PAVEMENT MARKING 9'	GROOVING FOR RECESSED PAVEMENT MARKING 13'	GROOVING FOR RECESSED PAVEMENT MARKING 25'	SHORT-TERM PAVEMENT MARKING	WORK ZONE PAVEMENT MARKING REMOVAL	RAISED REFLECTIVE PAVEMENT MARKER
	FOOT	FOOT	FOOT	FOOT	FOOT	FOOT	FOOT	FOOT	FOOT	FOOT	FOOT	FOOT	FOOT	SO FT	EACH
IL 15 EB															
81+67.00 TO 120+50.00	3883.0	5378.8	3518.0	245.0	130.0	26.3	16.4	0.0	8896.8	375.0	42.7	0.0	1152.0	128.0	49.0
IL 15 WB															
81+50.00 TO 115+00.00	3350.0	3616.3	3305.0	365.0	130.0	71.6	0.0	22.0	6921.3	495.0	71.6	22.0	1008.0	112.0	41.0
US 45 & CURVE C															
97+92.42 TO 111+87.35	1394.9	1787.9	1318.0	230.0	110.0	6.6	13.1	22.0	3105.9	340.0	19.7	22.0	420.0	46.7	17.0
CURVE F															
2+00.00 TO 10+43.21	843.2	1054.0	530.0	313.2	0.0	0.0	0.0	0.0	1584.0	313.2	0.0	0.0	252.0	28.0	10.0
CURVE D															
3+78.53 TO 11+77.16	798.6	544.0	773.6	229.6	0.0	0.0	0.0	14.0	1317.6	229.6	0.0	14.0	0.0	0.0	0.0
CURVE B															
96+75.00 TO 106+12.19	937.2	1171.5	605.0	215.0	117.2	9.7	0.0	0.0	1776.5	332.2	9.7	0.0	288.0	32.0	10.0
TOTALS		13552.0	10050.0	1598.0	487.0	114.0	30.0	58.0	23602.0	2085.0	144.0	58.0	3120.0	347.0	127.0

FILE NAME =	USER NAME = steffenmk	DESIGNED -	REVISED -
ci:\pw\work\p\dot\stefjenmk\d0397316\074690-sh-t-sch.dgn		DRAWN -	REVISED -
Default	PLOT SCALE = 100.0000' / in.	CHECKED -	REVISED -
	PLOT DATE = 5/22/2014	DATE -	REVISED -

STATE OF ILLINOIS  
DEPARTMENT OF TRANSPORTATION

SCHEDULE OF QUANTITIES

SCALE: N/A SHEET 2 OF 2 SHEETS STA. TO STA.

F.A.P. RTE.	SECTION	COUNTY	TOTAL SHEETS	SHEET NO.
328 821	D7 HMA RESURF 2015-9	WAYNE	12	6
CONTRACT NO. 74690			ILLINOIS FED. AID PROJECT	

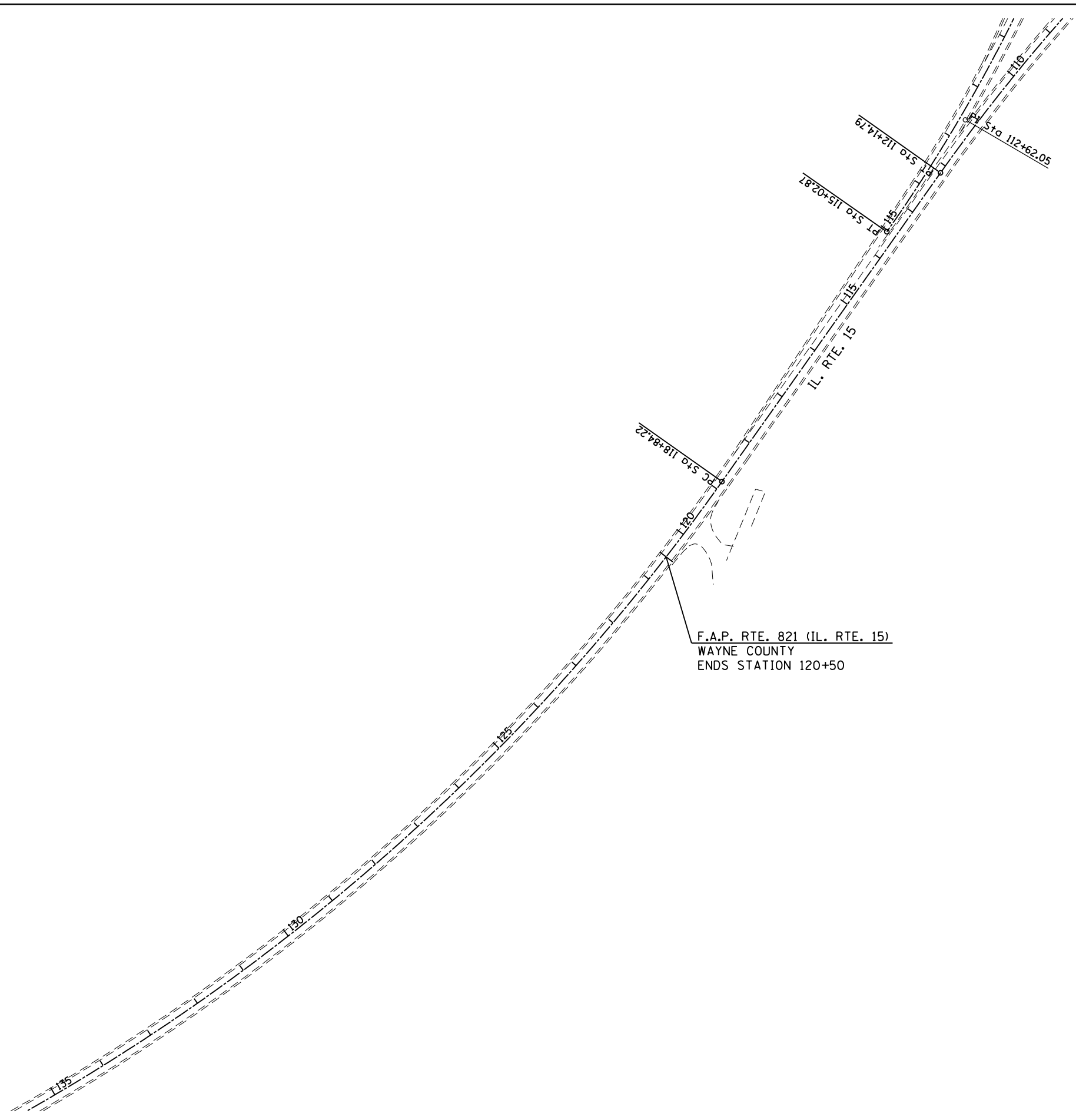

F.A.P. RTE. 821 (IL. RTE. 15)  
 WAYNE COUNTY  
 ENDS STATION 120+50

FILE NAME = c:\pw\work\p\dot\stef\enmk\d0397316\07	USER NAME = stef\enmk	DESIGNED -	REVISED -
	74690-sh-t-plan.dgn	DRAWN -	REVISED -
Default	PLOT SCALE = 200.0000' / in.	CHECKED -	REVISED -
	PLOT DATE = 5/22/2014	DATE -	REVISED -

**STATE OF ILLINOIS  
 DEPARTMENT OF TRANSPORTATION**

<b>PLAN</b>			
SCALE: 100	SHEET 1	OF 2 SHEETS	STA. TO STA.

F.A.P. RTE. 328 821	SECTION D7 HMA RESURF 2015-9	COUNTY WAYNE	TOTAL SHEETS 12	SHEET NO. 7
<b>CONTRACT NO. 74690</b>				
ILLINOIS FED. AID PROJECT				

F.A.P. RTE. 328 (U.S. RTE. 45)  
WAYNE COUNTY  
ENDS STATION 111+87.35

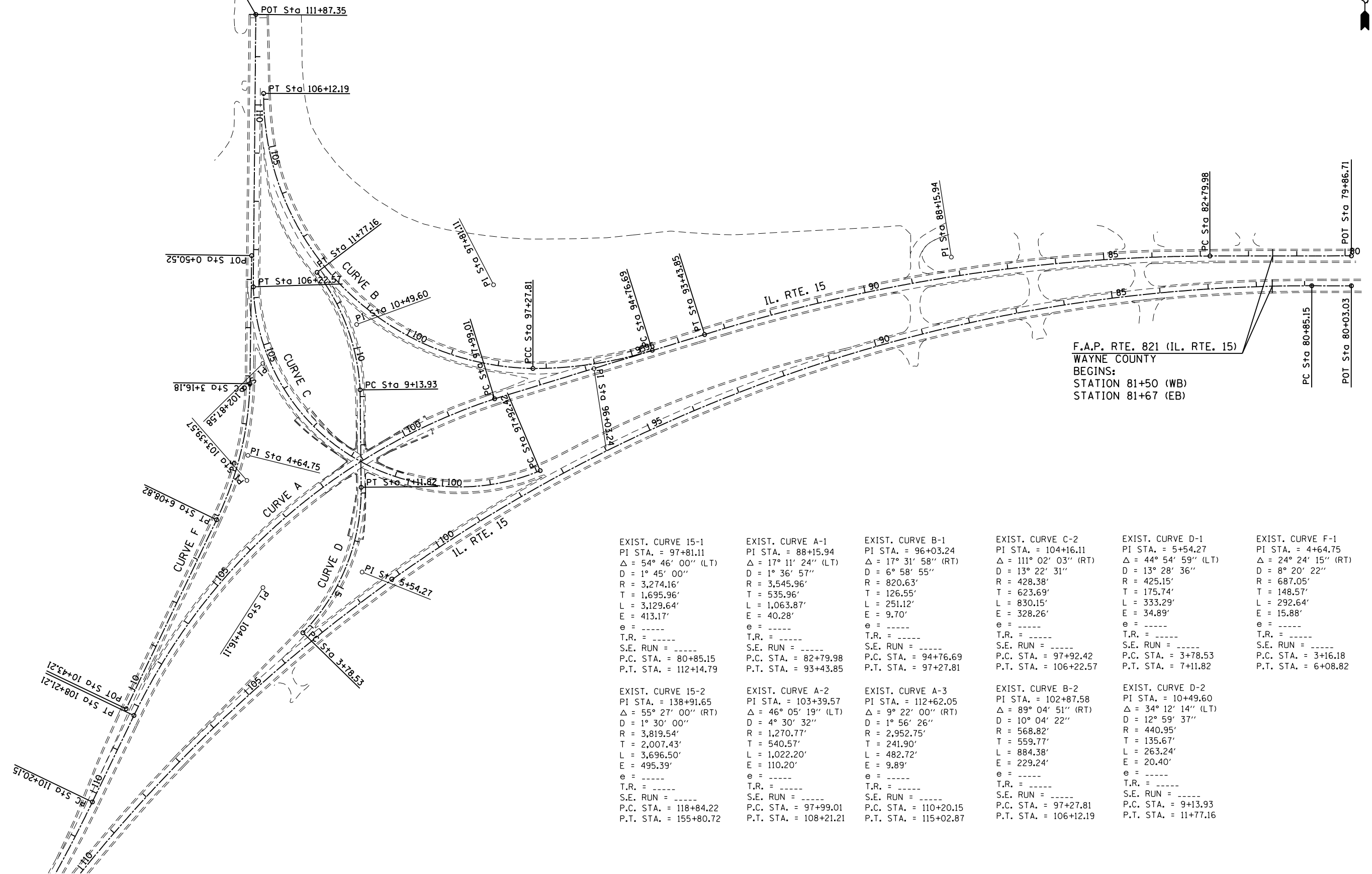
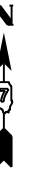

<p>EXIST. CURVE 15-1 PI STA. = 97+81.11 <math>\Delta = 54^\circ 46' 00''</math> (LT) D = 1° 45' 00" R = 3,274.16' T = 1,695.96' L = 3,129.64' E = 413.17' e = ----- T.R. = ----- S.E. RUN = ----- P.C. STA. = 80+85.15 P.T. STA. = 112+14.79</p>	<p>EXIST. CURVE A-1 PI STA. = 88+15.94 <math>\Delta = 17^\circ 11' 24''</math> (LT) D = 1° 36' 57" R = 3,545.96' T = 535.96' L = 1,063.87' E = 40.28' e = ----- T.R. = ----- S.E. RUN = ----- P.C. STA. = 82+79.98 P.T. STA. = 93+43.85</p>	<p>EXIST. CURVE B-1 PI STA. = 96+03.24 <math>\Delta = 17^\circ 31' 58''</math> (RT) D = 6° 58' 55" R = 820.63' T = 126.55' L = 251.12' E = 9.70' e = ----- T.R. = ----- S.E. RUN = ----- P.C. STA. = 94+76.69 P.T. STA. = 97+27.81</p>	<p>EXIST. CURVE C-2 PI STA. = 104+16.11 <math>\Delta = 111^\circ 02' 03''</math> (RT) D = 13° 22' 31" R = 428.38' T = 623.69' L = 830.15' E = 328.26' e = ----- T.R. = ----- S.E. RUN = ----- P.C. STA. = 97+92.42 P.T. STA. = 106+22.57</p>	<p>EXIST. CURVE D-1 PI STA. = 5+54.27 <math>\Delta = 44^\circ 54' 59''</math> (LT) D = 13° 28' 36" R = 425.15' T = 175.74' L = 333.29' E = 34.89' e = ----- T.R. = ----- S.E. RUN = ----- P.C. STA. = 3+78.53 P.T. STA. = 7+11.82</p>	<p>EXIST. CURVE F-1 PI STA. = 4+64.75 <math>\Delta = 24^\circ 24' 15''</math> (RT) D = 8° 20' 22" R = 687.05' T = 148.57' L = 292.64' E = 15.88' e = ----- T.R. = ----- S.E. RUN = ----- P.C. STA. = 3+16.18 P.T. STA. = 6+08.82</p>
<p>EXIST. CURVE 15-2 PI STA. = 138+91.65 <math>\Delta = 55^\circ 27' 00''</math> (RT) D = 1° 30' 00" R = 3,819.54' T = 2,007.43' L = 3,696.50' E = 495.39' e = ----- T.R. = ----- S.E. RUN = ----- P.C. STA. = 118+84.22 P.T. STA. = 155+80.72</p>	<p>EXIST. CURVE A-2 PI STA. = 103+39.57 <math>\Delta = 46^\circ 05' 19''</math> (LT) D = 4° 30' 32" R = 1,270.77' T = 540.57' L = 1,022.20' E = 110.20' e = ----- T.R. = ----- S.E. RUN = ----- P.C. STA. = 97+99.01 P.T. STA. = 108+21.21</p>	<p>EXIST. CURVE A-3 PI STA. = 112+62.05 <math>\Delta = 9^\circ 22' 00''</math> (RT) D = 1° 56' 26" R = 2,952.75' T = 241.90' L = 482.72' E = 9.89' e = ----- T.R. = ----- S.E. RUN = ----- P.C. STA. = 110+20.15 P.T. STA. = 115+02.87</p>	<p>EXIST. CURVE B-2 PI STA. = 102+87.58 <math>\Delta = 89^\circ 04' 51''</math> (RT) D = 10° 04' 22" R = 568.82' T = 559.77' L = 884.38' E = 229.24' e = ----- T.R. = ----- S.E. RUN = ----- P.C. STA. = 97+27.81 P.T. STA. = 106+12.19</p>	<p>EXIST. CURVE D-2 PI STA. = 10+49.60 <math>\Delta = 34^\circ 12' 14''</math> (LT) D = 12° 59' 37" R = 440.95' T = 135.67' L = 263.24' E = 20.40' e = ----- T.R. = ----- S.E. RUN = ----- P.C. STA. = 9+13.93 P.T. STA. = 11+77.16</p>	

FILE NAME =	USER NAME = steffenmk	DESIGNED -	REVISED -	<b>STATE OF ILLINOIS DEPARTMENT OF TRANSPORTATION</b>	<b>PLAN</b>		F.A.P. RTE.	SECTION	COUNTY	TOTAL SHEETS	SHEET NO.
Default	74690-sh1-pln.dgn	DRAWN -	REVISED -		SCALE: 100	SHEET 2 OF 2 SHEETS	STA.	D7 HMA RESURF 2015-9	WAYNE	12	8
	PLOT SCALE = 200.0000' / in.	CHECKED -	REVISED -				TO STA.	CONTRACT NO. 74690			
	PLOT DATE = 5/22/2014	DATE -	REVISED -		ILLINOIS FED. AID PROJECT						



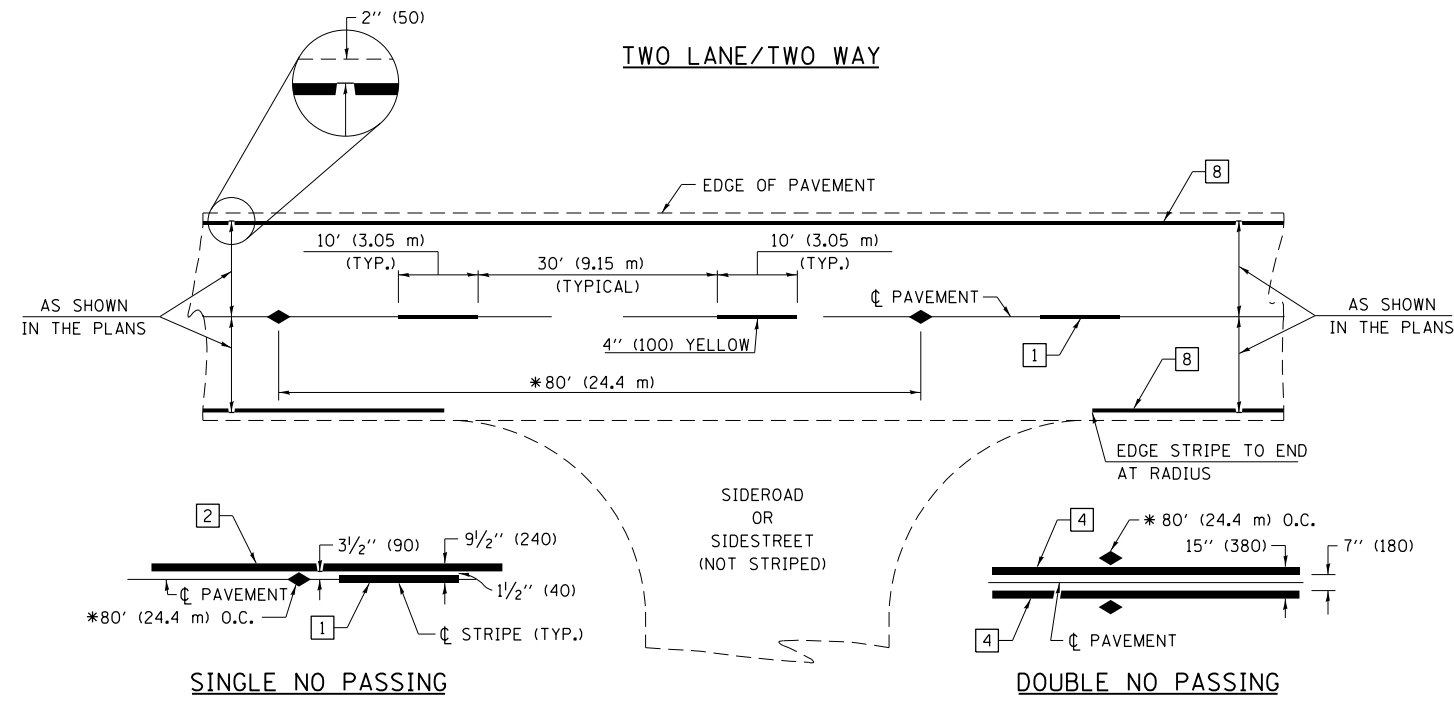

\* REDUCE TO 40' (12.2 m) O.C. ON CURVES WITH POSTED OR ADVISORY SPEEDS OF 45 mph (70 km/h) OR LESS.

**PAVEMENT MARKING LEGEND**

- 1 4" (100) SKIP-DASH (YELLOW)
  - 2 4" (100) SOLID (YELLOW)
  - 3 12" (300) DIAGONAL (YELLOW)
  - 4 4" (100) DOUBLE YELLOW (NARROW)
  - 5 12" (300) SOLID WHITE
  - 6 RESERVED
  - 7 6" (150) SKIP-DASH (WHITE)
  - 8 4" (100) SOLID (WHITE)
  - 9 12" (300) DIAGONAL (WHITE)
  - 10 6" (150) SOLID (WHITE)
  - 11 24" (600) STOP BAR (WHITE)
  - 12 8" (200) SOLID (WHITE)
  - 13 4" (100) PARKING WHITE
- 

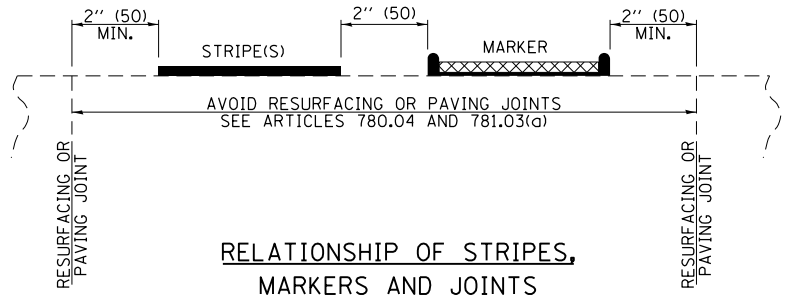

**TYPICAL PAVEMENT MARKERS LEGEND**

- ◆ TWO-WAY AMBER MARKER
- ▶ ONE-WAY AMBER MARKER
- ▷ ONE-WAY CRYSTAL MARKER

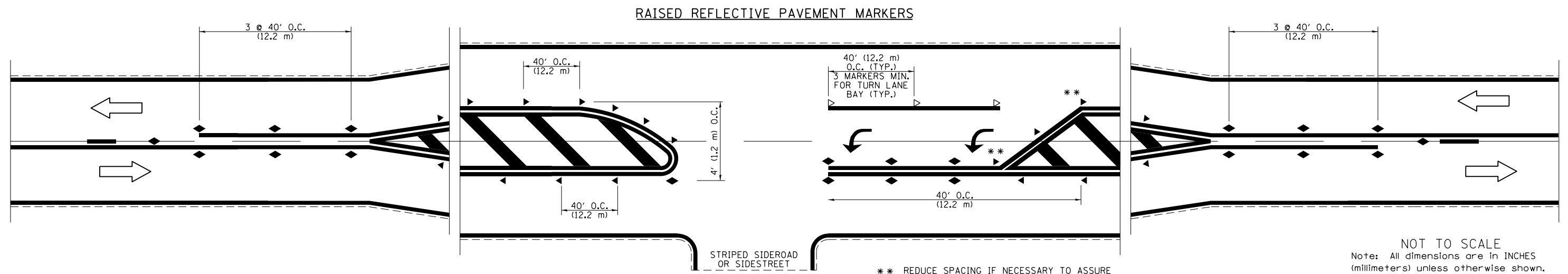

\*\* REDUCE SPACING IF NECESSARY TO ASSURE MARKERS AT CORNER POINTS.

NOT TO SCALE  
Note: All dimensions are in INCHES (millimeters) unless otherwise shown.

FILE NAME =	USER NAME = steffenmk	DESIGNED -	REVISED -
ci:\pw\work\p\d03\steffenmk\d0397316\074690-sh1-details.dgn		DRAWN -	REVISED -
		CHECKED -	REVISED -
		DATE -	REVISED -

**STATE OF ILLINOIS  
DEPARTMENT OF TRANSPORTATION**

**PAVEMENT MARKING AND RAISED REFLECTIVE PAVEMENT MARKERS  
(RURAL & URBAN APPLICATIONS)**

SCALE: N/A SHEET NO. 1 OF 4 SHEETS STA. TO STA.

<b>DISTRICT 7 DETAIL NO. 78000001</b>				
F.A.P. RTE.	SECTION	COUNTY	TOTAL SHEETS	SHEET NO.
328 821	D7 HMA RESURF 2015-9	WAYNE	12	9
CONTRACT NO. 74690				
ILLINOIS FED. AID PROJECT				

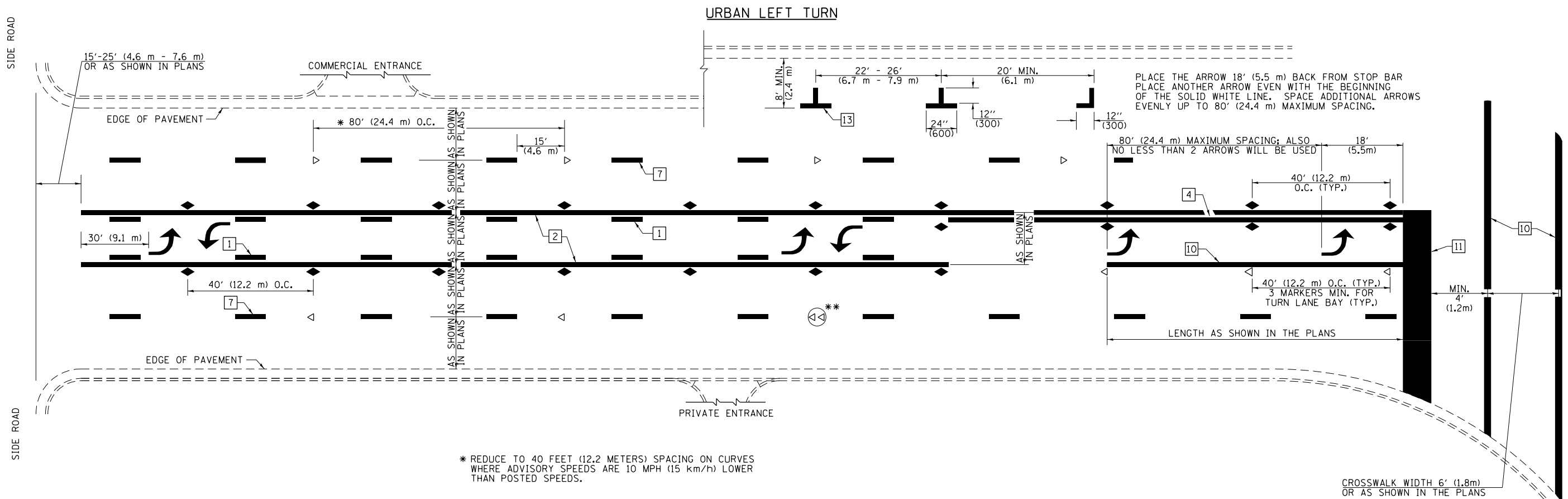

\* REDUCE TO 40 FEET (12.2 METERS) SPACING ON CURVES WHERE ADVISORY SPEEDS ARE 10 MPH (15 km/h) LOWER THAN POSTED SPEEDS.

\*\* DOUBLE LANE LINE MARKERS SHALL BE SPECIFIED AND SPACED AS SHOWN IN HIGHWAY STANDARD 781001 FOR MULTI-LANE DIVIDED AND UNDIVIDED HIGHWAYS.

**PAVEMENT MARKING LEGEND**

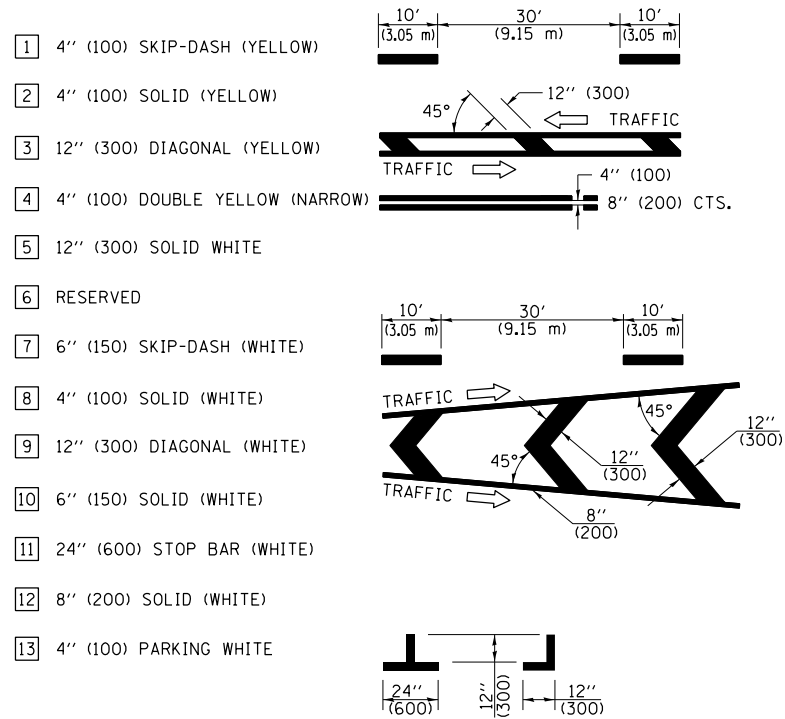

**GENERAL NOTES**

- TURN ARROW PAIRS SHALL BE PLACED AT 250' (75 m) INTERVALS AND SHALL BE EVENLY SPACED BETWEEN BOTH ENDS OF THE BIDIRECTIONAL LEFT TURN LANE. USE A MINIMUM OF TWO PAIRS PER BLOCK.
- THE SOLID YELLOW PAVEMENT MARKINGS [2] SHOULD GENERALLY START OR END NEAR THE RADIUS POINT OF EACH STREET RETURN EXCEPT WHERE ONE OR BOTH ENDS WOULD INCLUDE STOP BARS.
- THE SKIP-DASH PAVEMENT MARKINGS [1] OR [7] SHOULD BE CENTERED BETWEEN BOTH ENDS OF EACH CITY BLOCK AND SHALL BE PLACED SO THEY LINE UP ACROSS FROM EACH OTHER.
- USE LARGE ARROW SIZE FOR BOTH RURAL AND URBAN LOCATIONS. (SEE LAST PAGE OF SECTION 780x FOR SYMBOLS TABLE)
- LANE LINE EXTENSIONS SHALL BE THE SAME COLOR AND WIDTH AS THE LANE LINE BEING EXTENDED.

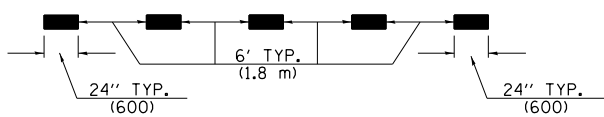

**LANE LINE EXTENSIONS**

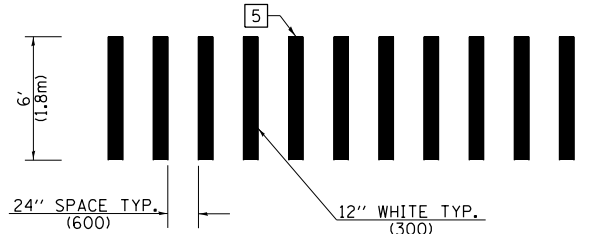

**CROSSWALK DETAIL (DECATUR CITY LIMITS ONLY)**

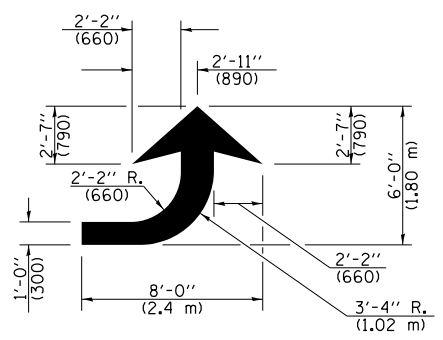

**LEFT ARROW**

REVERSE FOR RIGHT ARROW  
AREA = 15.6 SQ. FT. (1.47 m<sup>2</sup>)  
(WHITE)

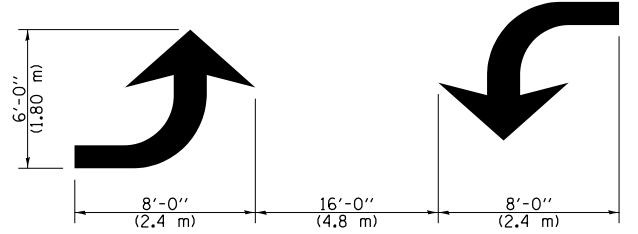

**TYPICAL DOUBLE TURN ARROWS (WHITE)**

NOT TO SCALE  
Note: All dimensions are in INCHES (millimeters) unless otherwise shown.

FILE NAME =	USER NAME = steffenmk	DESIGNED -	REVISED -	<b>STATE OF ILLINOIS DEPARTMENT OF TRANSPORTATION</b>	<b>PAVEMENT MARKING AND RAISED REFLECTIVE PAVEMENT MARKERS (RURAL &amp; URBAN APPLICATIONS)</b>		F.A.P. RTE.	SECTION	COUNTY	TOTAL SHEETS	SHEET NO.		
ci:\pw\work\p\idot\steffenmk\d0397316\074690-sh1-details.dgn	PLOT SCALE = 100.0000' / in.	DRAWN -	REVISED -				328	D7 HMA RESURF 2015-9	WAYNE	12	10		
	PLOT DATE = 5/22/2014	CHECKED -	REVISED -				CONTRACT NO. 74690						
		DATE -	REVISED -				ILLINOIS FED. AID PROJECT						

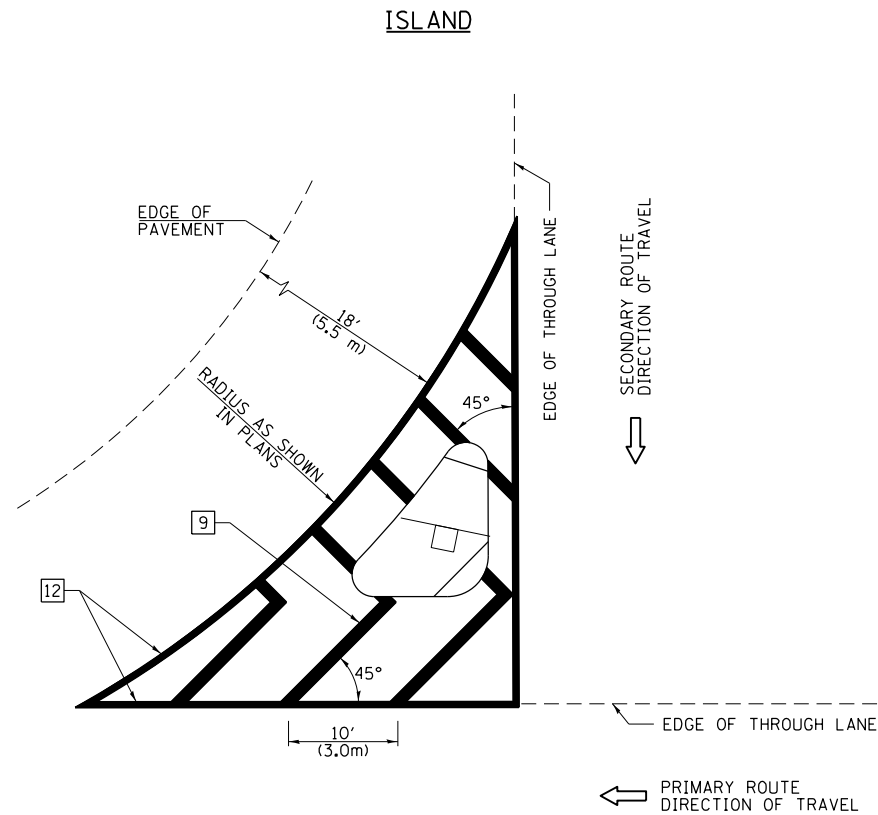

**GENERAL NOTES**

1. RAISED AND CORRUGATED MEDIANS SHALL BE OUTLINED WITH [2] IF PRESENT.
2. SOME OF THE INFORMATION INCLUDED WITH THIS DETAIL MAY NOT BE APPLICABLE TO THIS IMPROVEMENT.
3. PAVEMENT MARKINGS ARE TO BE EXTENDED THROUGH OMISSIONS WHEN APPLICABLE.
4. FINAL PAVEMENT MARKINGS SHALL BE IN PLACE PRIOR TO PLACING ANY RAISED REFLECTIVE PAVEMENT MARKERS.
5. THE FOLLOWING CRITERIA SHALL BE USED FOR SELECTING THE DIAGONAL PAVEMENT MARKING SPACING:

< 30 MPH (< 50 km/h)	15' (4.5 m)
30-45 MPH (50-75 km/h)	20' (6.0 m)
> 45 MPH (> 75 km/h)	30' (9.0 m)

**PAVEMENT MARKING LEGEND**

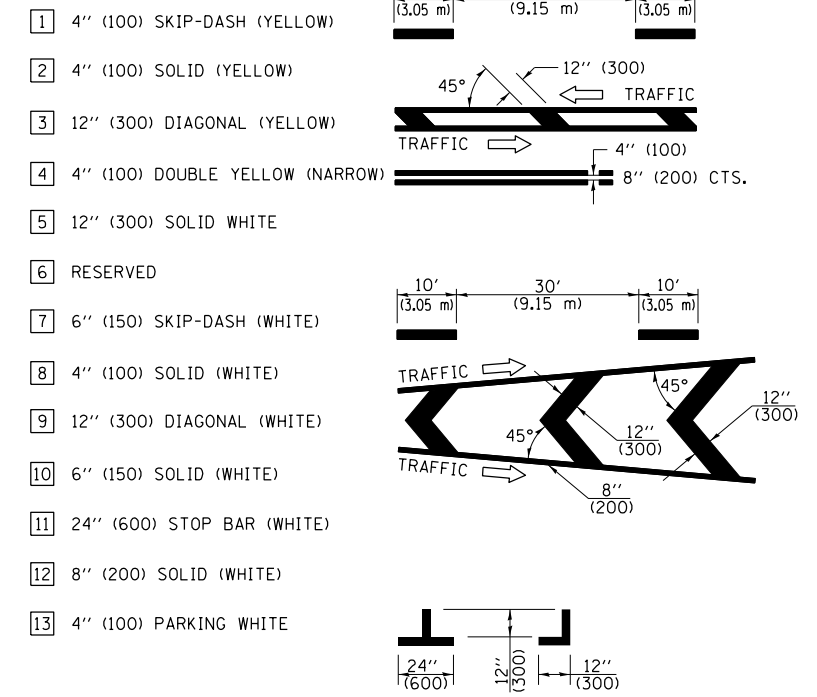

**RURAL LEFT TURN STRIPING**

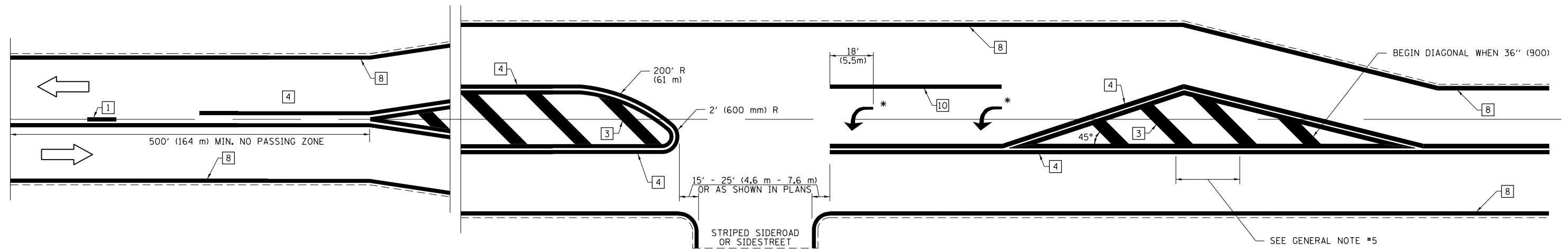

\* PLACE AN ARROW 18' (5.5 m) BACK FROM STOP BAR. PLACE ANOTHER ARROW EVEN WITH THE BEGINNING OF THE SOLID WHITE LINE. SPACE ADDITIONAL ARROWS EVENLY UP TO 80' (24.4 m) MAXIMUM SPACING. USE MINIMUM OF 2 ARROWS.

NOT TO SCALE  
Note: All dimensions are in INCHES (millimeters) unless otherwise shown.

**DISTRICT 7 DETAIL NO. 7800001**

FILE NAME =	USER NAME = steffenmk	DESIGNED -	REVISED -
ci:\pw\work\p\id\dot\stef\enmk\d0397316\074690-sh\details.dgn		DRAWN -	REVISED -
	PLOT SCALE = 100.0000' / 1in.	CHECKED -	REVISED -
	PLOT DATE = 5/22/2014	DATE -	REVISED -

**STATE OF ILLINOIS  
DEPARTMENT OF TRANSPORTATION**

**PAVEMENT MARKING AND RAISED REFLECTIVE PAVEMENT MARKERS  
(RURAL & URBAN APPLICATIONS)**

SCALE: N/A SHEET NO. 3 OF 4 SHEETS STA. TO STA.

F.A.P. RTE.	SECTION	COUNTY	TOTAL SHEETS	SHEET NO.
328 821	D7 HMA RESURF 2015-9	WAYNE	12	11
CONTRACT NO. 74690				
ILLINOIS FED. AID PROJECT				

PAVEMENT MARKINGS AT RAILROAD-HIGHWAY GRADE CROSSING

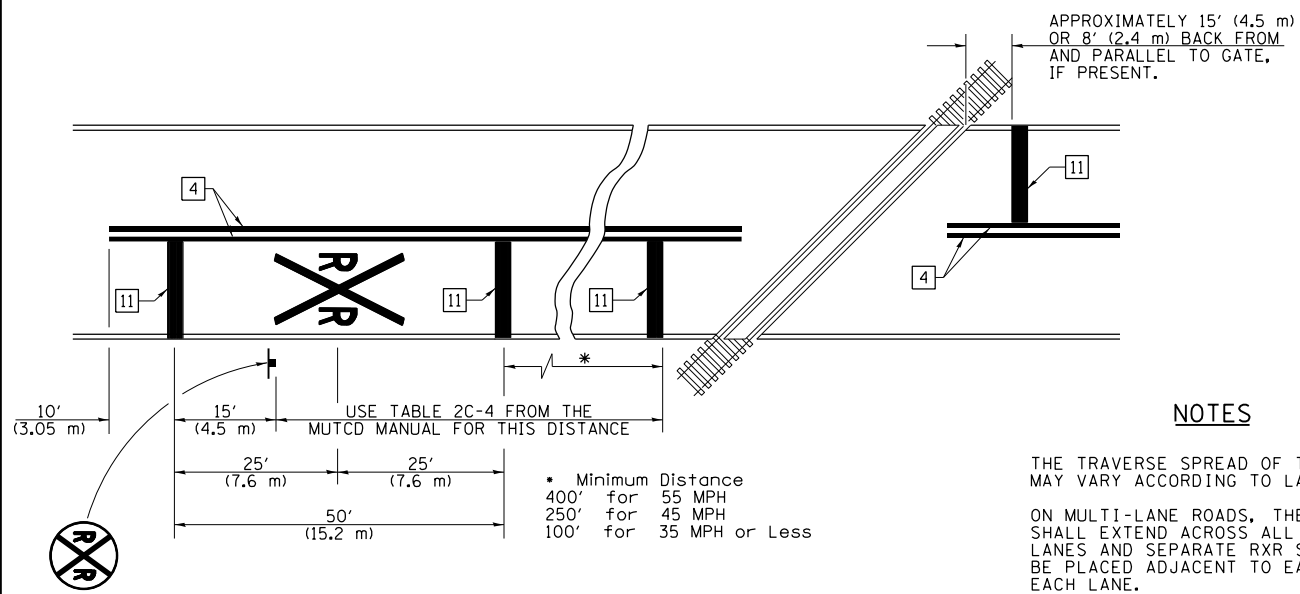

NOTES

THE TRAVERSE SPREAD OF THE "X" MAY VARY ACCORDING TO LANE WIDTH.

ON MULTI-LANE ROADS, THE STOP LINES SHALL EXTEND ACROSS ALL APPROACH LANES AND SEPARATE RXR SYMBOLS SHALL BE PLACED ADJACENT TO EACH OTHER IN EACH LANE.

WHEN THE PAVEMENT MARKING SYMBOL IS USED, A PORTION OF THE SYMBOL SHOULD BE LOCATED DIRECTLY ADJACENT TO THE ADVANCE WARNING SIGN (W10-1) AS PLACED BY TABLE II-1, CONDITION B OF THE MUTCD.

PAVEMENT MARKING LEGEND

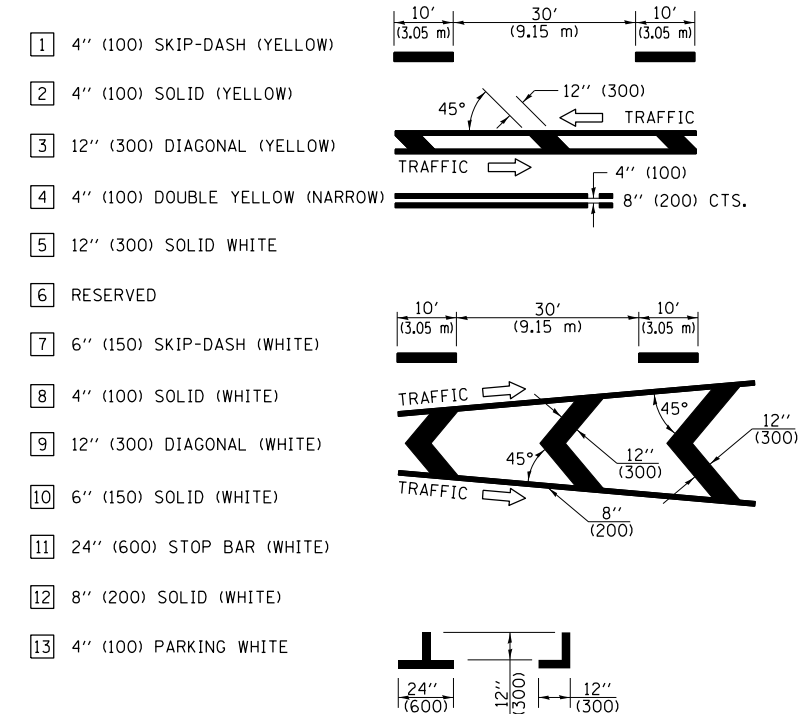

RAILROAD CROSSING WITH INTERCONNECT ONLY

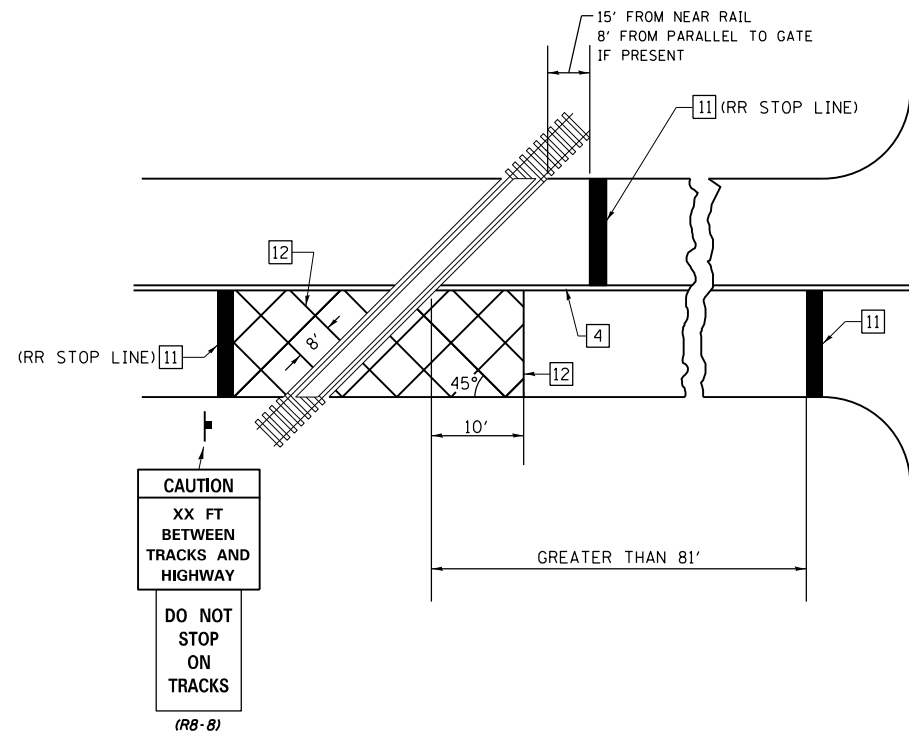

RAILROAD CROSSING WITH INTERCONNECT AND PRE-SIGNALS

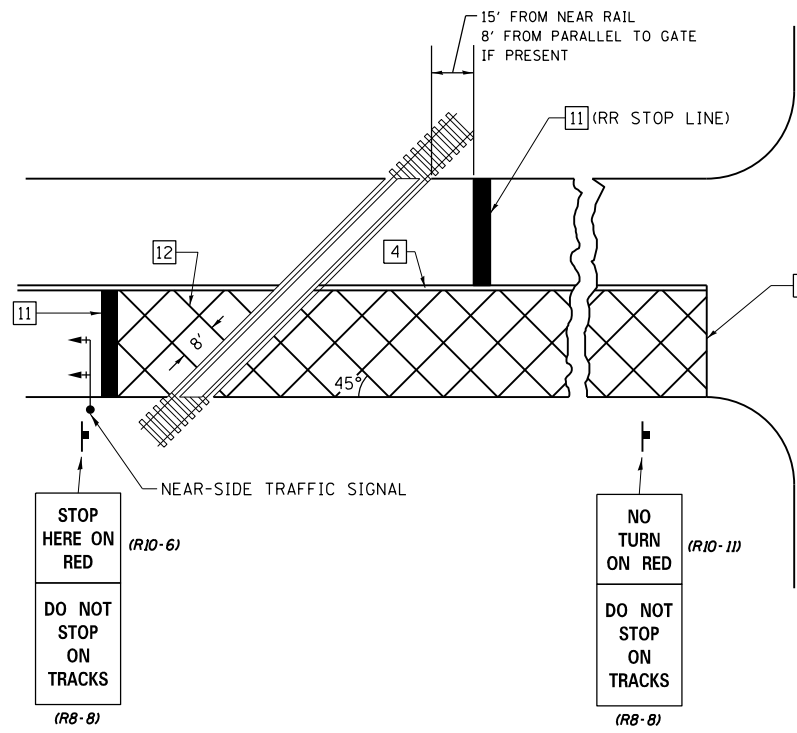

GENERAL NOTES

- SUPPLEMENTAL PAVEMENT MARKINGS TO BE INSTALLED ONLY ON APPROACHES TO INTERSECTIONS CONTROLLED BY TRAFFIC SIGNALS WHICH ARE INTERCONNECTED WITH THE RAILROAD WARNING SIGNALS.
- EXTEND PAVEMENT MARKINGS TO THE INTERSECTION ONLY WHERE NEAR-SIDE TRAFFIC SIGNALS ARE USED.

SUPPLEMENTAL PAVEMENT MARKING TREATMENT FOR RAILROAD-HIGHWAY GRADE CROSSING

NOT TO SCALE  
Note: All dimensions are in INCHES (millimeters) unless otherwise shown.

DISTRICT 7 DETAIL NO. 78000001

FILE NAME =	USER NAME = steffenmk	DESIGNED -	REVISED -	<b>STATE OF ILLINOIS DEPARTMENT OF TRANSPORTATION</b>	<b>PAVEMENT MARKING AND RAISED REFLECTIVE PAVEMENT MARKERS (RURAL &amp; URBAN APPLICATIONS)</b>	F.A.P. RTE.	SECTION	COUNTY	TOTAL SHEETS	SHEET NO.	
c:\pwork\pwork\stevfenmk\d0397316\074690-sh1-details.dgn	74690-sh1-details.dgn	DRAWN -	REVISED -			328	D7 HMA RESURF 2015-9	WAYNE	12	12	
PLOT SCALE = 100.0000' / 1in.		CHECKED -	REVISED -			CONTRACT NO. 74690					
PLOT DATE = 5/22/2014		DATE -	REVISED -			ILLINOIS FED. AID PROJECT					

SCALE: N/A SHEET NO. 4 OF 4 SHEETS STA. TO STA.