

18-2010MA-4430.0  
13-1-21-31-00-000-009.001

PIPE CULVERTS, CLASS A, TYPE 1 EQUIVALENT ROUND - SIZE 36"

ID	STATION	OFFSET	FLOWLINE
①	349+34.12	54.40 LT	418.35
②	349+69.12	54.40 LT	418.46
③	352+46.02	53.20 LT	419.31
④	352+83.02	53.20 LT	419.43

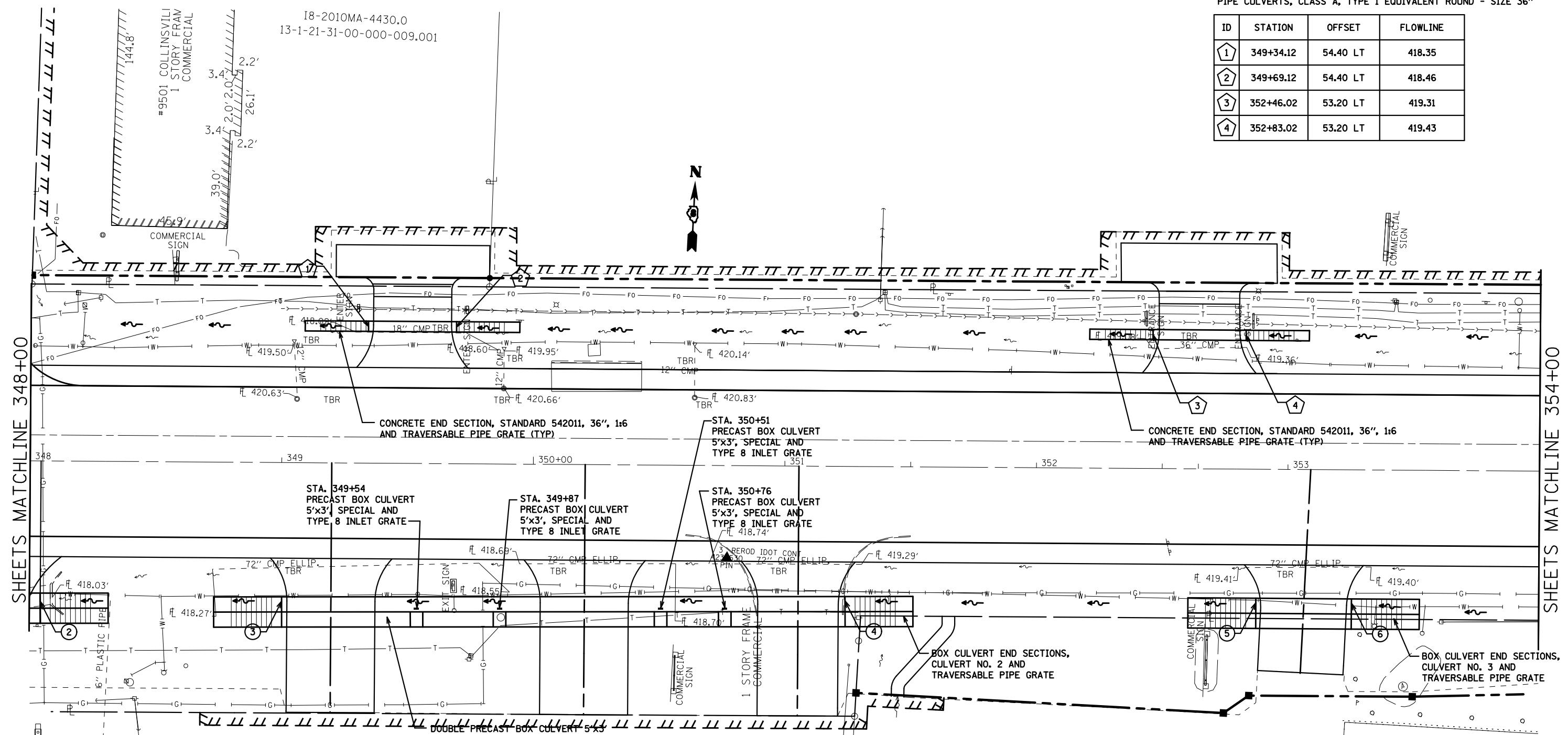

SHEETS MATCHLINE 348+00

SHEETS MATCHLINE 354+00

ASTM C 1577 DOUBLE PRECAST BOX CULVERTS, 5'x3'

ID	STATION	OFFSET	SKEW	DESIGN FILL	FLOWLINE	PGE
②	348+04.36	59.14 RT	0°	1.5'	418.09	X
③	349+00.28	58.92 RT	0°	1.0'	418.43	333.7
④	351+24.27	57.92 RT	0°	0.5'	419.23	X
⑤	352+87.58	57.30 RT	2° 34'	1.1'	419.82	85.7
⑥	353+25.58	57.28 RT	2° 34'	1.1'	419.96	100.3

THE PGE SHOWN IN THE CHART IS AN APPROXIMATION OF THE QUANTITY THAT WILL BE REQUIRED FOR THE PAY ITEMS END SECTIONS, BOX CULVERTS AND BOX CULVERTS, SPECIAL. THIS IS NOT TO BE PAID FOR SEPERATELY BUT IS INCLUDED IN THE COST OF THE ASSOCIATED PAY ITEMS.

\_\_\_\_\_ EXISTING ROW  
 - - - - - PROPOSED ROW  
 // // // // // TEMPORARY EASEMENT