

STATE OF ILLINOIS
DEPARTMENT OF TRANSPORTATION
DIVISION OF HIGHWAYS
**PROPOSED
HIGHWAY PLANS**

| | | | | |
|-------------|-----------|----------|--------------------|-----------|
| F.A.P. RTE. | SECTION | COUNTY | TOTAL SHEETS | SHEET NO. |
| 805 | 126-1RS-3 | CLINTON | 16 | 1 |
| | | ILLINOIS | CONTRACT NO. 76G30 | |

FOR INDEX OF SHEETS, SEE SHEET NO. 2

TRAFFIC DATA

| | |
|----------|---------------------|
| IL 161 | |
| 2011 ADT | = 5,100 (ACTUAL) |
| 2015 ADT | = 5,300 (ESTIMATED) |
| 2035 ADT | = 6,500 (ESTIMATED) |
| SU | = 2.9% |
| MU | = 3.5% |

FAP ROUTE 805 (IL 161)
SECTION 126-1RS-3
PROJECT: ACF-0805 (076)
RESURFACING-3P
CLINTON COUNTY

C-98-032-13



END PROJECT
STA. 1141+14
LONG: -89.61946
LAT: 38.54323

PROJECT OMISSION—
S.N. 014-0078
STA. 1116+98.5 TO STA. 1121+11.5

STATION EQUATION
STA. 1106+92 (BACK) =
STA. 1104+28.9 (AHEAD)

BEGIN PROJECT
STA. 941+10
LONG: -89.68770
LAT: 38.53519

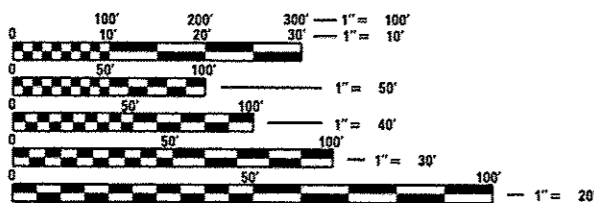
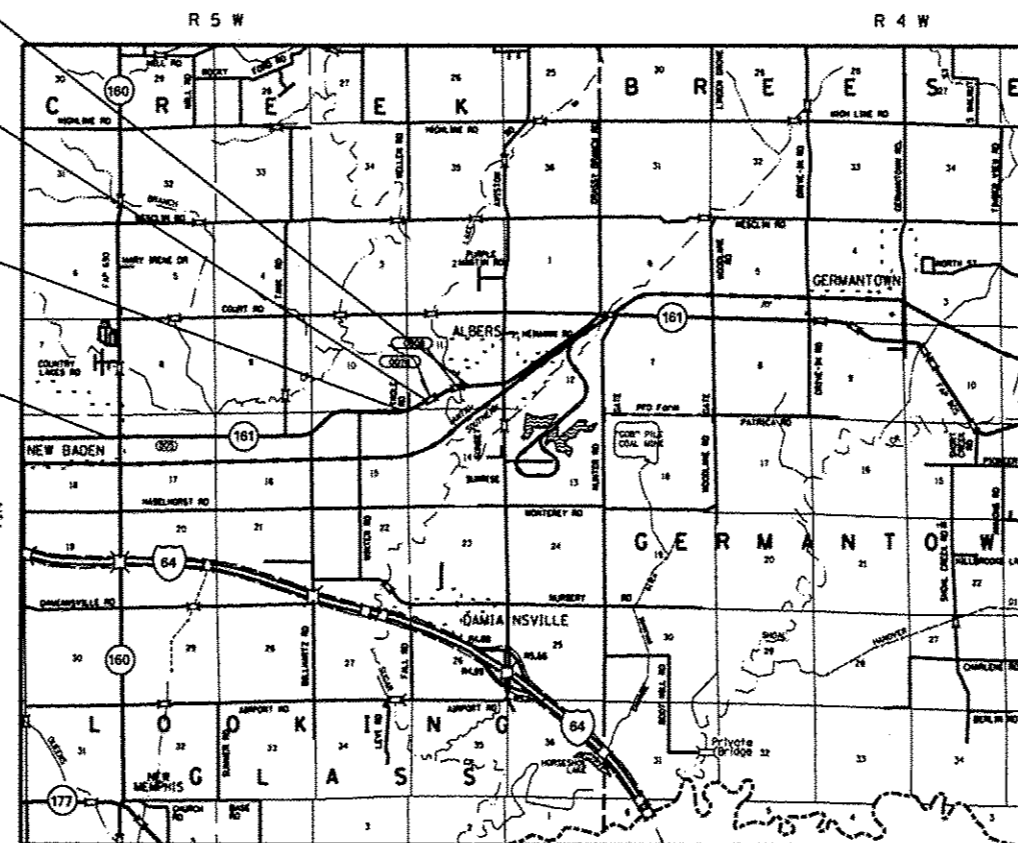

FULL SIZE PLANS HAVE BEEN PREPARED USING STANDARD ENGINEERING SCALES. REDUCED SIZED PLANS WILL NOT CONFORM TO STANDARD SCALES. IN MAKING MEASUREMENTS ON REDUCED PLANS, THE ABOVE SCALES MAY BE USED.

J.U.L.I.E.
JOINT UTILITY LOCATION INFORMATION FOR EXCAVATION
1-800-892-0123
OR 811

PROJECT ENGINEER: PATTI LeBEAU (618) 346-3179
PROJECT MANAGER: REBECCA THARP (618) 346-3323

CONTRACT NO. 76G30

DESIGN DESIGNATION
N/A

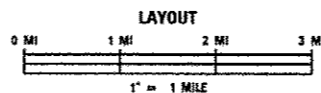

GROSS LENGTH = 20,267 FT. = 3.838 MILES
NET LENGTH = 19,854 FT. = 3.760 MILES

STATE OF ILLINOIS
DEPARTMENT OF TRANSPORTATION
DIVISION OF HIGHWAYS

SUBMITTED *May 6 20 14*
John D. Baranzelli, PE
DEPUTY DIRECTOR OF HIGHWAYS, REGION 5 ENGINEER

June 27 20 14
John D. Baranzelli, PE
acting ENGINEER OF DESIGN AND ENVIRONMENT

June 27 20 14
Omer Osman, PE
DIRECTOR OF HIGHWAYS, CHIEF ENGINEER

**PRINTED BY THE AUTHORITY
OF THE STATE OF ILLINOIS**