

NOTE: ALT A & ALT B OPTION BEGINS AT STATION 449+88.13 AND CONTINUES TO THE END OF THE PROJECT.

LINUS & MARY A. KIEFER

PEGGY L. SISCO

DATE	
BY	
SURVEYED	
PLOTTED	
ALIGNED	
CHECKED	
NO. _____	
NOTE BOOK	
NO. _____	
CADD FILE NAME	

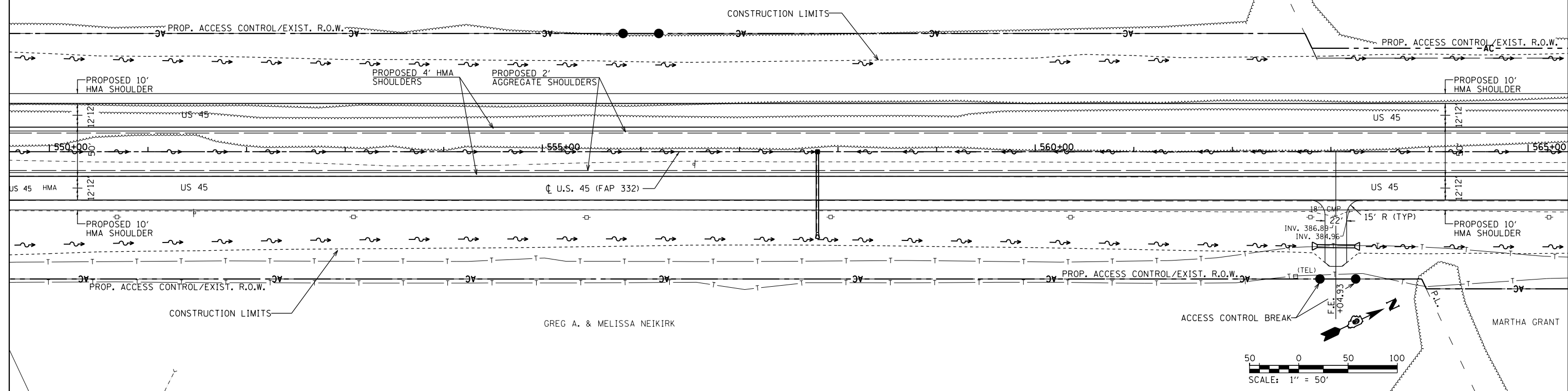

DATE	
BY	
SURVEYED	
PLOTTED	
GRADES CHECKED	
STRUCTURE	
NO. _____	
NOTE BOOK	
NO. _____	
NOT AT THIS OFFICE	

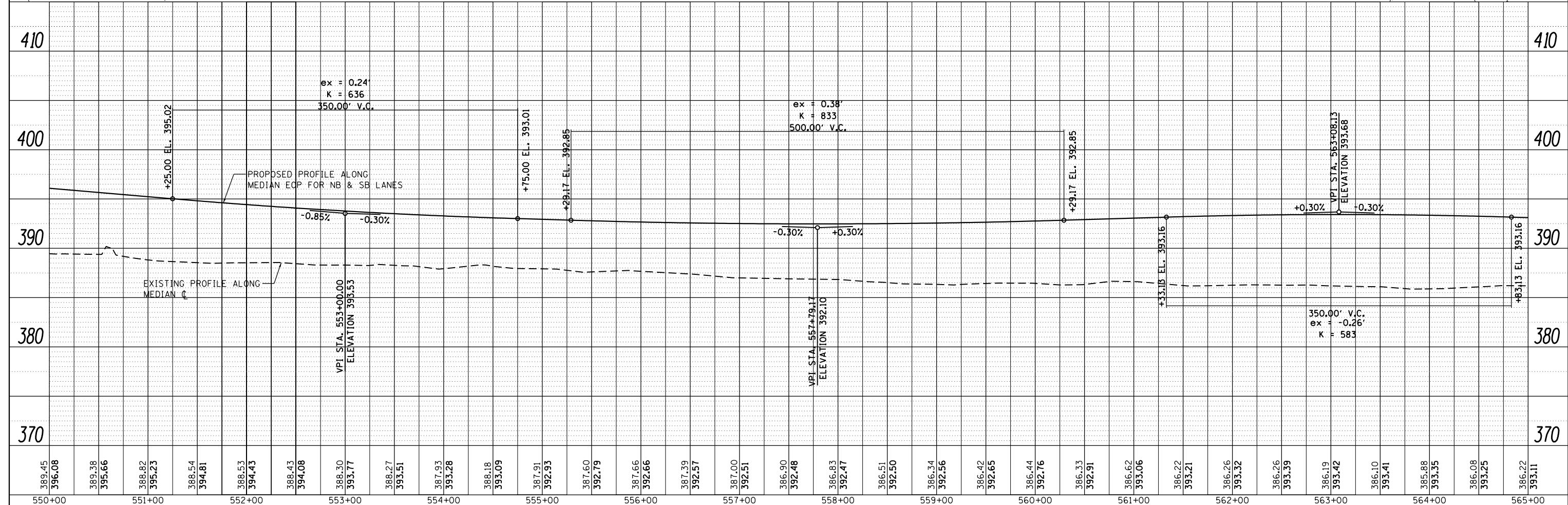

FILE NAME =	USER NAME = bemory	DESIGNED -	REVISED -
P:\Projects\2011 Projects\11297 - 100T US45	Ph2\CV\CADD Sheets\0978077-sh1-plnprof-US45	DRAWN -	REVISED -
	PLOT SCALE = 100.0000' / in.	CHECKED -	REVISED -
	PLOT DATE = 4/30/2014	DATE -	REVISED -

STATE OF ILLINOIS  
DEPARTMENT OF TRANSPORTATION

ROADWAY PLAN & PROFILE  
U.S. 45

SCALE: 1"=50' SHEET NO. OF SHEETS STA. 550+00.00 TO STA. 565+00.00

F.A.P. RTE.	SECTION	COUNTY	TOTAL SHEETS	SHEET NO.
332	(29,30)R-1	SALINE	745	157
CONTRACT NO. 78077			ILLINOIS FED. AID PROJECT	