

TEMPORARY PAVEMENT CONSTRUCTED AS NOTED	PERMANENT PAVEMENT CONSTRUCTED THIS STAGE	PERMANENT PAVEMENT CONSTRUCTED IN PREVIOUS STAGE	PAVEMENT REMOVAL THIS STAGE	[ADJ] STRUCTURE TO BE ADJUSTED	DIRECTION OF TRAFFIC FLOW	TEMPORARY FLOW ARROW	SIGN PANEL/BARRICADE ASSEMBLY (INCLUDED IN THE COST FOR TRAFFIC CONTROL AND PROTECTION, LUMP SUM)
				CONSTRUCTION SIGN	DRUMS WITH STEADY BURNING MONODIRECTIONAL LIGHTS		
				TYPE III BARRICADE	25' CENTERS		

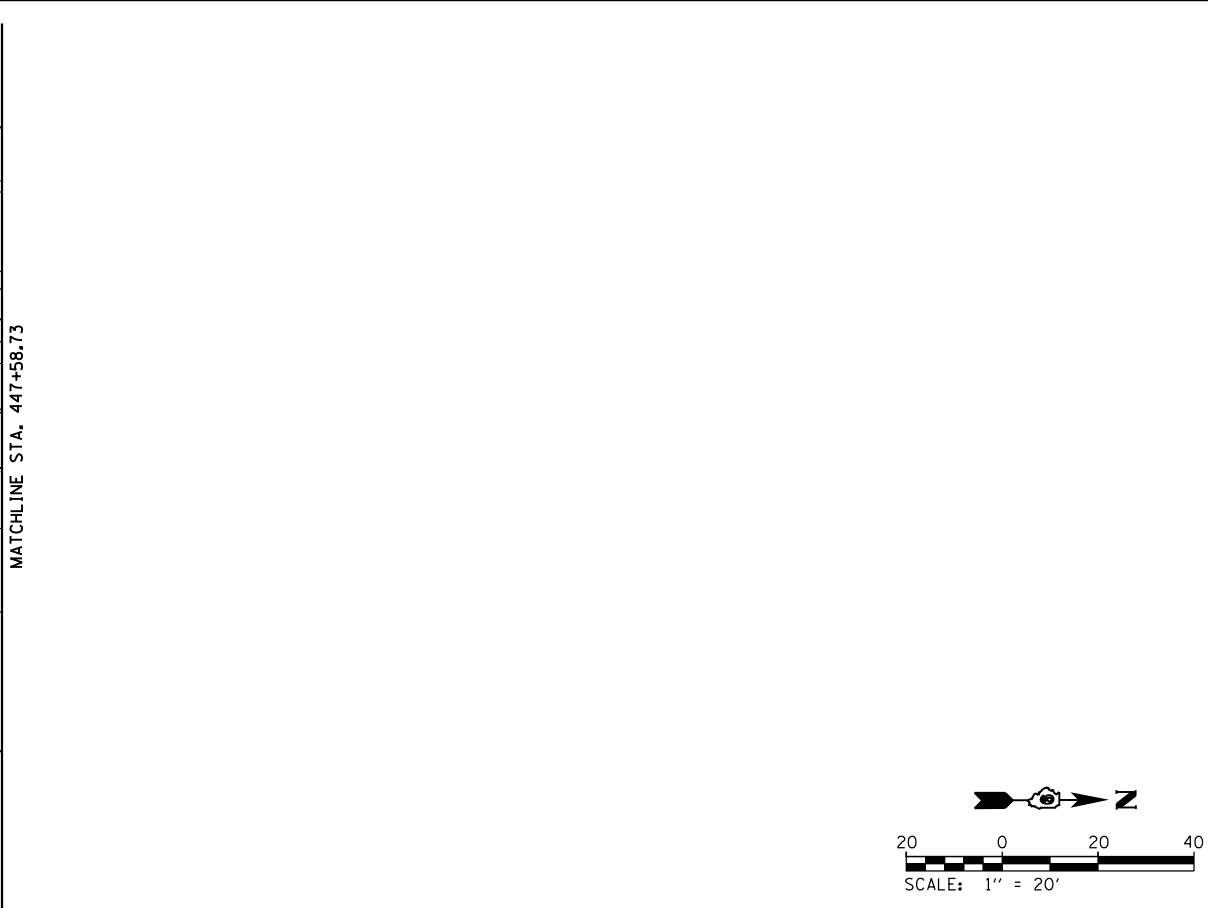
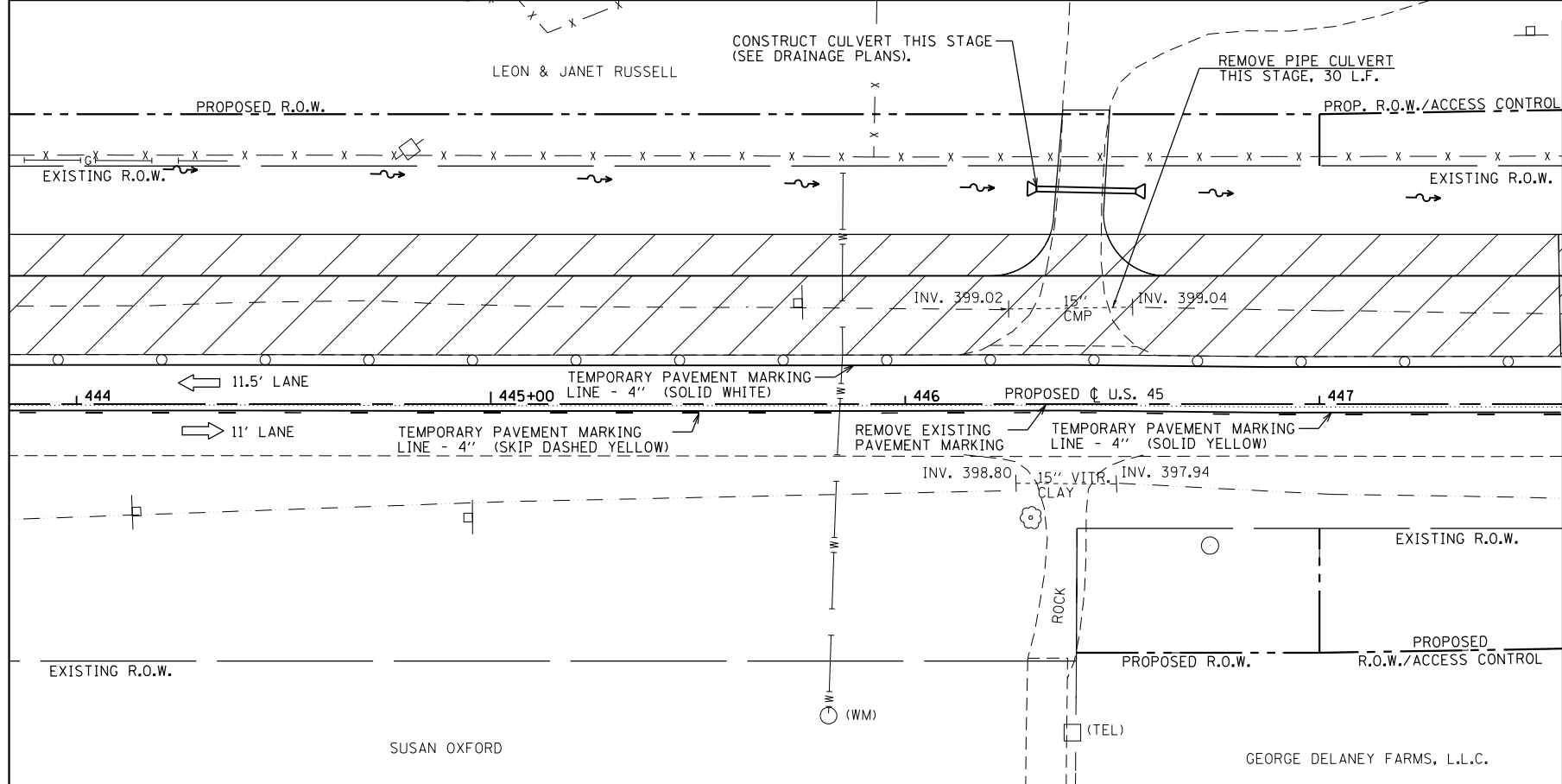

FILE NAME =	USER NAME = bemery	DESIGNED -	REVISED -
P:\Projects\2011 Projects\11297 - IDOT US 45 Ph2\CV\CADD Sheets\0978077-sht-MOT-Stage1\DRAWN.dgn		CHECKED -	REVISED -
		DATE -	REVISED -

**STATE OF ILLINOIS
DEPARTMENT OF TRANSPORTATION**

**MAINTENANCE OF TRAFFIC - STAGE 1A
U.S. 45**

SCALE: 1" = 20' SHEET NO. OF SHEETS STA. 438+00.00 TO STA. 447+58.73

F.A.P. RTE.	SECTION	COUNTY	TOTAL SHEETS	SHEET NO.
332	(29,30)R-1	SALINE	745	204
CONTRACT NO. 78077				
ILLINOIS FED. AID PROJECT				