

	TEMPORARY PAVEMENT CONSTRUCTED AS NOTED		PERMANENT PAVEMENT CONSTRUCTED THIS STAGE		PERMANENT PAVEMENT CONSTRUCTED IN PREVIOUS STAGE		ROADWAY REMOVAL THIS STAGE		DIRECTION OF TRAFFIC FLOW		TYPE III BARRICADE		TEMPORARY FLOW ARROW		DRUMS WITH STEADY BURNING MONODIRECTIONAL LIGHTS ● 25' CENTERS		SIGN PANEL/BARRICADE ASSEMBLY (INCLUDED IN THE COST FOR TRAFFIC CONTROL AND PROTECTION, LUMP SUM)
	CONSTRUCTION SIGN																

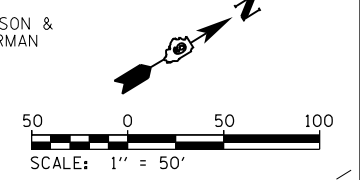
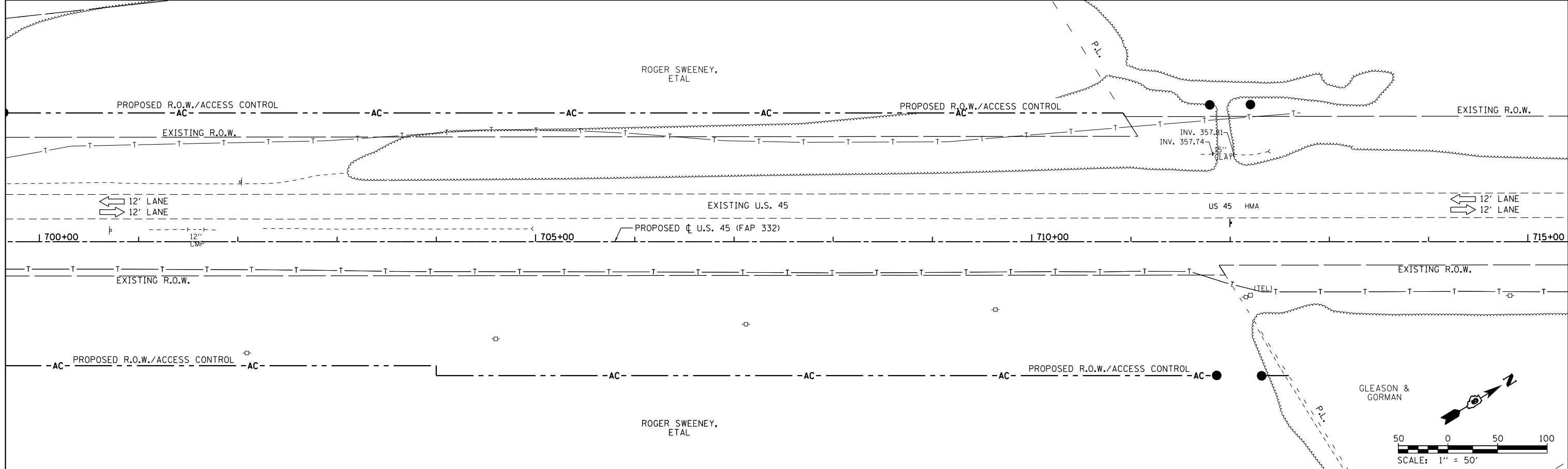

FILE NAME =	USER NAME = bemery	DESIGNED -	REVISED -	STATE OF ILLINOIS DEPARTMENT OF TRANSPORTATION	MAINTENANCE OF TRAFFIC - STAGE 1A U.S. 45				F.A.P. RTE. 332	SECTION (29,30)R-1	COUNTY SALINE	TOTAL SHEETS 745	SHEET NO. 213
P:\Projects\2011 Projects\11297 - IDOT US 45 Ph2\CV\CADD Sheets\0978077-sht-MOT-Stage1-DRAWN.dgn		CHECKED -	REVISED -		SCALE: 1" = 50'	SHEET	OF	SHEETS	STA. 685+00.00	TO STA. 715+00.00	CONTRACT NO. 78077		
Default	PLOT SCALE = 100.0000' / in.	DATE -	REVISED -		ILLINOIS FED. AID PROJECT								
	PLOT DATE = 4/30/2014												