

**MAINTENANCE OF TRAFFIC STAGE 2 (THIS SHEET)**

**SEQUENCE OF CONSTRUCTION**

1. BUILDING REMOVAL
2. REMOVE EXISTING U.S. 45
3. CONSTRUCT PROPOSED PERMANENT U.S. 45 EMBANKMENT AND PAVEMENT
4. CONSTRUCT PROPOSED PERMANENT S. COOK RD. INTERSECTION
5. CONSTRUCT PROPOSED PERMANENT GANDERTOWN RD EMBANKMENT AND PAVEMENT

**TRAFFIC PLACEMENT**

1. MAINTAIN TRAFFIC ON U.S. 45 PAVEMENT FROM STAGE 1A
2. ALL SIDEROADS SHALL REMAIN OPEN AND SHALL BE CONSTRUCTED UNDER TRAFFIC
3. ALL ENTRANCES SHALL REMAIN OPEN AND SHALL BE CONSTRUCTED UNDER TRAFFIC

**TRAFFIC CONTROL STANDARDS**  
701006, 701326

**TRAFFIC CONTROL PAYMENT**  
TRAFFIC CONTROL AND PROTECTION, LUMP SUM  
AS PER TRAFFIC CONTROL STANDARD USED

**NOTE:**  
ALT A & ALT B OPTION BEGINS AT STATION 449+88.13  
AND CONTINUES TO THE END OF THE PROJECT.

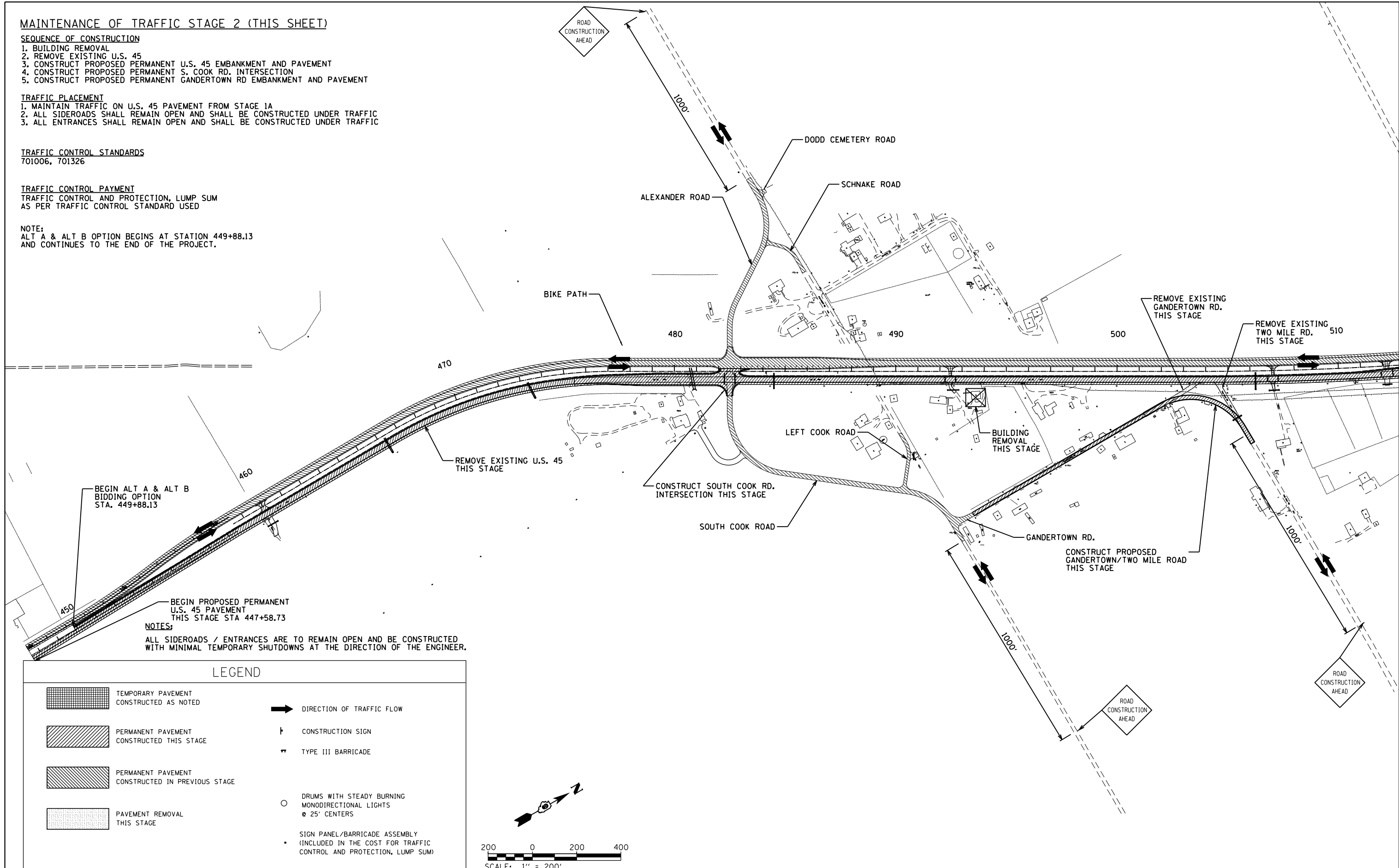

**NOTES:**  
ALL SIDEROADS / ENTRANCES ARE TO REMAIN OPEN AND BE CONSTRUCTED WITH MINIMAL TEMPORARY SHUTDOWNS AT THE DIRECTION OF THE ENGINEER.

**LEGEND**

- TEMPORARY PAVEMENT CONSTRUCTED AS NOTED
- PERMANENT PAVEMENT CONSTRUCTED THIS STAGE
- PERMANENT PAVEMENT CONSTRUCTED IN PREVIOUS STAGE
- PAVEMENT REMOVAL THIS STAGE
- DIRECTION OF TRAFFIC FLOW
- CONSTRUCTION SIGN
- TYPE III BARRICADE
- DRUMS WITH STEADY BURNING MONODIRECTIONAL LIGHTS @ 25' CENTERS
- SIGN PANEL/BARRICADE ASSEMBLY (INCLUDED IN THE COST FOR TRAFFIC CONTROL AND PROTECTION, LUMP SUM)

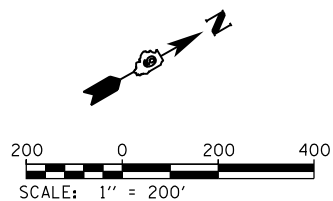

FILE NAME =	USER NAME = bemory	DESIGNED -	REVISED -
P:\Projects\2011 Projects\11297 - IDOT US 45 Ph2\CV\CADD Sheets\0978077-sht-Stage2.dgn		DRAWN -	REVISED -
Default	PLOT SCALE = 400.0000' / in.	CHECKED -	REVISED -
	PLOT DATE = 4/30/2014	DATE -	REVISED -

**STATE OF ILLINOIS  
DEPARTMENT OF TRANSPORTATION**

**CONSTRUCTION STAGING PLAN  
STAGE 2**

SCALE: 1" = 200' SHEET OF SHEETS STA. 447+58.73 TO STA. 510+00.00

F.A.P. RTE.	SECTION	COUNTY	TOTAL SHEETS	SHEET NO.
332	(29,30)R-1	SALINE	745	266
CONTRACT NO. 78077				
ILLINOIS FED. AID PROJECT				