

TEMPORARY PAVEMENT CONSTRUCTED AS NOTED
  PERMANENT PAVEMENT CONSTRUCTED THIS STAGE
  PERMANENT PAVEMENT CONSTRUCTED IN PREVIOUS STAGE
  ROADWAY REMOVAL THIS STAGE
  DIRECTION OF TRAFFIC FLOW
  TYPE III BARRICADE
  TEMPORARY FLOW ARROW
  DRUMS WITH STEADY BURNING MONODIRECTIONAL LIGHTS
  SIGN PANEL/BARRICADE ASSEMBLY (INCLUDED IN THE COST FOR TRAFFIC CONTROL AND PROTECTION, LUMP SUM)

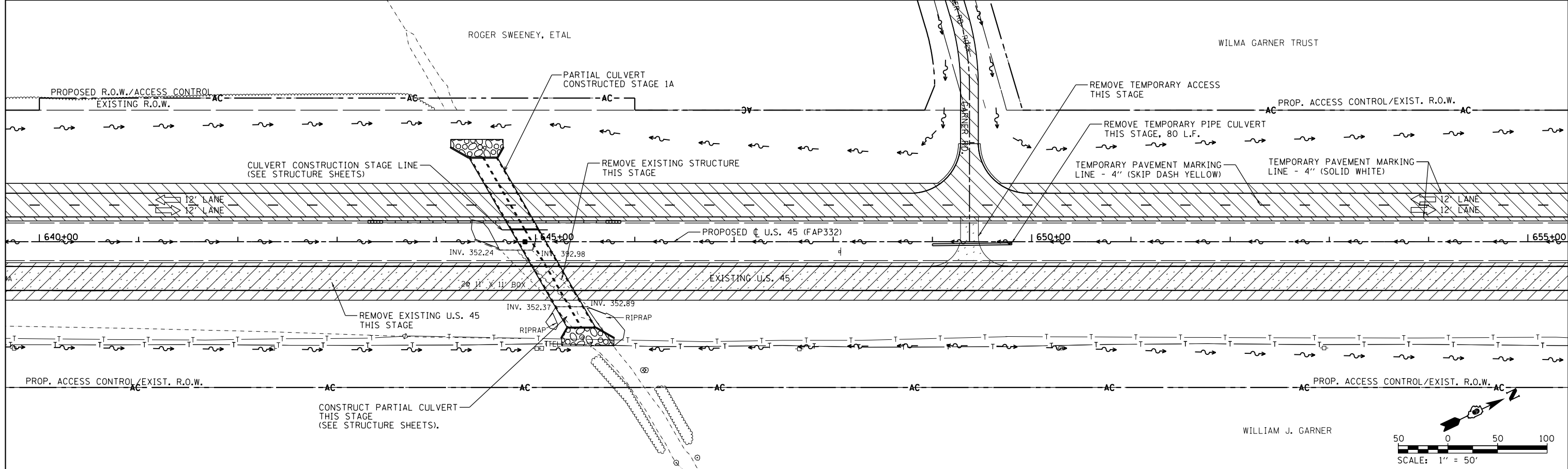

FILE NAME =	USER NAME = bemery	DESIGNED -	REVISED -	<b>STATE OF ILLINOIS DEPARTMENT OF TRANSPORTATION</b>	<b>MAINTENANCE OF TRAFFIC - STAGE 2 U.S. 45</b>	F.A.P. RTE. 332	SECTION (29,30)R-1	COUNTY SALINE	TOTAL SHEETS 745	SHEET NO. 277	
P:\Projects\2011 Projects\11297 - IDOT US 45 Ph2\CV\CADD Sheets\0978077-sht-MOT-Stage2	DRAWN -	REVISOR -	REVISION -			CONTRACT NO. 78077					
Default	PLOT SCALE = 100.0000' / in.	CHECKED -	REVISOR -			ILLINOIS FED. AID PROJECT					
	PLOT DATE = 4/30/2014	DATE -	REVISION -			SCALE: 1" = 50' SHEET OF SHEETS STA. 625+00.00 TO STA. 655+00.00					