

DATE
BY
FINISHED
NO.
DATE
BY
FINISHED
NO.
DATE
BY
FINISHED
NO.
DATE
BY
FINISHED
NO.

DATE
BY
FINISHED
NO.
DATE
BY
FINISHED
NO.
DATE
BY
FINISHED
NO.

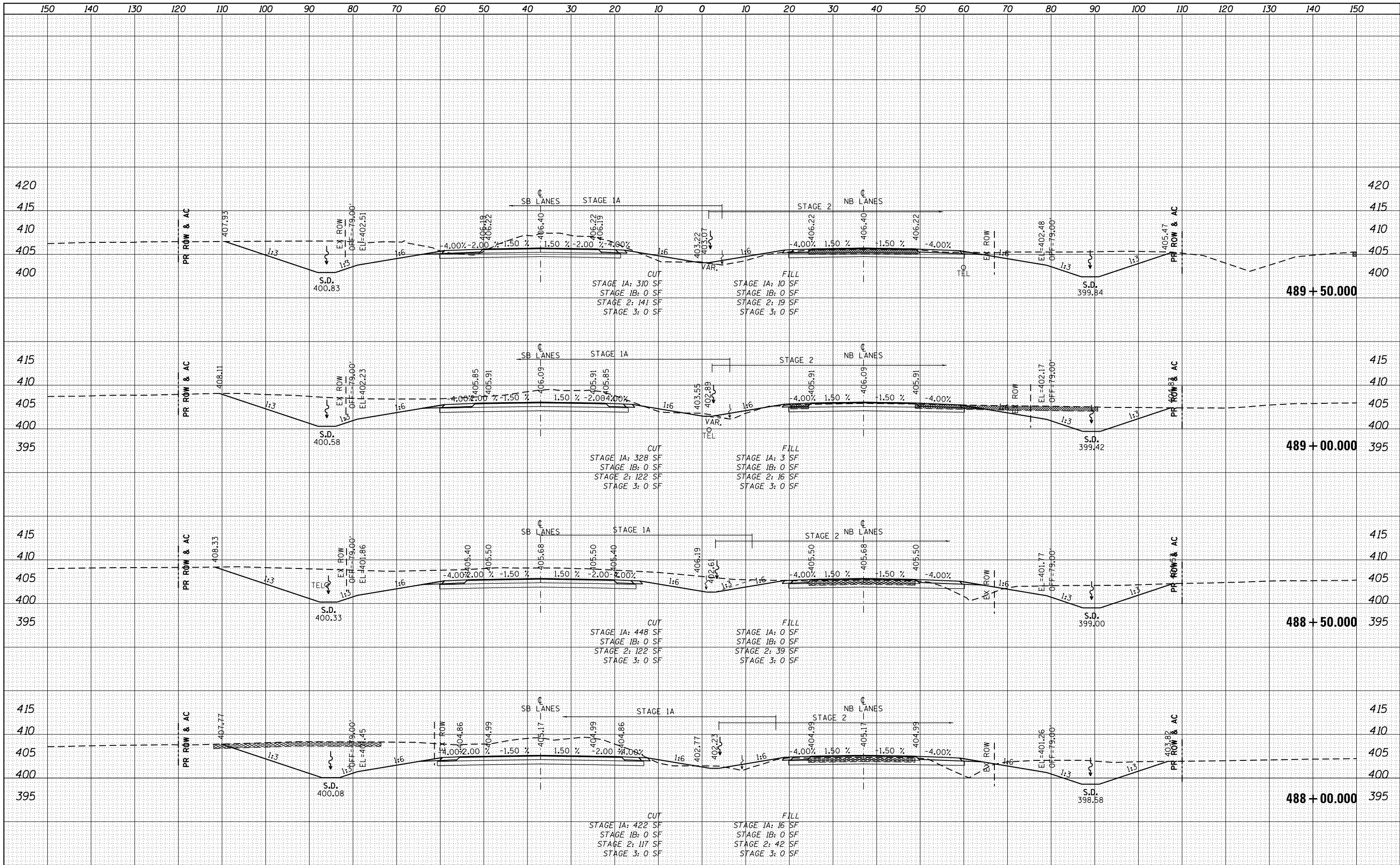

FILE NAME =	USER NAME = bemery	DESIGNED -	REVISED -	STATE OF ILLINOIS DEPARTMENT OF TRANSPORTATION	CROSS SECTIONS U.S. 45 (F.A.P. 332)	F.A.P. RTE.	SECTION	COUNTY	TOTAL SHEETS	SHEET NO.
P:\Projects\2011 Projects\11297 - IDOT US45 Ph2\CV\CADD Sheets\0978077-sht-xsc.dgn		DRAWN -	REVISED -			332	(29,30)R-1	SALINE	745	552
PLOT SCALE = 20.0000' / in.		CHECKED -	REVISED -			CONTRACT NO. 78077				
PLOT DATE = 4/30/2014		DATE -	REVISED -			ILLINOIS FED. AID PROJECT				
Default				SCALE: 1" = 10'	SHEET OF SHEETS	STA. 488+00.000 TO STA. 489+50.000				