

DATE	
BY	
FINISHED	
NO.	
SURVEYED	
PLOTTED	
TEMPLATE	
AREAS	
CHECKED	

DATE	
BY	
ORIGINAL	
NO.	
SURVEYED	
PLOTTED	
TEMPLATE	
AREAS	
CHECKED	

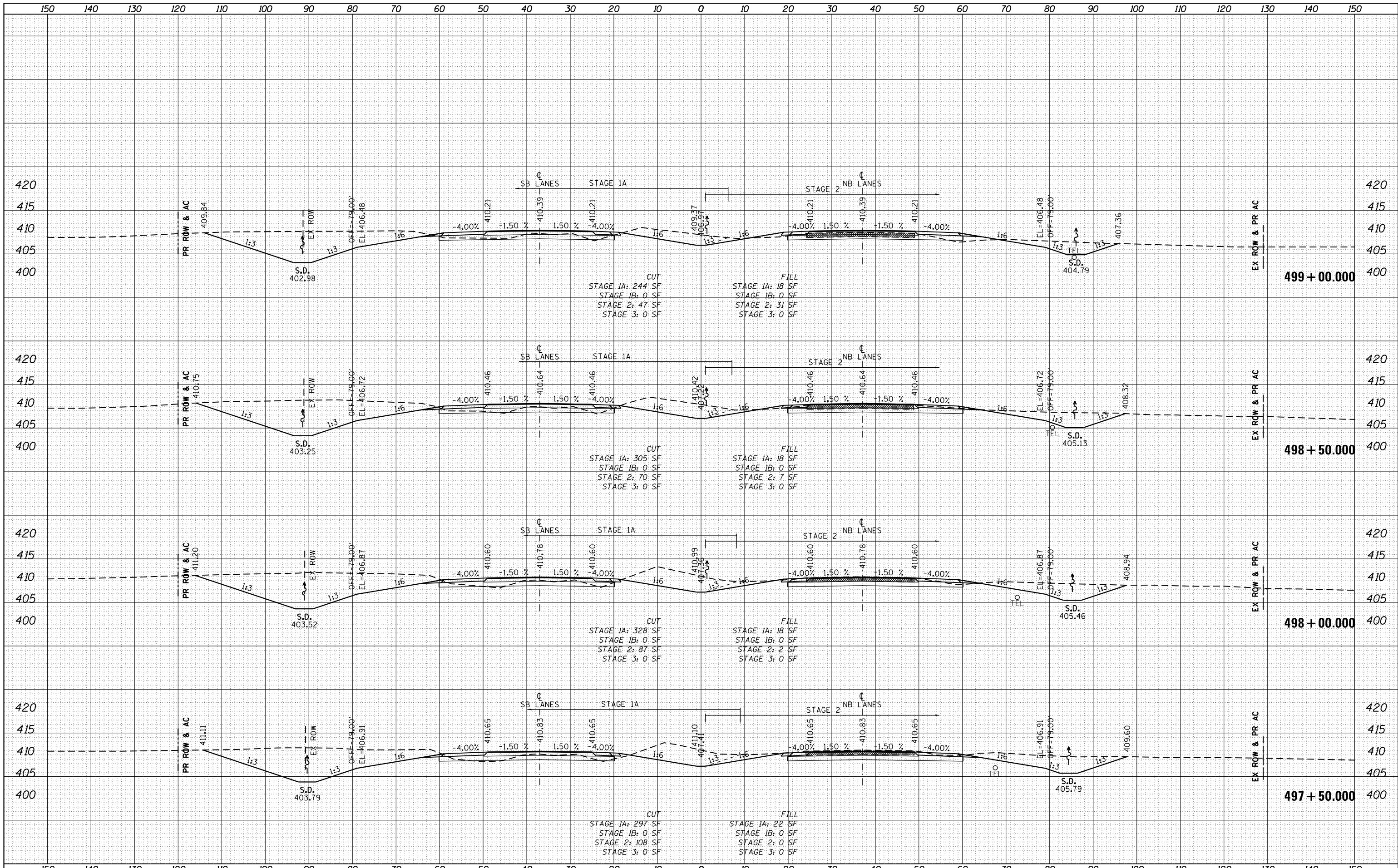

FILE NAME =	P:\Projects\2011 Projects\11297 - IDOT US45 Ph2\CV\CADD Sheets\978077-sht-xsc.dgn
USER NAME =	bemery
DESIGNED -	REVISIED -
DRAWN -	REVISIED -
CHECKED -	REVISIED -
DATE -	REVISIED -
PLOT SCALE =	20.0000' / in.
PLOT DATE =	4/30/2014

**STATE OF ILLINOIS
DEPARTMENT OF TRANSPORTATION**

CROSS SECTIONS U.S. 45 (F.A.P. 332)	
SCALE: 1" = 10'	SHEET OF SHEETS
STA. 497+50.000	TO STA. 499+00.000

F.A.P. RTE.	SECTION	COUNTY	TOTAL SHEETS	SHEET NO.
332	(29,30)R-1	SALINE	745	557
CONTRACT NO. 78077			ILLINOIS FED. AID PROJECT	