

REVISIONS		
NUMBER	BY	DATE

**MIDAMERICA ST. LOUIS AIRPORT  
ST. CLAIR COUNTY, ILLINOIS**

**AIRFIELD LIGHTING IMPROVEMENTS**

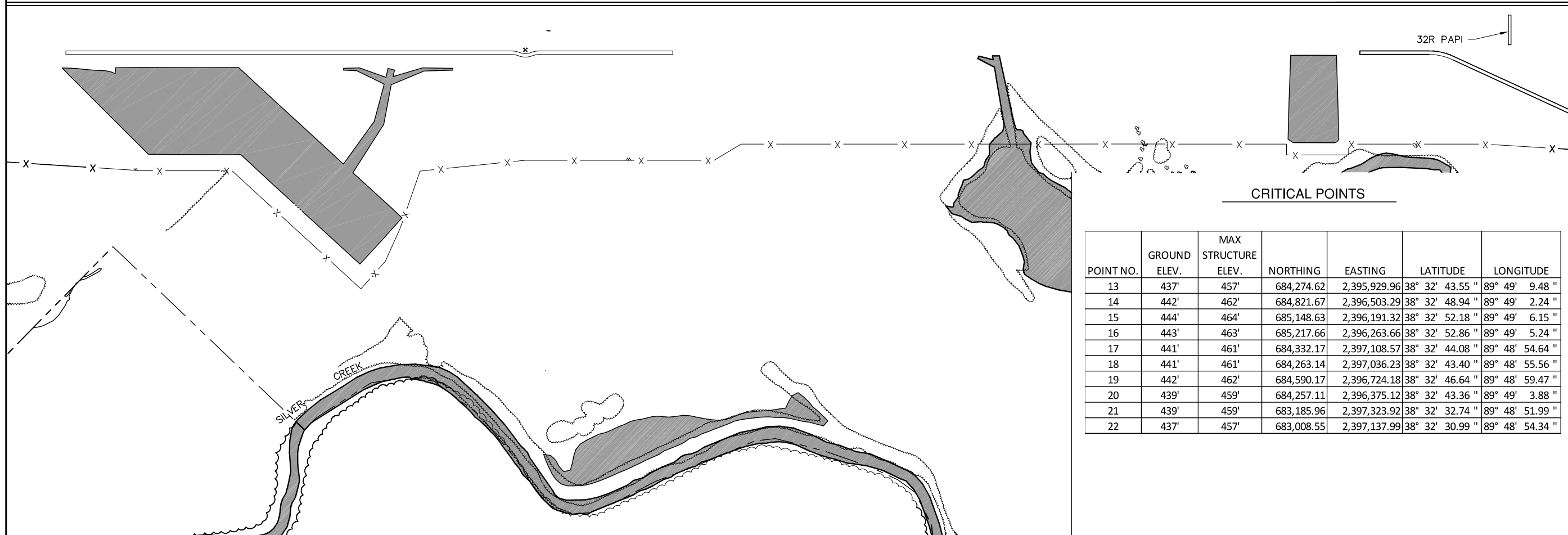

POINT NO.	GROUND ELEV.	MAX STRUCTURE ELEV.	NORTHING	EASTING	LATITUDE	LONGITUDE
13	437'	457'	684,274.62	2,395,929.96	38° 32' 43.55 "	89° 49' 9.48 "
14	442'	462'	684,821.67	2,396,503.29	38° 32' 48.94 "	89° 49' 2.24 "
15	444'	464'	685,148.63	2,396,191.32	38° 32' 52.18 "	89° 49' 6.15 "
16	443'	463'	685,217.66	2,396,263.66	38° 32' 52.86 "	89° 49' 5.24 "
17	441'	461'	684,332.17	2,397,108.57	38° 32' 44.08 "	89° 48' 54.64 "
18	441'	461'	684,263.14	2,397,036.23	38° 32' 43.40 "	89° 48' 55.56 "
19	442'	462'	684,590.17	2,396,724.18	38° 32' 46.64 "	89° 48' 59.47 "
20	439'	459'	684,257.11	2,396,375.12	38° 32' 43.36 "	89° 49' 3.88 "
21	439'	459'	683,185.96	2,397,323.92	38° 32' 32.74 "	89° 48' 51.99 "
22	437'	457'	683,008.55	2,397,137.99	38° 32' 30.99 "	89° 48' 54.34 "

ONE MEMORIAL DRIVE, SUITE 500  
ST. LOUIS, MO 63102  
(314) 436-5500

**GMT**  
CRAWFORD, MURPHY & TILLY, INC.  
CONSULTING ENGINEERS

© Copyright GMT, Inc.  
PROFESSIONAL ENGINEERING - 184-00613

**IL PROJECT, BLV-4405  
AIP PROJECT, 3-17-SBGP-XX**

FILE: 05-12\_CAP.dwg

DESIGN BY: ASF

DRAWN BY: ASF

CHECKED BY: MJD/CET

APPROVED BY: BWG

DATE: JUNE 27, 2014

JOB No: 13098-02

**CONSTRUCTION  
ACTIVITY PLAN  
PHASE 2**

SHEET 8 OF 35 SHEETS