

FILE: CMI4347-1305902-CD102.dwg
 UPDATE BY: Chris Groth
 PLOT DATE: 7/10/2014 7:05 PM
 CMI-V-AERL
 CMI 1305902-V-AF2D
 CMI 1305902-C-SPAL
 KEYMAP
 UTILITY_CMI
 CMI PAVEMENT MARKING

UN053

REVISIONS		
NUMBER	BY	DATE

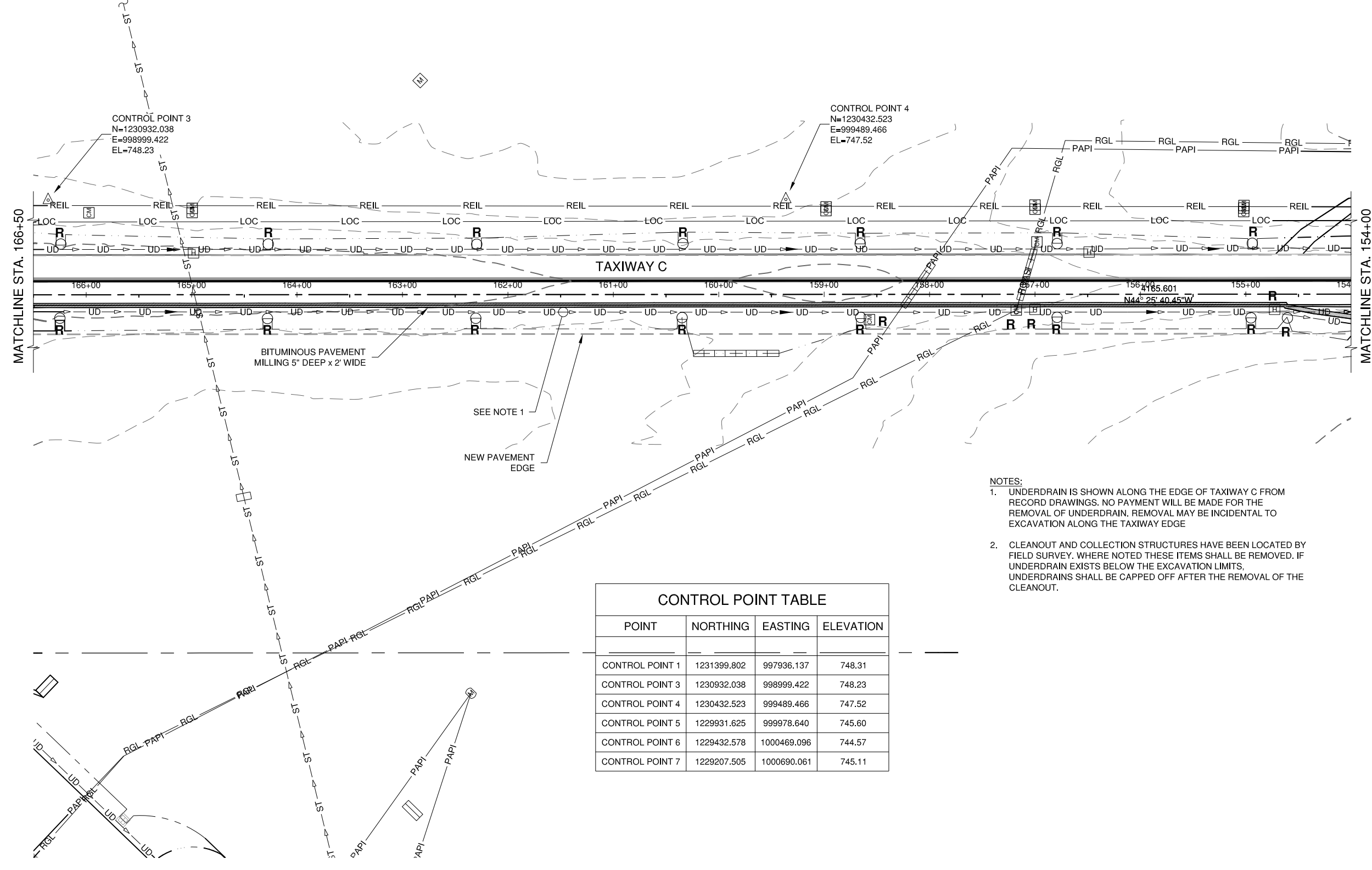
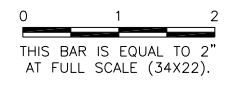

- NOTES:**
- UNDERDRAIN IS SHOWN ALONG THE EDGE OF TAXIWAY C FROM RECORD DRAWINGS. NO PAYMENT WILL BE MADE FOR THE REMOVAL OF UNDERDRAIN. REMOVAL MAY BE INCIDENTAL TO EXCAVATION ALONG THE TAXIWAY EDGE
 - CLEANOUT AND COLLECTION STRUCTURES HAVE BEEN LOCATED BY FIELD SURVEY. WHERE NOTED THESE ITEMS SHALL BE REMOVED. IF UNDERDRAIN EXISTS BELOW THE EXCAVATION LIMITS, UNDERDRAINS SHALL BE CAPPED OFF AFTER THE REMOVAL OF THE CLEANOUT.

CONTROL POINT TABLE			
POINT	NORTHING	EASTING	ELEVATION
CONTROL POINT 1	1231399.802	997936.137	748.31
CONTROL POINT 3	1230932.038	998999.422	748.23
CONTROL POINT 4	1230432.523	999489.466	747.52
CONTROL POINT 5	1229931.625	999978.640	745.60
CONTROL POINT 6	1229432.578	1000469.096	744.57
CONTROL POINT 7	1229207.505	1000690.061	745.11

UNIVERSITY OF ILLINOIS
 WILLARD AIRPORT
 SAVOY, ILLINOIS

**BASE BID - REALIGN AND WIDEN TAXIWAY C
 EXISTING CONDITIONS AND REMOVALS
 SHEET 2**

© Copyright CMT, Inc.

CMT
 CRAWFORD, MURPHY & TILLY, INC.
 CONSULTING ENGINEERS
 License No. 184-000613

DESIGN BY:	CBG
DRAWN BY:	ADD
CHECKED BY:	CET
APPROVED BY:	CET
DATE:	JUNE 27, 2014
JOB No:	13059-02-00
IL PROJ. NO. CMI-4347 AIP PROJ. NO. 3-17-0016-XX	
SHEET	22 OF 83 SHEETS

K:\Champaign\1305902\Draw\Sheets