

Illinois Department of Transportation

Asbestos Abatement Survey

Work Order No.: 36

Job Order No.: R-90-001-21

Route: IL 43

Parcel No.: 0N30002

6439 S. Old Harlem Avenue

Chicago, Cook County, IL 60638

June 13, 2025

Asbestos Abatement Survey

Work Order No.: 36

Job Order No.: R-90-001-21

Route: IL 43

Parcel No.: 0N30002

6439 S. Old Harlem Avenue

Chicago, Cook County, IL 60638

June 13, 2025

Prepared By:

Arcadis U.S., Inc.
225 West Wacker Drive
Suite 2015
Chicago, Illinois 60606
Phone: 312 917 1000

Prepared For:

Illinois Department of Transportation
2300 South Dirksen Parkway
Springfield, IL 62764

Our Ref:

30253552



Paul Hoffman
Industrial Hygiene Specialist



Katherine Challberg
Senior Environmental Engineer / QA/QC

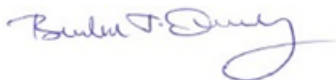

Brendan J. Quealy
Principal Environmental Engineer/Certified Project Manager

This document is intended only for the use of the individual or entity for which it was prepared and may contain information that is privileged, confidential and exempt from disclosure under applicable law. Any dissemination, distribution or copying of this document is strictly prohibited.

Contents

Acronyms and Abbreviations.....	ii
1 Introduction.....	1
2 Survey Methodology	1
3 Analytical Methods.....	2
4 Findings.....	2
5 Recommendations.....	2
6 Cost Estimate.....	3
7 Additional Survey Limitations.....	4

Tables

Table 1	Asbestos Homogeneous Areas Summary
---------	------------------------------------

Figures

Figures 1-3	Asbestos Bulk Sampling Locations
Figure 4	Asbestos-Containing Materials Locations

Appendices

Appendix A	Limitations and Service Constraints
Appendix B	Accreditations - Inspector, Laboratory
Appendix C	Laboratory Reports – Asbestos
Appendix D	Photograph Log

Acronyms and Abbreviations

ACM	asbestos-containing material
AHERA	Asbestos Hazard Emergency Response Act
Arcadis	Arcadis U.S., Inc.
ASTM	ASTM International
CFR	Code of Federal Regulations
COC	chain of custody
DS	dispersion staining
HA	homogeneous area
IAC	Illinois Administrative Code
IDPH	Illinois Department of Public Health
IDOT	Illinois Department of Transportation
IEPA	Illinois Environmental Protection Agency
NESHAP	National Emissions Standards for Hazardous Air Pollutant
NIOSH	National Institute for Occupational Safety and Health
NVLAP	National Voluntary Laboratory Accreditation Program
OSHA	Occupational Safety and Health Administration
PLM	polarized light microscopy
PPE	personal protective equipment
QA/QC	quality control/quality assurance
STAT	STAT Analysis Corporation of Chicago, Illinois
USEPA	United States Environmental Protection Agency

1 Introduction

Arcadis U.S., Inc. (Arcadis) conducted an asbestos abatement survey (survey) at Parcel No. 0N30002 located at 6439 S. Old Harlem Avenue, Chicago, Cook County, Illinois (Site) in accordance with Work Order No. 36 under the Prime Agreement for Consulting Services for PTB No. 202-043 between Illinois Department of Transportation (IDOT) and Arcadis. Arcadis' services and report are subject to the Limitations and Service Constraints provided in **Appendix A**.

The Site is improved with ranch-style residential building with a full finished basement, constructed in 1992, and covering approximately 1,272 SF above grade. A two-car detached garage is also present and included in the scope of the work.

The objective of the survey was to ascertain the general presence, quantity, and location of asbestos-containing materials (ACMs) at the site that may be impacted by the planned demolition and provide preliminary cost estimates for asbestos abatement that may be required prior to demolition activities.

The survey activities were conducted on March 7, 2025, by Paul Hoffman of Arcadis U.S., Inc. and Patrick Hook of A3 Environmental LLC. (A3E), an Arcadis sub-consultant. Copies of their accreditations are provided in **Appendix B**.

2 Survey Methodology

Arcadis conducted the asbestos survey in compliance with the United States Environmental Protection Agency (USEPA) National Emissions Standards for Hazardous Air Pollutants (NESHAPs), applicable State of Illinois and local asbestos regulations. This was accomplished by conducting a visual inspection of the structures to be impacted by the planned demolition and collecting samples of suspect ACM based on these observations. Arcadis conducted the asbestos survey in general accordance with ASTM International (ASTM) E2356 Standard Practice for Comprehensive Building Asbestos Surveys. ASTM E2356 meets the applicable asbestos survey and/or sampling requirements of current USEPA NESHAP Standard [40 Code of Federal Regulations (CFR) 61, Subpart M (Asbestos)], USEPA Asbestos Hazard Emergency Response Act (AHERA) [40 CFR 763, Subpart E], and Occupational Safety and Health Administration (OSHA) Asbestos Construction Standard [29 CFR 1926.1101].

The survey included an inspection of the structures to be impacted by the planned demolition providing a general sense of the overall location, type, quantity, and condition of suspect ACMs present. The asbestos survey included a visual and physical assessment of each accessible space to locate suspect ACMs. Suspect materials were divided into "Homogeneous Areas" (HAs) (i.e., materials that were determined by the inspector to be homogeneous based on their color, texture, and assumed date of installation).

A representative number of samples were collected from each HA. Bulk material samples were collected in 4-milliliter plastic bags and tightly sealed for transport to STAT Analysis Corporation (STAT) in Chicago, Illinois. Each sample collected by Arcadis was assigned its own unique coded number and sent for laboratory analysis under a chain-of-custody (COC) protocol.

The survey included destructive, intrusive, and/or exploratory testing unless specifically prohibited by IDOT. Destructive sampling is performed in order to identify materials which are hidden or obstructed. Hidden or obstructed areas include but are not limited to wall cavities, pipe chases, spaces above fixed ceilings, materials located under carpeting or subfloors, and ceramic tile grout/adhesive.

3 Analytical Methods

Asbestos bulk samples were analyzed for asbestos (reported in percent of type of asbestos) using polarized light microscopy with dispersion staining (PLM/DS) in accordance with the USEPA Method 600/R-93/116. Percentage estimates of each material's composition are based on the analyst's best visual judgment following PLM/DS analysis, and examination with a stereoscope.

STAT is accredited under the National Voluntary Laboratory Accreditation Program (NVLAP). A copy of their accreditation is provided in **Appendix B**. Laboratory analytical reports are provided in **Appendix C**.

4 Findings

Arcadis identified 15 HAs from which 47 samples were collected and analyzed. A listing of the identified HAs, including each HA material description, location, sample number, condition, asbestos content, and estimated quantity, are presented in Table 1. Approximate sampling locations are shown on Figures 1-3 and locations of identified ACM are shown on Figure 4.

The USEPA defines ACM as a material containing greater than 1% asbestos. Materials containing less than 1% asbestos are not regulated by the USEPA or the State of Illinois, but their disturbance is regulated by OSHA.

The following HAs were determined to be asbestos-containing materials:

- HA-14: Black sealant along the exterior wall to the concrete sidewalk

No HAs were identified as assumed ACM.

The remaining samples collected by Arcadis as part of the survey were reported by the laboratory to be ND = Asbestos Not Detected (Not Present).

Representative photographs are provided in **Appendix D**.

5 Recommendations

ACMs identified at the site that may be disturbed during demolition activities, must be removed by a licensed asbestos abatement contractor utilizing industry standard work procedures in accordance with all federal, state, and local regulations governing asbestos.

If other suspect materials not referenced in this survey report are identified during demolition activities, we recommend these materials be assumed ACM until the materials are inspected by a licensed asbestos inspector, sampled, and submitted for laboratory analysis.

6 Cost Estimate

Arcadis prepared this rough order of magnitude (ROM) opinion of cost to support planned asbestos abatement activities at the Site prior to building demolition.

ROUGH ORDER OF MAGNITUDE OPINION OF ASBESTOS ABATEMENT COSTS		
ASBESTOS ABATEMENT COSTS		
Item	Estimated Cost	Estimated Duration (Days)
Removal/disposal of identified ACM	\$5,500.00	1
Removal/disposal of assumed ACM	N/A	N/A
Sub-Total Estimated Abatement Costs	\$5,500.00	1
Contingency (15%)	\$825.00	n/a
Total Estimated Abatement Costs	\$6,325.00	1
ASBESTOS OVERSIGHT COSTS		
Item	Estimated Cost	Estimated Duration (Days)
Project Management/Coordination/Reporting	\$1,000.00	n/a
ACM Abatement Oversight (including equipment and analysis)	\$1,500.00	1
Sub-Total Estimated Oversight Costs	\$2,500.00	1
Contingency (15%)	\$375.00	n/a
Total Estimated Oversight Costs	\$2,875.00	1
TOTAL ESTIMATED PROJECT COST (WITH 15% CONTINGENCY)	\$9,200.00	1

The above ROM opinion of cost is based on the following assumptions:

- Cost estimate is based on the information identified in Arcadis' survey report.
- Cost estimate includes permits, labor, equipment, waste transport and disposal.
- Cost estimate assumes work will be awarded in its entirety to one contractor and completed during a single mobilization.
- Cost estimate includes consulting fees such as project management, project oversight, air sampling, etc.
- Actual bids and schedule durations may vary.
- Oversight costs are dependent upon the project duration which may vary depending on the contractor's schedule and is outside of Arcadis' control.

7 Additional Survey Limitations

Arcadis' survey is subject to the following survey limitations.

- The investigation did not include access or inspection of confined spaces, underground piping, conduits, and building footings, if any.
- If other suspect materials, not referenced in this survey report, are identified during renovation or demolition activities, Arcadis recommends that these materials be considered regulated until they are inspected by an appropriately certified inspector and proven otherwise.
- Utilities/services, including electric, water, and heat, were active in most areas surveyed. Materials associated with electrical components and energized equipment were not safely accessible and were not sampled.

Table

Table 1. Asbestos Homogeneous Areas Summary
IDOT - Asbestos Abatement Survey
WO # 36
6439 S Old Harlem Avenue, Chicago, Illinois

HA No.	Material Description	Material Location	Sample Number	Condition	Friability	Asbestos Content	Estimated Quantity	Unit	Notes
1	Tan 12" x 12" Ceramic Floor Tile Thin Set	Kitchen, Dining Room, Hallway	1, 2, 3	Good	Non-Friable	ND	400	SF	
1G	Tan 12" x 12" Ceramic Floor Tile Grout	Kitchen, Dining Room, Hallway	1G, 2G, 3G	Good	Non-Friable	ND	400	SF	
2	8" x 8" White Ceramic Floor Tile Thinset	Bathroom	4, 5, 6	Good	Non-Friable	ND	40	SF	
2G	8" x 8" White Ceramic Floor Tile Grout	Bathroom	4G, 5G, 6G	Good	Non-Friable	ND	40	SF	
3	Tan 8" x 12" Ceramic Wall Tile Mastic	Bathroom	7, 8, 9	Good	Non-Friable	ND	60	SF	
3G	Tan 8" x 12" Ceramic Wall Tile Grout	Bathroom	7G, 8G, 9G	Good	Non-Friable	ND	60	SF	
4	Tan 12" x 12" Ceramic Floor Tile Thinset	Front Entrance	10, 11, 12	Good	Non-Friable	ND	12	SF	
4G	Tan 12" x 12" Ceramic Floor Tile Grout	Front Entrance	10G, 11G, 12G	Good	Non-Friable	ND	12	SF	
5	Brown 2" x 2"/ 2" x 4" Stone Backsplash Thinset	Kitchen	13, 14, 15	Good	Non-Friable	ND	60	SF	
5G	Brown 2" x 2"/ 2" x 4" Stone Backsplash Grout	Kitchen	13G, 14G, 15G	Good	Non-Friable	ND	60	SF	
6	White Joint Compound	1st Floor and Basement Walls and Ceilings	16, 17, 18, 19, 20	Good	Friable	ND	3,000	SF	
7	Brown 12" x 12" Backsplash Thinset	Basement Bathroom Walls and Floor	21, 22, 23	Good	Non-Friable	ND	120	SF	
7G	Brown 12" x 12" Backsplash Grout	Basement Bathroom Walls and Floor	21G, 22G, 23G	Good	Non-Friable	ND	120	SF	
8	Tan 12" x 12" Vinyl Floor Tile	Basement Under Stairs	24, 25, 26	Good	Non-Friable	ND	30	SF	
8M	Yellow Mastic with Tan 12" x 12" Vinyl Floor Tile and	Basement Under Stairs	24M, 25M, 26M	Good	Non-Friable	ND	30	SF	

Table 1. Asbestos Homogeneous Areas Summary
 IDOT - Asbestos Abatement Survey
 WO # 36
 6439 S Old Harlem Avenue, Chicago, Illinois

HA No.	Material Description	Material Location	Sample Number	Condition	Friability	Asbestos Content	Estimated Quantity	Unit	Notes
9	Concrete Foundation Floor and Wall	Basement	27, 28, 29	Good	Non-Friable	ND	1,000	SF	
10	Black Asphalt Roof Shingle	Roof	30, 31, 32	Good	Non-Friable	ND	1,000	SF	
11	Black Tar Paper under HA-10	Roof	33, 34, 35	Good	Non-Friable	ND	1,000	SF	
12	Brown Asphalt Roof Shingle	Garage Roof	36, 37, 38	Good	Non-Friable	ND	280	SF	
13	Black Tar Paper under HA-12	Garage Roof	39, 40, 41	Good	Non-Friable	ND	280	SF	
14	Black Sealant Along Exterior Wall to Concrete Sidewalk	Exterior	42, 43, 44	Good	Non-Friable	Chrysotile 1% - 5%	100	LF	
15	Gypsum Board	1st Floor and Basement Walls and Ceilings	45, 46, 47	Good	Non-Friable	ND	3,000	SF	

ACM = Asbestos-Containing Material

Assumed ACM = A material determined by the inspector to be suspect ACM and is considered asbestos-containing until laboratory analysis can prove otherwise.

NAD = No Asbestos Detected

EA = Each

LF = Linear Foot

SF = Square Foot

Figures

1

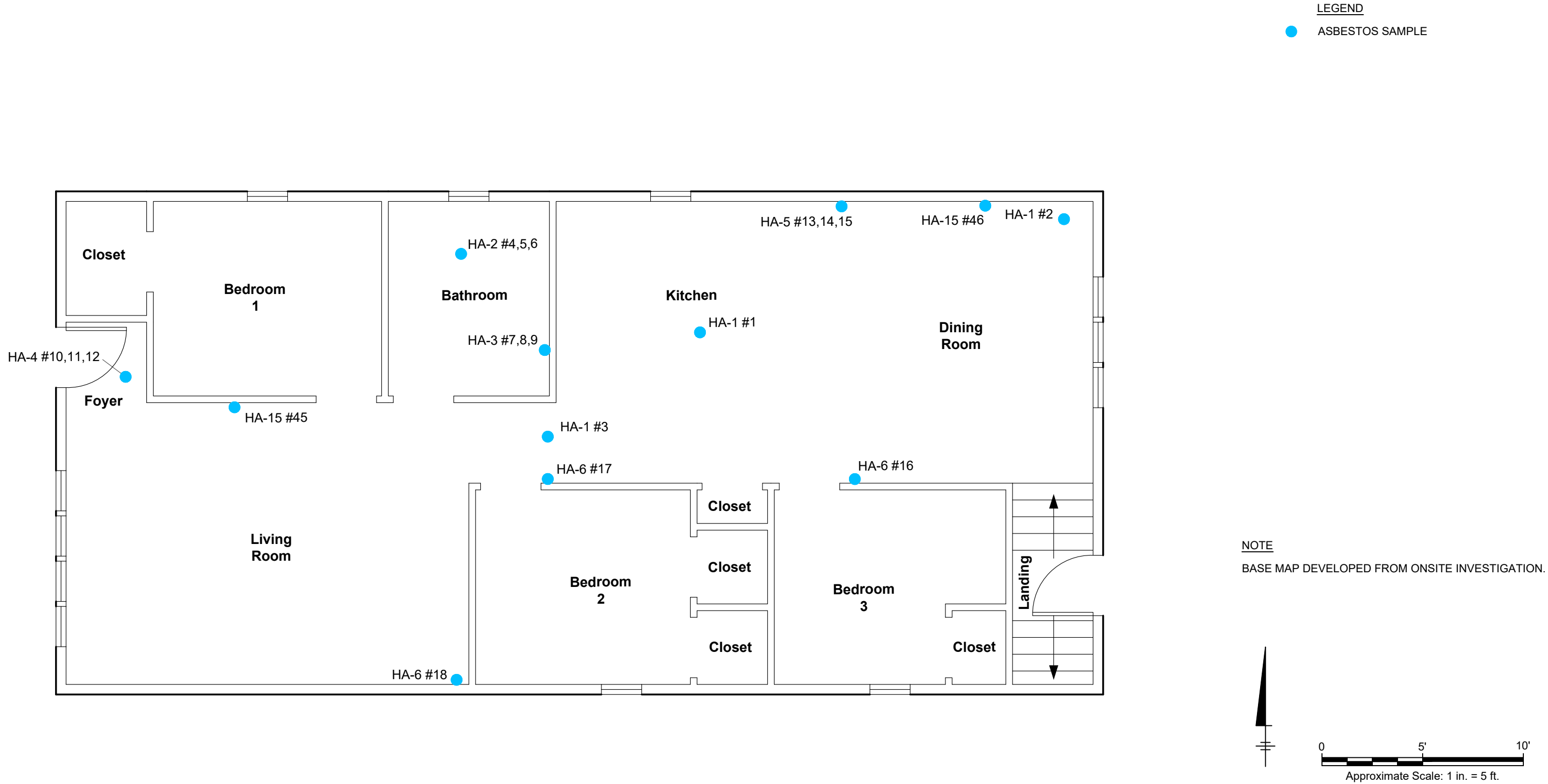

IDOT / Asbestos Surveys WO #036
Job No. R-90-001-21
Route IL 43 0N30002
6439 S Old Harlem Avenue
Chicago, Cook County, Illinois
ASBESTOS ABATEMENT SURVEY

**SAMPLING LOCATIONS -
FIRST FLOOR**

ARCADIS

FIGURE
2

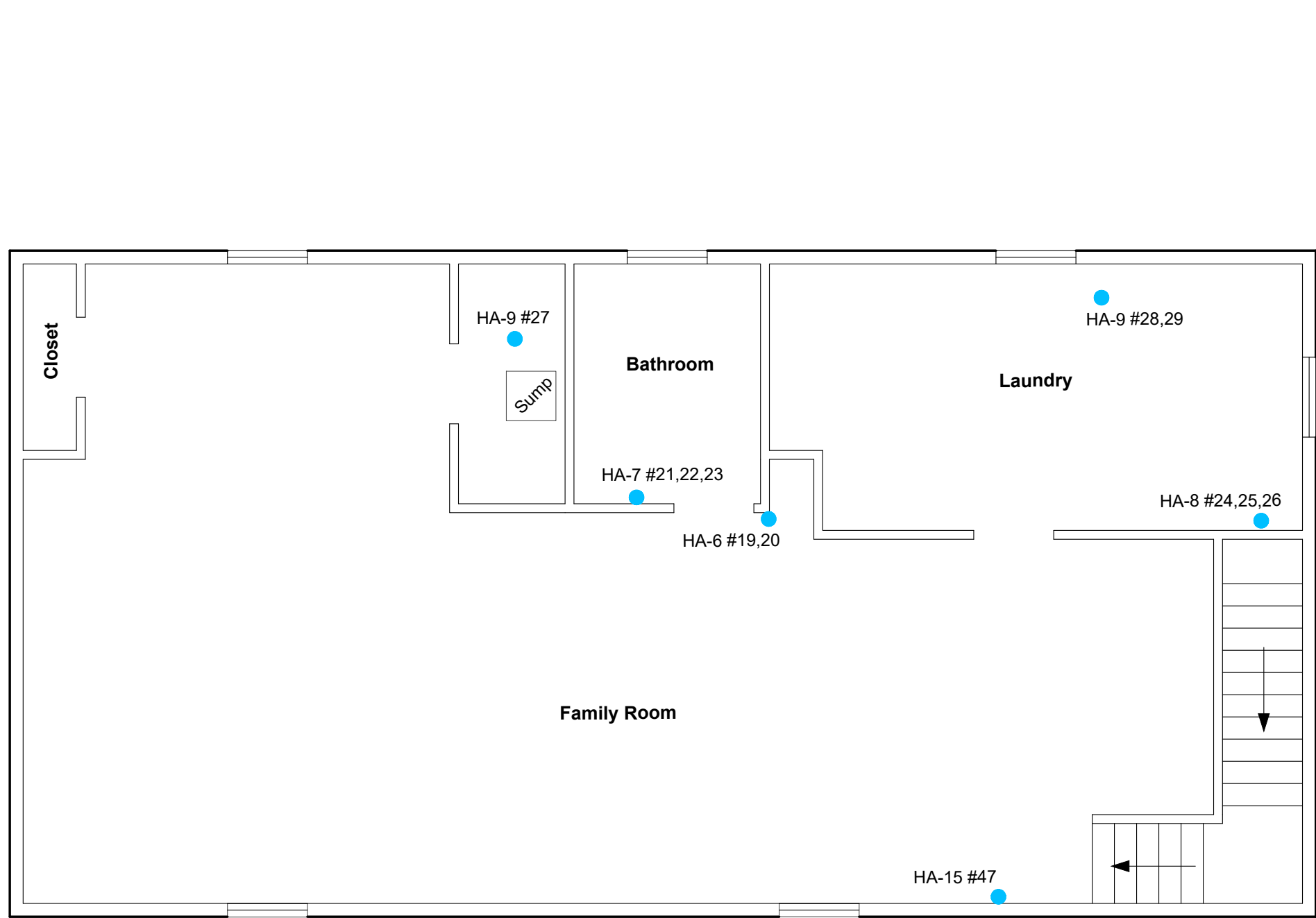

LEGEND

● ASBESTOS SAMPLE

NOTE
BASE MAP DEVELOPED FROM ONSITE INVESTIGATION.

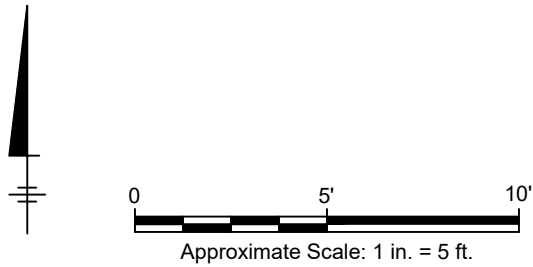

IDOT / Asbestos Surveys WO #036 Job No. R-90-001-21 Route IL 43 0N30002 6439 S Old Harlem Avenue Chicago, Cook County, Illinois ASBESTOS ABATEMENT SURVEY	
SAMPLING LOCATIONS - BASEMENT	
	FIGURE 3

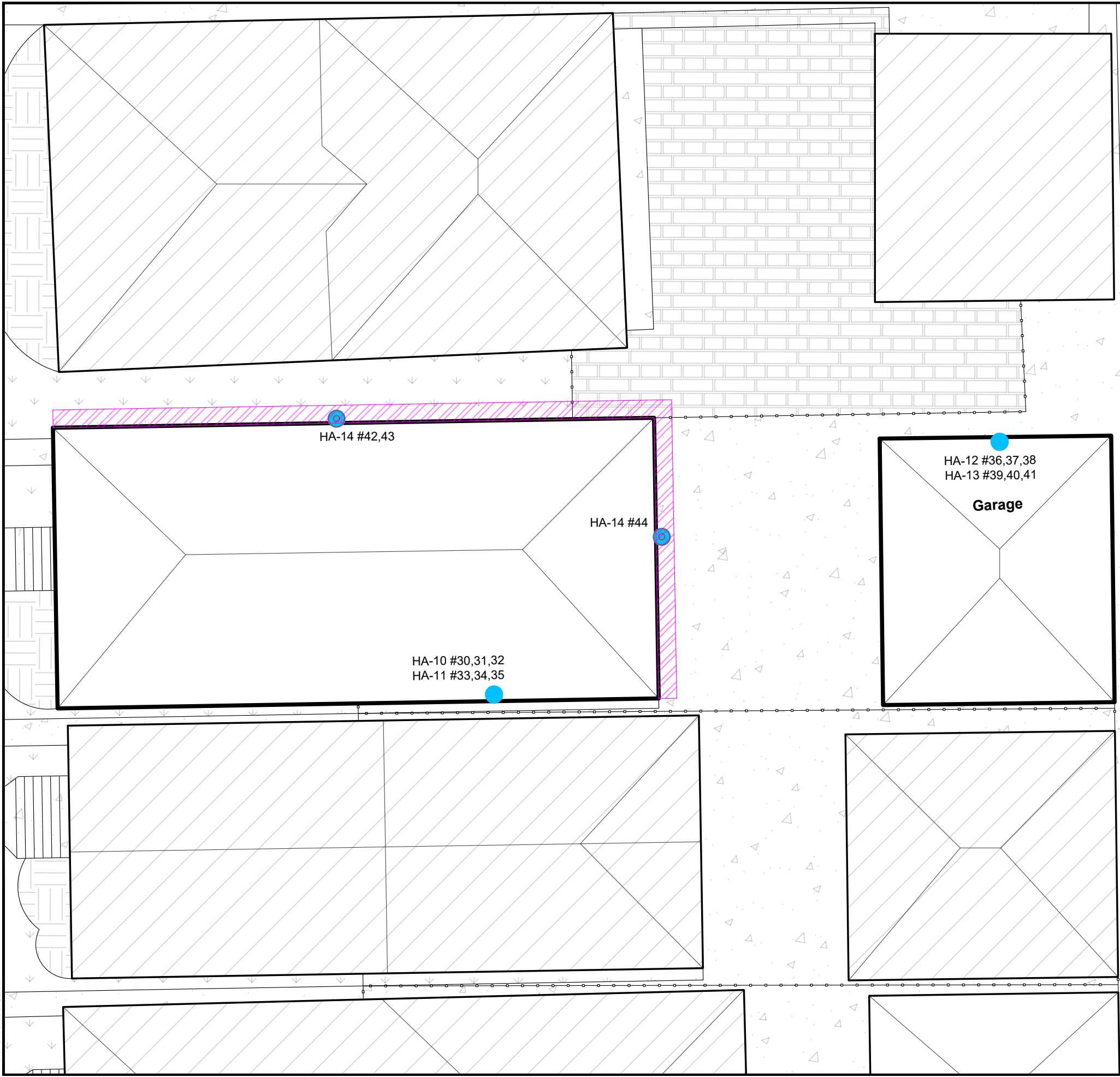

G:\Shared drives\Projects\2025\0154 - Arcadis IDOT Work Order #36\Figures\2025\0154_CAD_Arcadis IDOT Work Order #36\Figures\2025\0154_CAD_Arcadis IDOT Work Order #36\FIGURE 4-18\2025 12:03 PM BY: SARAH CLARK



LEGEND

- ASBESTOS SAMPLE
- POSITIVE SAMPLE
- HA-14: Black Sealant along exterior wall to Concrete Sidewalk

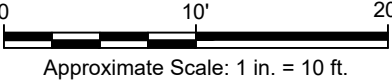
NOTE
BASE MAP DEVELOPED FROM ONSITE INVESTIGATION.



IDOT / Asbestos Surveys WO #036
Job No. R-90-001-21
Route IL 43 0N30002
6439 S Old Harlem Avenue
Chicago, Cook County, Illinois
ASBESTOS ABATEMENT SURVEY

**ASBESTOS CONTAINING MATERIAL
LOCATIONS - EXTERIOR**



FIGURE
4

Appendix A

Limitations and Service Constraints

Limitations and Service Constraints

The opinions, conclusions and recommendations presented in this report are limited to the information obtained during the performance of the specific scope of service identified in the report. To the extent that Arcadis relied upon any information prepared by other parties not under direct contract to Arcadis, no representation as to the accuracy or completeness of such information is made. This report is an instrument of professional service and the services described in the report were performed in accordance with generally accepted standards and level of skill and care ordinarily exercised by members of the profession working under similar conditions including comparable budgetary and schedule constraints. No warranty, guarantee or certification express or implied, is intended or given with respect to Arcadis' services, opinions, conclusions, or recommendations. This statement is in lieu of any other statement either expressed or implied.

Arcadis' observations, the results of testing and Arcadis' opinions, conclusions and recommendations apply solely to conditions existing at the specific times when and specific locations where Arcadis' investigative work was performed. Arcadis affirms that data gathered and presented by Arcadis in this report was collected in an appropriate manner in accordance with generally accepted methods and practices. Arcadis cannot be responsible for decisions made by our client solely on the basis of economic factors. Observation and testing activities such as those conducted by Arcadis are inherently limited and do not represent a conclusive or complete characterization. Arcadis analyzed only the substances, conditions and locations described in the report at the time indicated. Conditions in other parts of the project site, building or area may vary from conditions at the specific locations where observations were made and where testing was performed by Arcadis. Additionally, other building material hazards which were not identified by Arcadis, may also be present in inaccessible areas, including within walls and cavities, above ceilings, and below floors. Therefore, the extent of Arcadis' opinions, conclusions and recommendations are limited and 100% confidence in these opinions, conclusions and recommendations cannot reasonably be achieved. Nothing contained in this report shall relieve any other party of its responsibility to abide by contract documents and applicable laws, codes, regulations, or standards nor shall it be considered medical advice or consultation.

This report is expressly for the sole and exclusive use of the party for whom this report was originally prepared and for the particular purpose outlined in the report. Only the party for whom this report was originally prepared and/or other specifically named parties have the right to make use of and rely upon this report. Reuse of this report or any portion thereof for other than its intended purpose, or if modified, or if used by third parties, shall be at the user's sole risk. This report must be presented in its entirety.

Appendix B

Accreditations

Inspector

Laboratory



525-535 West Jefferson Street • Springfield, Illinois 62761-0001 • www.dph.illinois.gov

PATRICK W HOOK
2025 WOODLANE DR
LINDENHURST, IL 60046

3/11/2024

ASBESTOS PROFESSIONAL LICENSE ID NUMBER: 10967

Enclosed is your Asbestos Professional License. Please note the expiration date on the card and in the image depicted below.

COPY OF THE ASBESTOS PROFESSIONAL LICENSE

Front of License

Back of License

 ASBESTOS PROFESSIONAL LICENSE			ENDORSEMENTS	TC EXPIRES
ID NUMBER	ISSUED	EXPIRES	INSPECTOR	1/12/2025
100 - 10967	3/11/2024	05/15/2025	PROJECT MANAGER	1/13/2025
PATRICK W HOOK 2025 WOODLANE DR LINDENHURST, IL 60046 Environmental Health			Alteration of this license shall result in legal action This license issued under authority of the State of Illinois Department of Public Health This license is valid only when accompanied by a valid training course certificate.	

If you have any questions or need further assistance, contact the Asbestos Program at (217)782-3517 or fax (217)785-5897.

Our WEB address is: dph.illinois.gov/topics-services/environmental-health-protection/asbestos
EMAIL Address: dph.asbestos@illinois.gov



This is to certify that

Paul J. Hoffman

11 Precourt Lane, Norton, MA 02766

MA DLS Asbestos Inspector License# AI061473

*has completed requisite training by Video Conference, and has passed an examination for
reaccreditation as:*

Asbestos Inspector Refresher

pursuant to Title II of the Toxic Substance Control Act, 15 U.S.C. 2646

Course Location

Zoom Video Conference

Institute for Environmental Education 16 Upton Drive Wilmington, MA 01887

June 21, 2024

Course Dates

24-5332-106-213698

Certificate Number

June 21, 2024

Examination Date

June 21, 2025

Expiration Date



Training Director

16 Upton Drive, Wilmington, MA 01887

Telephone 978.658.5272

www.ieetrains.com

INSTITUTE FOR ENVIRONMENTAL EDUCATION

United States Department of Commerce
National Institute of Standards and Technology



Certificate of Accreditation to ISO/IEC 17025:2017

NVLAP LAB CODE: 101202-0

STAT Analysis Corporation
Chicago, IL

*is accredited by the National Voluntary Laboratory Accreditation Program for specific services,
listed on the Scope of Accreditation, for:*

Asbestos Fiber Analysis

*This laboratory is accredited in accordance with the recognized International Standard ISO/IEC 17025:2017.
This accreditation demonstrates technical competence for a defined scope and the operation of a laboratory quality
management system (refer to joint ISO-ILAC-IAF Communiqué on ISO/IEC 17025).*

2024-07-01 through 2025-06-30

Effective Dates



A handwritten signature in blue ink, reading "Dana S. Laman".

For the National Voluntary Laboratory Accreditation Program

SCOPE OF ACCREDITATION TO ISO/IEC 17025:2017

STAT Analysis Corporation

Sterling Labs
2242 W. Harrison St. Suite 200
Chicago, IL 60612
Carolyn Mazzuca
Phone: 312-733-0551
Email: cmazzuca@statanalysis.com

ASBESTOS FIBER ANALYSIS

NVLAP LAB CODE 101202-0

Bulk Asbestos Analysis

Code

Description

18/A01

EPA -- 40 CFR Appendix E to Subpart E of Part 763, Interim Method of the Determination of Asbestos in Bulk Insulation Samples

18/A03

EPA 600/R-93/116: Method for the Determination of Asbestos in Bulk Building Materials

Airborne Asbestos Analysis

Code

Description

18/A02

U.S. EPA's "Interim Transmission Electron Microscopy Analytical Methods-Mandatory and Nonmandatory-and Mandatory Section to Determine Completion of Response Actions" as found in 40 CFR, Part 763, Subpart E, Appendix A.

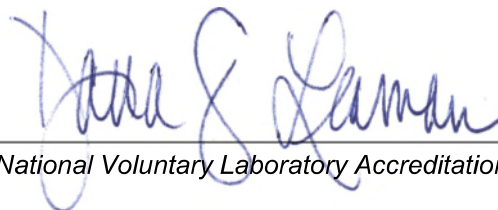

For the National Voluntary Laboratory Accreditation Program

Appendix C

Laboratory Reports

ASBESTOS ANALYSIS BY POLARIZED LIGHT MICROSCOPY

Method: EPA-600/M4-82-020

Arcadis US Inc.
225 W. Wacker Drive, Suite 2015
Chicago, IL 60606
Phone: (312) 575-3718

Reference: 30253552 IDOT Date Received: 03/11/2025
Location: 6439 S Old Harlem Ave Chicago, IL Date Analyzed: 03/17/2025
Batch No.: 374090 Date Reported: 03/17/2025
Customer No.: 2530 Turn Around Time: 5 Days

Laboratory Sample	Customer Sample Number	Asbestos Components (%)	Non-Asbestos Components (%)
374090001	1	ND	Cellulose 1-5% Binder 95-99%
374090002	2	ND	Cellulose 1-5% Binder 95-99%
374090003	3	ND	Cellulose 1-5% Binder 95-99%
374090004	1G	ND	Cellulose 1-5% Binder 95-99%
374090005	2G	ND	Cellulose 1-5% Binder 95-99%
374090006	3G	ND	Cellulose 1-5% Binder 95-99%
374090007	4	ND	Cellulose 1-5% Binder 95-99%
374090008	5	ND	Cellulose 1-5% Binder 95-99%
374090009	6	ND	Cellulose 1-5% Binder 95-99%
374090010	4G	ND	Cellulose 1-5% Binder 95-99%

ND = Asbestos Not Detected (Not Present) NA = Not Analyzed NS = Not Submitted

Components of inhomogeneous samples are analyzed per our Standard Operating Procedure, or per customer request.

The use of the NVLAP logo does not imply endorsement by NVLAP or any agency of the US Government.

The information contained in this report and any attachments is confidential information intended only for the use of the individual or entities named above. The results of this report relate only to the samples tested. If you have received this report in error, please notify us immediately by phone. This report shall not be reproduced, except in its entirety, unless written approval has been obtained from the laboratory. This report remains property of STAT Analysis until payment is received in full (see invoice).

Analyzed by Name : 
Daniel Mikos / Microscopist

Date: 03/17/2025

ASBESTOS ANALYSIS BY POLARIZED LIGHT MICROSCOPY

Method: EPA-600/M4-82-020

Arcadis US Inc.
225 W. Wacker Drive, Suite 2015
Chicago, IL 60606
Phone: (312) 575-3718

Reference: 30253552 IDOT Date Received: 03/11/2025
Location: 6439 S Old Harlem Ave Chicago, IL Date Analyzed: 03/17/2025
Batch No.: 374090 Date Reported: 03/17/2025
Customer No.: 2530 Turn Around Time: 5 Days

Laboratory Sample	Customer Sample Number	Asbestos Components (%)	Non-Asbestos Components (%)
374090011	5G	ND	Cellulose 1-5% Binder 95-99%
374090012	6G	ND	Cellulose 1-5% Binder 95-99%
374090013	7	ND	Cellulose 1-5% Binder 95-99%
374090014	8	ND	Cellulose 1-5% Binder 95-99%
374090015	9	ND	Cellulose 1-5% Binder 95-99%
374090016	7G	ND	Cellulose 1-5% Binder 95-99%
374090017	8G	ND	Cellulose 1-5% Binder 95-99%
374090018	9G	ND	Cellulose 1-5% Binder 95-99%
374090019	10	ND	Cellulose 1-5% Binder 95-99%
374090020	11	ND	Cellulose 1-5% Binder 95-99%

ND = Asbestos Not Detected (Not Present) NA = Not Analyzed NS = Not Submitted

Components of inhomogeneous samples are analyzed per our Standard Operating Procedure, or per customer request.

The use of the NVLAP logo does not imply endorsement by NVLAP or any agency of the US Government.

The information contained in this report and any attachments is confidential information intended only for the use of the individual or entities named above. The results of this report relate only to the samples tested. If you have received this report in error, please notify us immediately by phone. This report shall not be reproduced, except in its entirety, unless written approval has been obtained from the laboratory. This report remains property of STAT Analysis until payment is received in full (see invoice).

Analyzed by Name :

Daniel Mikos / Microscopist

Date: 03/17/2025

ASBESTOS ANALYSIS BY POLARIZED LIGHT MICROSCOPY

Method: EPA-600/M4-82-020

Arcadis US Inc.
225 W. Wacker Drive, Suite 2015
Chicago, IL 60606
Phone: (312) 575-3718

Reference: 30253552 IDOT
Location: 6439 S Old Harlem Ave Chicago, IL
Batch No.: 374090
Customer No.: 2530
Date Received: 03/11/2025
Date Analyzed: 03/17/2025
Date Reported: 03/17/2025
Turn Around Time: 5 Days

Laboratory Sample	Customer Sample Number	Asbestos Components (%)	Non-Asbestos Components (%)
374090021	12	ND	Cellulose 1-5% Binder 95-99%
374090022	10G	ND	Cellulose 1-5% Binder 95-99%
374090023	11G	ND	Cellulose 1-5% Binder 95-99%
374090024	12G	ND	Cellulose 1-5% Binder 95-99%
374090025	13	ND	Cellulose 1-5% Binder 95-99%
374090026	14	ND	Cellulose 1-5% Binder 95-99%
374090027	15	ND	Cellulose 1-5% Binder 95-99%
374090028	13G	ND	Cellulose 1-5% Binder 95-99%
374090029	14G	ND	Cellulose 1-5% Binder 95-99%
374090030	15G	ND	Cellulose 1-5% Binder 95-99%

ND = Asbestos Not Detected (Not Present) NA = Not Analyzed NS = Not Submitted

Components of inhomogeneous samples are analyzed per our Standard Operating Procedure, or per customer request.

The use of the NVLAP logo does not imply endorsement by NVLAP or any agency of the US Government.

The information contained in this report and any attachments is confidential information intended only for the use of the individual or entities named above. The results of this report relate only to the samples tested. If you have received this report in error, please notify us immediately by phone. This report shall not be reproduced, except in its entirety, unless written approval has been obtained from the laboratory. This report remains property of STAT Analysis until payment is received in full (see invoice).

ASBESTOS ANALYSIS BY POLARIZED LIGHT MICROSCOPY

Method: EPA-600/M4-82-020

Arcadis US Inc.
225 W. Wacker Drive, Suite 2015
Chicago, IL 60606
Phone: (312) 575-3718

Reference: 30253552 IDOT Date Received: 03/11/2025
Location: 6439 S Old Harlem Ave Chicago, IL Date Analyzed: 03/17/2025
Batch No.: 374090 Date Reported: 03/17/2025
Customer No.: 2530 Turn Around Time: 5 Days

Laboratory Sample	Customer Sample Number	Asbestos Components (%)	Non-Asbestos Components (%)
374090031	16	ND	Cellulose 1-5% Binder 95-99%
374090032	17	ND	Cellulose 1-5% Binder 95-99%
374090033	18	ND	Cellulose 1-5% Binder 95-99%
374090034	19	ND	Cellulose 1-5% Binder 95-99%
374090035	20	ND	Cellulose 1-5% Binder 95-99%
374090036	21	ND	Cellulose 1-5% Binder 95-99%
374090037	22	ND	Cellulose 1-5% Binder 95-99%
374090038	23	ND	Cellulose 1-5% Binder 95-99%
374090039	21G	ND	Cellulose 1-5% Binder 95-99%
374090040	22G	ND	Cellulose 1-5% Binder 95-99%

ND = Asbestos Not Detected (Not Present) NA = Not Analyzed NS = Not Submitted

Components of inhomogeneous samples are analyzed per our Standard Operating Procedure, or per customer request.

The use of the NVLAP logo does not imply endorsement by NVLAP or any agency of the US Government.

The information contained in this report and any attachments is confidential information intended only for the use of the individual or entities named above. The results of this report relate only to the samples tested. If you have received this report in error, please notify us immediately by phone. This report shall not be reproduced, except in its entirety, unless written approval has been obtained from the laboratory. This report remains property of STAT Analysis until payment is received in full (see invoice).

Analyzed by Name : 
Daniel Mikos / Microscopist

ASBESTOS ANALYSIS BY POLARIZED LIGHT MICROSCOPY

Method: EPA-600/M4-82-020

Arcadis US Inc.
225 W. Wacker Drive, Suite 2015
Chicago, IL 60606
Phone: (312) 575-3718

Reference: 30253552 IDOT Date Received: 03/11/2025
Location: 6439 S Old Harlem Ave Chicago, IL Date Analyzed: 03/17/2025
Batch No.: 374090 Date Reported: 03/17/2025
Customer No.: 2530 Turn Around Time: 5 Days

Laboratory Sample	Customer Sample Number	Asbestos Components (%)	Non-Asbestos Components (%)
374090041	23G	ND	Cellulose 1-5% Binder 95-99%
374090042	24	ND	Cellulose 1-5% Binder 95-99%
374090043	25	ND	Cellulose 1-5% Binder 95-99%
374090044	26	ND	Cellulose 1-5% Binder 95-99%
374090045	24M	ND	Cellulose 1-5% Binder 95-99%
374090046	25M	ND	Cellulose 1-5% Binder 95-99%
374090047	26M	ND	Cellulose 1-5% Binder 95-99%
374090048	27	ND	Cellulose 1-5% Binder 95-99%
374090049	28	ND	Cellulose 1-5% Binder 95-99%
374090050	29	ND	Cellulose 1-5% Binder 95-99%

ND = Asbestos Not Detected (Not Present) NA = Not Analyzed NS = Not Submitted

Components of inhomogeneous samples are analyzed per our Standard Operating Procedure, or per customer request.

The use of the NVLAP logo does not imply endorsement by NVLAP or any agency of the US Government.

The information contained in this report and any attachments is confidential information intended only for the use of the individual or entities named above. The results of this report relate only to the samples tested. If you have received this report in error, please notify us immediately by phone. This report shall not be reproduced, except in its entirety, unless written approval has been obtained from the laboratory. This report remains property of STAT Analysis until payment is received in full (see invoice).

Analyzed by Name :

Daniel Mikos / Microscopist

Date: 03/17/2025

ASBESTOS ANALYSIS BY POLARIZED LIGHT MICROSCOPY

Method: EPA-600/M4-82-020

Arcadis US Inc.
225 W. Wacker Drive, Suite 2015
Chicago, IL 60606
Phone: (312) 575-3718

Reference: 30253552 IDOT Date Received: 03/11/2025
Location: 6439 S Old Harlem Ave Chicago, IL Date Analyzed: 03/17/2025
Batch No.: 374090 Date Reported: 03/17/2025
Customer No.: 2530 Turn Around Time: 5 Days

Laboratory Sample	Customer Sample Number	Asbestos Components (%)	Non-Asbestos Components (%)
374090051	30	ND	Binder 85-90% Glass 10-15%
374090052	31	ND	Binder 85-90% Glass 10-15%
374090053	32	ND	Binder 85-90% Glass 10-15%
374090054	33	ND	Cellulose 60-65% Binder 35-40%
374090055	34	ND	Cellulose 60-65% Binder 35-40%
374090056	35	ND	Cellulose 60-65% Binder 35-40%
374090057	36	ND	Cellulose 10-15% Binder 85-90%
374090058	37	ND	Cellulose 10-15% Binder 85-90%
374090059	38	ND	Cellulose 10-15% Binder 85-90%
374090060	39	ND	Cellulose 60-65% Binder 35-40%

ND = Asbestos Not Detected (Not Present) NA = Not Analyzed NS = Not Submitted

Components of inhomogeneous samples are analyzed per our Standard Operating Procedure, or per customer request.

The use of the NVLAP logo does not imply endorsement by NVLAP or any agency of the US Government.

The information contained in this report and any attachments is confidential information intended only for the use of the individual or entities named above. The results of this report relate only to the samples tested. If you have received this report in error, please notify us immediately by phone. This report shall not be reproduced, except in its entirety, unless written approval has been obtained from the laboratory. This report remains property of STAT Analysis until payment is received in full (see invoice).

Analyzed by Name : 
Daniel Mikos / Microscopist

ASBESTOS ANALYSIS BY POLARIZED LIGHT MICROSCOPY

Method: EPA-600/M4-82-020

Arcadis US Inc.
225 W. Wacker Drive, Suite 2015
Chicago, IL 60606
Phone: (312) 575-3718

Reference: 30253552 IDOT Date Received: 03/11/2025
Location: 6439 S Old Harlem Ave Chicago, IL Date Analyzed: 03/17/2025
Batch No.: 374090 Date Reported: 03/17/2025
Customer No.: 2530 Turn Around Time: 5 Days

Laboratory Sample	Customer Sample Number	Asbestos Components (%)	Non-Asbestos Components (%)
374090061	40	ND	Cellulose 60-65% Binder 35-40%
374090062	41	ND	Cellulose 60-65% Binder 35-40%
374090063	42	Chrysotile 1-5%	Binder 95-99%
374090064	43	Chrysotile 1-5%	Binder 95-99%
374090065	44	Chrysotile 1-5%	Binder 95-99%

ND = Asbestos Not Detected (Not Present) NA = Not Analyzed NS = Not Submitted

Components of inhomogeneous samples are analyzed per our Standard Operating Procedure, or per customer request.

The use of the NVLAP logo does not imply endorsement by NVLAP or any agency of the US Government.

The information contained in this report and any attachments is confidential information intended only for the use of the individual or entities named above. The results of this report relate only to the samples tested. If you have received this report in error, please notify us immediately by phone. This report shall not be reproduced, except in its entirety, unless written approval has been obtained from the laboratory. This report remains property of STAT Analysis until payment is received in full (see invoice).

Analyzed by Name :

Daniel Mikos / Microscopist

Date: 03/17/2025



2242 W. Harrison, Suite 200, Chicago, Illinois 60612 Phone: (312) 733-0551 Fax: (312) 733-2386
e-mail address: info@thesterlinglab.com

Page : 1 of 5

Comments: SITE ADDRESS 6439 S OLD HARLEM AVE CHICAGO, IL
44 SAMPLES

Client:

IDOT

 Building/Site No.: 6439
 Address: 6439 SOLD
HARLEM AVE CHICAGO IL

 Project No.: 30253552
 Survey Date: 3/7/2025
 Inspector: PATRICK HOOK

 Rec. J 1/22 3/11/25 9:21
ARCADIS 374090
 for natural and built assets

HA	Sample Number	Material Type (Circle)	Color Texture	Material Description	Floor: B,1,Mezz, Ext,Roof	Sample Location	Condition G, D, SD	Friable Y / N	Quantity SF, LF, EA	Photo
1	1	(M) S, TSI	TAN	TAN 12"X12"	1	KITCHEN - 1 ST FLOOR	G	N	400 SF	
	2	Location:	FLR	CERAMIC	1	DINING RM - 1 ST FLR	↓	↓	↓	
	3	Ceiling, Wall, Floor, Roof, Multiple, Shaftway, Other	(Floor) Roof	F.T, THINSET AND GROUT	1	HALLWAY - 1 ST FLR	↓	↓	↓	
Mat. Location/QTY:										
Notes:										
2	4	(M) S, TSI	WHITE	WHITE 8"X8"	1	BATH ROOM - 1 ST FLR	G	N	40 SF	
	5	Location:	FLR	CERAMIC	1	↓	↓	↓		
	6	Ceiling, Wall, Floor, Roof, Multiple, Shaftway, Other	(Floor) Roof	FT-THINSET AND GROUT	1	↓	↓	↓		
Mat. Location/QTY:										
Notes:										
3	7	(M) S, TSI	TAN	TAN 8"X12"	1	BATH ROOM - 1 ST FLR	G	N	60 SF	
	8	Location:	WALL	CERAMIC	1	↓	↓	↓		
	9	Ceiling, Wall, Floor, Roof, Multiple, Shaftway, Other	(Wall) Floor, Roof	MASTIC + GROUT	1	↓	↓	↓		
Mat. Location/QTY:										
Notes:										
4	10	(M) S, TSI	TAN	TAN 12"X12"	1	FRONT ENTRANCE - 1 ST FLR	G	N	12 SF	
	11	Location:	FLR	CERAMIC	1	↓	↓	↓		
	12	Ceiling, Wall, Floor, Roof, Multiple, Shaftway, Other	(Floor) Roof	FLR TILE THINSET + GROUT	1	↓	↓	↓		
Mat. Location/QTY:										
Notes:										

Client:

IDOT

Building/Site No.:

6439

Address: 6439 SOLD HARLEM
AVE CHICAGO, IL

Project No.:

30253552

Survey Date:

3/7/2025

Inspector:

PATRICK HOOK

Rec. J 122 3/11/25 9:21



ARCADIS

for natural and
built assets

374090

HA	Sample Number	Material Type (Circle)	Color Texture	Material Description	Floor: B, I, Mezz, Ext, Roof	Sample Location	Condition G, D, SD	Friable Y/N	Quantity SF, LF, EA	Photo
5	13	(M) S, TSI	BROWN	BROWN 2"x2"	1	KITCHEN BACKSPASH - 1 ST FL	G	N	60 SF	
	14	Location: WALL		2"x4" STONE	1					
	15	Ceiling, Wall, Floor, Roof, Multiple, Shaftway, Other		BACKSPASH THINSET + GROUT	1					
Mat. Location/QTY:										
Notes:										
6	16	(M) S, TSI	WHITE	WHITE	1	KITCHEN WALL 1 ST FLOOR	G	Y	3,000	
	17	Location: GEN		JOINT	1	HALLWAY WALL				
	18	Ceiling, Wall, Floor, Roof, Multiple, Shaftway, Other		COMPOUND ON WALLS + FLOORS	1	LIVING RM WALL				
	19				B	FAMILY RM - BASEMENT				
Mat. Locat	20				B	FAMILY RM (CEILING)				
Notes:										
7	21	(M) S, TSI	BROWN	BROWN 12"x12"	B	BATHROOM - BASEMENT	G	Y	120 SF	
	22	Location: WALL		WALL BACKSPASH	B	FLRS/WALLS				
	23	Ceiling, Wall, Floor, Roof, Multiple, Shaftway, Other		THINSET + GROUT	B					
Mat. Location/QTY:										
Notes:										
8	24	(M) S, TSI	TAN	TAN 12"x12"	B	BASEMENT UNDER STAIRS	G	N	30 SF	
	25	Location: FLR		VINYL F.T. +	B					
	26	Ceiling, Wall, Floor, Roof, Multiple, Shaftway, Other		YELLOW MASTIC	B					
Mat. Location/QTY:										
Notes:										

Client:

IDOT

Building/Site No.:

6439
6439 SOLD HARLEM
AVE CHICAGO, IL

Project No.:

Survey Date:

Inspector:

30253552

3/7/2025

PATRICK HOOK

Rec'd J A L 3/11/25 9:21



ARCADIS

for natural and
built assets

374090

HA	Sample Number	Material Type (Circle)	Color Texture	Material Description	Floor: B,1,Mezz, Ext,Roof	Sample Location	Condition (G, SD)	Friable Y/N	Quantity SF, LF, EA	Photo
9	27	(M)S, TSI	GRAY	CONCRETE	B	BASEMENT - SUMP PUMP RM	G	N	1,000	
	28	Location:	BASE	FOUNDATION	B	↓ - LAUNDRY RM	↓	↓	↓	
	29	Ceiling, (Wall, Floor) Roof,		FLR + WALL	B	↓ ↓ ↓	↓	↓	↓	
		Multiple, Shaftway, Other								

Mat. Location/QTY:

Notes:

10	30	(M)S, TSI	BLACK	BLACK	ROOF	MAIN HOUSE - SOUTH SIDE ROOF	G	N	1,000	
	31	Location:	ROOF	ASPHALT	↓	↓	↓	↓	↓	
	32	Ceiling, Wall, Floor, (Roof)		ROOF SHINGLE	↓	↓	↓	↓	↓	
		Multiple, Shaftway, Other								

Mat. Location/QTY:

Notes:

11	33	(M)S, TSI	BLACK	BLACK TAR	ROOF	MAIN HOUSE - SOUTH SIDE RF	G	N	1,000	
	34	Location:	ROOF	PAPER	↓	↓	↓	↓	↓	
	35	Ceiling, Wall, Floor, (Roof)		UNDER	↓	↓	↓	↓	↓	
		Multiple, Shaftway, Other		HA-10						

Mat. Location/QTY:

Notes:

12	36	(M)S, TSI	BROWN	BROWN	ROOF	GARAGE - NORTH SIDE ROOF	G	N	280 SF	
	37	Location:	ROOF	ASPHALT	↓	↓	↓	↓	↓	
	38	Ceiling, Wall, Floor, (Roof)		ROOF	↓	↓	↓	↓	↓	
		Multiple, Shaftway, Other		SHINGLE						

Mat. Location/QTY:

Notes:

Client:

IDOT

Building/Site No.:

6439
Address: 6439 S OLD HARLEM
AVE

Project No.:

Survey Date:

Inspector:

30253552

3/7/2025

PATRICK HOOK

Revised 3/11/25 9:21

ARCADIS

for natural and
built assets

374090

HA	Sample Number	Material Type (Circle)	Color Texture	Material Description	Floor: B,1,Mezz, Ext,Roof	Sample Location	Condition G, D, SD	Friable Y/N	Quantity SF, LF, EA	Photo
13	39	(M, S, TSI)	BLACK	BLACK TAR	ROOF	GARAGE ROOF - NORTH SIDE	G	Y	280 SF	
	40	Location:	ROOF	PAPER	↓	↓	↓	↓	↓	
	41	Ceiling, Wall, Floor, Roof	(HA-12)	UNDER	↓	↓	↓	↓	↓	
		Multiple, Shaftway, Other								

Mat. Location/QTY:

Notes:

14	42	(M, S, TSI)	BLACK	BLACK SEALANT	EXT	SIDEWALK TO	NORTH	G	Y	100 LF	
	43	Location:	W/G	ALONG EXT	↓	EXT BRICK FOUNDATION	NORTH	↓	↓	↓	
	44	Ceiling, Wall, Floor, Roof		WALL TO	↓	WALL	EAST	↓	↓	↓	
		Multiple, Shaftway, Other		CONCRETE							
				SIDE WALK							

Mat. Location/QTY:

Notes:

		M, S, TSI									
		Location:									
		Ceiling, Wall, Floor, Roof									
		Multiple, Shaftway, Other									

Mat. Location/QTY:

Notes:

		M, S, TSI									
		Location:									
		Ceiling, Wall, Floor, Roof									
		Multiple, Shaftway, Other									

Mat. Location/QTY:

Notes:

ASBESTOS ANALYSIS BY POLARIZED LIGHT MICROSCOPY

Method: EPA/600/R-93/116

Arcadis US Inc.
225 W. Wacker Drive, Suite 2015
Chicago, IL 60606
Phone: (312) 575-3718

Reference: 30253552 Date Received: 04/17/2025
Location: 6439 S. Old Harlem Avenue, Chicago, IL Date Analyzed: 04/22/2025
Batch No.: 374529 Date Reported: 04/22/2025
Customer No.: 2530 Turn Around Time: 3 Days

Laboratory Sample	Customer Sample Number	Asbestos Components (%)	Non-Asbestos Components (%)
374529001	15-45	ND	Cellulose 5-10% Binder 90-95%
374529002	15-46	ND	Cellulose 5-10% Binder 90-95%
374529003	15-47	ND	Cellulose 5-10% Binder 90-95%

ND = Asbestos Not Detected (Not Present) NA = Not Analyzed NS = Not Submitted

Components of inhomogeneous samples are analyzed per our Standard Operating Procedure, or per customer request.

The use of the NVLAP logo does not imply endorsement by NVLAP or any agency of the US Government.

The information contained in this report and any attachments is confidential information intended only for the use of the individual or entities named above. The results of this report relate only to the samples tested. If you have received this report in error, please notify us immediately by phone. This report shall not be reproduced, except in its entirety, unless written approval has been obtained from the laboratory. This report remains property of STAT Analysis until payment is received in full (see invoice).

Analyzed by Name :

Zineb Nasri / Microscopist

Date: 04/22/2025

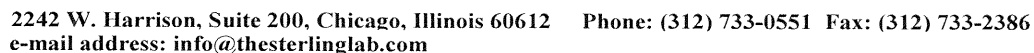

Page : 1 of 1

Comments: Email results to brendan.quealy@arcadis.com

Appendix D

Photo Log



Exterior of Building – Front



HA-1: 12" x 12" Tan Ceramic Floor Tile Thin Set and Grout



HA-2: 8" x 8" White Ceramic Floor Tile Thin Set and Grout



HA-3: Tan 8" x 12" Ceramic Wall Tile Grout and Mastic



HA-4: Tan 12" x 12" Ceramic Floor Tile Thin Set and Grout



HA-5: Brown 2" x 2" / 2" x 4" Stone Backsplash Thin Set and Grout



**HA-6: White Joint Compound
HA-15: Gypsum Board**



HA-7: Brown 12" x 12" Backsplash Thin Set and Grout



**HA-8: Tan 12" x 12" Vinyl Floor Tile and Yellow Mastic
HA-9: Concrete Foundation Floor and Wall**



**HA-10: Black Asphalt Roof Shingle
HA-11: Black Tar Paper under HA-10**



**HA-12: Brown Asphalt Roof Shingle
HA-13: Black Tar Paper under HA-12**



HA-14: Black Sealant Along Exterior Wall to Concrete Sidewalk

Arcadis U.S., Inc.
225 West Wacker Drive
Suite 2015
Chicago, Illinois 60606
Phone: 312 917 1000
www.arcadis.com