

Illinois Department of Transportation

Asbestos Abatement Survey

Work Order No.: 36

Job Order No.: R-90-001-21

Route: IL 43

Parcel No.: 0N30003

6443 S. Old Harlem Avenue

Chicago, Cook County, IL 60638

June 18, 2025

Asbestos Abatement Survey

Work Order No.: 36

Job Order No.: R-90-001-21

Route: IL 43

Parcel No.: 0N30003

6443 S. Old Harlem Avenue

Chicago, Cook County, IL 60638

June 18, 2025

Prepared By:

Arcadis U.S., Inc.
225 West Wacker Drive
Suite 2015
Chicago, Illinois 60606
Phone: 312 917 1000

Prepared For:

Illinois Department of Transportation
2300 South Dirksen Parkway
Springfield, IL 62764

Our Ref:

30253552



Paul Hoffman
Industrial Hygiene Specialist



Katherine Challberg
Senior Environmental Engineer / QA/QC

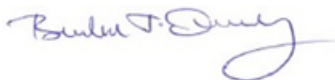

Brendan J. Quealy
Principal Environmental Engineer/Certified Project Manager

This document is intended only for the use of the individual or entity for which it was prepared and may contain information that is privileged, confidential and exempt from disclosure under applicable law. Any dissemination, distribution or copying of this document is strictly prohibited.

Contents

Acronyms and Abbreviations.....	ii
1 Introduction.....	1
2 Survey Methodology	1
3 Analytical Methods.....	2
4 Findings.....	2
5 Recommendations.....	2
6 Cost Estimate.....	3
7 Additional Survey Limitations.....	4

Tables

Table 1	Asbestos Homogeneous Areas Summary
----------------	---

Figures

Figures 1-3	Asbestos Bulk Sampling Locations
--------------------	---

Appendices

Appendix A	Limitations and Service Constraints
Appendix B	Accreditations - Inspector, Laboratory
Appendix C	Laboratory Reports – Asbestos
Appendix D	Photograph Log

Acronyms and Abbreviations

ACM	asbestos-containing material
AHERA	Asbestos Hazard Emergency Response Act
Arcadis	Arcadis U.S., Inc.
ASTM	ASTM International
CFR	Code of Federal Regulations
COC	chain of custody
DS	dispersion staining
HA	homogeneous area
IAC	Illinois Administrative Code
IDPH	Illinois Department of Public Health
IDOT	Illinois Department of Transportation
IEPA	Illinois Environmental Protection Agency
NESHAP	National Emissions Standards for Hazardous Air Pollutant
NIOSH	National Institute for Occupational Safety and Health
NVLAP	National Voluntary Laboratory Accreditation Program
OSHA	Occupational Safety and Health Administration
PLM	polarized light microscopy
PPE	personal protective equipment
QA/QC	quality control/quality assurance
STAT	STAT Analysis Corporation of Chicago, Illinois
USEPA	United States Environmental Protection Agency

1 Introduction

Arcadis U.S., Inc. (Arcadis) conducted an asbestos abatement survey (survey) at Parcel No. 0N30003 located at 6443 S. Old Harlem Avenue, Chicago, Cook County, Illinois (Site) in accordance with Work Order No. 36 under the Prime Agreement for Consulting Services for PTB No. 202-043 between Illinois Department of Transportation (IDOT) and Arcadis. Arcadis' services and report are subject to the Limitations and Service Constraints provided in **Appendix A**.

The Site is improved with a split-level residential building with a lower level and partially finished sub-basement, constructed in 1992, and covering approximately 1,200 SF above grade. A two-car detached garage is also present.

The objective of the survey was to ascertain the general presence, quantity, and location of asbestos-containing materials (ACMs) at the site that may be impacted by the planned demolition and provide preliminary cost estimates for asbestos abatement that may be required prior to demolition activities.

The survey activities were conducted on March 4, 2025, by Paul Hoffman of Arcadis U.S., Inc. and Patrick Hook of A3 Environmental LLC. (A3E), an Arcadis sub-consultant. Mr. Hook collected additional samples on April 17, 2025. Copies of their accreditations are provided in **Appendix B**.

2 Survey Methodology

Arcadis conducted the asbestos survey in compliance with the United States Environmental Protection Agency (USEPA) National Emissions Standards for Hazardous Air Pollutants (NESHAPs), applicable State of Illinois and local asbestos regulations. This was accomplished by conducting a visual inspection of the structures to be impacted by the planned demolition and collecting samples of suspect ACM based on these observations. Arcadis conducted the asbestos survey in general accordance with ASTM International (ASTM) E2356 Standard Practice for Comprehensive Building Asbestos Surveys. ASTM E2356 meets the applicable asbestos survey and/or sampling requirements of current USEPA NESHAP Standard [40 Code of Federal Regulations (CFR) 61, Subpart M (Asbestos)], USEPA Asbestos Hazard Emergency Response Act (AHERA) [40 CFR 763, Subpart E], and Occupational Safety and Health Administration (OSHA) Asbestos Construction Standard [29 CFR 1926.1101].

The survey included an inspection of the structures to be impacted by the planned demolition providing a general sense of the overall location, type, quantity, and condition of suspect ACMs present. The asbestos survey included a visual and physical assessment of each accessible space to locate suspect ACMs. Suspect materials were divided into "Homogeneous Areas" (HAs) (i.e., materials that were determined by the inspector to be homogeneous based on their color, texture, and assumed date of installation).

A representative number of samples were collected from each HA. Bulk material samples were collected in 4-milliliter plastic bags and tightly sealed for transport to STAT Analysis Corporation (STAT) in Chicago, Illinois. Each sample collected by Arcadis was assigned its own unique coded number and sent for laboratory analysis under a chain-of-custody (COC) protocol.

The survey included destructive, intrusive, and/or exploratory testing unless specifically prohibited by IDOT. Destructive sampling is performed in order to identify materials which are hidden or obstructed. Hidden or obstructed areas include but are not limited to wall cavities, pipe chases, spaces above fixed ceilings, materials located under carpeting or subfloors, and ceramic tile grout/adhesive.

3 Analytical Methods

Asbestos bulk samples were analyzed for asbestos (reported in percent of type of asbestos) using polarized light microscopy with dispersion staining (PLM/DS) in accordance with the USEPA Method 600/R-93/116. Percentage estimates of each material's composition are based on the analyst's best visual judgment following PLM/DS analysis, and examination with a stereoscope.

STAT is accredited under the National Voluntary Laboratory Accreditation Program (NVLAP). A copy of their accreditation is provided in **Appendix B**. Laboratory analytical reports are provided in **Appendix C**.

4 Findings

Arcadis identified 14 HAs from which 43 samples were collected and analyzed. A listing of the identified HAs, including each HA material description, location, sample number, condition, asbestos content, and estimated quantity, are presented in Table 1. Approximate sampling locations are shown on Figures 1-3.

The USEPA defines ACM as a material containing greater than 1% asbestos. Materials containing less than 1% asbestos are not regulated by the USEPA or the State of Illinois, but their disturbance is regulated by OSHA.

No HAs were identified as assumed ACM.

The samples collected by Arcadis as part of the survey were reported by the laboratory to be ND = Asbestos Not Detected (Not Present).

Representative photographs are provided in **Appendix D**.

5 Recommendations

ACMs identified at the site that may be disturbed during demolition activities, must be removed by a licensed asbestos abatement contractor utilizing industry standard work procedures in accordance with all federal, state, and local regulations governing asbestos.

If other suspect materials not referenced in this survey report are identified during demolition activities, we recommend these materials be assumed ACM until the materials are inspected by a licensed asbestos inspector, sampled, and submitted for laboratory analysis.

6 Cost Estimate

Arcadis prepared this rough order of magnitude (ROM) opinion of cost to support planned asbestos abatement activities at the Site prior to building demolition.

ROUGH ORDER OF MAGNITUDE OPINION OF ASBESTOS ABATEMENT COSTS		
ASBESTOS ABATEMENT COSTS		
Item	Estimated Cost	Estimated Duration (Days)
Removal/disposal of identified ACM	N/A	N/A
Removal/disposal of assumed ACM	N/A	N/A
Sub-Total Estimated Abatement Costs	N/A	N/A
Contingency (15%)	N/A	N/A
Total Estimated Abatement Costs	N/A	N/A
ASBESTOS OVERSIGHT COSTS		
Item	Estimated Cost	Estimated Duration (Days)
Project Management/Coordination/Reporting	N/A	N/A
ACM Abatement Oversight (including equipment and analysis)	N/A	N/A
Sub-Total Estimated Oversight Costs	N/A	N/A
Contingency (15%)	N/A	N/A
Total Estimated Oversight Costs	N/A	N/A
TOTAL ESTIMATED PROJECT COST (WITH 15% CONTINGENCY)	N/A	N/A

The above ROM opinion of cost is based on the following assumptions:

- Cost estimate is based on the information identified in Arcadis' survey report.
- Cost estimate includes permits, labor, equipment, waste transport and disposal.
- Cost estimate assumes work will be awarded in its entirety to one contractor and completed during a single mobilization.
- Cost estimate includes consulting fees such as project management, project oversight, air sampling, etc.
- Actual bids and schedule durations may vary.
- Oversight costs are dependent upon the project duration which may vary depending on the contractor's schedule and is outside of Arcadis' control.

7 Additional Survey Limitations

Arcadis' survey is subject to the following survey limitations.

- The investigation did not include access or inspection of confined spaces, underground piping, conduits, and building footings, if any.
- If other suspect materials, not referenced in this survey report, are identified during renovation or demolition activities, Arcadis recommends that these materials be considered regulated until they are inspected by an appropriately certified inspector and proven otherwise.
- Utilities/services, including electric, water, and heat, were active in most areas surveyed. Materials associated with electrical components and energized equipment were not safely accessible and were not sampled.

Table

Table 1. Asbestos Homogeneous Areas Summary
IDOT - Asbestos Abatement Survey
WO # 36
6443 S Old Harlem Avenue, Chicago, Illinois

HA No.	Material Description	Material Location	Sample Number	Condition	Friability	Asbestos Content	Estimated Quantity	Unit	Notes
1T	White 12" x 12" Stone/Cream Floor Tile Thin Set	Kitchen	1T, 2T, 3T	Good	Non-Friable	ND	200	SF	
1G	White 12" x 12" Stone/Cream Floor Tile Grout	Kitchen	1G, 2G, 3G	Good	Non-Friable	ND	200	SF	
2T	6" x 8" White Wall Tile Mastic	Kitchen, 1st Floor Bathroom	4T, 5T, 6T	Good	Non-Friable	ND	64	SF	
2G	6" x 8" White Wall Tile Grout	Kitchen, 1st Floor Bathroom	4G, 5G, 6G	Good	Non-Friable	ND	64	SF	
3	White Joint Tape Compound	1st Floor, Basement Walls and Ceilings	7, 8, 9, 28	Good	Friable	ND	3,000	SF	
4	Black Felt Paper under Wood Floor	Living Room, Bedroom	10, 11, 12	Good	Non-Friable	ND	500	SF	
5T	4" x 4" White Stone/Cream Floor Tile Thin Set	1st Floor Bathroom	13T, 14T, 15T	Good	Non-Friable	ND	40	SF	
5G	4" x 4" White Stone/Cream Floor Tile Grout	1st Floor Bathroom	13G, 14G, 15G	Good	Non-Friable	ND	40	SF	
6T	12" x 12" Gray Stone/Ceramic Floor Thin Set and Grout	Basement - Utility Closet, Bathroom #3, Laundry Room	16T, 17T, 18T	Good	Non-Friable	ND	500	SF	
6G	12" x 12" Gray Stone/Ceramic Floor Thin Set and Grout	Basement - Utility Closet, Bathroom #3, Laundry Room	16G, 17G, 18G	Good	Non-Friable	ND	500	SF	
7	Yellow Glue on Wood Strip Panel Walls	Basement Family Room	19, 20, 21	Good	Non-Friable	ND	360	SF	
8T	4" x 4" Black Stone/Ceramic Floor Tile Thin Set	2nd Floor Bathroom	22T, 23T, 24T	Good	Non-Friable	ND	80	SF	
8G	4" x 4" Black Stone/Ceramic Floor Tile Grout	2nd Floor Bathroom	22G, 23G, 24G	Good	Non-Friable	ND	80	SF	
9T	3" x 3" White Ceramic Wall Tile Mastic	Basement Bathroom #2	25T, 26T, 27T	Good	Non-Friable	ND	100	SF	
9G	3" x 3" White Ceramic Wall Tile Grout	Basement Bathroom #2	25G, 26G, 27G	Good	Non-Friable	ND	100	SF	

HA No.	Material Description	Material Location	Sample Number	Condition	Friability	Asbestos Content	Estimated Quantity	Unit	Notes
10	Exterior Chimney Brick Mortar	Exterior	29, 30, 31	Good	Non-Friable	ND	1,000	LF	
11	Asphalt Roof Shingles	House and Garage Roof	32, 33, 34	Good	Non-Friable	ND	1,640	SF	
12	Tar Paper under HA-11	House and Garage Roof	35, 36, 37	Good	Non-Friable	ND	1,640	SF	
13	Concrete Floor	Basement	38, 39, 40	Good	Non-Friable	ND	1,200	SF	
14	Gypsum Board	1st Floor, Basement Walls and Ceilings	41, 42, 43	Good	Friable	ND	3,000	SF	

Notes

ACM = Asbestos-Containing Material

Assumed ACM = A material determined by the inspector to be suspect ACM and is considered asbestos-containing until laboratory analysis can prove otherwise.

NAD = No Asbestos Detected

EA = Each

LF = Linear Foot

SF = Square Foot

Figures

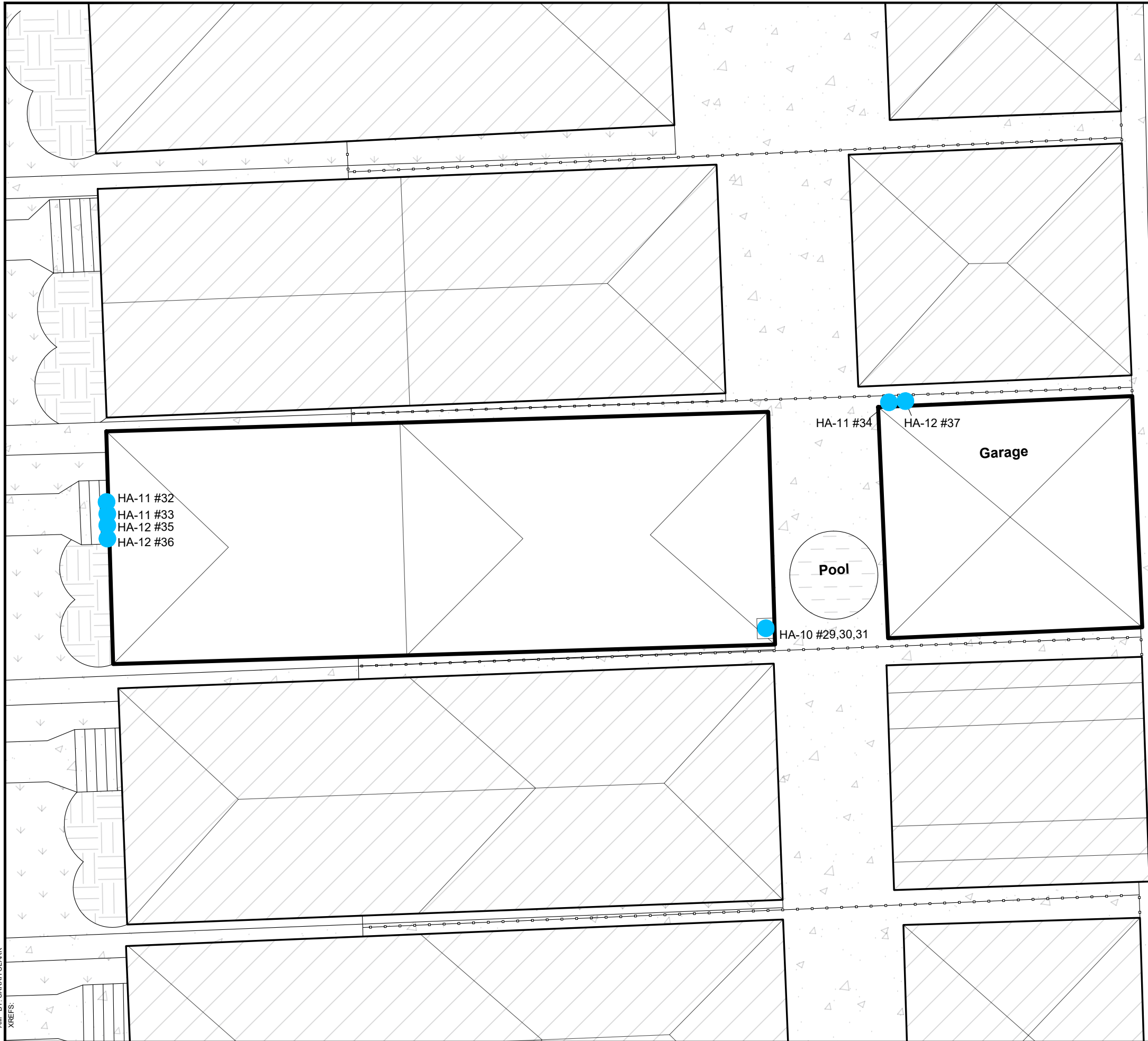

LEGEND

● ASBESTOS SAMPLE

NOTE

BASE MAP DEVELOPED FROM ONSITE INVESTIGATION.

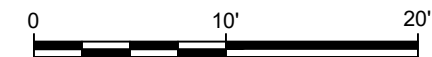

Approximate Scale: 1 in. = 10 ft.

IDOT / Asbestos Surveys WO #036
Job No. R-90-001-21
Route IL 43 0N30003
6443 S. Old Harlem Avenue
Chicago, Cook County, Illinois
ASBESTOS ABATEMENT SURVEY

**SAMPLING LOCATIONS -
EXTERIOR**



FIGURE

1

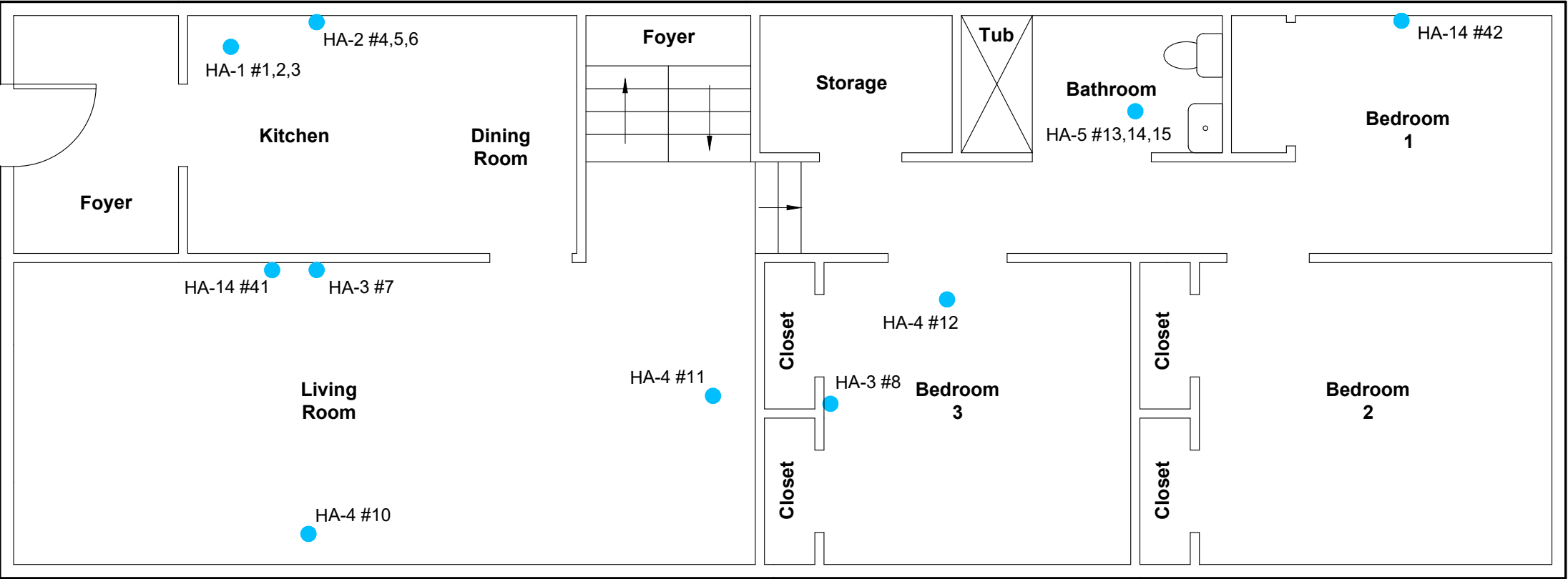

LEGEND
● ASBESTOS SAMPLE

NOTE
BASE MAP DEVELOPED FROM ONSITE INVESTIGATION.

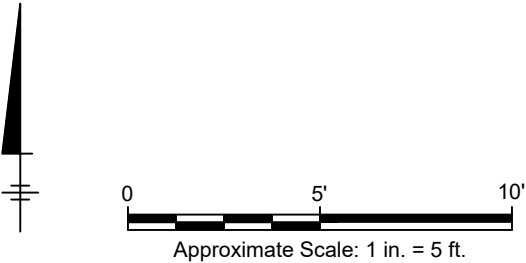

IDOT / Asbestos Surveys WO #036
Job No. R-90-001-21
Route IL 43 0N30003
6443 S. Old Harlem Avenue
Chicago, Cook County, Illinois
ASBESTOS ABATEMENT SURVEY

**SAMPLING LOCATIONS -
FIRST FLOOR**

FIGURE
2

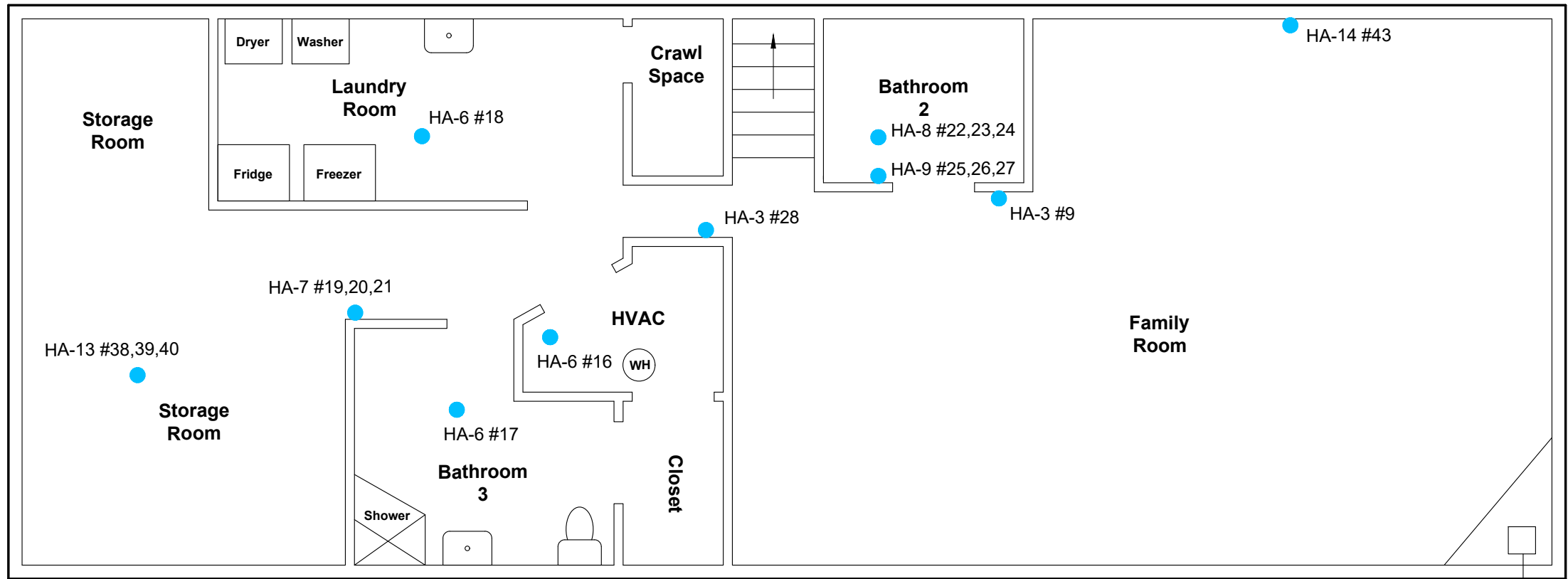

NOTE
BASE MAP DEVELOPED FROM ONSITE INVESTIGATION.

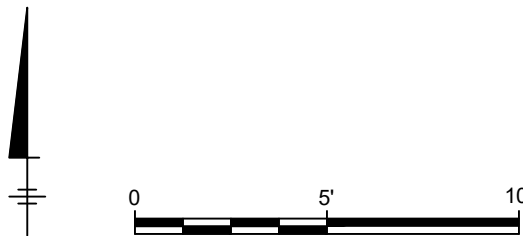

IDOT / Asbestos Surveys WO #036
 Job No. R-90-001-21
 Route IL 43 0N30003
 6443 S. Old Harlem Avenue
 Chicago, Cook County, Illinois
ASBESTOS ABATEMENT SURVEY

SAMPLING LOCATIONS - BASEMENT



FIGURE
3

Appendix A

Limitations and Service Constraints

Limitations and Service Constraints

The opinions, conclusions and recommendations presented in this report are limited to the information obtained during the performance of the specific scope of service identified in the report. To the extent that Arcadis relied upon any information prepared by other parties not under direct contract to Arcadis, no representation as to the accuracy or completeness of such information is made. This report is an instrument of professional service and the services described in the report were performed in accordance with generally accepted standards and level of skill and care ordinarily exercised by members of the profession working under similar conditions including comparable budgetary and schedule constraints. No warranty, guarantee or certification express or implied, is intended or given with respect to Arcadis' services, opinions, conclusions, or recommendations. This statement is in lieu of any other statement either expressed or implied.

Arcadis' observations, the results of testing and Arcadis' opinions, conclusions and recommendations apply solely to conditions existing at the specific times when and specific locations where Arcadis' investigative work was performed. Arcadis affirms that data gathered and presented by Arcadis in this report was collected in an appropriate manner in accordance with generally accepted methods and practices. Arcadis cannot be responsible for decisions made by our client solely on the basis of economic factors. Observation and testing activities such as those conducted by Arcadis are inherently limited and do not represent a conclusive or complete characterization. Arcadis analyzed only the substances, conditions and locations described in the report at the time indicated. Conditions in other parts of the project site, building or area may vary from conditions at the specific locations where observations were made and where testing was performed by Arcadis. Additionally, other building material hazards which were not identified by Arcadis, may also be present in inaccessible areas, including within walls and cavities, above ceilings, and below floors. Therefore, the extent of Arcadis' opinions, conclusions and recommendations are limited and 100% confidence in these opinions, conclusions and recommendations cannot reasonably be achieved. Nothing contained in this report shall relieve any other party of its responsibility to abide by contract documents and applicable laws, codes, regulations, or standards nor shall it be considered medical advice or consultation.

This report is expressly for the sole and exclusive use of the party for whom this report was originally prepared and for the particular purpose outlined in the report. Only the party for whom this report was originally prepared and/or other specifically named parties have the right to make use of and rely upon this report. Reuse of this report or any portion thereof for other than its intended purpose, or if modified, or if used by third parties, shall be at the user's sole risk. This report must be presented in its entirety.

Appendix B

Accreditations

Inspector

Laboratory



525-535 West Jefferson Street • Springfield, Illinois 62761-0001 • www.dph.illinois.gov

PATRICK W HOOK
2025 WOODLANE DR
LINDENHURST, IL 60046

3/11/2024



ASBESTOS PROFESSIONAL LICENSE ID NUMBER: 10967

Enclosed is your Asbestos Professional License. Please note the expiration date on the card and in the image depicted below.

COPY OF THE ASBESTOS PROFESSIONAL LICENSE

Front of License

Back of License

 ASBESTOS PROFESSIONAL LICENSE			ENDORSEMENTS	TC EXPIRES
ID NUMBER	ISSUED	EXPIRES	INSPECTOR	1/12/2025
100 - 10967	3/11/2024	05/15/2025	PROJECT MANAGER	1/13/2025
PATRICK W HOOK 2025 WOODLANE DR LINDENHURST, IL 60046 Environmental Health			Alteration of this license shall result in legal action This license issued under authority of the State of Illinois Department of Public Health This license is valid only when accompanied by a valid training course certificate.	

If you have any questions or need further assistance, contact the Asbestos Program at (217)782-3517 or fax (217)785-5897.

Our WEB address is: dph.illinois.gov/topics-services/environmental-health-protection/asbestos
EMAIL Address: dph.asbestos@illinois.gov



This is to certify that

Paul J. Hoffman

11 Precourt Lane, Norton, MA 02766

MA DLS Asbestos Inspector License# AI061473

*has completed requisite training by Video Conference, and has passed an examination for
reaccreditation as:*

Asbestos Inspector Refresher

pursuant to Title II of the Toxic Substance Control Act, 15 U.S.C. 2646



Course Location

Zoom Video Conference

Institute for Environmental Education 16 Upton Drive Wilmington, MA 01887

June 21, 2024

Course Dates

24-5332-106-213698

Certificate Number

June 21, 2024

Examination Date

June 21, 2025

Expiration Date

Training Director

16 Upton Drive, Wilmington, MA 01887

Telephone 978.658.5272

www.ieetrains.com

INSTITUTE FOR ENVIRONMENTAL EDUCATION

United States Department of Commerce
National Institute of Standards and Technology



Certificate of Accreditation to ISO/IEC 17025:2017

NVLAP LAB CODE: 101202-0

STAT Analysis Corporation
Chicago, IL

*is accredited by the National Voluntary Laboratory Accreditation Program for specific services,
listed on the Scope of Accreditation, for:*

Asbestos Fiber Analysis

*This laboratory is accredited in accordance with the recognized International Standard ISO/IEC 17025:2017.
This accreditation demonstrates technical competence for a defined scope and the operation of a laboratory quality
management system (refer to joint ISO-ILAC-IAF Communiqué on ISO/IEC 17025).*

2024-07-01 through 2025-06-30

Effective Dates



A handwritten signature in blue ink, reading "Dana S. Laman".

For the National Voluntary Laboratory Accreditation Program

SCOPE OF ACCREDITATION TO ISO/IEC 17025:2017

STAT Analysis Corporation

Sterling Labs
2242 W. Harrison St. Suite 200
Chicago, IL 60612
Carolyn Mazzuca
Phone: 312-733-0551
Email: cmazzuca@statanalysis.com

ASBESTOS FIBER ANALYSIS

NVLAP LAB CODE 101202-0

Bulk Asbestos Analysis

Code

Description

18/A01

EPA -- 40 CFR Appendix E to Subpart E of Part 763, Interim Method of the Determination of Asbestos in Bulk Insulation Samples

18/A03

EPA 600/R-93/116: Method for the Determination of Asbestos in Bulk Building Materials

Airborne Asbestos Analysis

Code

Description

18/A02

U.S. EPA's "Interim Transmission Electron Microscopy Analytical Methods-Mandatory and Nonmandatory-and Mandatory Section to Determine Completion of Response Actions" as found in 40 CFR, Part 763, Subpart E, Appendix A.

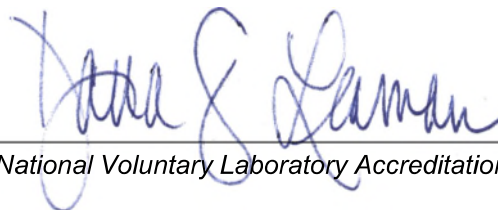

For the National Voluntary Laboratory Accreditation Program

Appendix C

Laboratory Reports

ASBESTOS ANALYSIS BY POLARIZED LIGHT MICROSCOPY

Method: EPA/600/R-93/116

Arcadis US Inc.
225 W. Wacker Drive, Suite 2015
Chicago, IL 60606
Phone: (312) 575-3718

Reference: 30253552 IDOT
Location: 6443 S Old Harlem Ave Chicago, IL
Batch No.: 374068
Customer No.: 2530

Date Received: 03/07/2025
Date Analyzed: 03/12/2025
Date Reported: 03/12/2025
Turn Around Time: 5 Days

Laboratory Sample	Customer Sample Number	Asbestos Components (%)	Non-Asbestos Components (%)
374068001	1T	ND	Cellulose 1-5% Binder 95-99%
374068002	2T	ND	Cellulose 1-5% Binder 95-99%
374068003	3T	ND	Cellulose 1-5% Binder 95-99%
374068004	1G	ND	Cellulose 1-5% Binder 95-99%
374068005	2G	ND	Cellulose 1-5% Binder 95-99%
374068006	3G	ND	Cellulose 1-5% Binder 95-99%
374068007	4T	ND	Cellulose 1-5% Binder 95-99%
374068008	5T	ND	Cellulose 1-5% Binder 95-99%
374068009	6T	ND	Cellulose 1-5% Binder 95-99%
374068010	4G	ND	Cellulose 1-5% Binder 95-99%

ND = Asbestos Not Detected (Not Present) NA = Not Analyzed NS = Not Submitted

Components of inhomogeneous samples are analyzed per our Standard Operating Procedure, or per customer request.

The use of the NVLAP logo does not imply endorsement by NVLAP or any agency of the US Government.

The information contained in this report and any attachments is confidential information intended only for the use of the individual or entities named above. The results of this report relate only to the samples tested. If you have received this report in error, please notify us immediately by phone. This report shall not be reproduced, except in its entirety, unless written approval has been obtained from the laboratory. This report remains property of STAT Analysis until payment is received in full (see invoice).

Analyzed by Name :

Daniel Mikos / Microscopist

ASBESTOS ANALYSIS BY POLARIZED LIGHT MICROSCOPY

Method: EPA/600/R-93/116

Arcadis US Inc.
225 W. Wacker Drive, Suite 2015
Chicago, IL 60606
Phone: (312) 575-3718

Reference: 30253552 IDOT
Location: 6443 S Old Harlem Ave Chicago, IL
Batch No.: 374068
Customer No.: 2530
Date Received: 03/07/2025
Date Analyzed: 03/12/2025
Date Reported: 03/12/2025
Turn Around Time: 5 Days

Laboratory Sample	Customer Sample Number	Asbestos Components (%)	Non-Asbestos Components (%)
374068011	5G	ND	Cellulose 1-5% Binder 95-99%
374068012	6G	ND	Cellulose 1-5% Binder 95-99%
374068013	7	ND	Cellulose 1-5% Binder 95-99%
374068014	8	ND	Cellulose 1-5% Binder 95-99%
374068015	9	ND	Cellulose 1-5% Binder 95-99%
374068016	28	ND	Cellulose 1-5% Binder 95-99%
374068017	10	ND	Cellulose 60-65% Binder 35-40%
374068018	11	ND	Cellulose 60-65% Binder 35-40%
374068019	12	ND	Cellulose 60-65% Binder 35-40%
374068020	13T	ND	Cellulose 1-5% Binder 95-99%

ND = Asbestos Not Detected (Not Present) NA = Not Analyzed NS = Not Submitted

Components of inhomogeneous samples are analyzed per our Standard Operating Procedure, or per customer request.

The use of the NVLAP logo does not imply endorsement by NVLAP or any agency of the US Government.

The information contained in this report and any attachments is confidential information intended only for the use of the individual or entities named above. The results of this report relate only to the samples tested. If you have received this report in error, please notify us immediately by phone. This report shall not be reproduced, except in its entirety, unless written approval has been obtained from the laboratory. This report remains property of STAT Analysis until payment is received in full (see invoice).

Analyzed by Name :

Daniel Mikos / Microscopist

ASBESTOS ANALYSIS BY POLARIZED LIGHT MICROSCOPY

Method: EPA/600/R-93/116

Arcadis US Inc.
225 W. Wacker Drive, Suite 2015
Chicago, IL 60606
Phone: (312) 575-3718

Reference: 30253552 IDOT
Location: 6443 S Old Harlem Ave Chicago, IL
Batch No.: 374068
Customer No.: 2530

Date Received: 03/07/2025
Date Analyzed: 03/12/2025
Date Reported: 03/12/2025
Turn Around Time: 5 Days

Laboratory Sample	Customer Sample Number	Asbestos Components (%)	Non-Asbestos Components (%)
374068021	14T	ND	Cellulose 1-5% Binder 95-99%
374068022	15T	ND	Cellulose 1-5% Binder 95-99%
374068023	13G	ND	Cellulose 1-5% Binder 95-99%
374068024	14G	ND	Cellulose 1-5% Binder 95-99%
374068025	15G	ND	Cellulose 1-5% Binder 95-99%
374068026	16T	ND	Cellulose 1-5% Binder 95-99%
374068027	17T	ND	Cellulose 1-5% Binder 95-99%
374068028	18T	ND	Cellulose 1-5% Binder 95-99%
374068029	16G	ND	Cellulose 1-5% Binder 95-99%
374068030	17G	ND	Cellulose 1-5% Binder 95-99%

ND = Asbestos Not Detected (Not Present) NA = Not Analyzed NS = Not Submitted

Components of inhomogeneous samples are analyzed per our Standard Operating Procedure, or per customer request.

The use of the NVLAP logo does not imply endorsement by NVLAP or any agency of the US Government.

The information contained in this report and any attachments is confidential information intended only for the use of the individual or entities named above. The results of this report relate only to the samples tested. If you have received this report in error, please notify us immediately by phone. This report shall not be reproduced, except in its entirety, unless written approval has been obtained from the laboratory. This report remains property of STAT Analysis until payment is received in full (see invoice).

Analyzed by Name :

Daniel Mikos / Microscopist

ASBESTOS ANALYSIS BY POLARIZED LIGHT MICROSCOPY

Method: EPA/600/R-93/116

Arcadis US Inc.
225 W. Wacker Drive, Suite 2015
Chicago, IL 60606
Phone: (312) 575-3718

Reference: 30253552 IDOT Date Received: 03/07/2025
Location: 6443 S Old Harlem Ave Chicago, IL Date Analyzed: 03/12/2025
Batch No.: 374068 Date Reported: 03/12/2025
Customer No.: 2530 Turn Around Time: 5 Days

Laboratory Sample	Customer Sample Number	Asbestos Components (%)	Non-Asbestos Components (%)
374068031	18G	ND	Cellulose 1-5% Binder 95-99%
374068032	19	ND	Cellulose 1-5% Binder 95-99%
374068033	20	ND	Cellulose 1-5% Binder 95-99%
374068034	21	ND	Cellulose 1-5% Binder 95-99%
374068035	22T	ND	Cellulose 1-5% Binder 95-99%
374068036	23T	ND	Cellulose 1-5% Binder 95-99%
374068037	24T	ND	Cellulose 1-5% Binder 95-99%
374068038	22G	ND	Cellulose 1-5% Binder 95-99%
374068039	23G	ND	Cellulose 1-5% Binder 95-99%
374068040	24G	ND	Cellulose 1-5% Binder 95-99%

ND = Asbestos Not Detected (Not Present) NA = Not Analyzed NS = Not Submitted

Components of inhomogeneous samples are analyzed per our Standard Operating Procedure, or per customer request.

The use of the NVLAP logo does not imply endorsement by NVLAP or any agency of the US Government.

The information contained in this report and any attachments is confidential information intended only for the use of the individual or entities named above. The results of this report relate only to the samples tested. If you have received this report in error, please notify us immediately by phone. This report shall not be reproduced, except in its entirety, unless written approval has been obtained from the laboratory. This report remains property of STAT Analysis until payment is received in full (see invoice).

Analyzed by Name :

Daniel Mikos / Microscopist

ASBESTOS ANALYSIS BY POLARIZED LIGHT MICROSCOPY

Method: EPA/600/R-93/116

Arcadis US Inc.
225 W. Wacker Drive, Suite 2015
Chicago, IL 60606
Phone: (312) 575-3718

Reference: 30253552 IDOT
Location: 6443 S Old Harlem Ave Chicago, IL
Batch No.: 374068
Customer No.: 2530
Date Received: 03/07/2025
Date Analyzed: 03/12/2025
Date Reported: 03/12/2025
Turn Around Time: 5 Days

Laboratory Sample	Customer Sample Number	Asbestos Components (%)	Non-Asbestos Components (%)
374068041	25T	ND	Cellulose 1-5% Binder 95-99%
374068042	26T	ND	Cellulose 1-5% Binder 95-99%
374068043	27T	ND	Cellulose 1-5% Binder 95-99%
374068044	25G	ND	Cellulose 1-5% Binder 95-99%
374068045	26G	ND	Cellulose 1-5% Binder 95-99%
374068046	27G	ND	Cellulose 1-5% Binder 95-99%
374068047	29	ND	Cellulose 1-5% Binder 95-99%
374068048	30	ND	Cellulose 1-5% Binder 95-99%
374068049	31	ND	Cellulose 1-5% Binder 95-99%
374068050	32	ND	Binder 85-90% Glass 10-15%

ND = Asbestos Not Detected (Not Present) NA = Not Analyzed NS = Not Submitted

Components of inhomogeneous samples are analyzed per our Standard Operating Procedure, or per customer request.

The use of the NVLAP logo does not imply endorsement by NVLAP or any agency of the US Government.

The information contained in this report and any attachments is confidential information intended only for the use of the individual or entities named above. The results of this report relate only to the samples tested. If you have received this report in error, please notify us immediately by phone. This report shall not be reproduced, except in its entirety, unless written approval has been obtained from the laboratory. This report remains property of STAT Analysis until payment is received in full (see invoice).

Analyzed by Name : 
Daniel Mikos / Microscopist

ASBESTOS ANALYSIS BY POLARIZED LIGHT MICROSCOPY

Method: EPA/600/R-93/116

Arcadis US Inc.
 225 W. Wacker Drive, Suite 2015
 Chicago, IL 60606
 Phone: (312) 575-3718

Reference:	30253552 IDOT	Date Received:	03/07/2025
Location:	6443 S Old Harlem Ave Chicago, IL	Date Analyzed:	03/12/2025
Batch No.:	374068	Date Reported:	03/12/2025
Customer No.:	2530	Turn Around Time:	5 Days

Laboratory Sample	Customer Sample Number	Asbestos Components (%)	Non-Asbestos Components (%)
374068051	33	ND	Binder 85-90% Glass 10-15%
374068052	34	ND	Binder 85-90% Glass 10-15%
374068053	35	ND	Binder 85-90% Glass 10-15%
374068054	36	ND	Binder 85-90% Glass 10-15%
374068055	37	ND	Binder 85-90% Glass 10-15%
374068056	38	ND	Cellulose 1-5% Binder 95-99%
374068057	39	ND	Cellulose 1-5% Binder 95-99%
374068058	40	ND	Cellulose 1-5% Binder 95-99%

ND = Asbestos Not Detected (Not Present) NA = Not Analyzed NS = Not Submitted

Components of inhomogeneous samples are analyzed per our Standard Operating Procedure, or per customer request.

The use of the NVLAP logo does not imply endorsement by NVLAP or any agency of the US Government.

The information contained in this report and any attachments is confidential information intended only for the use of the individual or entities named above. The results of this report relate only to the samples tested. If you have received this report in error, please notify us immediately by phone. This report shall not be reproduced, except in its entirety, unless written approval has been obtained from the laboratory. This report remains property of STAT Analysis until payment is received in full (see invoice).

Analyzed by Name :

 Daniel Mikos / Microscopist



2242 W. Harrison, Suite 200, Chicago, Illinois 60612

Phone: (312) 733-0551 Fax: (312) 733-2386

e-mail address: info@thesterlinglab.com

CHAIN OF CUSTODY RECORD

Page : 1 of 2

Client: ARCADIS US

Street Address: 225 W WACKER DRIVE

City, State, Zip: SUITE 2015 CHICAGO, IL

Phone: 312-575-3718

Fax: MOBILE 630-803-5905

e-mail/Alt. Fax: BRENDAN.QUELY@ARCADIS

Project Number: 30253552

Project Name: IDOT SURVEYS

Project Location: 6413 SOLD HARLEM AVE CHICAGO IL

Project Manager: BRENDAN QUEALY

P.O. Number: 30253552

Turn Around: Immediate: ☐ 4 Hrs: ☐ 8 Hrs: ☐ 24 Hrs: ☐ 1 Day: ☐ 2 Days: ☐ 3 Days: ☐ 5 Days: ☒

Date Due: _____ Time Due: _____ Note: Not all turn around times are available for all analysis.

OFFICE USE ONLY BELOW:

Batch No.: 374068

Salaries Acceptable: Yes: ☒ No: ☐

Checked by (Initial/Date): 3/13/14

Comments:

Relinquished by: P. Walker Date/Time: 3/6/2025 1700

Received by: Fedex/In-1 Date/Time: 3/7/25 9:05

Relinquished by: _____ Date/Time: _____

Received by: _____ Date/Time: _____

Relinquished by: _____ Date/Time: _____

Received by: _____ Date/Time: _____

[illegible]

Comments: 6443 S OLD HARLEM AVE CHICAGO, IL
40 SAMPLES

Client:

IDOT

Building/Site No.:

6443
Address: 6443 S OLD
HARLEM AVE CHICAGO IL

Project No.:

30253552
Survey Date: 3/4/2025
Inspector: PATRICK HOOKDesign & Consultancy
for natural and
built assets

HA	Sample Number	Material Type (Circle)	Color Texture	Material Description	Floor: B, 1, Mezz, Ext, Roof	Sample Location	Condition G, D, SD	Friable Y / N	Quantity SP, LF, EA	Photo
1	1	(M) S, TSI	WHITE	12" X 12" WHITE	1	KITCHEN FLOOR	G	N	200	
	2	Location:	FLR	STONE / CERAM	1	↓	↓	↓		
	3	Ceiling, Wall, Floor, Roof,	(C)	FLOOR TILE	1	↓	↓	↓		
		Multiple, Shaftway, Other		THINSET / GROUT						
Mat. Location/QTY:										
Notes:										
2	4	(M) S, TSI	WHITE	6" X 8" WHITE	1	KITCHEN BACKSPLASH	G	N	24	
	5	Location:	WALL	WALL TILE	1	↓	↓	↓		
	6	Ceiling, Wall, Floor, Roof,	(C)	MASTIC / GROUT	1	BATHRM 1 ST FLR WALL	↓	↓	40	
		Multiple, Shaftway, Other								
Mat. Location/QTY:										
Notes:										
3	7	(M) S, TSI	WHITE	JOINT TAPE	1	LIVING ROOM	G	N	3000	
	8	Location:	WALL	COMPOUND	1	BED ROOM	↓	↓	↓	
	9	Ceiling, Wall, Floor, Roof,	(C)		B	HALL / TV ROOM / FAMILY RM	↓	↓	↓	
	28	Multiple, Shaftway, Other			B	STAIRWELL HALLWAY	G	↓	↓	
Mat. Location/QTY:										
Notes:										
4	10	(M) S, TSI	BLACK	BLACK FELT	1	LIVING ROOM	G	N	500	
	11	Location:	FLR	PAPER UNDER	1	↓ ↓	↓	↓	↓	
	12	Ceiling, Wall, Floor, Roof,	(C)	WOOD FLOOR	1	BED ROOM	↓	↓	↓	
		Multiple, Shaftway, Other								
Mat. Location/QTY:										
Notes:										

Client:

IDOT

Building/Site No.:

6443

Project No.:

30253552

Address:

6443 S OLD HARBOR
AVE CHICAGO, IL

Survey Date:

3/4/2025

Inspector:

PATRICK HOOK

374068

ARCADIS

Design & Consultancy
for natural and
built assets

HA	Sample Number	Material Type (Circle)	Color Texture	Material Description	Floor: B,1,Mezz,Ext,Roof	Sample Location	Condition G, D, SD	Friable Y / N	Quantity SF, LF, EA	Photo
5	13	(M) S, TSI	GRAY	4" X 4" WHITE	1	BATHROOM FLOOR 1ST FLR	G	N	40	
	14	Location:	FLR	STONE/CERAM	1	↓	↓	↓	↓	
	15	Ceiling, Wall, Floor, Roof,	(Floor)	FLOOR TILE,	1	↓	↓	↓	↓	
		Multiple, Shaftway, Other		THINSET/ GROUT-GRAY						

Mat. Location/QTY:

Notes:

6	16	(M) S, TSI	GRAY	12" X 12" GRAY	B	BASEMENT-UTILITY CLOSET	G	N	500 SF	
	17	Location:	FLR	STONE/CERAMIC	B	↓ BATHROOM #3	G	↓	↓	
	18	Ceiling, Wall, Floor, Roof,	(Floor)	FLR, THINSET +	B	↓ LAUNDRY RM	G	↓	↓	
		Multiple, Shaftway, Other		GROUT						

Mat. Location/QTY:

Notes:

7	19	(M) S, TSI	YEL	YELLOW GLUE	B	BASEMENT-FAMILY/TV RM	G	N	360	
	20	Location:	WALL	ON WOOD	B	↓	↓	↓	↓	
	21	Ceiling, Wall, Floor, Roof,	(Wall)	STRIP PANEL	B	↓	↓	↓	↓	
		Multiple, Shaftway, Other		WALLS						

Mat. Location/QTY:

Notes:

8	22	(M) S, TSI	BLACK	4" X 4" BLACK	B	MEZZ LEVEL BATH RM FLR 2	G	N	80	
	23	Location:	FLR	STONE/CERAMIC	B	↓	↓	↓	↓	
	24	Ceiling, Wall, Floor, Roof,	(Floor)	F.T - THINSET	B	↓	↓	↓	↓	
		Multiple, Shaftway, Other		+ GROUT						

Mat. Location/QTY:

Notes:

Client:

IDOT

Building/Site No.:

6443

Address:

6443 SOLD HARLEM
AVE CHICAGO, IL

Project No.:

3023552

Survey Date:

3/4/2025

Inspector:

PATRICK HOOK

374068



ARCADIS

Design & Consultancy
for natural and
built assets

HA	Sample Number	Material Type (Circle)	Color Texture	Material Description	Floor: B, 1, Mezz, Ext, Roof	Sample Location	Condition G, D, SD	Friable Y / N	Quantity SP, LF, EA	Photo
9	25	(M) S, TSI	WHITE	3"X3" WHITE CERAMIC WALL TILE-MASTIC AND GROUT	B	BASEMENT BATH RM #2	G	N	100	
	26	Location: WALL			B	WALL	↓	↓	↓	
	27	Ceiling, Wall, Floor, Roof, Multiple, Shaftway, Other			B	↓	↓	↓	↓	
Mat. Location/QTY:										
Notes:										
10	29	(M) S, TSI	GRAY	EXTERIOR CHIMNEY / BRICK MORTAR	EXT	EXTERIOR - BACK OF BUILDING	G	N	1,000 LF	
	30	Location: EXT			↓		↓	↓	↓	
	31	Ceiling, Wall, Floor, Roof, Multiple, Shaftway, Other			↓		↓	↓	↓	
Mat. Location/QTY:										
Notes:										
11	32	(M) S, TSI	BLACK	ASPHALT ROOF SHINGLES	ROOF	FRONT-HOUSE ROOF	G	N	1,200	
	33	Location: ROOF			↓	↓	↓	↓	↓	
	34	Ceiling, Wall, Floor, Roof, Multiple, Shaftway, Other			↓	GARAGE SIDE ROOF	↓	↓	440	
Mat. Location/QTY:										
Notes:										
12	35	(M) S, TSI	BLACK	TAR PAPER- UNDER SHINGLES	ROOF	FRONT OF HOUSE - ROOF	G	N	1,200	
	36	Location: ROOF			↓	↓	↓	↓	↓	
	37	Ceiling, Wall, Floor, Roof, Multiple, Shaftway, Other			↓	GARAGE SIDE - ROOF	↓	↓	440	
Mat. Location/QTY:										
Notes:										

Client:

IDOT

Building/Site No.:

6443

Address:

643 S OLD HARLEM
AVE CHICAGO, IL

Project No.:

3023552

Survey Date:

3/1/2025

Inspector:

PATRICK HOOK

374668

 Partnering
for natural and
built assets

HA	Sample Number	Material Type (Circle)	Color Texture	Material Description	Floor: B,1,Mezz, Ext,Roof	Sample Location	Condition G, D, SD	Friable Y / N	Quantity SF, LF, EA	Photo
13	38	(M, S, TSI)	GRAN	CONCRETE	B	BASEMENT STORAGE	G	N	1,200	
	39	Location:	FLR	FLOOR	B	↓			↓	
	40	Ceiling, Wall, Floor, Roof, Multiple, Shaftway, Other	FLR	BASEMENT FLR	B	↓			↓	
Mat. Location/QTY:										

Notes:

		M, S, TSI								
		Location:								
		Ceiling, Wall, Floor, Roof, Multiple, Shaftway, Other								
Mat. Location/QTY:										

Notes:

		M, S, TSI								
		Location:								
		Ceiling, Wall, Floor, Roof, Multiple, Shaftway, Other								
Mat. Location/QTY:										

Notes:

		M, S, TSI								
		Location:								
		Ceiling, Wall, Floor, Roof, Multiple, Shaftway, Other								
Mat. Location/QTY:										

Notes:

ASBESTOS ANALYSIS BY POLARIZED LIGHT MICROSCOPY

Method: EPA/600/R-93/116

Arcadis US Inc.
225 W. Wacker Drive, Suite 2015
Chicago, IL 60606
Phone: (312) 575-3718

Reference: 30253552 Date Received: 04/17/2025
Location: 6443 S. Old Harlem Avenue, Chicago, IL Date Analyzed: 04/22/2025
Batch No.: 374530 Date Reported: 04/22/2025
Customer No.: 2530 Turn Around Time: 3 Days

Laboratory Sample	Customer Sample Number	Asbestos Components (%)	Non-Asbestos Components (%)
374530001	14-41	ND	Cellulose 5-10% Binder 90-95%
374530002	14-42	ND	Cellulose 5-10% Binder 90-95%
374530003	14-43	ND	Cellulose 5-10% Binder 90-95%

ND = Asbestos Not Detected (Not Present) NA = Not Analyzed NS = Not Submitted

Components of inhomogeneous samples are analyzed per our Standard Operating Procedure, or per customer request.

The use of the NVLAP logo does not imply endorsement by NVLAP or any agency of the US Government.

The information contained in this report and any attachments is confidential information intended only for the use of the individual or entities named above. The results of this report relate only to the samples tested. If you have received this report in error, please notify us immediately by phone. This report shall not be reproduced, except in its entirety, unless written approval has been obtained from the laboratory. This report remains property of STAT Analysis until payment is received in full (see invoice).

Analyzed by Name :

Zineb Nasri / Microscopist

Date: 04/22/2025

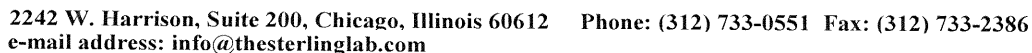

Page : 1 of 1

Comments: Email results to brendan.quealy@arcadis.com

Appendix D

Photo Log



Exterior of Building – Front



HA-1: 12" x 12" White Stone/Cream Floor Tile Thin Set and Grout



HA-2: 6" x 8" White Wall Tile Mastix and Grout



**HA-3: Joint Tape Compound
HA-14: Gypsum Board**



HA-4: Black Felt Paper under Wood Floor



HA-5: 4" x 4" White Stone/Cream Floor Tile Thin Set and Grout



HA-6: 12" x 12" Gray Stone/Ceramic Floor Tile Thin Set and Mortar



HA-7: Yellow Glue on Wood Strip Panel Walls



HA-8: 4" x 4" Black Stone/Ceramic Floor Tile Thin Set and Grout



HA-9: 3" x 3" White Ceramic Wall Tile Mastic and Grout



HA-10: Exterior Chimney Brick Mortar



HA-11: Asphalt Roof Shingles



HA-12: Black Tar Paper under Shingles



HA-13: Concrete Basement Floor

Arcadis U.S., Inc.
225 West Wacker Drive
Suite 2015
Chicago, Illinois 60606
Phone: 312 917 1000
www.arcadis.com