

REMOVAL SCHEDULE OF DRAINAGE STRUCTURE

STATION	OFFSET	REMOVING MANHOLES	REMOVING INLETS
6582+47	58' LT	X	
6588+47	24' LT		X

F.A.P. RTE.	SECTION	COUNTY	TOTAL SHEETS	SHEET NO.
307	130N-3 (11)	DUPAGE	141	48
STA. 6577+00		TO STA. 6590+00		
FED. ROAD DIST. NO.		ILLINOIS	FED. AID PROJECT	

60R46

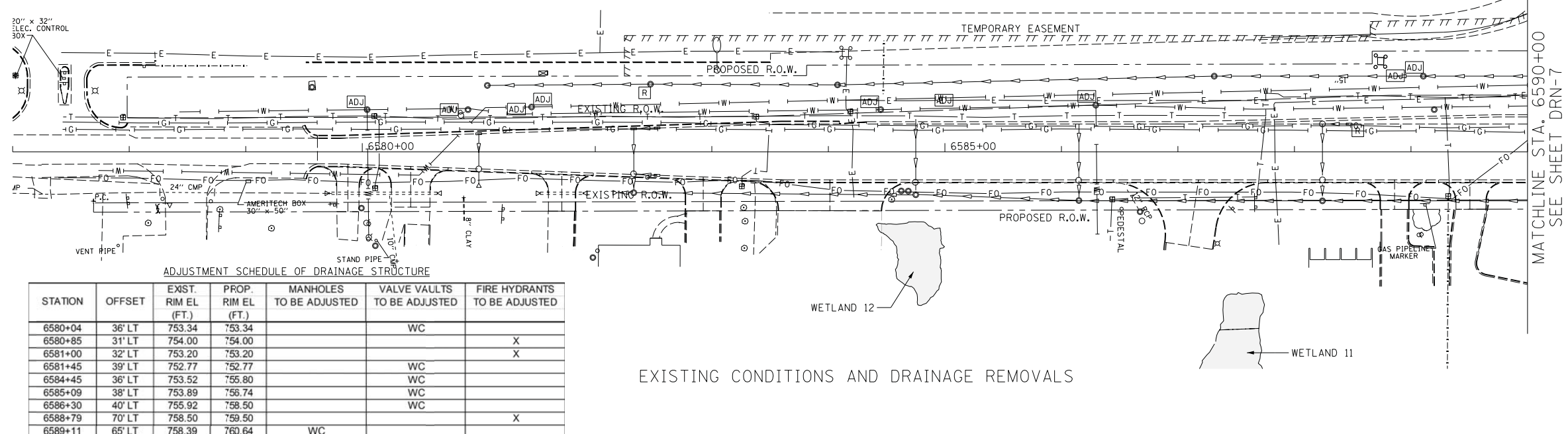

ADJUSTMENT SCHEDULE OF DRAINAGE STRUCTURE

STATION	OFFSET	EXIST. RIM EL (FT.)	PROP. RIM EL (FT.)	MANHOLES TO BE ADJUSTED	VALVE VAULTS TO BE ADJUSTED	FIRE HYDRANTS TO BE ADJUSTED
6580+04	36' LT	753.34	753.34			
6580+85	31' LT	754.00	754.00		WC	X
6581+00	32' LT	753.20	753.20			X
6581+45	39' LT	752.77	752.77		WC	
6584+45	36' LT	753.52	755.80		WC	
6585+09	38' LT	753.89	756.74		WC	
6586+30	40' LT	755.92	758.50		WC	
6588+79	70' LT	758.50	759.50			X
6589+11	65' LT	758.39	760.64	WC		

- NOTES:
- FOR POWIS ROAD INTERSECTION DRAINAGE DETAILS - SEE SHEET DRN-7
 - "WC" DESIGNATES WEST CHICAGO MANHOLES AND VALVE VAULTS TO BE ADJUSTED IN THE ADJUSTMENT SCHEDULE OF DRAINAGE STRUCTURE.

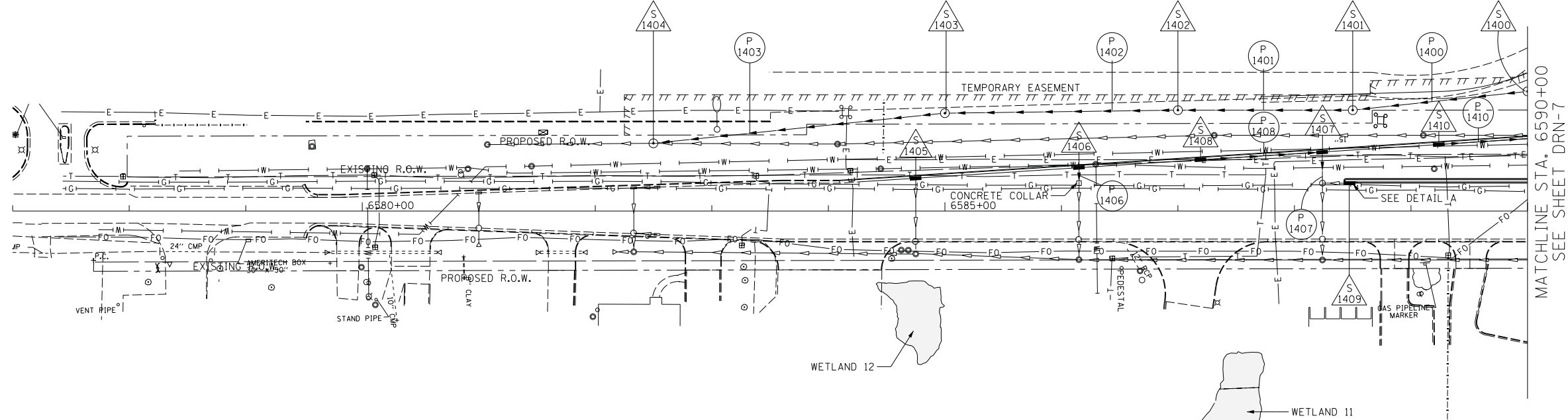

PIPE SCHEDULE

PIPE NO.	UP STREAM STR. NO.	UP STREAM INVERT	DOWN STREAM STR. NO.	DOWN STREAM INVERT	PIPE LENGTH (FEET)	PIPE DIA. (INCHES)	PIPE SLOPE (%)	PAY ITEM DESCRIPTION	TRENCH BACKFILL (CY)
P 1400	S 1400	746.45	S 1401	746.08	151	48	0.25	STORM SEW CL A 2 48	157.10
P 1401	S 1401	746.08	S 1402	745.70	150	48	0.25	STORM SEW CL A 2 48	0.00
P 1402	S 1402	745.70	S 1403	745.20	200	48	0.25	STORM SEW CL A 2 48	0.00
P 1403	S 1403	745.20	S 1404	744.57	252	48	0.25	SS CL A 1 EQRS 48	0.00
P 1406	S 1406	751.87	COLLAR	751.81	14	12	0.44	STORM SEW CL A 2 12	5.30
P 1407	S 1407	754.60	COLLAR	754.48	27	12	0.44	STORM SEW CL A 2 12	9.60
P 1408	S 1408	755.06	S 1407	754.60	105	12	0.44	STORM SEW CL A 2 12	24.60
P 1410	S 1410	755.74	S 707	755.30	101	12	0.44	STORM SEW CL A 2 12	35.70

DRAINAGE STRUCTURE SCHEDULE

STR. NO	STATION OFFSET	PAY ITEM	RIM (FT.)	N. INVERT (FT.)	W. INVERT (FT.)	S. INVERT (FT.)	E. INVERT (FT.)
S 1400	6590+00, 102.9' LT	MAN TA 6 DIA T1F CL	758.17	746.45	-	746.45	-
S 1401	6588+50, 86.7' LT	MAN TA 6 DIA T1F CL	758.29	746.08	-	746.08	-
S 1402	6587+00, 86.7' LT	MAN TA 6 DIA T1F CL	757.25	745.70	-	745.70	-
S 1403	6585+00, 84.1' LT	MAN TA 6 DIA T1F CL	755.00	745.20	-	745.20	-
S 1404	6582+50, 58.2' LT	MAN TA 7 DIA T1F CL	750.90	744.57	-	744.57	-
S 1405	6584+75, 28.2' LT	INLETS TA T24F&G	756.19	-	-	-	751.45
S 1406	6586+15, 37.8' LT	INLETS TA T24F&G	758.06	-	-	-	751.87
S 1407	6588+24, 50.7' LT	INLETS TB T24F&G	760.37	-	-	754.60	754.60
S 1408	6587+20, 44.0' LT	INLETS TA T24F&G	759.45	755.06	-	-	-
S 1409	6588+47, 24.0' LT	INLETS TB T12F&G	761.17	-	-	754.58	-
S 1410	6589+24, 57.2' LT	INLETS TA T24F&G	760.59	755.74	-	-	-

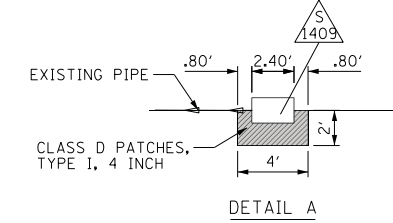

REVISIONS	
NAME	DATE

ILLINOIS DEPARTMENT OF TRANSPORTATION
 F.A.P. ROUTE 307 (ILLINOIS ROUTE 64)

DRAINAGE PLAN
 POWIS ROAD
 STA. 6577+00 TO STA. 6590+00

SCALE: VERT: NONE
 HORIZ: 1" = 50'
 DATE: FEBRUARY 1, 2013

DRAWN BY: AFC
 CHECKED BY: EY



PROPOSED DRAINAGE PLAN

DRN-14