

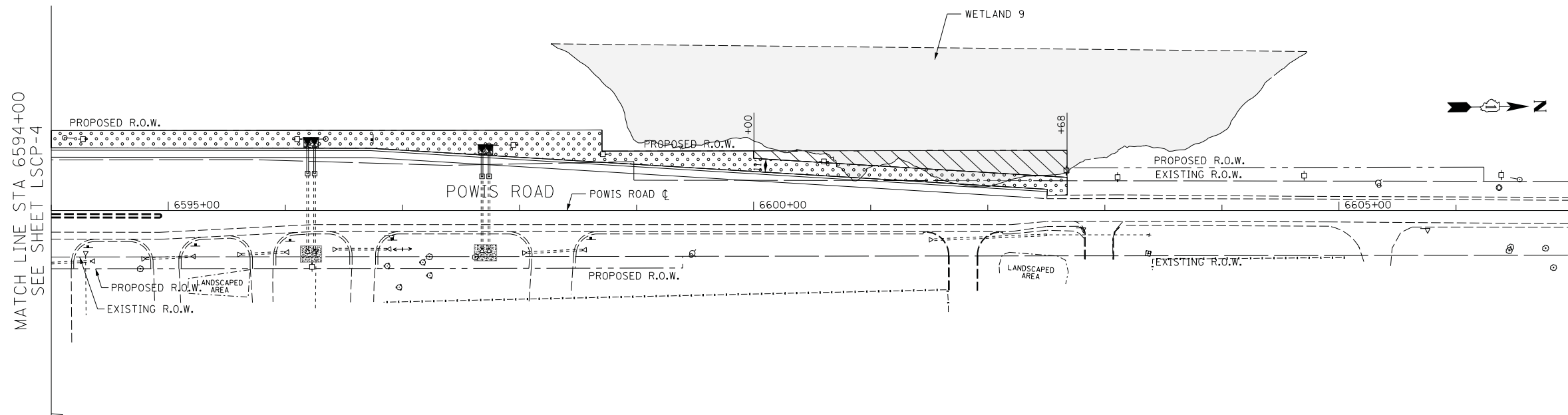



F.A.P. RTE.	SECTION	COUNTY	TOTAL SHEETS	SHEET NO.
307	130N-3 (11)	DUPAGE	141	93
STA. 6579+61		TO STA. 6602+50		
FED. ROAD DIST. NO.		ILLINOIS	FED. AID PROJECT	

60R46



LEGEND:

-  TOPSOIL PLACEMENT, 4" AND SEEDING CLASS 2A EROSION CONTROL BLANKET
-  TOPSOIL PLACEMENT, 4" AND SODDING, SALT TOLERANT EROSION CONTROL BLANKET
-  COMPOST, FURNISH AND PLACE 2" SEEDING CLASS 4 (PRAIRIE GRASS) EROSION CONTROL BLANKET
-  COMPOST, FURNISH AND PLACE 2" SEEDING CLASS 4B (MODIFIED) WETLAND MIX EROSION CONTROL BLANKET

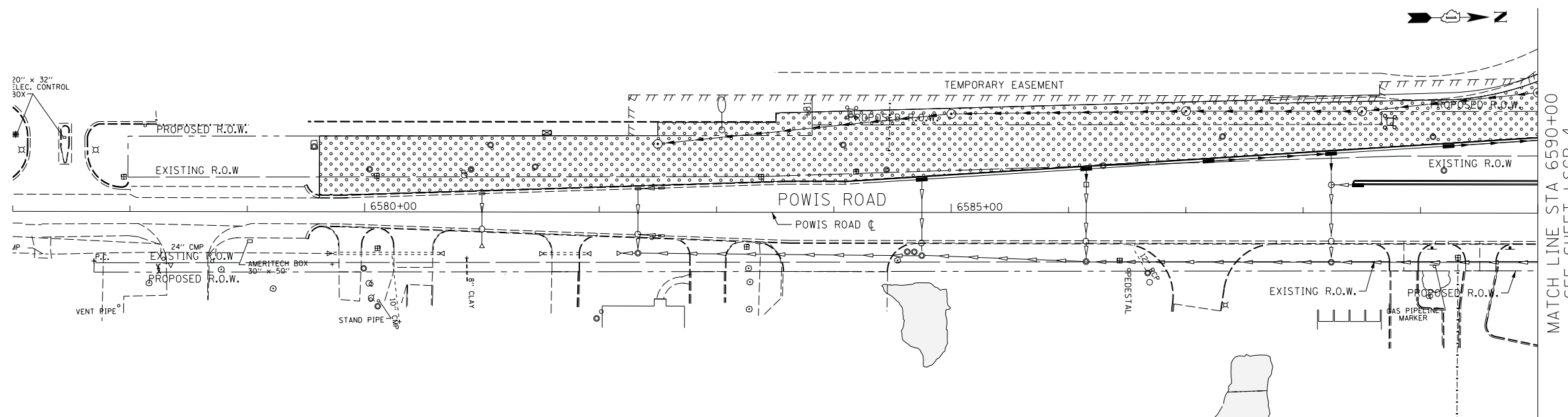

MATCH LINE STA 6594+00
SEE SHEET LSCP-4

MATCH LINE STA 6590+00
SEE SHEET LSCP-4

LSCP-9

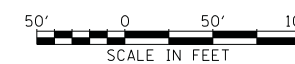

REVISIONS	
NAME	DATE

ILLINOIS DEPARTMENT OF TRANSPORTATION
 F.A.P. ROUTE 307 (ILLINOIS ROUTE 64)

LANDSCAPING PLAN
POWIS ROAD
 STA. 6579+61 TO STA. 6602+50

SCALE: VERT: NONE
 HORIZ: 1"=50'
 DATE: FEBRUARY 1, 2013

DRAWN BY: AFC
 CHECKED BY: NJH