

DATE	
BY	
FINAL SURVEY	SURVEYED
NOTE BOOK	PLOTTED
NO.	TEMPLATE
	AREAS
	CHECKED

DATE	
BY	
ORIGINAL SURVEY	SURVEYED
NOTE BOOK	PLOTTED
NO.	TEMPLATE
	AREAS
	CHECKED

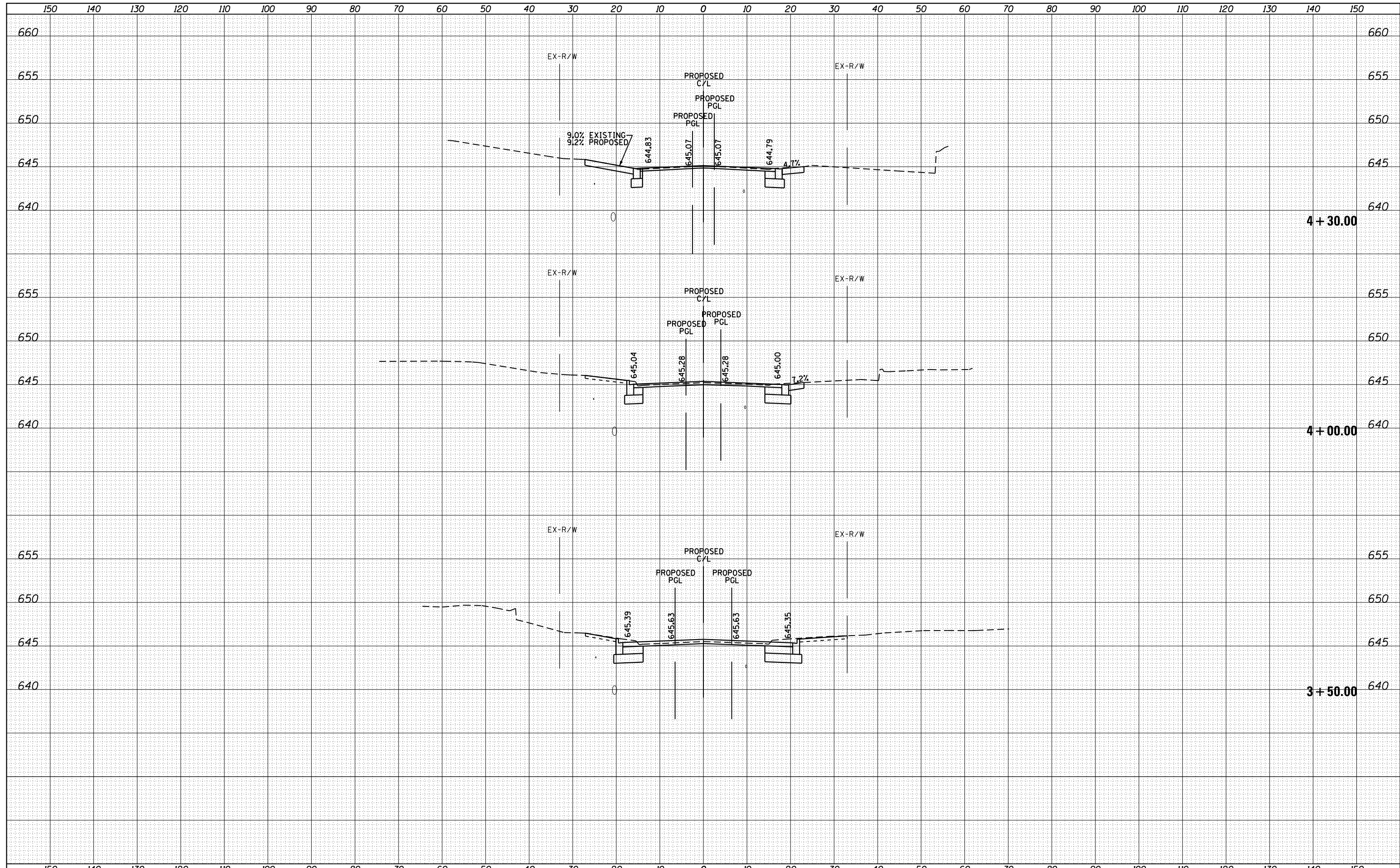

FILE NAME =	USER NAME = 1654	DESIGNED -	JWB	REVISED -		STATE OF ILLINOIS DEPARTMENT OF TRANSPORTATION	U.S. ROUTE 30 AT IL ROUTE 31 CROSS-SECTIONS - WATKINS ST		F.A.U. RTE.	SECTION	COUNTY	TOTAL SHEETS	SHEET NO.
ht:\jobs\2010\20103003\cad\site\dgn\refs-watkins	Watkins\DI60V53-sht-Watkins-xsec.dgn	DRAWN -	JWB	REVISED -			3902	12R-N	KANE	92	91		
		PLOT SCALE =	20.0000' / in.	CHECKED -	RS		REVISED -					CONTRACT NO. 60V53	
		PLOT DATE =	5/16/2013	DATE -	05/17/2013		REVISED -		SCALE: H=10', V=5'	SHEET NO. 4	OF 5 SHEETS	STA. 4+30.00	TO STA. 5+00.00