

- 1 TEMP EPOXY PVT MK LTR & SYM
- 2 TEMP EPOXY PVT MK LINE 4 (SOLID WHITE)
- 3 TEMP EPOXY PVT MK LINE 4 (2' DASH 6' SKIP, WHITE)
- 4 TEMP EPOXY PVT MK LINE 24 (WHITE STOP BAR)

NOTE:
UNLESS NOTED OTHERWISE, ALL STATIONS AND OFFSETS USED ARE TAKEN FROM EITHER EXISTING EB AND WB I-290 BASELINES

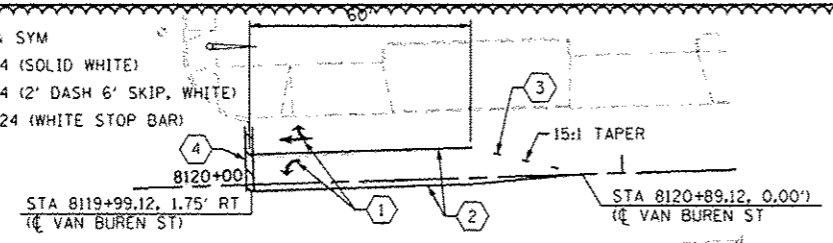

TEMPORARY EPOXY PAVEMENT MARKINGS AT RACINE AVE AND VAN BUREN ST INTERSECTION TO REMAIN FOR DETOUR ROUTES IN ALL STAGES

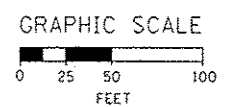
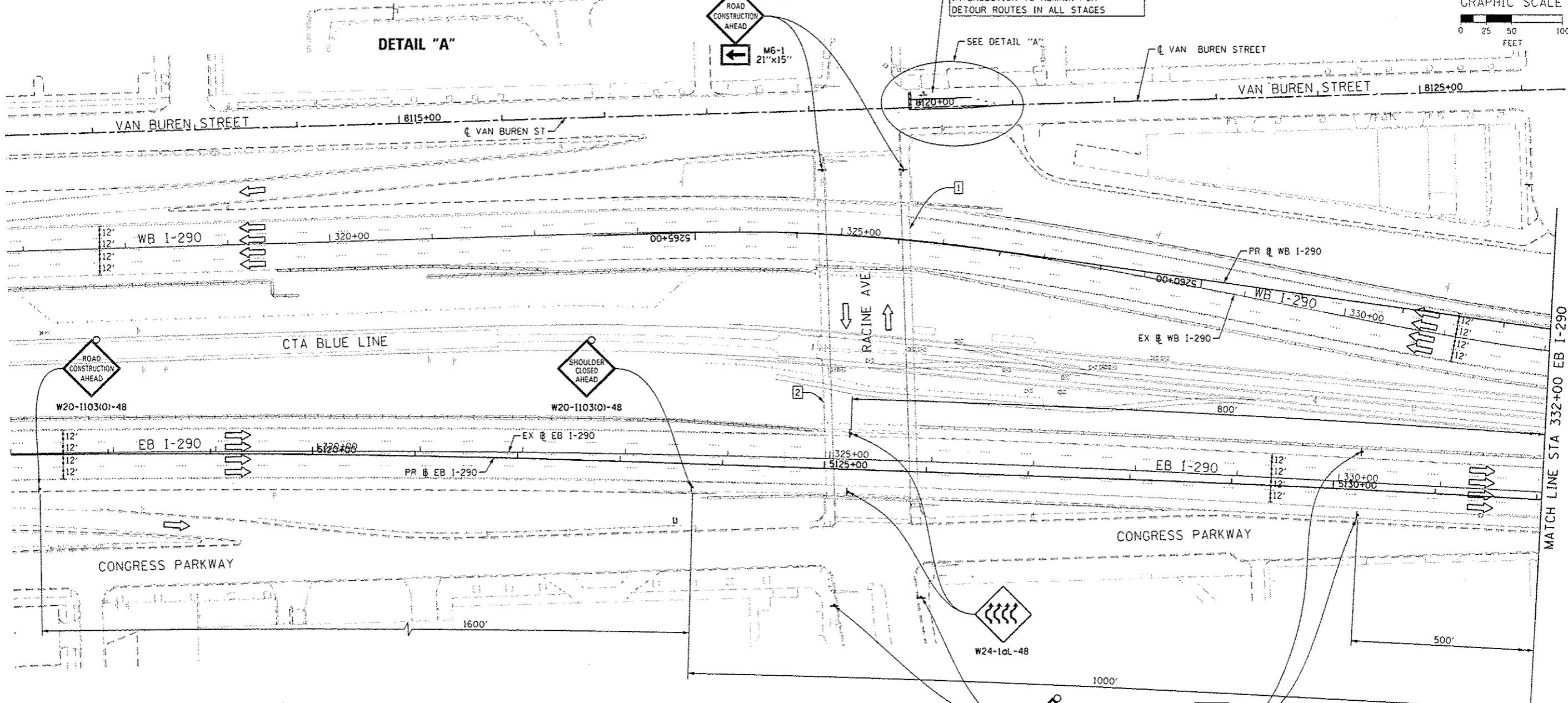

2 EXISTING OVERHEAD SIGNS TO REMAIN

1 INSTALL PROPOSED OVERHEAD BRIDGE MOUNTED SIGN ON RACINE AVE BRIDGE STRUCTURE. SEE OVERHEAD SIGN STRUCTURE PLANS (SHEETS 112 TO 121) FOR ADDITIONAL INFORMATION.

Congress Pkwy Chicago Loop ↓ ↓	 WEST Kennedy Expy Wisconsin ↓	 EAST Ryan Expy Indiana ↓
--	---	--

EXIT 28A Damen Ave 3/4 MILE	EXIT 28B Ashland Ave 1/4 MILE
---	---

WORK ZONE
SPEED LIMIT
45
PHOTO ENFORCED
SPOK FINE MINIMUM

W2-1115(O)-3618
R2-1-3648
R10-19dP-3618
R2-1106-3618



DESIGNED - OPS	REVISED - 7/19/2013
DRAWN - PHP	REVISED -
CHECKED - DBM	REVISED -
DATE - 6/17/2013	REVISED -

STATE OF ILLINOIS
DEPARTMENT OF TRANSPORTATION

SUGGESTED STAGES OF CONSTRUCTION AND TRAFFIC CONTROL
STAGE 1

SCALE: 1" = 50' SHEET 1 OF 7 SHEETS STA. TO STA.

F.A.I. RTE.	SECTION	COUNTY	TOTAL SHEETS	SHEET NO.
90/94/290	2013-007R	COOK	317	56
CONTRACT NO. 60W25				
ILLINOIS FED. AID PROJECT				

FILE PATH: C:\Users\Chuan\OneDrive\Documents\60W25-Sht-1-Stage1.dgn