

NOTE:
UNLESS NOTED OTHERWISE, ALL STATIONS AND OFFSETS USED
ARE TAKEN FROM EITHER EXISTING EB AND WB I-290 BASELINES

REMOVE, STORE, AND RE-ERECT
OVERHEAD SIGN PANEL (SPECIAL)
(TO BE REMOVED AND STORED IN
STAGE 1 AND RE-ERECTED IN
STAGE 4)

**EXIT TO
MORGAN ST
PROHIBITED**

RAMP
CLOSED
AHEAD
Morgan St
STA. 18+90.00
(NW RAMP)

WORK
ZONE
SPEED
LIMIT
45
PHOTO
ENFORCED
EXCESS
FINE
MINIMUM

W2-1115(10)-3618
R2-1-3648
R10-190P-3618
R2-1106-3618
STA. 360+00.00
(EX WB I-290)

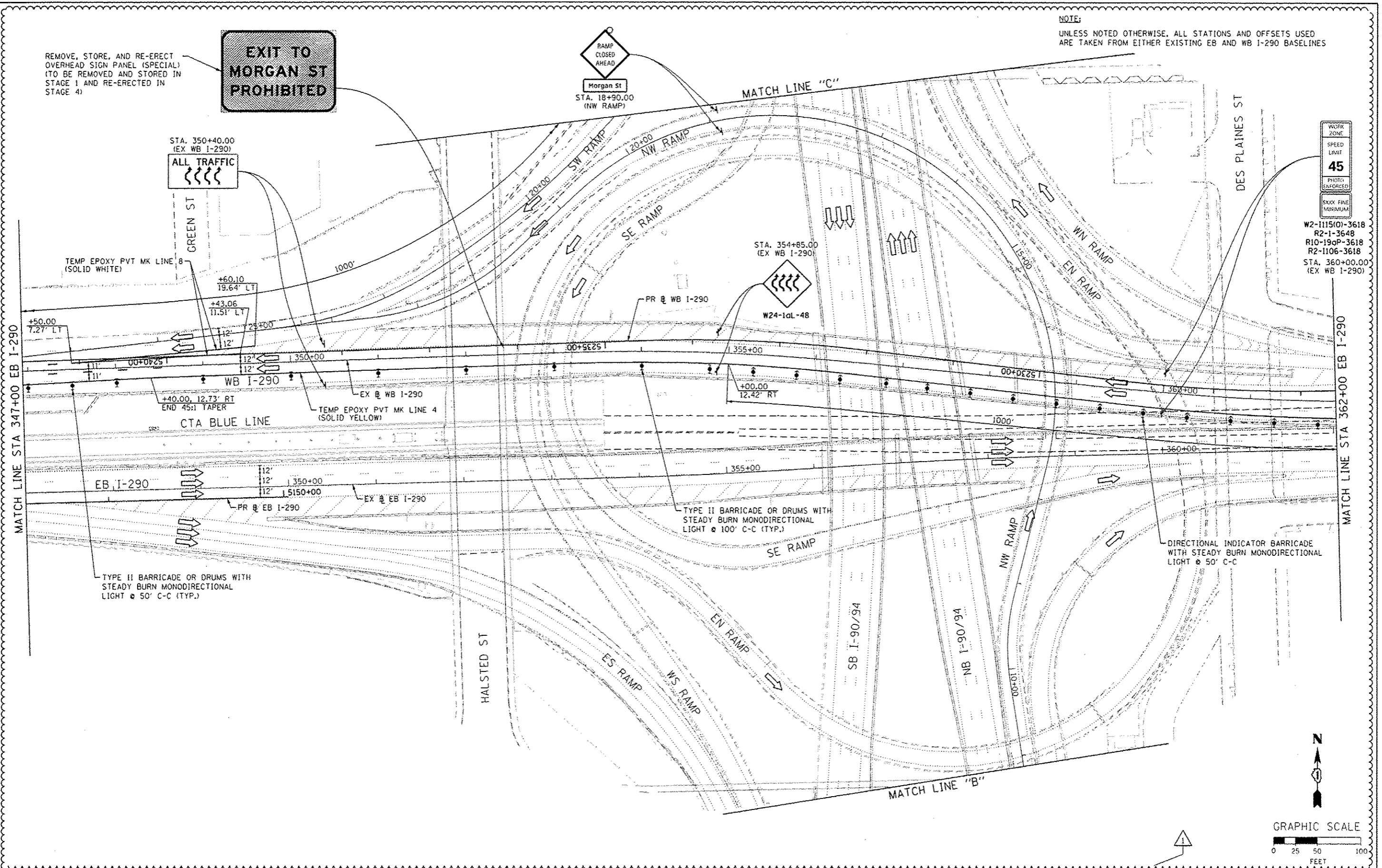

TYPE II BARRICADE OR DRUMS WITH
STEADY BURN MONODIRECTIONAL
LIGHT @ 50' C-C (TYP.)

TYPE II BARRICADE OR DRUMS WITH
STEADY BURN MONODIRECTIONAL
LIGHT @ 100' C-C (TYP.)

DIRECTIONAL INDICATOR BARRICADE
WITH STEADY BURN MONODIRECTIONAL
LIGHT @ 50' C-C

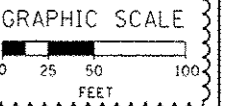
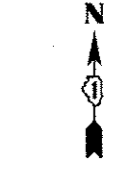

FILE PATH: C:\Users\Chuan\Desktop\60W25-5ht-Stage1-03.dgn



D:\60W25-5ht-Stage1-03.dgn	DESIGNED - OPS	REVISED - 7/19/2013
USER NAME: chuan	DRAWN - PHP	REVISED -
PLOT SCALE: 50.0000' / 1"	CHECKED - DBM	REVISED -
PLOT DATE: 7/16/2013	DATE - 6/17/2013	REVISED -

DESIGNED - OPS	REVISED - 7/19/2013
DRAWN - PHP	REVISED -
CHECKED - DBM	REVISED -
DATE - 6/17/2013	REVISED -

STATE OF ILLINOIS
DEPARTMENT OF TRANSPORTATION

SUGGESTED STAGES OF CONSTRUCTION AND TRAFFIC CONTROL
STAGE 1

SCALE: 1" = 50' SHEET 3 OF 7 SHEETS STA. TO STA.

F.A.I. RTE. 90/94/290	SECTION 2013-007R	COUNTY COOK	TOTAL SHEETS 317	SHEET NO. 58
CONTRACT NO. 60W25				
ILLINOIS FED. AID PROJECT				