

NOTE:
UNLESS NOTED OTHERWISE, ALL STATIONS AND OFFSETS USED
ARE TAKEN FROM EITHER EXISTING EB AND WB I-290 BASELINES

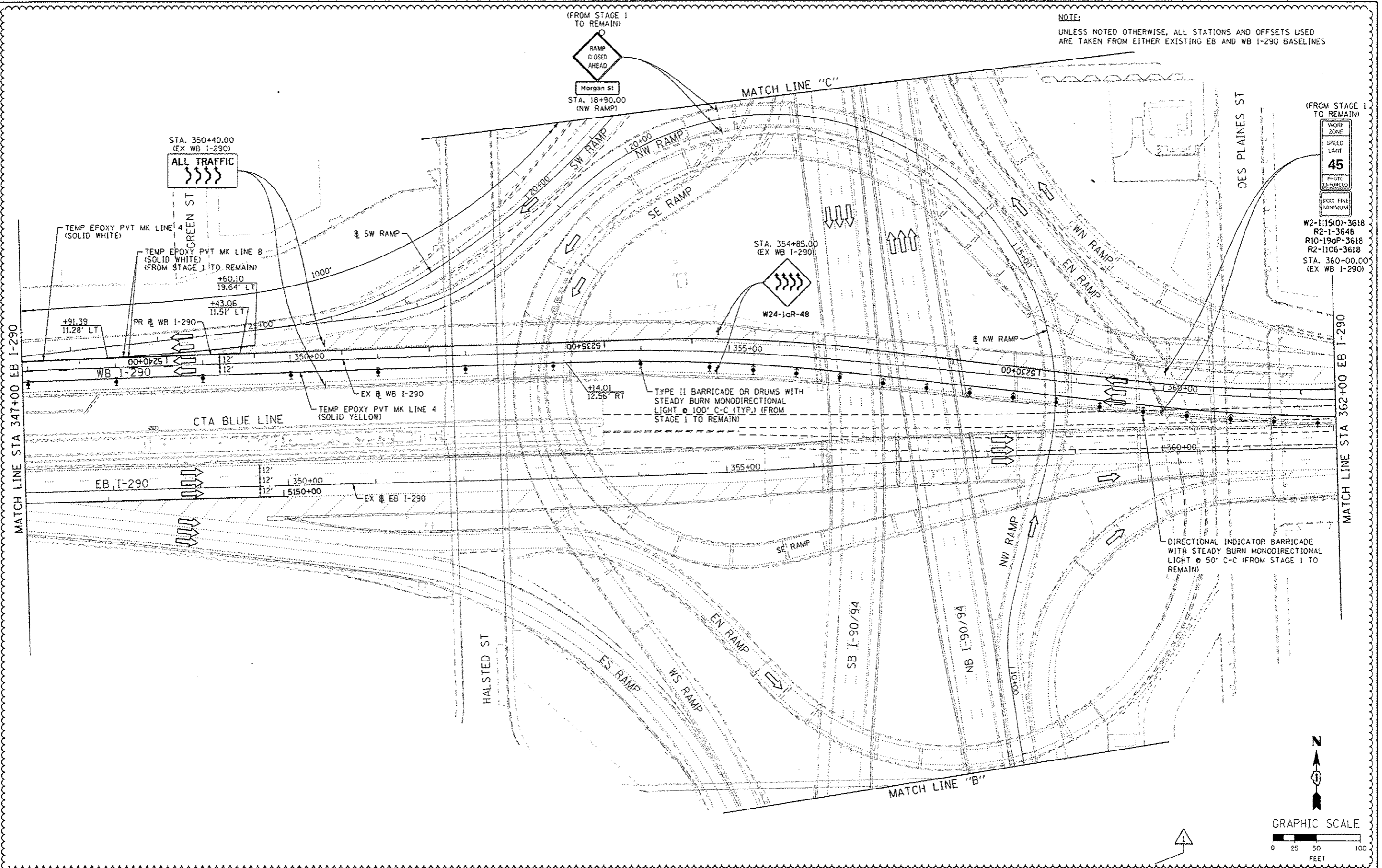

(FROM STAGE TO REMAIN)
WORK ZONE
SPEED LIMIT
45
PHOTO ENFORCED
300X FINE MINIMUM

W2-1115(0)-3618
R2-1-3648
R10-190P-3618
R2-1106-3618
STA. 360+00.00
(EX WB I-290)

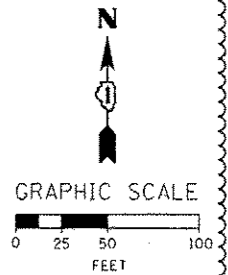

FILE PATH: C:\Users\Chuan\Desktop\1001EN2013\10159\25-111-Stage2-03.dgn



D16R25-111-Stage2-03.dgn
USER NAME: chuan
PLOT SCALE: 50.0000 1/16"
PLOT DATE: 7/16/2013

DESIGNED - OPS	REVISED - 7/19/2013
DRAWN - PHP	REVISED -
CHECKED - DBM	REVISED -
DATE - 6/17/2013	REVISED -

STATE OF ILLINOIS
DEPARTMENT OF TRANSPORTATION

SUGGESTED STAGES OF CONSTRUCTION AND TRAFFIC CONTROL
STAGE 2

SCALE: 1" = 50' SHEET 3 OF 7 SHEETS STA. TO STA.

F.A.I. RTE.	SECTION	COUNTY	TOTAL SHEETS	SHEET NO.
90/94/290	2013-007R	COOK	317	65
CONTRACT NO. 60W25				
ILLINOIS FED. AID PROJECT				