

NOTE:
UNLESS NOTED OTHERWISE, ALL STATIONS AND OFFSETS USED
ARE TAKEN FROM EITHER EXISTING EB AND WB I-290 BASELINES

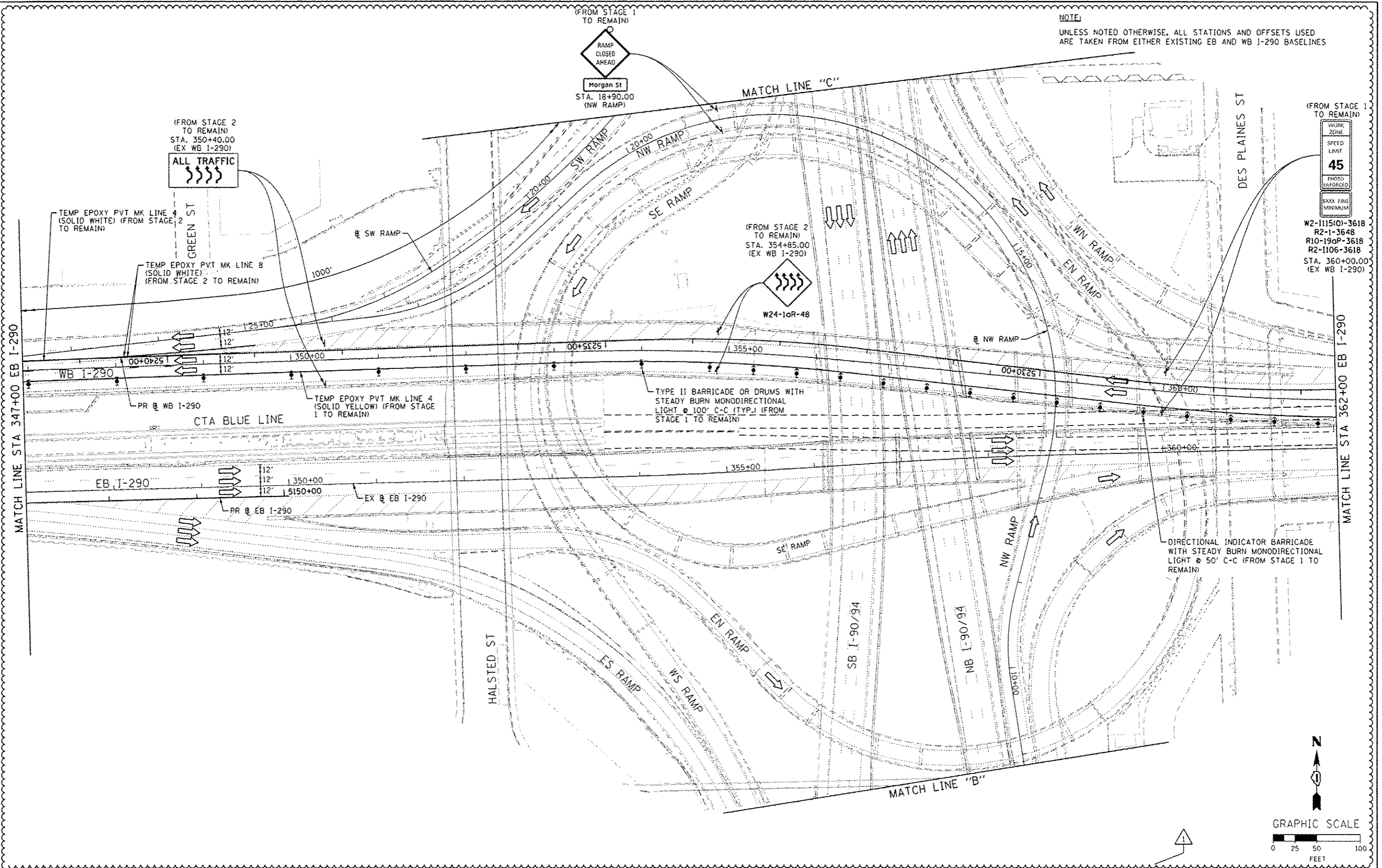

(FROM STAGE TO REMAIN)
WORK ZONE
SPEED LIMIT
45
PHOTO ENFORCED
XXXX FINE
MINIMUM

W2-1115(0)-3618
R2-1-3648
R10-190P-3618
R2-1106-3618
STA. 360+00.00
(EX WB I-290)

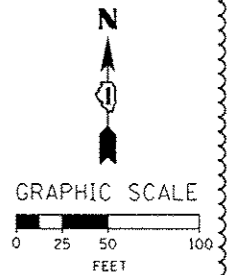

FILE PATH: C:\Users\Chuan\Desktop\I290\I290\I290-317-5-15-13.dgn



D:\E\28-st-3-03.dgn
USER NAME: chuan
PLOT SCALE: 50.0000' / 1" = 100.0000'
PLOT DATE: 7/15/2013

DESIGNED - OPS	REVISED - 7/15/2013
DRAWN - PHP	REVISED -
CHECKED - DBM	REVISED -
DATE - 5/14/2013	REVISED -

STATE OF ILLINOIS
DEPARTMENT OF TRANSPORTATION

SUGGESTED STAGES OF CONSTRUCTION AND TRAFFIC CONTROL
STAGE 3

SCALE: 1" = 50' SHEET 3 OF 7 SHEETS STA. TO STA.

F.A.I. RTE.	SECTION	COUNTY	TOTAL SHEETS	SHEET NO.
90/94/290	2013-007R	COOK	317	72
CONTRACT NO. 60W25			ILLINOIS FED. AID PROJECT	