

NOTE:  
UNLESS NOTED OTHERWISE, ALL STATIONS AND OFFSETS USED  
ARE TAKEN FROM EITHER EXISTING EB AND WB I-290 BASELINES

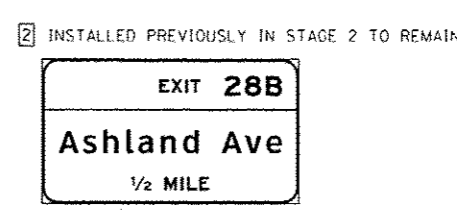
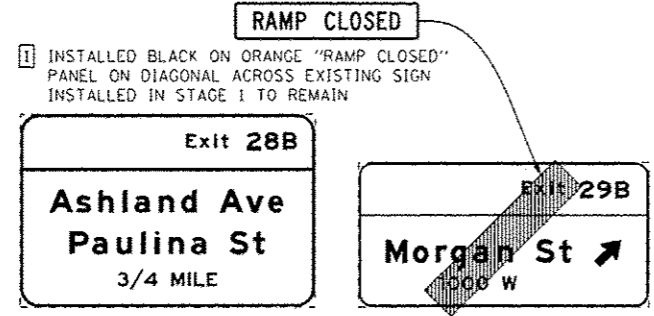
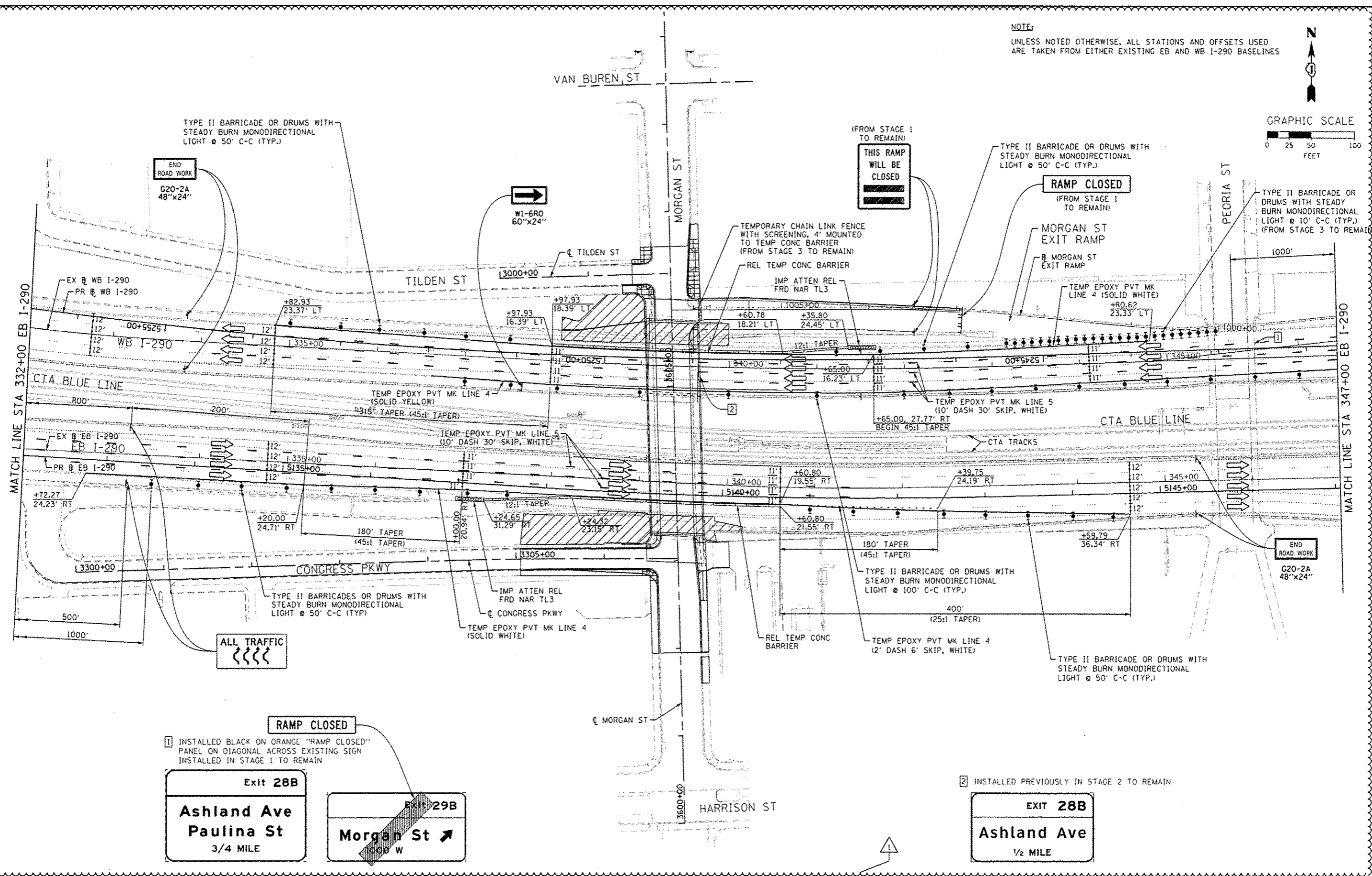
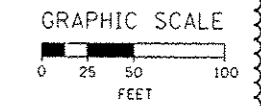

1 INSTALLED BLACK ON ORANGE "RAMP CLOSED" PANEL ON DIAGONAL ACROSS EXISTING SIGN INSTALLED IN STAGE 1 TO REMAIN

2 INSTALLED PREVIOUSLY IN STAGE 2 TO REMAIN

<p>303 EAST Wacker Drive, Suite 1400 Chicago, IL 60601-3276 Phone: (312) 315-7700 Fax: (312) 315-6800</p>	016R#25-shit-Staging4-82.dgn USER NAME: chuan PLOT SCALE: 58.0000' / 1"	DESIGNED - OPS DRAWN - PHP CHECKED - DBM DATE -	REVISED - $\Delta$ 7/19/2013 REVISED - REVISED - REVISED -
---	---	--	---

STATE OF ILLINOIS  
DEPARTMENT OF TRANSPORTATION

SUGGESTED STAGES OF CONSTRUCTION AND TRAFFIC CONTROL  
STAGE 4  
SCALE: 1" = 50' SHEET 2 OF 7 SHEETS STA. TO STA.

F.A.I. RTE.	SECTION	COUNTY	TOTAL SHEETS	SHEET NO.
90/94/290	2013-007R	COOK	317	76B
CONTRACT NO. 60W25			ILLINOIS FED. AID PROJECT	