

EXISTING CONDITIONS

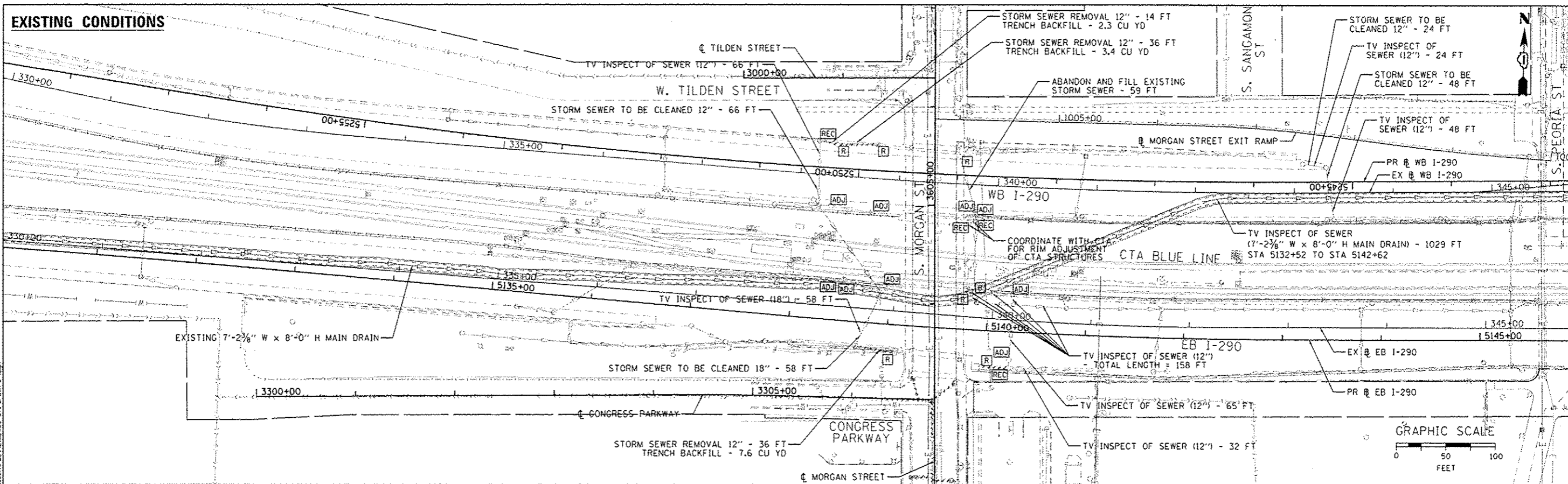

PROPOSED CONDITIONS

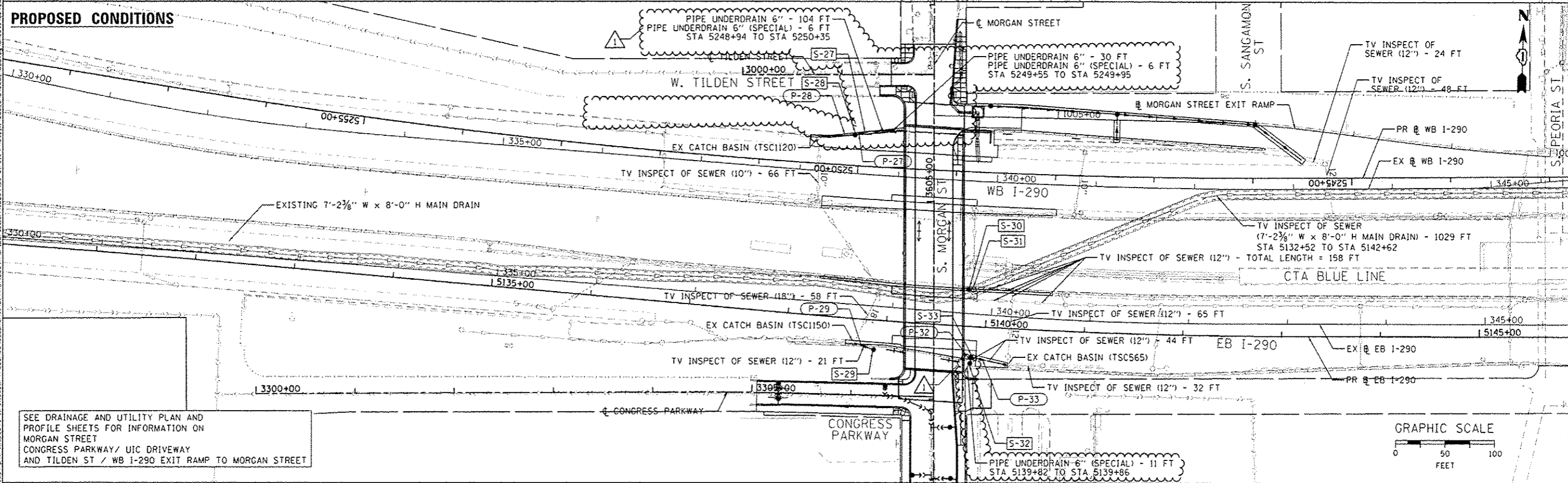

SEE DRAINAGE AND UTILITY PLAN AND PROFILE SHEETS FOR INFORMATION ON MORGAN STREET CONGRESS PARKWAY/ UIC DRIVEWAY AND TILDEN ST / WB I-290 EXIT RAMP TO MORGAN STREET



D:\60W25\st-drain\84.dgn
 USER NAME: chluo
 PLOT SCALE: 50.0000 1/31
 PLOT DATE: 7/16/2013

DESIGNED - DMS	REVISED - 7/19/2013
DRAWN - DMS	REVISED -
CHECKED - AFC	REVISED -
DATE - 6/17/2013	REVISED -

STATE OF ILLINOIS
 DEPARTMENT OF TRANSPORTATION

DRAINAGE AND UTILITY PLAN
 I-290

SCALE: 1" = 50' SHEET 1 OF 1 SHEETS STA. TO STA.

F.A.I. RTE. 90/94/290	SECTION 2013-007R	COUNTY COOK	TOTAL SHEETS 317	SHEET NO. 86
CONTRACT NO. 60W25			ILLINOIS FED. AID PROJECT	