

**SOUTHEAST WINGWALL ELEVATION**  
(Looking South - Drilled shafts are not shown for clarity)

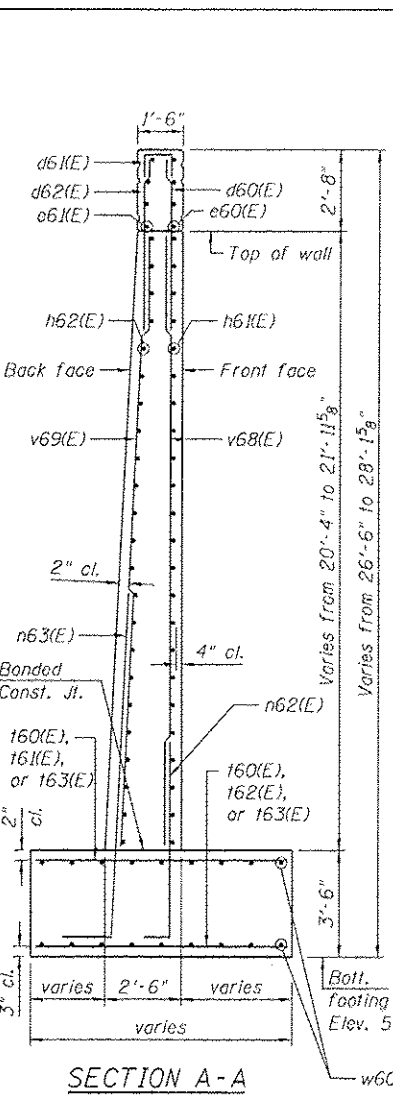

**SECTION A-A**  
(Reveal and Drilled shafts are not shown for clarity)

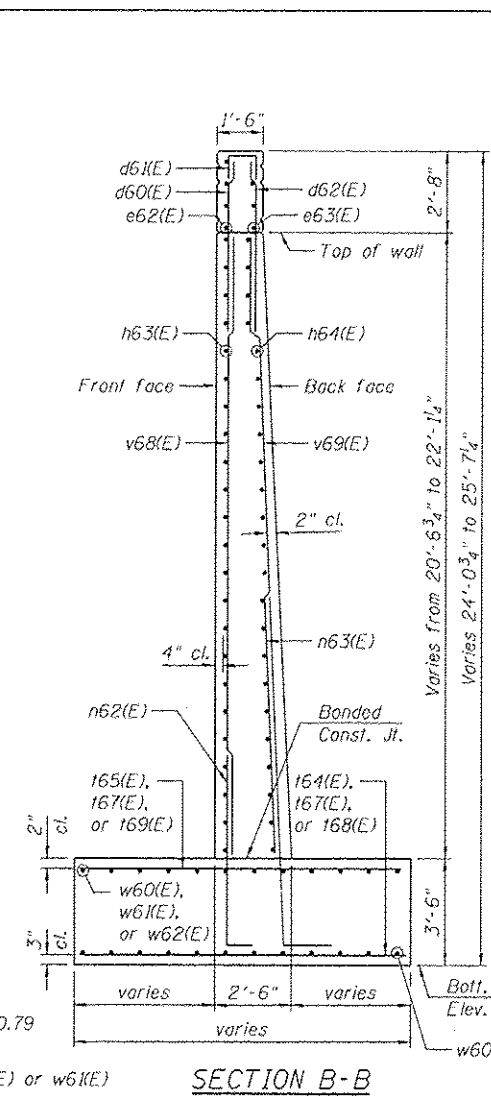

**SECTION B-B**  
(Reveal and Drilled shafts are not shown for clarity)

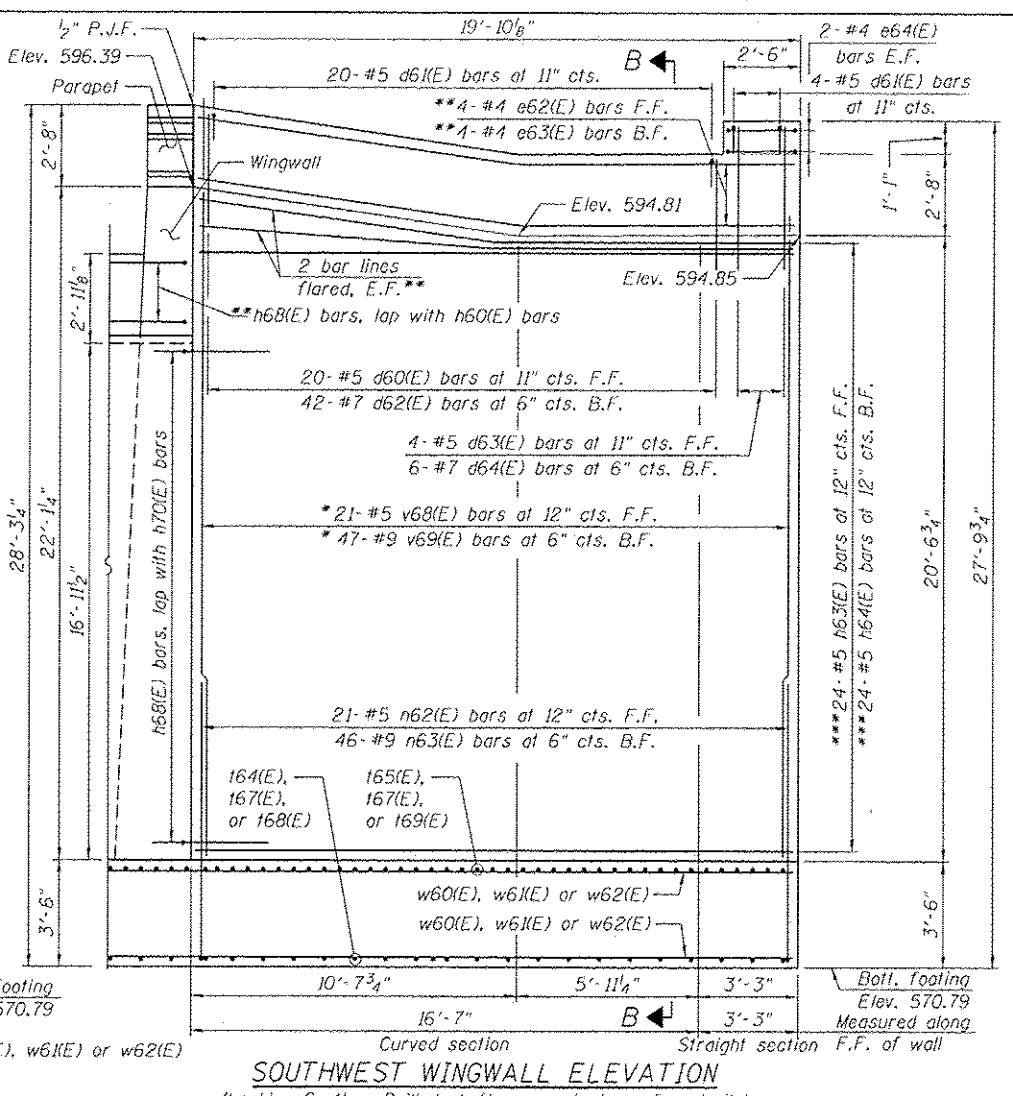

**SOUTHWEST WINGWALL ELEVATION**  
(Looking South - Drilled shafts are not shown for clarity)

**BAR TABLE SCHEDULE**

Bar	No. of Sets Req'd	No. of Bars Per Set	A	B	C
161(E)	1	7	8'-4"	14'-4"	22'-8"
162(E)	1	4	8'-4"	14'-4"	22'-8"
164(E)	1	4	14'-10"	21'-0"	35'-10"
165(E)	1	7	14'-10"	21'-0"	35'-10"
168(E)	1	4	11'-2"	17'-0"	28'-2"
169(E)	1	7	11'-2"	17'-0"	28'-2"

- NOTES:**
- Reinforcement bars designated (E) shall be epoxy coated.
  - For drilled shaft details and Bill of Materials, see Sheet S1-29.
  - Concrete required for parapet shall be included with Concrete Superstructure.
  - For wingwall Braced Excavation and granular backfill for structures details, see Sheet S1-28.
  - For working points, see Sheet S1-28.
  - For reveal details, see Sheet S1-31.

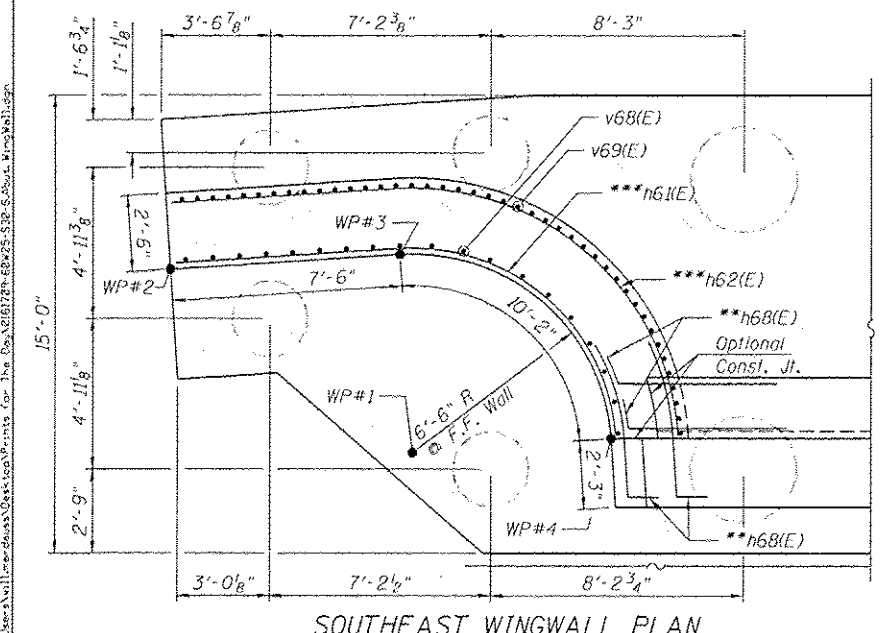

**SOUTHEAST WINGWALL PLAN**

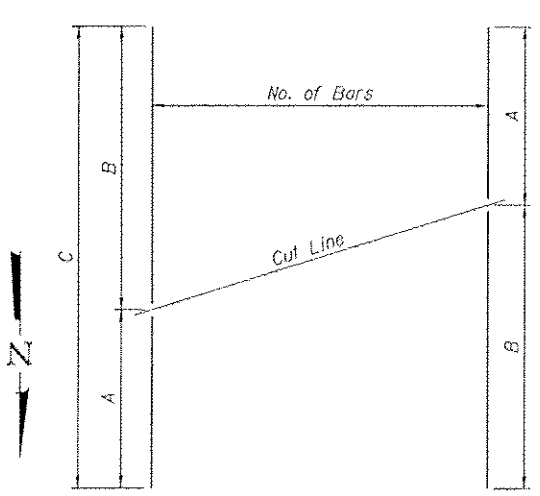

**BAR CUTTING DIAGRAM**

See table for dimensions. Make all cuts normal to bar axis

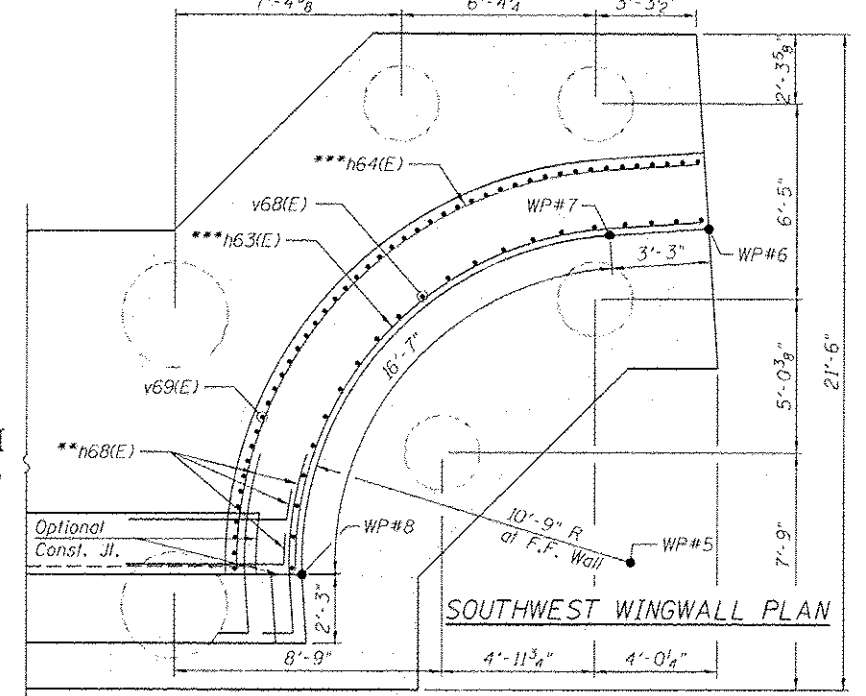

**SOUTHWEST WINGWALL PLAN**