

BILL OF MATERIAL

Bar	No.	Size	Length	Shape
h90(E)	4	#5	30'-9"	
h91(E)	16	#6	24'-7"	
h92(E)	10	#8	24'-7"	
h93(E)	4	#5	29'-1"	
h94(E)	16	#6	22'-11"	
h95(E)	10	#8	22'-11"	
h96(E)	2	#5	25'-9"	
h97(E)	2	#5	27'-5"	
n90(E)	112	#9	15'-5"	
p90(E)	10	#9	30'-9"	
p91(E)	5	#9	24'-3"	
p92(E)	10	#9	16'-1"	
p93(E)	4	#5	5'-8"	
p94(E)	10	#9	29'-1"	
p95(E)	5	#9	22'-3"	
p96(E)	4	#5	4'-0"	
sp90	190	#6	12'-2"	
s91(E)	112	#6	6'-11"	
s92(E)	64	#5	3'-8"	
s93(E)	64	#5	5'-5"	
s94(E)	64	#5	8'-0"	
s95(E)	97	#6	24'-4"	
** sp90	8	#4	81'-7"	
u90(E)	8	#6	9'-10"	
u91(E)	12	#4	7'-4"	
u92(E)	20	#6	10'-8"	
v90(E)	56	#8	15'-11"	
v91	336	#9	32'-9"	
Structure Excavation	Cu Yd	28		
Concrete Structures	Cu Yd	94.6		
Reinforcement Bars	Pound	44,870		
Reinforcement Bars, Epoxy Coated	Pound	24,260		
Permanent Casing	Foot	628		
Drilled Shaft in Soil	Cu Yd	224		
Drilled Shaft in Rock	Cu Yd	7		
Concrete Sealer	Sq Ft	2,247		
Granular Backfill for Structures	Cu Yd	27		

**Length is height of spiral

NOTES:

1. Reinforcement bars designated (E) shall be epoxy coated.
2. Bars noted thus, 14x3-#5 indicates 14 lines of bars with 3 lengths of bars per line.
3. Bars equally spaced, unless otherwise noted.
4. Apply concrete sealer to all exposed concrete surfaces of the pier.
5. All edges shall have standard 3/4" chamfer.
6. Spirals are measured vertically.

Bar	Lap
#4	2'-7"
#5	3'-3"
#6	3'-10"
#7	5'-2"
#8	6'-9"
#9	8'-7"

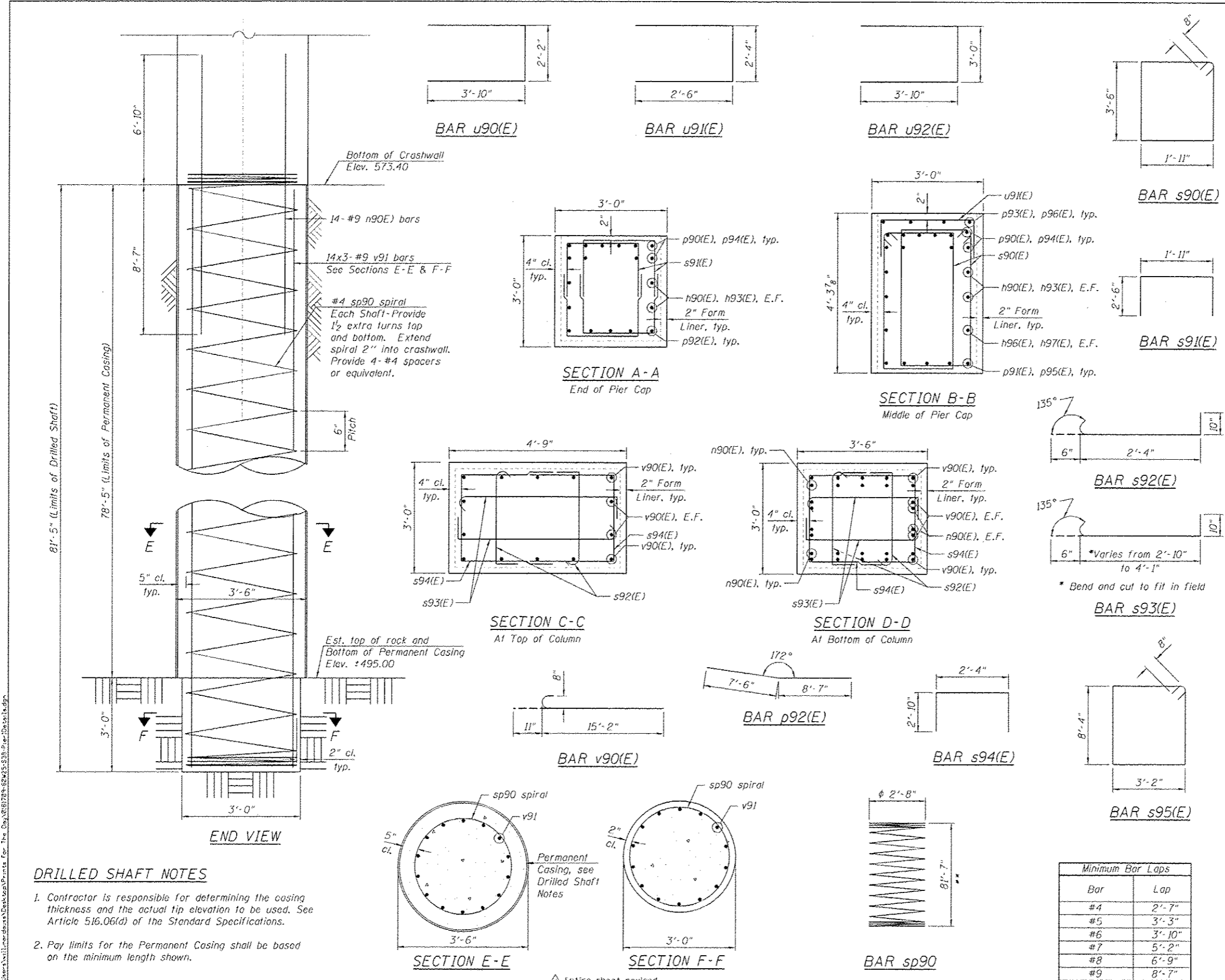

DRILLED SHAFT NOTES

1. Contractor is responsible for determining the casing thickness and the actual tip elevation to be used. See Article 516.06(d) of the Standard Specifications.
2. Pay limits for the Permanent Casing shall be based on the minimum length shown.

FILE PATH: C:\Users\will.mardoux\Desktop\Projects For The Dept\B1709-016-25-09-Per-Detail.dgn
 HBM ENGINEERING GROUP, LLC
 4415 WEST HARRISON ST.
 SUITE 231
 HILLSDALE, IL 60142
 (630) 236-0900
 FAX: (630) 236-0901