

DATE	
BY	
PLAN	
NO.	
CHECKED	
DATE	
NO.	

DATE	
BY	
PROFILE	
NO.	
CHECKED	
DATE	
NO.	

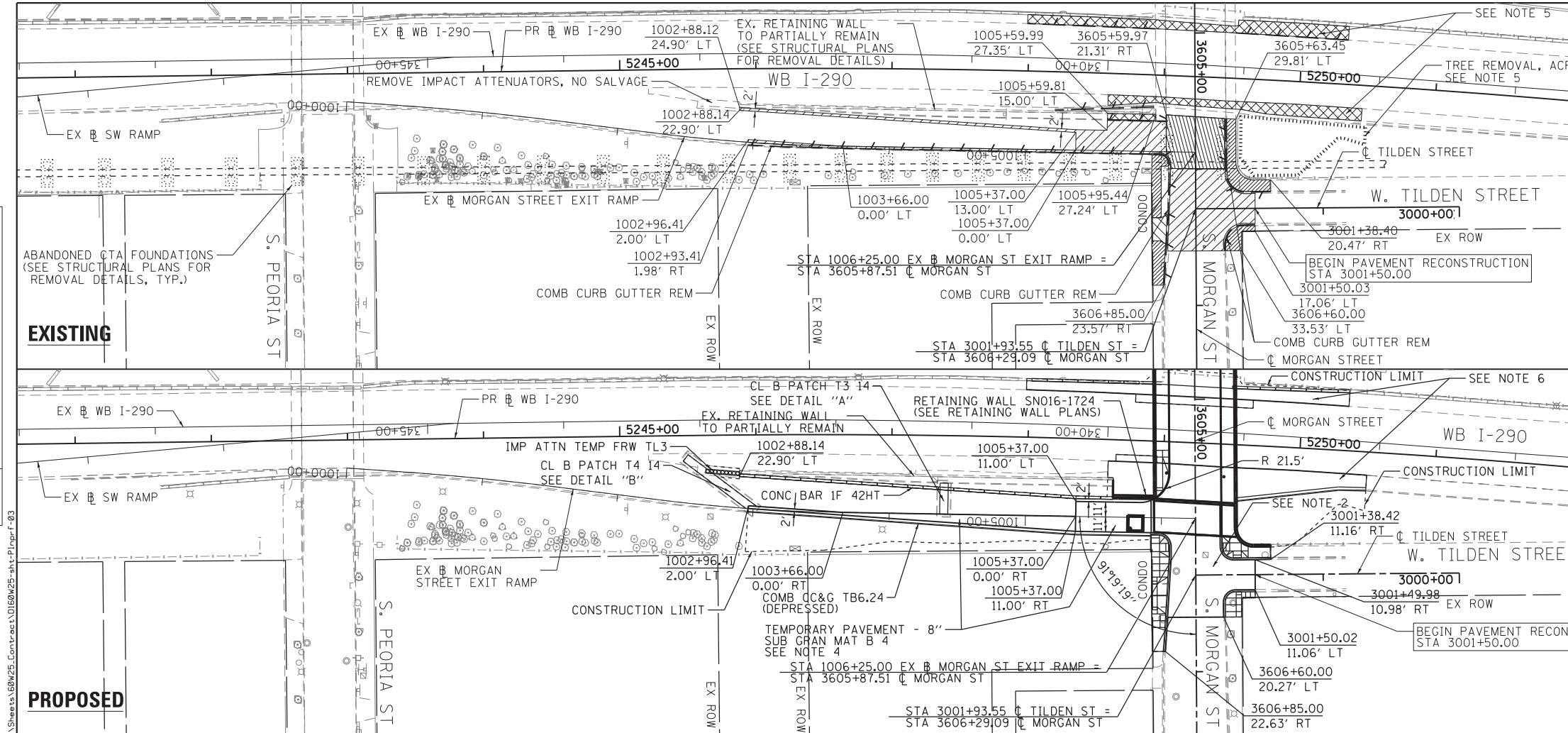

PAVEMENT REMOVAL LEGEND

- PAVEMENT REMOVAL
- PAVED SHOULDER REMOVAL
- DRIVEWAY PAVEMENT REMOVAL
- APPROACH SLAB REMOVAL
- SIDEWALK REMOVAL
- PARKING LOT PAVEMENT REMOVAL
- LINEAR REMOVAL
- TREE REMOVAL, ACRES

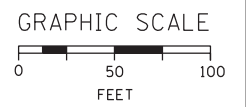

NOTES

1. SEE CURB RAMP DETAIL FOR ADA RAMP INFORMATION.
2. SEE INTERSECTION DETAIL FOR INTERSECTION TRANSITION INFORMATION.
3. ALL STATIONS AND OFFSETS ARE BASED ON THE BASELINE FOR THE INTERIM CONDITION OF THE EXIT RAMP.
4. USE PORTLAND CEMENT CONCRETE PAVEMENT 8" FOR THE TEMPORARY PAVEMENT ON THE MORGAN STREET EXIT RAMP (INTERIM CONDITION).
5. SEE I-290 REMOVAL PLAN FOR ADDITIONAL INFORMATION.
6. SEE I-290 ROADWAY PLAN FOR ADDITIONAL INFORMATION.

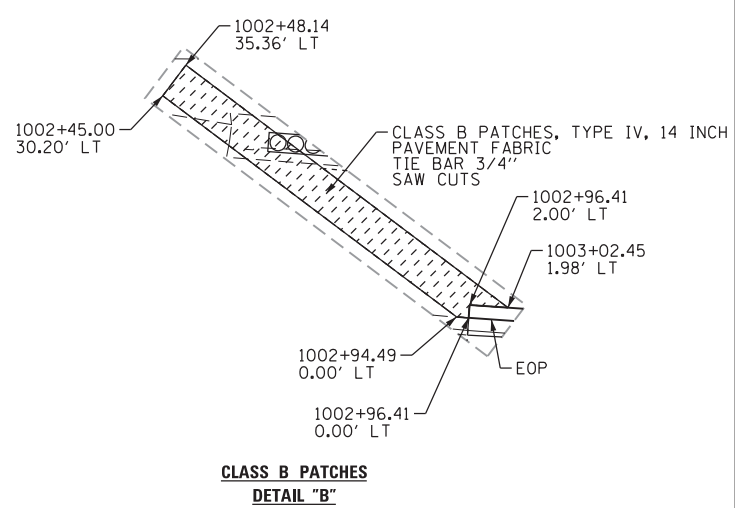
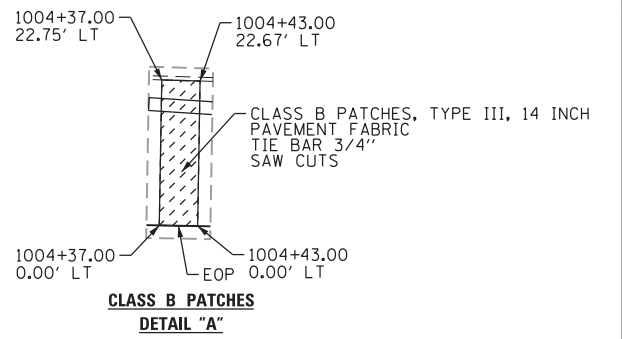
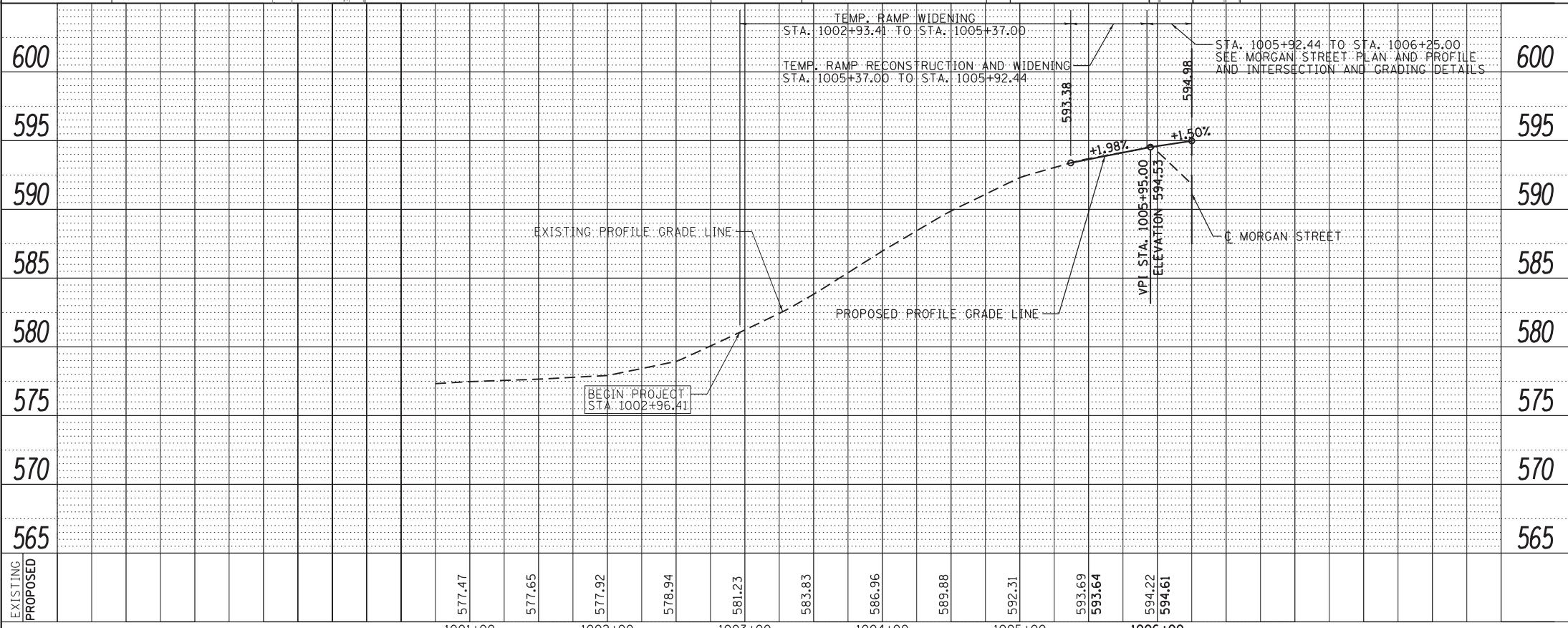
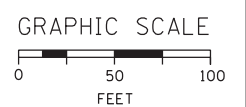

Di60w25-sht-Plnprf-03
 USER NAME = chiuo
 PLOT SCALE = 50.0000' / in.
 PLOT DATE = 6/14/2013

DESIGNED - AFC	REVISED -
DRAWN - AFC	REVISED -
CHECKED - DBM	REVISED -
DATE - 6/17/2013	REVISED -

STATE OF ILLINOIS
 DEPARTMENT OF TRANSPORTATION

PLAN & PROFILE -
 MORGAN STREET EXIT RAMP AND TILDEN STREET

SCALE: 1" = 50' SHEET 1 OF 1 SHEETS STA. TO STA.

F.A.I. R.E.	SECTION	COUNTY	TOTAL SHEETS	SHEET NO.
90/94/290	2013-007R	COOK	317	44
CONTRACT NO. 60W25				

ILLINOIS FED. AID PROJECT

FILE PATH = p:\388935-par\1\escomon\me\local\p\AECD0000\Documents\01\Americas\Transportation\60269938_Circle\Phase\I\000_CAD\005_Roadway\Sheets\60w25-sht-Plnprf-03