

**TRAFFIC CONTROL NOTES**

1. Detour signing must be installed prior to closure of the Morgan Street Bridge.
2. The contractor is responsible for coordination with other road work in the area.
3. See Suggested Stages of Construction (Stage 1, Sheet 2 of 8) for installation of temporary pavement markings necessary for this detour.
4. "CTA ENTRANCE CLOSED USE HALSTED ST ENTRANCE" signs should be used as shown (this sheet) during Stage 1 of the Suggested Stages of Construction and removed when pedestrian access to the Morgan St. CTA station is re-opened in Stage 2.

**LEGEND**

- NORTHBOUND MORGAN DETOUR ROUTE
- SOUTHBOUND MORGAN DETOUR ROUTE
- ARROW BOARD
- TEMPORARY SIGN
- SIGN BARRICADE TYPE III
- ROADWAY DIRECTION

W20-3 48"x48"	W20-3 48"x48"	W20-2 48"x48"
M3-1 24"x12"	M3-3 24"x12"	CUSTOM SPECIAL BLACK LETTERS ON ORANGE BACKGROUND 30"x18"
R3-1 24"x24"	R3-2 24"x24"	R11-1101 24"x18"
R11-2 48"x30"	M4-8A 24"x18"	R11-4 60"x30"
M4-10L 48"x18"	M4-10R 48"x18"	CUSTOM SPECIAL BLACK LETTERS ON ORANGE BACKGROUND 48"x24"
M4-9R 24"x30"	M4-9L 24"x30"	M4-9 24"x30"
M4-9L 30"x24"	M4-9R 30"x24"	

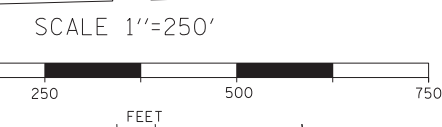
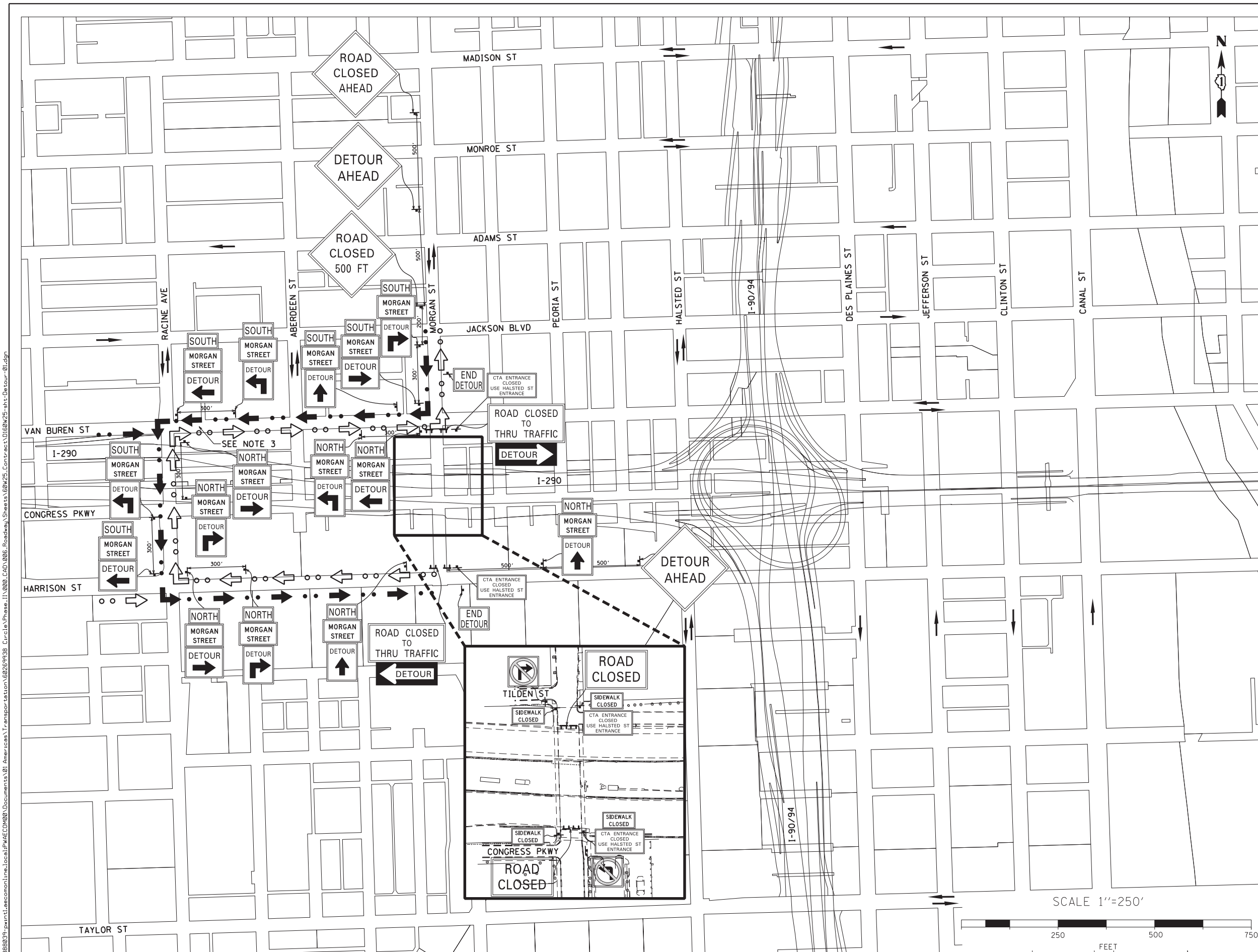

FILE PATH = p:\388035\pmt\lecom\line\local\p\AECOM\00\Documents\01\_Americas\Transportation\66269938\_Circle\Phase\1\000\_CAD\005\_Roadway\_Sheets\66W25-sht-Detour-01.dgn



D160W25-sht-Detour-01.dgn  
 USER NAME = maronik  
 PLOT SCALE = 250.0000' / in.  
 PLOT DATE = 6/11/2013

DESIGNED - JRB	REVISED -
DRAWN - JRB	REVISED -
CHECKED - SLW	REVISED -
DATE - 6/17/2013	REVISED -

**STATE OF ILLINOIS  
 DEPARTMENT OF TRANSPORTATION**

**MORGAN STREET DETOUR PLAN**

SCALE: 1"=250' SHEET 1 OF 2 SHEETS STA. TO STA.

F.A.I. R.E.	SECTION	COUNTY	TOTAL SHEETS	SHEET NO.
90/94/290	2013-007R	COOK	317	47
CONTRACT NO. 60W25			ILLINOIS FED. AID PROJECT	