

NOTE:
UNLESS NOTED OTHERWISE, ALL STATIONS AND OFFSETS USED
ARE TAKEN FROM EITHER EXISTING EB AND WB I-290 BASELINES

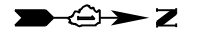

GRAPHIC SCALE

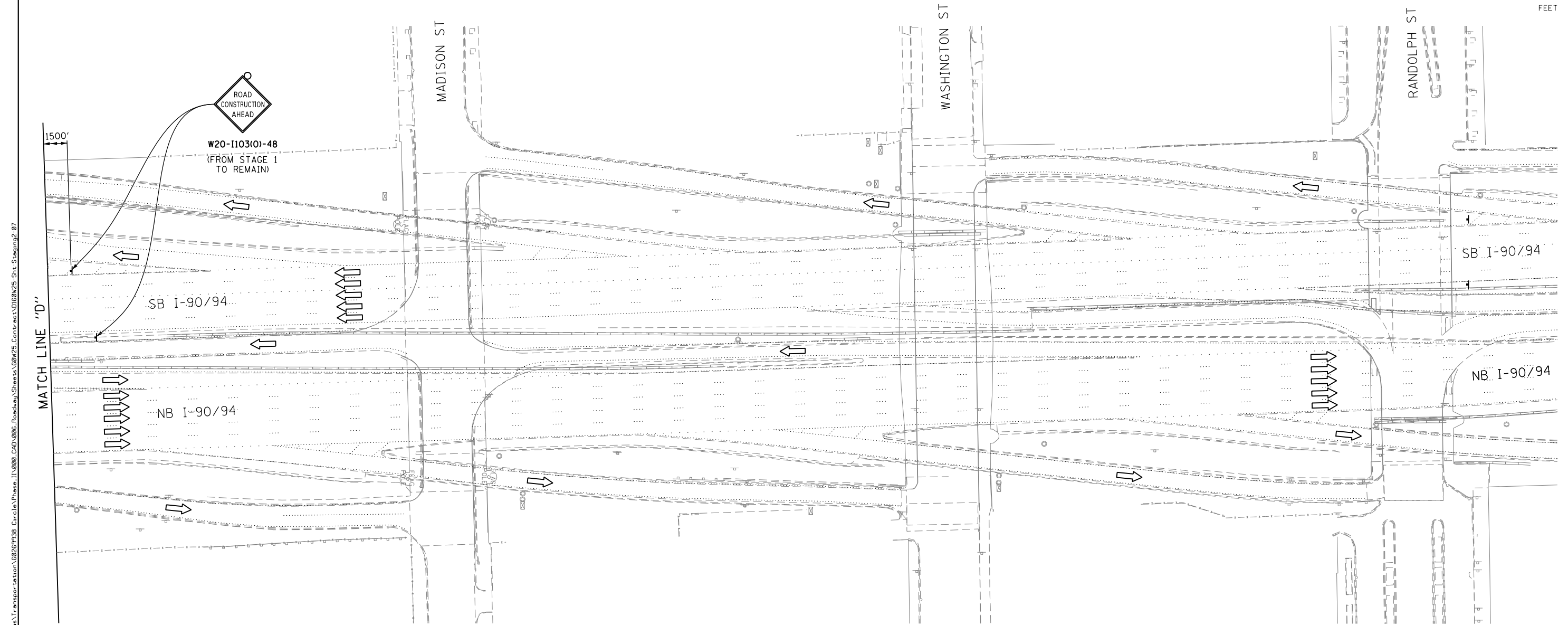

FILE PATH = p:\388035\pmt\escomon\line\local\AECOM\Documents\01_Americas\Transportation\60269938_Circle\Phase_1\000_CAD\006_Roadway\Sheets\60W25_Contract\0160W25-Sht-Staging2-07



DI60W25-Sht-Staging2-07
USER NAME = potelp2
PLOT SCALE = 50.0000' / in.
PLOT DATE = 5/15/2013

DESIGNED - OPS
DRAWN - PHP
CHECKED - DBM
DATE - 5/14/2013

REVISED -
REVISED -
REVISED -
REVISED -

STATE OF ILLINOIS
DEPARTMENT OF TRANSPORTATION

SUGGESTED STAGES OF CONSTRUCTION AND TRAFFIC CONTROL
STAGE 2

SCALE: 1" = 50' SHEET 7 OF 7 SHEETS STA. TO STA.

F.A.I. RTE.	SECTION	COUNTY	TOTAL SHEETS	SHEET NO.
90/94/290	2013-007R	COOK	317	69
CONTRACT NO. 60W25			ILLINOIS FED. AID PROJECT	