

CROSS SECTIONS, STATIONING AND OFFSETS SHOWN
REFERENCE THE PROPOSED WB I-290 BASELINE

DATE	
BY	
FINAL SURVEY	
PLOTTED	
TEMPLATE	
NOTE BOOK	
AREAS CHECKED	
NO.	

DATE	
BY	
ORIGINAL SURVEY	
PLOTTED	
TEMPLATE	
NOTE BOOK	
AREAS CHECKED	
NO.	

FILE PATH = p:\388039\p\m\l\ecommon\lme\local\p\m\ec\00\Documents\01\Americas\Transportation\60269938_Circle\Phase 1\000_CDD\006_Roadway\Sheets\60W25-shr-Xsht-03

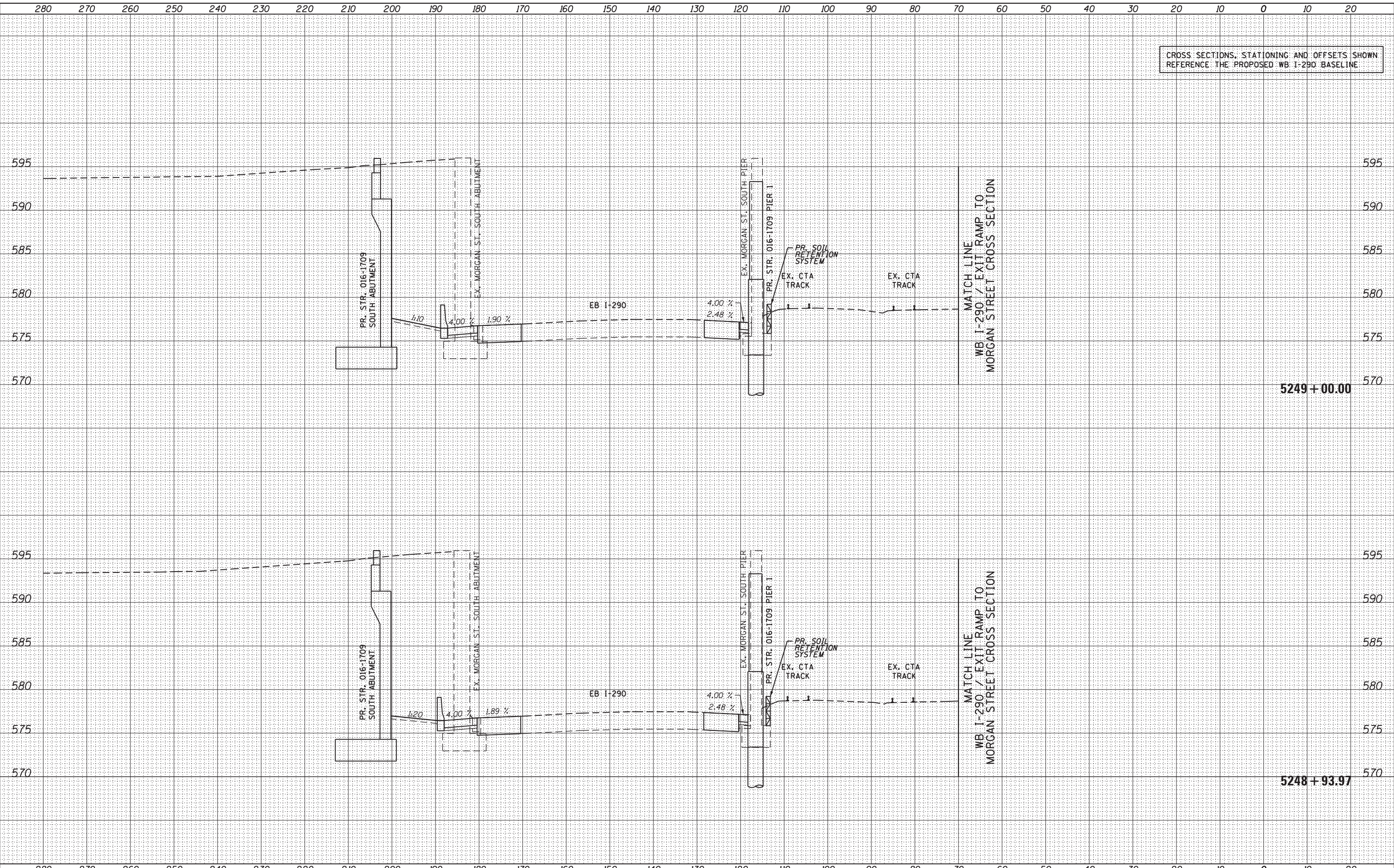

D160W25-shr-Xsht-03
 USER NAME = pimsarno
 PLOT SCALE = 10.0000' / 1"
 PLOT DATE = 6/14/2013

DESIGNED - AFC / KAM
 DRAWN - AFC / KAM
 CHECKED - DBM
 DATE - 6/17/2013

REVISED -
 REVISED -
 REVISED -
 REVISED -

STATE OF ILLINOIS
 DEPARTMENT OF TRANSPORTATION

EB I-290 / CONGRESS PARKWAY CROSS SECTION

SCALE: 1:5V, 1:10H SHEET 27 OF 33 SHEETS STA. 5248+93.97 TO STA. 5249+00.00

F.A.I. RTE.	SECTION	COUNTY	TOTAL SHEETS	SHEET NO.
90/94/290	2013-007R	COOK	317	299
CONTRACT NO. 60W25				
ILLINOIS FED. AID PROJECT				