

FAP ROUTE 599 (IL 92) SECTION (83MFT & 103MFT)W ROCK ISLAND COUNTY

F.A.P. RTE. 599	SECTION (83MFT & 103MFT)W	COUNTY ROCK ISLAND ILLINOIS	TOTAL SHEETS 340	SHEET NO. 1
			CONTRACT NO. 64H11	

STATE OF ILLINOIS
DEPARTMENT OF TRANSPORTATION
DIVISION OF HIGHWAYS
**PROPOSED
HIGHWAY PLANS**

FAP ROUTE 599 (IL 92)
SECTION (83MFT & 103MFT)W
PROJECT; F-HSIP-0599(024)

ROCK ISLAND COUNTY

C-92-062-12

R.4W. ← → R.3W.

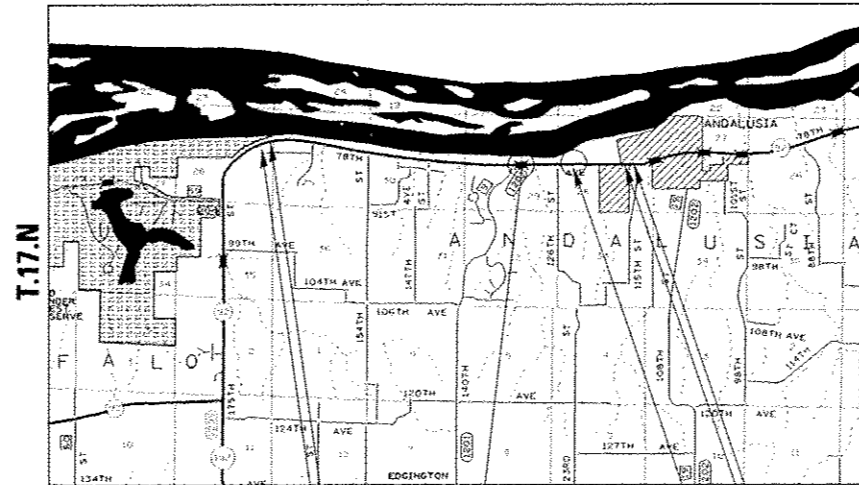

IMPROVEMENT BEGINS
STA 802+15

PROJECT BEGINS
STA 802+90

BRIDGE OMISSION
STA 951+45 - 952+43

IMPROVEMENT ENDS
STA 1018+59

PROJECT ENDS
STA 1017+84

CULVERT OMISSION
STA 995+64 - 997+03

GROSS LENGTH = 21644 FT. = 4.09 MILES

NET LENGTH = 21408 FT. = 4.05 MILES

FOR INDEX OF SHEETS, SEE SHEET NO. 2

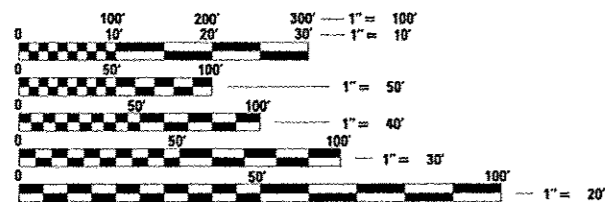

FULL SIZE PLANS HAVE BEEN PREPARED USING STANDARD ENGINEERING SCALES. REDUCED SIZED PLANS WILL NOT CONFORM TO STANDARD SCALES. IN MAKING MEASUREMENTS ON REDUCED PLANS, THE ABOVE SCALES MAY BE USED.

J.U.L.I.E.
JOINT UTILITY LOCATION INFORMATION FOR EXCAVATION
1-800-892-0123
OR 811

PROJECT ENGINEER: JENNIFER LUBBS (815)-284-5958
PROJECT MANAGER: REBECCA MARRUFFO
BUFFALO PRAIRIE TOWNSHIP, SECTION 25,26
ANDALUSIA TOWNSHIP, SECTION 28,29,30
CONTRACT NO. 64H11

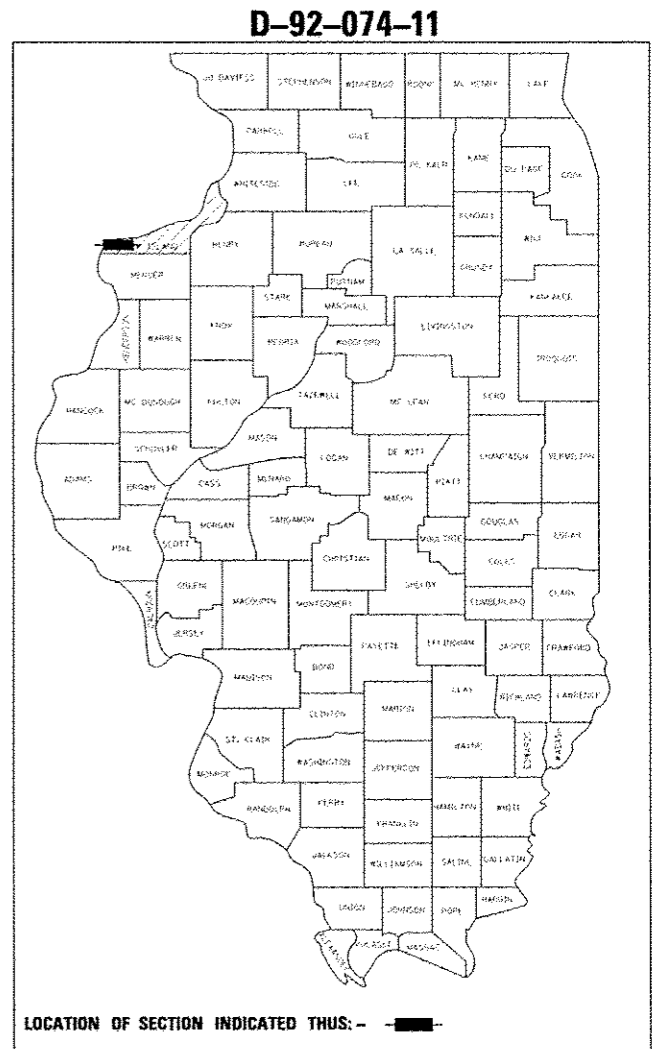

STATE OF ILLINOIS
DEPARTMENT OF TRANSPORTATION
DIVISION OF HIGHWAYS

SUBMITTED MARCH 22 20 13

Paul A. Soeta
DEPUTY DIRECTOR OF HIGHWAYS, REGION ENGINEER

MAY 10 20 13
John D. Baranelli, P.E. for
ENGINEER OF DESIGN AND ENVIRONMENT

MAY 10 20 13
Omer Osman, P.E. for
DIRECTOR OF HIGHWAYS, CHIEF ENGINEER

**PRINTED BY THE AUTHORITY
OF THE STATE OF ILLINOIS**