

Existing Structure: Existing culvert is a 36" corrugated metal pipe with a nominal 30" ID plastic liner pipe. The existing culvert is approximately 60'-0" out to out headwalls. The end sections are reinforced concrete end sections that consist of headwall, apron and wingwalls. The upstream end of the existing culvert will be extended with a concrete end section and drop box. One lane of traffic to be maintained at all times utilizing staged construction.

No salvage.

DESIGN SPECIFICATIONS
2002 AASHTO Bridge Design Specifications

DESIGN STRESSES

FIELD UNITS

$f'_c = 3,500$ psi
 $f_y = 60,000$ psi (Reinforcement)

GENERAL NOTES

- Plan dimensions and details have been taken from existing plans or survey/field checks. As such, these dimensions and details are subject to nominal construction variations. The Contractor shall field verify existing dimensions and details affecting new construction and make necessary approved adjustments prior to construction or ordering of materials. Such variations shall not be cause for additional compensation for a change in scope of the work, however, the Contractor will be paid for the quantity actually furnished at the unit price bid for the work.
- The barrel slab and walls shall be poured monolithically with the drop box.
- All exposed concrete edges shall be chamfered $\frac{3}{4}$ " unless otherwise noted.
- All construction joints shall be bonded.
- The contract unit price "Each" for Box Culvert End Sections of the culvert end section specified shall include the Concrete Box Culverts, Reinforcement Bars, Earth Excavation where required and necessary grading to fit the structures as shown, or to the slope.
- This work shall be done according to the applicable portion of 501, 503, 505, 508, 540 and 584 of the Standard Specifications.
- Drainage holes shall conform to the requirements of Article 503.11 of the Standard Specifications.
- A precast option will not be allowed at this site.

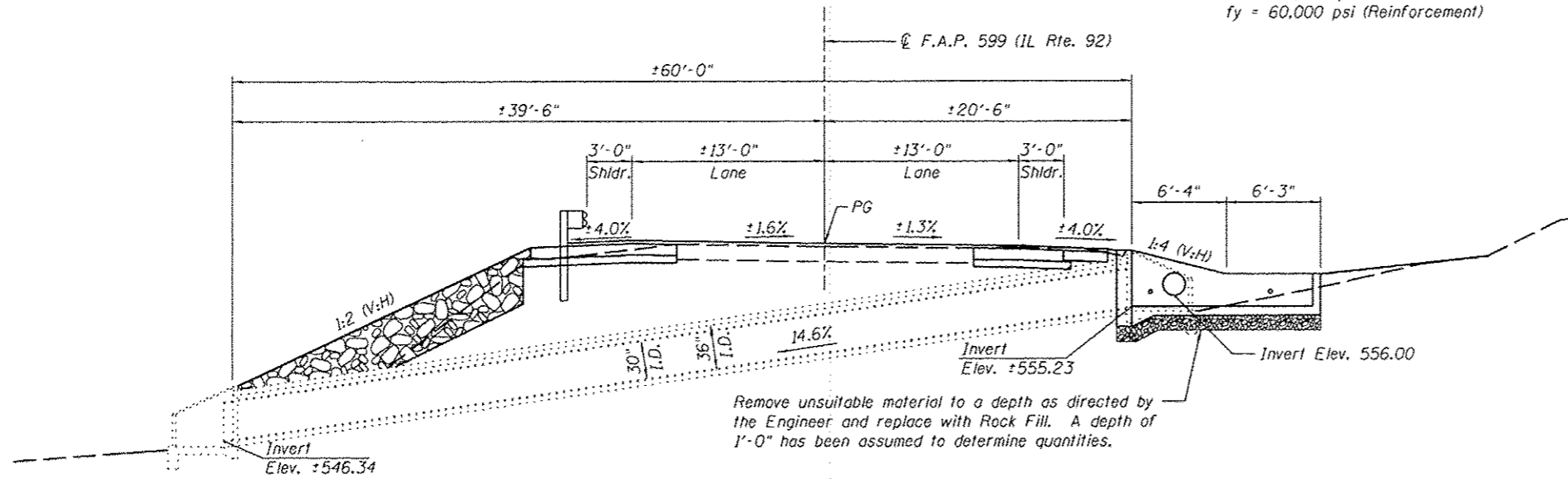

LONGITUDINAL SECTION

TOTAL BILL OF MATERIAL

ITEM	UNIT	TOTAL
Turf Reinforcement Mat	Sq. Yd.	16
Removal of Existing Structures No. 3	Each	1
Removal And Disposal Of Unsuitable Material For Structures	Cu. Yd.	5
Traversable Pipe Grate	Foot	26.5
Box Culvert End Section, Culvert No. 16	Each	1
Rock Fill	Ton	9

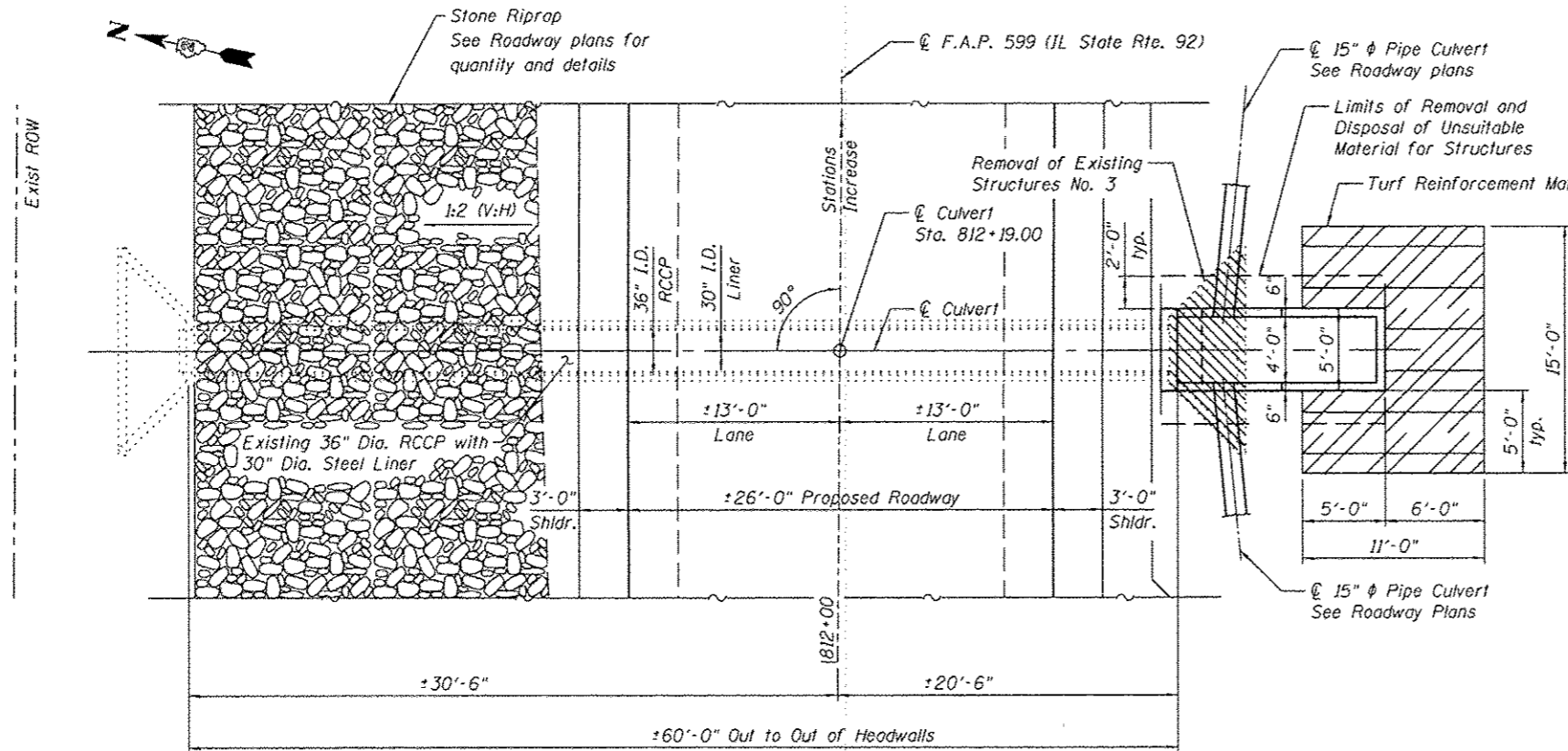

PLAN

INDEX OF SHEETS

- General Plan & Elevation
- Box Culvert End Section with Drop Box
- Box Culvert End Section with Drop Box Details
- Traversable Steel Pipe System with Drop Box

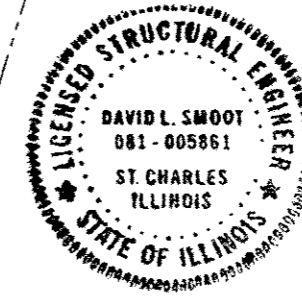

David L. Smoot
Signature

Date: March 13, 2013
License Expires 11/30/2014

GENERAL PLAN & ELEVATION
ILLINOIS ROUTE 92
F.A.P. RTE 599 - SEC. (83MFT & 103MFT)W
ROCK ISLAND COUNTY
STATION 812+19.00

FILE NAME: \\MAP\projects\2013\1128228_PTB_157\25\cadd\Structural\N\081110_2013.dwg
 PROJECT: MAP\projects\2013\1128228_PTB_157\25\cadd\Structural\N\081110_2013.dwg
 USER: hlf
 DATE: 3/21/2013



USER NAME: hlf	DESIGNED: HLF	REVISED:
PLOT SCALE:	CHECKED: DLS	REVISED:
PLOT DATE: 3/21/2013	DRAWN: HLF	REVISED:
	CHECKED: DLS	REVISED:

STATE OF ILLINOIS
DEPARTMENT OF TRANSPORTATION

GENERAL PLAN & ELEVATION
STA. 812 + 19.00

SHEET NO. 1 OF 4 SHEETS

F.A.P. RTE.	SECTION	COUNTY	TOTAL SHEETS	SHEET NO.
599	(83MFT & 103MFT)W	ROCK ISLAND	340	134
CONTRACT NO. 64H11				
FED. ROAD DIST. NO. ILLINOIS FED. AID PROJECT				