

STATE OF ILLINOIS  
DEPARTMENT OF TRANSPORTATION  
DIVISION OF HIGHWAYS

**PROPOSED  
HIGHWAY PLANS**

F.A.U. ROUTE 7706 (BUSINESS LOOP 55)  
SECTION 23(B-1)  
PROJECT ACM-7706(004)  
LOGAN COUNTY  
C-96-503-10

F.A.U. RTE. 7706	SECTION 23(B-1)	COUNTY LOGAN	TOTAL SHEETS 179	SHEET NO. 1
FED. ROAD DIST. NO.	ILLINOIS	CONTRACT NO. 72789		

FOR INDEX OF SHEETS, SEE SHEET NO. 2

D-96-521-03



STA 73+00.00  
BEGIN IMPROVEMENT  
BEGIN PROJECT

STA 96+50.07 TO STA 102+35.96 (0° SKEW)  
PROJECT INCLUDES REMOVAL AND REPLACEMENT OF  
EXISTING SN 054-0005 OVER SALT CREEK WITH A  
PROPOSED FIVE SPAN, 48" WEB PLATE GIRDER BRIDGE  
587'-0 1/4" BK-TO-BK ABUTMENTS  
89'-2" 0-TO-0 CONCRETE DECK  
PROPOSED SN 054-0512

STA 126+00.00  
END IMPROVEMENT  
END PROJECT

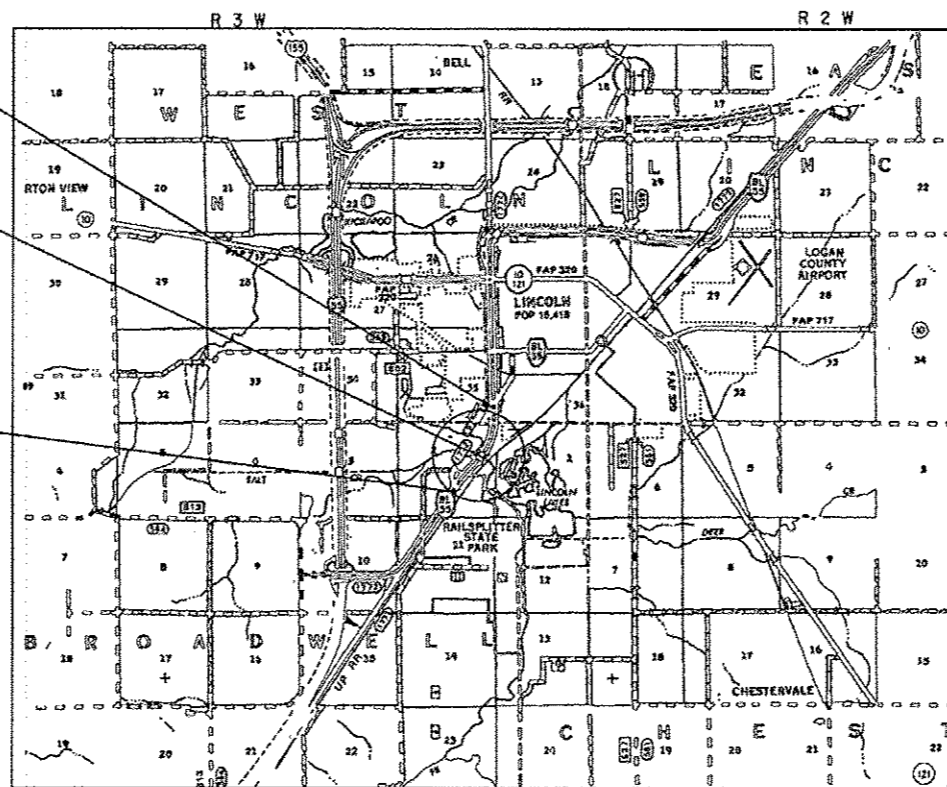

GROSS LENGTH OF PROJECT= 5,300.00 FEET = 1.004 MILES  
NET LENGTH OF PROJECT= 5,300.00 FEET = 1.004 MILES

ADT = 5,200 (2012)  
% SU = 8.1  
% MU = 1.9  
TOWNSHIPS = BROADWELL (T19N, R3W)  
WEST LINCOLN (T20N, R3W)  
FUNCTIONAL CLASSIFICATION = MINOR ARTERIAL

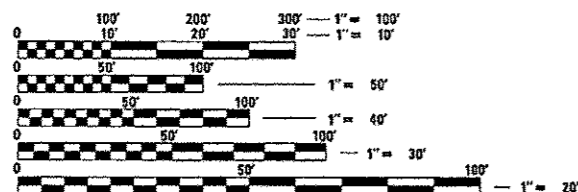

FULL SIZE PLANS HAVE BEEN PREPARED USING STANDARD  
ENGINEERING SCALES. REDUCED SIZED PLANS WILL NOT  
CONFORM TO STANDARD SCALES. IN MAKING MEASUREMENTS  
ON REDUCED PLANS, THE ABOVE SCALES MAY BE USED.

J.U.L.I.E.  
JOINT UTILITY LOCATION INFORMATION FOR EXCAVATION  
1-800-892-0123  
OR 811

PROJECT ENGINEER: VINCE MADONIA, P.E. (217) 785-9046  
TEAM ENGINEER: JAY EDWARDS (217) 785-5321

CONTRACT NO. 72789

PLANS PREPARED BY  
**HORNER &  
SHIFRIN, INC.**  
ENGINEERS

www.HornerShifrin.com  
640 Pierce Boulevard, Suite 200 • O'Fallon, Illinois 62269  
Phone: (618) 622-3040  
Illinois Professional Design Firm No. 184-000435  
License Expires 4/30/2015



*Steven R. Donahue* 5/23/13  
Steven R. Donahue, P.E. Date  
License Expires 11/30/2013

STATE OF ILLINOIS  
DEPARTMENT OF TRANSPORTATION  
DIVISION OF HIGHWAYS

SUBMITTED May 28 2013  
Ryan D. Daken  
DEPUTY DIRECTOR OF HIGHWAYS, REGION ENGINEER

June 28 2013  
John D. Baranowski, P.E.  
acting ENGINEER OF DESIGN AND ENVIRONMENT

June 28 2013  
Omer Osman, P.E.  
DIRECTOR OF HIGHWAYS, CHIEF ENGINEER

PRINTED BY THE AUTHORITY  
OF THE STATE OF ILLINOIS

USER NAME = bmcwhd  
LAST SAVED = 5/23/2013  
PLOT DATE = 5/23/2013  
PLOT TIME = 6:57:55 AM  
PLOT SCALE = 40.0000 "/>