

DATE	
BY	
SURVEYED	
PLOTTED	
TEMPLATE	
AREAS	
CHECKED	
NO.	

DATE	
BY	
SURVEYED	
PLOTTED	
TEMPLATE	
AREAS	
CHECKED	
NO.	

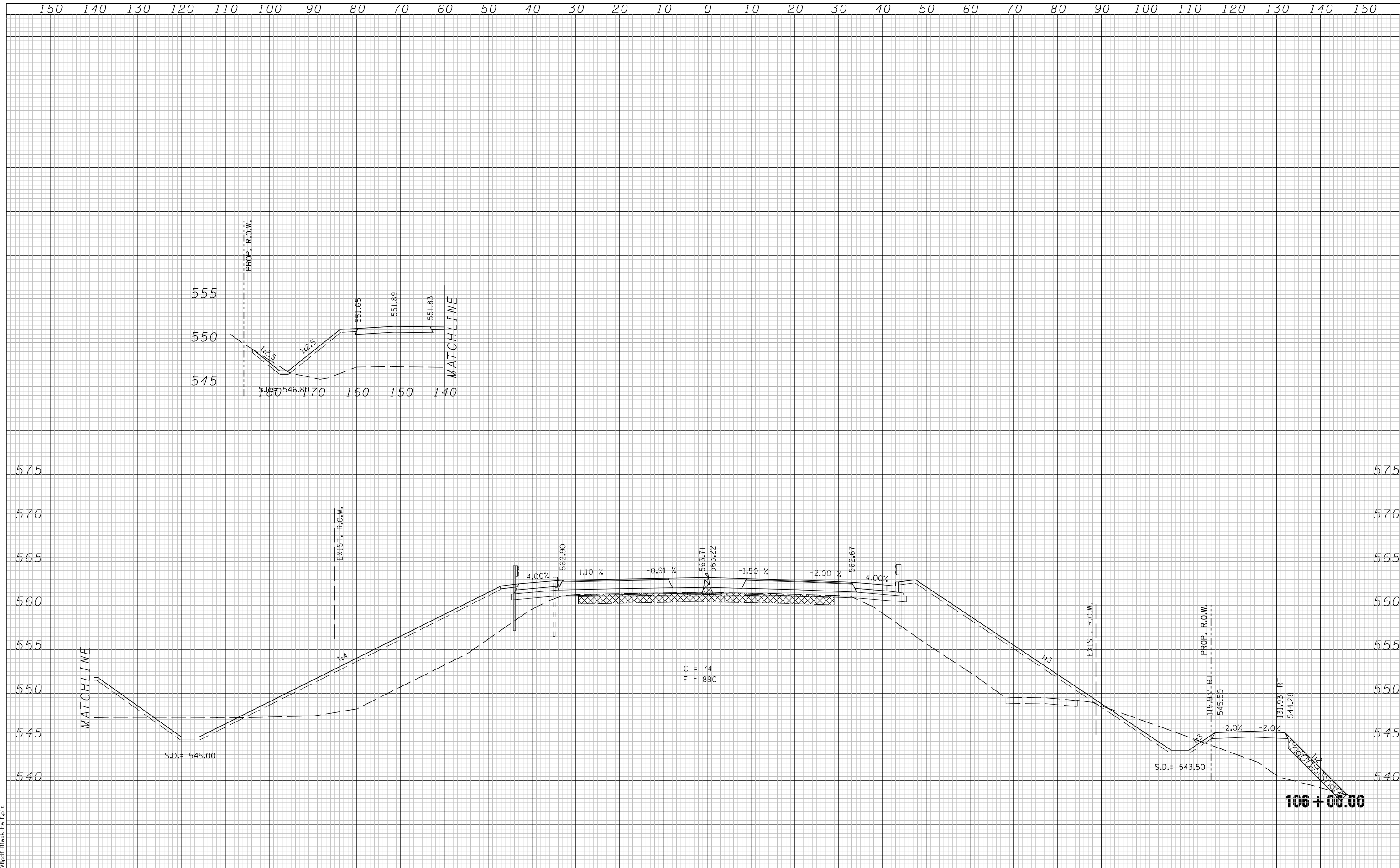

LAST SAVED = 5/23/2013  
 PEN TABLE = 106-Hd11-163  
 PLOT DRIVER = P:\17838d\FBlack-Hd11-163.plt

FILE NAME =	USER NAME = jepettibone	DESIGNED -	REVISD -	<b>STATE OF ILLINOIS</b> <b>DEPARTMENT OF TRANSPORTATION</b>	<b>CROSS SECTIONS - BUSINESS LOOP 55</b>			F.A.U. R.T.E. = 7706	SECTION = 23(B-1)	COUNTY = LOGAN	TOTAL SHEETS = 179	SHEET NO. = 165
		DRAWN -	REVISD -		SCALE: 1"=10'H 5'V	SHEET NO. 21 OF 33 SHEETS	STA. 106+00.00 TO STA. 106+00.00	BUS. LOOP 55 OVER SALT CREEK		CONTRACT NO. 72789		
		CHECKED -	REVISD -		FED. ROAD DIST. NO. ILLINOIS FED. AID PROJECT							
		DATE -	REVISD -									