

DATE	
BY	
FINAL SURVEY NO.	
SURVEYED PLOTTED AREAS CHECKED	
NOTE BOOK NO.	
TEMPLATE AREAS CHECKED	

DATE	
BY	
ORIGINAL SURVEY NO.	
SURVEYED PLOTTED AREAS CHECKED	
NOTE BOOK NO.	
TEMPLATE AREAS CHECKED	

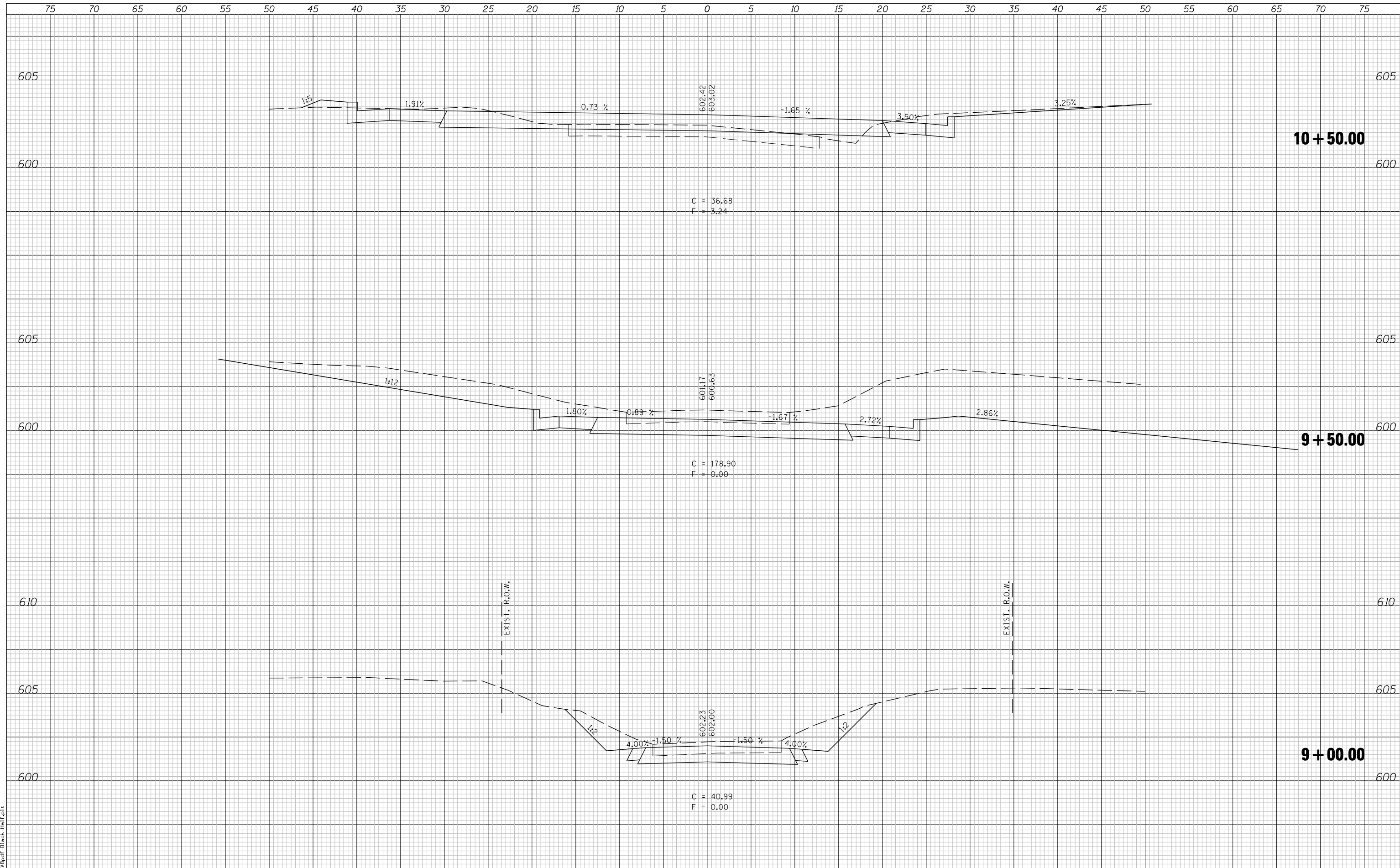

LAST SAVED = 5/20/2013
 PLOT FILE = 106103\cad\1\plans\098_0672789-Sht-XSht-Broadwell.dgn
 PLOT DRIVER = prt3dprt_black_half.plt

FILE NAME =	USER NAME = jepettibone	DESIGNED -	REVISIED -	STATE OF ILLINOIS DEPARTMENT OF TRANSPORTATION	CROSS SECTIONS - BROADWELL DRIVE			F.A.U. R.E.	SECTION	COUNTY	TOTAL SHEETS	SHEET NO.
		DRAWN -	REVISIED -					7706	23(B-1)	LOGAN	179	178
		CHECKED -	REVISIED -		SCALE: 1"=5' H SHEET NO. 1 OF 2 SHEETS STA. 9+00.00 TO STA. 10+50.00			BUS. LOOP 55 OVER SALT CREEK CONTRACT NO. 72789				
		DATE -	REVISIED -		FED. ROAD DIST. NO. ILLINOIS FED. AID PROJECT							