

**SECTION - IL 13 EASTBOUND**

SECTION APPLIES TO IL 13 WESTBOUND

\*\* LANES SHIFTED AS SHOWN IN STAGING PLANS

**LEGEND**

- CONSTRUCTION THIS STAGE
- ROAD CLOSED
- DIRECTION OF TRAVEL/LANE MAINTAINED
- DRUMS, CONES, OR BARRICADE

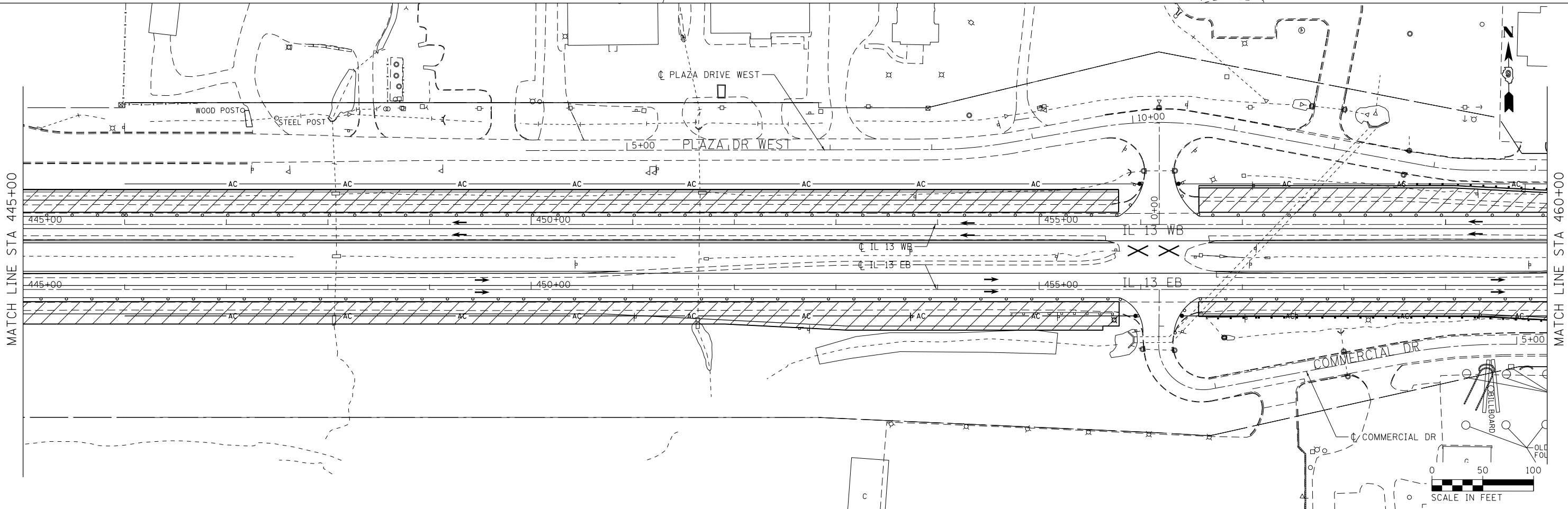
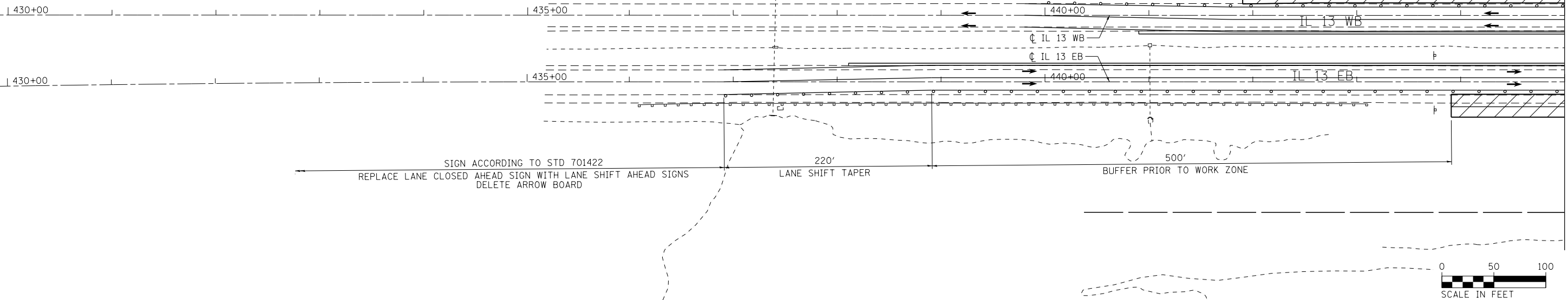
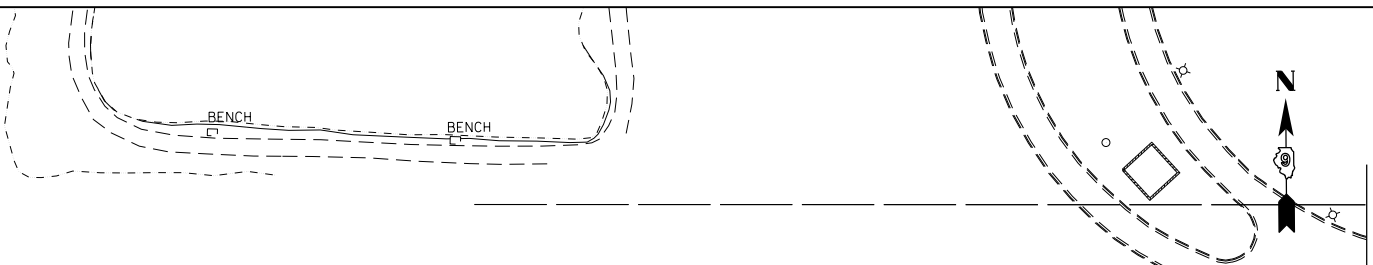

FILE NAME = D978258-sht-staging-03.dgn  
**CH2MHILL**

|                              |               |           |
|------------------------------|---------------|-----------|
| USER NAME = mfox             | DESIGNED - KN | REVISED - |
| PLOT SCALE = 100.0000' / in. | DRAWN - AS    | REVISED - |
| PLOT DATE = 1/31/2013        | CHECKED -     | REVISED - |
|                              | DATE -        | REVISED - |

**STATE OF ILLINOIS  
 DEPARTMENT OF TRANSPORTATION**

**SUGGESTED STAGES OF CONSTRUCTION AND TRAFFIC CONTROL**  
**IL 13 - STAGE 1**  
 SCALE: SHEET NO. 3 OF 13 SHEETS STA. 430+00.00 TO STA. 460+00.00

| F.A.P. RTE.               | SECTION             | COUNTY     | TOTAL SHEETS       | SHEET NO. |
|---------------------------|---------------------|------------|--------------------|-----------|
| 331                       | (1-4)R-2, N-4, TS-4 | WILLIAMSON | 381                | 131       |
| DRAWING NO. TC-03         |                     |            | CONTRACT NO. 78258 |           |
| ILLINOIS FED. AID PROJECT |                     |            |                    |           |