

**NOTES:**

1. FOR CLARITY, ONLY VARIABLE DEPTH DITCHES ARE SHOWN ON THE PROFILE. REFER TO THE TYPICAL SECTIONS AND CROSS SECTIONS FOR DEPENDENT DITCH INFORMATION.

STA 8+96.75, 30.42' LT  
 PIPE CULVERT  
 CLASS D, TYPE 1 15"  
 USFL = 417.98  
 DSFL = 417.68  
 END SECTIONS 15"

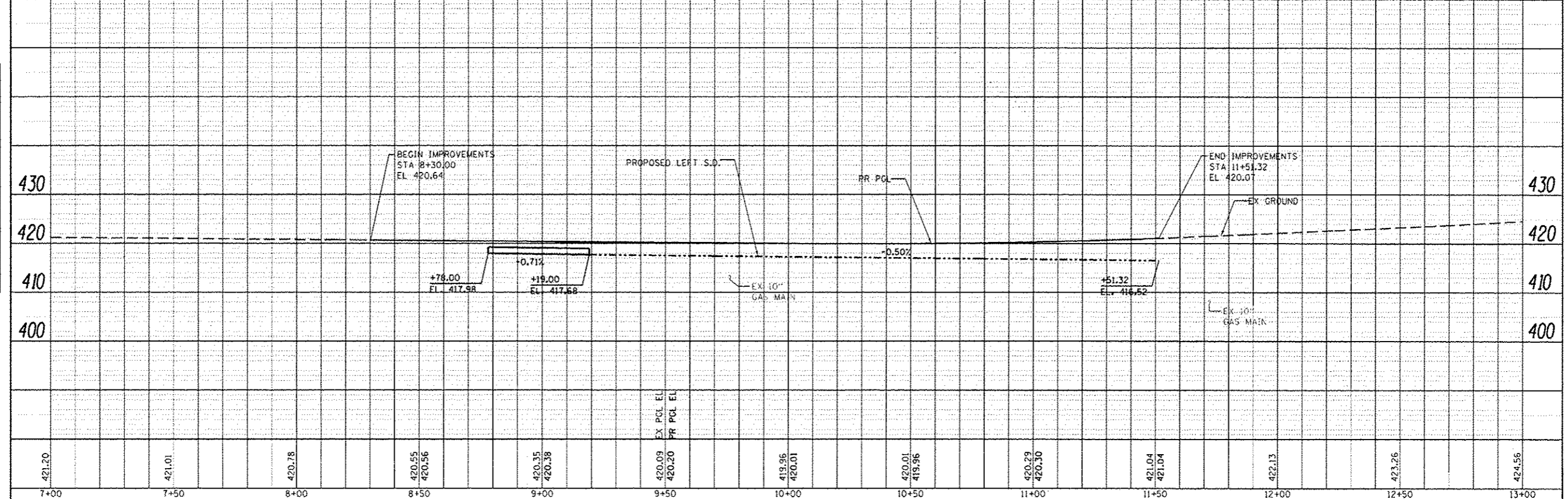
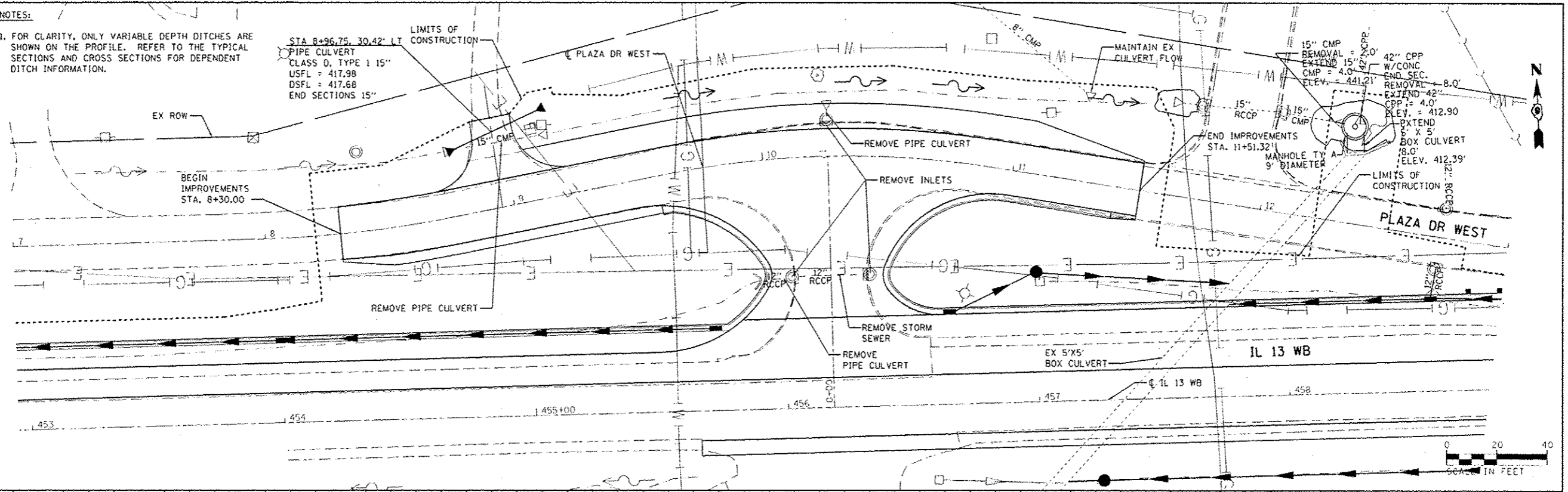

7+00	7+50	8+00	8+50	9+00	9+50	10+00	10+50	11+00	11+50	12+00	12+50	13+00
421.20	421.01	420.78	420.55 420.56	420.35 420.38	420.09 420.20	419.96 420.01	420.01 419.96	420.29 420.30	421.04 421.04	422.13	423.26	424.56

FILE NAME: 25-B-sh-d-ain-05.dgn  
 USER: brandon  
 PLOT SCALE: 40.0000 / in.  
 PLOT DATE: 5/7/2013

DESIGNED - KN  
 DRAWN - AS  
 CHECKED -  
 DATE -

REVISIED -  
 REVISIED -  
 REVISIED -  
 REVISIED -

**STATE OF ILLINOIS  
 DEPARTMENT OF TRANSPORTATION**

**DRAINAGE AND UTILITY PLANS  
 PLAZA DR WEST**  
 SCALE: SHEET NO. 7 OF 43 SHEETS STA. 8+30.00 TO STA. 11+51.32

F.A.P. RTE.	SECTION	COUNTY	TOTAL SHEETS	SHEET NO.
331	(I-4R-2, N-4, TS-4)	WILLIAMSON	381	162
DRAWING NO. DU-07			CONTRACT NO. 78258	
ILLINOIS FED. AID PROJECT				

REVISIED SHEET 6-5-13

DATE	BY

DATE	BY