



NOTES:

1. ELEVATIONS GIVEN ARE AT THE EDGE OF PAVEMENT, UNLESS OTHERWISE INDICATED.

LEGEND
⊕ SPOT ELEVATION LOCATION

STA. 12+44.25, 52.19' RT, DIVISION ST SOUTH =  
 STA. 02+98.72, 42.00' LT, VENABLE DR  
 $\Delta = 90^\circ 17' 58.16''$   
 $R = 30.00'$   
 $L = 47.28'$

STA. 13+28.21, 49.90' RT, DIVISION ST SOUTH =  
 STA. 02+99.16, 42.00' RT, VENABLE DR  
 $\Delta = 89^\circ 42' 01.84''$   
 $R = 30.00'$   
 $L = 46.97'$

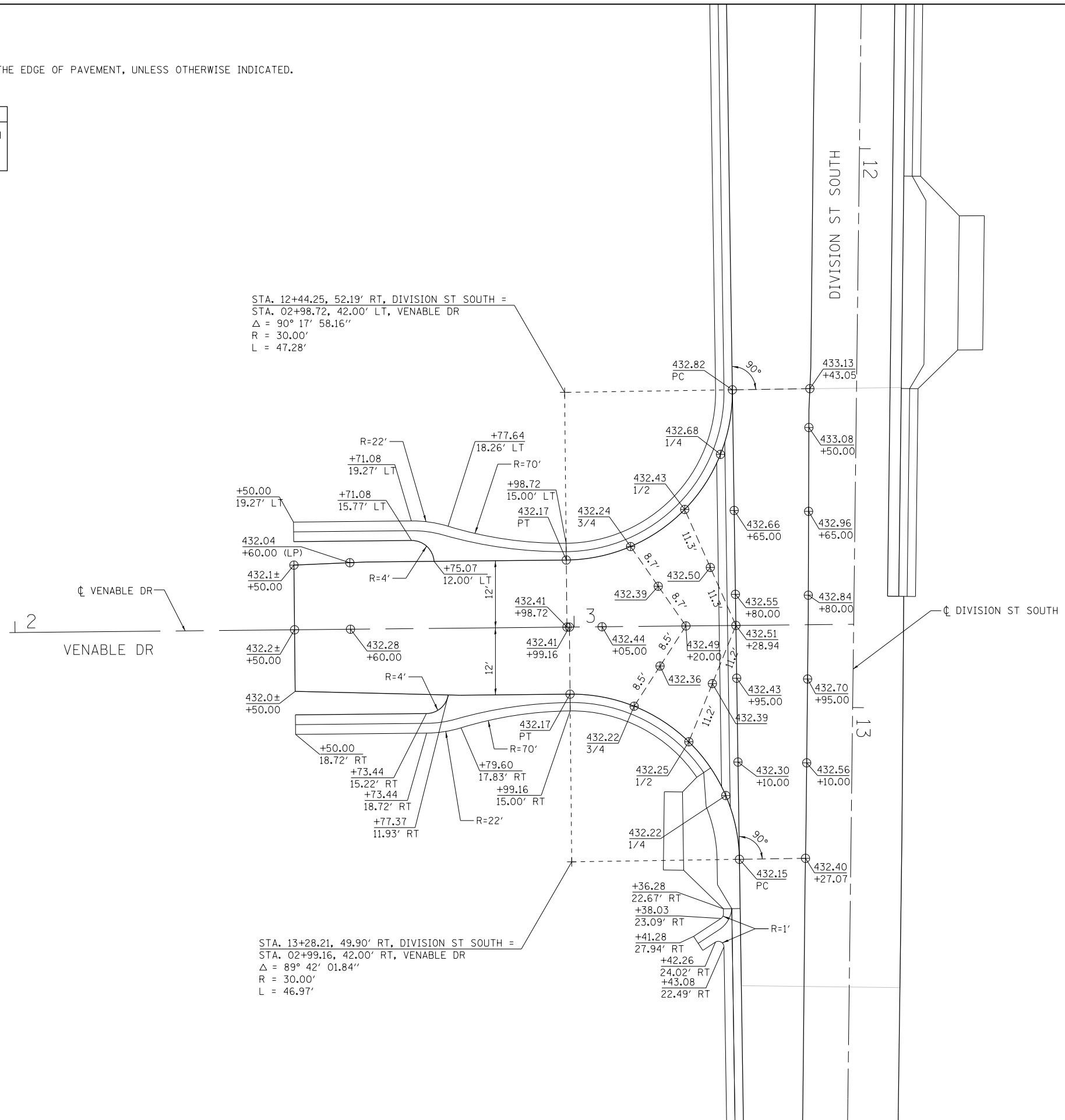

FILE NAME =  
 D978258-sht-intersec-14.dgn  
**CH2MHILL**

USER NAME = mfox	DESIGNED - KN	REVISED -
PLOT SCALE = 20.0000' / in.	DRAWN - AS	REVISED -
PLOT DATE = 1/31/2013	CHECKED -	REVISED -
	DATE -	REVISED -

**STATE OF ILLINOIS  
 DEPARTMENT OF TRANSPORTATION**

**INTERSECTION DETAILS  
 DIVISION STREET SOUTH AND VENABLE DRIVE**

SCALE: SHEET NO. 14 OF 17 SHEETS STA. TO STA.

F.A.P. RTE.	SECTION	COUNTY	TOTAL SHEETS	SHEET NO.
331	(1-4)R-2, N-4, TS-4	WILLIAMSON	381	218
DRAWING NO. ID-14		CONTRACT NO. 78258		
ILLINOIS FED. AID PROJECT				